

## 5309URF Quick Installation Guide

### Important Information

- For Windows® 98SE operating system, please go to <http://www.emprex.com/> website to download and install the "KeyMaestro Input Device Driver" to have the Internet Keys Block and Multimedia Keys Block functions.
- For Windows® ME, Windows® 2000 and Windows® XP operating system, you could use the wireless kit immediately after plugging the receiver USB connector into PC USB port.

### Hardware Installation

1. Plug in the receiver connector into your available USB port on PC.
2. Make sure the batteries of the keyboard and mouse are installed correctly, please follow the polarity signs in the battery compartment.

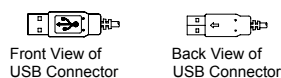

### Pairing Procedure

The pairing button locates on the top of the receiver with a LED under to show the pairing or data reception status.

The ID-recognition function helps to protect against interference from other RF products in the same environment. Remember to pair ID when other RF products affect your keyboard kit.

1. Press the pairing button on the top of the receiver first. Receiver LED will blink slowly indicating it's ready to receive keyboard/mouse pairing information.
2. Next, press the pairing button on the bottom of the mouse once.
3. Then press the pairing button on the top of the receiver again.
4. Finally, press the pairing button on the bottom of the keyboard

Receiver LED flashes 3 times rapidly as indication it's paired with this keyboard and mouse.

#### Note:

- The whole procedure should be complete **within 60 seconds**.
- Make sure your PC is on and running when doing the pairing procedure.

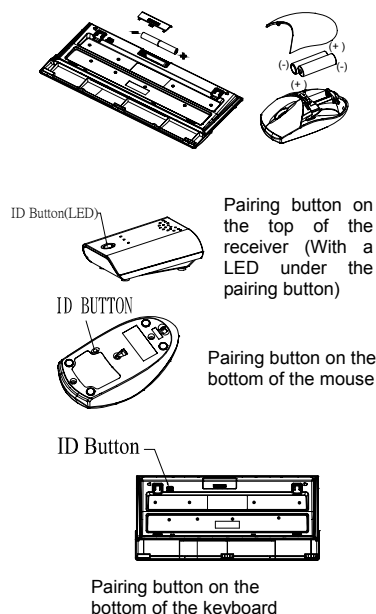

### Driver Installation

#### ■ USB Device Driver

The USB device driver is included in Windows operating system.

During initial installation of the USB device, the system will automatically detect a new hardware being added, and then bring up "Add New Hardware Wizard" dialogue box. Please follow the Wizard's USB driver installation steps. Once this installation step is completed the basic functions of the USB device will work under the operating system. The additional functions are provided only after the KeyMaestro application is installed.

#### ■ KeyMaestro Input Device Driver

1. After you download the driver, please find the "SetupKey.exe" in the directory and double-click this file.
2. Follow the on-screen instruction to install the driver.
  2. The driver icon  will show at the right-bottom of the Windows system tray when the driver is loaded.

English



## FCC GUIDELINES

This equipment has been tested and found to comply with the limits for a Class B digital device, pursuant to Part 15 of the FCC Rules. These limits are designed to provide reasonable protection against harmful interference in a residential installation. This equipment generates, uses and can radiate radio frequency energy and, if not installed and used in accordance with the instructions may cause harmful interference to radio communications. However, there is no guarantee that interference will not occur in a particular installation. If this equipment does cause harmful interference to radio or television reception, which can be determined by turning the equipment off and on, the user is encouraged to try to correct the interference by one or more of the following measures:

- ♦ Reorient or relocate the receiving antenna.
- ♦ Increase the separation between the equipment and receiver.
- ♦ Connect the equipment into an outlet on a circuit different from that to which the receiver is connected.
- ♦ Consult the dealer or an experienced radio/TV technician for help.
- ♦ Use only shielded cables to connect I/O devices to this equipment.

FCC Warning: This device complies with Part 15 of the FCC Rules. Operation is subject to the following two conditions: (1) this device may not cause harmful interference, (2) this device must accept any interference received, including interference that may cause undesired operation.

FCC Caution: Any changes or modifications not expressly approved by the party responsible for compliance could void the user's authority to operate this equipment.

Information to user:

The users manual or instruction manual for an intentional or unintentional radiator shall caution the user that changes or modifications not expressly approved by the party responsible for compliance could void the user's authority to operate the equipment.

This equipment is intended for use in the following countries EU 18 countries:

Austria, Belgium, Denmark, Finland, France, Germany, Ireland, Italy, Luxembourg, Netherlands, Spain, Sweden, United Kingdom, Portugal, Greece, Switzerland, Norway, and Iceland.

### IMPORTANT NOTE:

#### FCC Radiation Exposure Statement:

This equipment complies with FCC radiation exposure limits set forth for an uncontrolled environment. To maintain compliance with FCC RF exposure compliance requirements, please avoid direct contact to the transmitting antenna during transmitting.

This transmitter must not be co-located or operating in conjunction with any other antenna or transmitter.

