

Instruction for Eye-Caring Smart Table Lamp

Thanks for purchasing our eye-caring smart table lamp. Please read the instruction carefully before use. Product specification is the latest information at the time when this user manual is made. No further notice will be made for any variation.

Structural Function Diagram

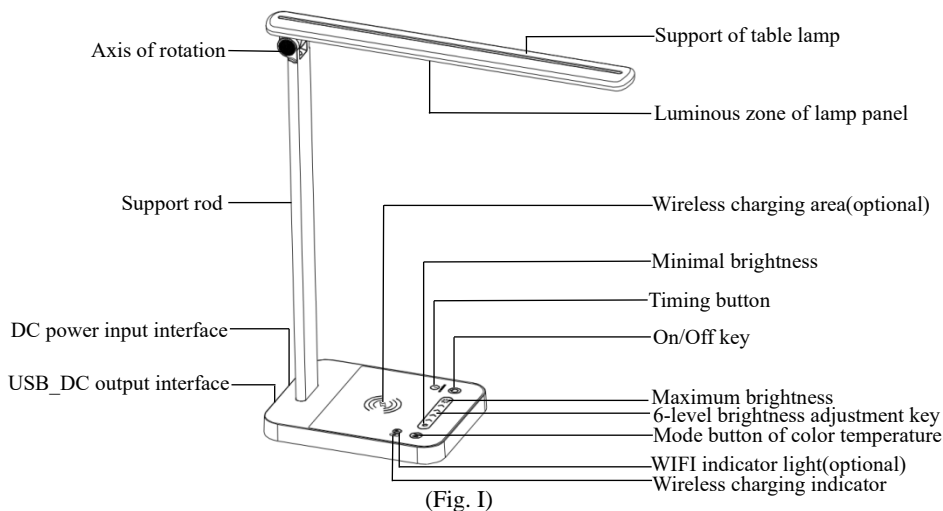

Installation Step Schematic

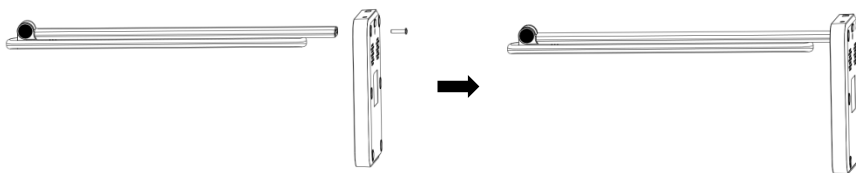

(Fig.II)

At first, the table lamp support is connected with the base and then a M4 bolt shall be screwed up from the bottom of the base and then tightened with a phillips screwdriver. The installation is completed if it is shown as the Fig. II.

Functional Description (fig. I)

Key quantity: switch/color temperature switching, 6 keys are for brightness control by sliding itching.

② Power supply: AC100-240V-50/60HZ power adapter, DC-9V_2.5A output.

③ Wireless charging indicator has the red light on during the charging process. Neither red nor

green light is on when the table lamp is not charged. During energization, red and green lights are on alternatively and the green light flickers in case of failure (only limited to the table lamp with wireless charging function).

④ 50HZ/60HZ-no stroboflash during photographing with mobile phone.

Work Mode

1) On/off key: After the table lamp is POWERED, touch the on/off key for the first time, the red indicator light is on, and the table lamp is turned on. Touch the key for the second time, the indicator light is off, and the table lamp is turned off.

2) Mode switching button of Color temperature: When the light is on, touch the M key to switch the color temperature; the color temperature has three levels: only white light -- only warm light -- ratio between white and warm light is 1:1. Three levels cycle in turn; the color temperatures switch in time hopping mode.

3) Six-level brightness adjustment key: When the light is on, you can slide or touch the key to adjust the brightness, and the brightness increases from left to right in turn.

4) In the case of uninterrupted power supply, the table lamp has memory function of brightness and color temperature.

5) When the color temperatures are switched, the brightness increases in turn from left to right; when the brightness is adjusted, the color temperature ratio remains unchanged.

Touch Instructions

(1) Brightness control through 6-key sliding or touching, brightness changes gradually in sequence of 10% -20%- 40% - 60% - 80% - 100% in turn. When the white light and warm light are on at the same time, the power is the same as that of the white light alone or warm light alone at maximum brightness.

(2) The mode switching button of color temperature has an indicator light. Touch the power button, the color temperature indicator and power indicator will light up simultaneously.

(3) Touch the timing button, the timing indicator light is on and blinking slowly, which means timing starts. The timing length is 30 minutes. Touch the button again, the indicator light is off and the the timing function is turned off.

WIFI Network Distribution (The function is equipped based on the type)

(1) Indicator light for network distribution: Users should note that before WiFi network distribution, please press the on/off key for five seconds until the WIFI indicator light flashes slowly. It indicates the reset is completed. At this time, WIFI can be connected.

(2) During network distribution status, the indicator light blinks slowly; after successful network distribution, the WIFI indicator light is keeping on; Under the network distribution status, the indicator light flashes slowly and APP flashes slowly under the network distribution status. In case of overtime network distribution or unsuccessful network distribution, WiFi indicator light is off.

(3) Press the on/off key for five seconds to reset WIFI and then distribute the network again for

connection.

(4) WiFi connection method:

At first, scan the QR code below with a mobile phone to download the APP, application name: Smart Life 



After installation is completed, click on the application icon to enter into APP setting:

Register a new account according to the prompt and login in. Upon login, click “Add Device” in “Home” interface. Afterwards, click “Smart Lighting” and “Lighting Devices” in “Add Devices” interface. After the smart table lamp is connected with the charger, “” indicator light will blink constantly. At this time, click “confirm light blinks rapidly”. Then enter the WIFI network name and password, click “Confirm”. Finally, please wait for the connection to succeed.

Note: After clicking “confirm light blinks rapidly” in the prompt interface of the hand-held device, the device is being connected (please note the hand-held device, WiFi router shall be close to the smart table lamp as far as possible). If the connection is successful, it will prompt “Device added successfully”, and click “Completed”. The smart table lamp can be controlled with the APP via WIFI. There are five items on the setting interface---“Switch”, “Custom”, “PC Mode”, “Scene” and “Schedule”. Under these items, various functions can be adjusted as needed. WiFi function supports Amazon Alexa, Google HOME, Tmall Genie, and other apps.

Instruction for Wireless Charging (The function is equipped based on the type)

After connecting the power adaptor, the charging sign(fig. I) flickering in both red and green lights alternatively indicates that the detection is completed. The mobile phone (it must be the device with wireless charging function) is put on the central region of wireless charging area (Fig.I), the red light of charging sign is on, which indicates charging is in process. Flickering of red light indicates there are foreign objects or the charging cannot be identified. The indicator light is off when no charging can be performed.

Technical Parameter

Item	Parameter
Power supply way	AC100-240V-50/60HZ, input port 9V_2.5A
Maximal power of the whole device	≤ 24W
Maximal power of LED	8.5W
Output power of USB	Output voltage 5V/1000MA.
Light control way	6-level light control through touch
Light color	1. White light 6500K 2. Warm light 3000K

	3. Warm light and white light (1:1) 5000-5500K.
Power of wireless charger (the function is optional)	Maximal 10W.
Material	Aluminium alloy metal support rod and plastic cement base
Adjustable angle for illuminance	Rotation along 180°
Product size	13.8cm*17.8cm*41cm
Product weight	About 791g

Notice

1. Do not look at the light-emitting chip directly because of the strong light here. Looking at the strong light directly will cause damage to the eyesight!
2. In order to avoid danger of electric shock, please do not dismantle the table lamp and accessories privately.
3. In order to prolong the service life of the table lamp, it is better to reduce the full load.
4. Keep the table lamp dry. If moisture enters into the table lamp, please stop using it immediately. Make sure the table lamp is completely dry before reuse.
5. The device with wireless charging function should be placed in the center of the charging signs of the table lamp in order to obtain the best charging effect.
6. The table lamp heating in the using process is a normal phenomenon.
7. When the table lamp is at its maximum brightness, charging a high-power device will affect the brightness of the table lamp. So, before charging the high-power device, please turn off or turn down the brightness of the table lamp.

NOTE: This equipment has been tested and found to comply with the limits for a Class B digital device, pursuant to part 15 of the FCC Rules. These limits are designed to provide reasonable protection against harmful interference in a residential installation. This equipment generates uses and can radiate radio frequency energy and, if not installed and used in accordance with the instructions, may cause harmful interference to radio communications. However, there is no guarantee that interference will not occur in a particular installation. If this equipment does cause harmful interference to radio or television reception, which can be determined by turning the equipment off and on, the user is encouraged to try to correct the interference by one or more of the following measures:

- Reorient or relocate the receiving antenna.
- Increase the separation between the equipment and receiver.
- Connect the equipment into an outlet on a circuit different from that to which the receiver is connected.
- Consult the dealer or an experienced radio/TV technician for help

Changes or modifications not expressly approved by the party responsible for compliance could void the user's authority to operate the equipment.

This device complies with Part

15 of the FCC Rules. Operation is subject to the following two conditions:

- (1) this device may not cause harmful interference, and
- (2) this device must accept any interference received, including interference that may cause undesired operation.

This device is acting as slave and operating in the 2.4 GHz (2412 ~2462 MHz) band.

RF Exposure Warning Statements:

This equipment complies with FCC radiation exposure limits set forth for an uncontrolled environment. This equipment shall be installed and operated with minimum distance 20cm between the radiator & body.