

4折页 宽105mm 长148mm 中文一面 英文一面 折叠的时候，英文朝上面

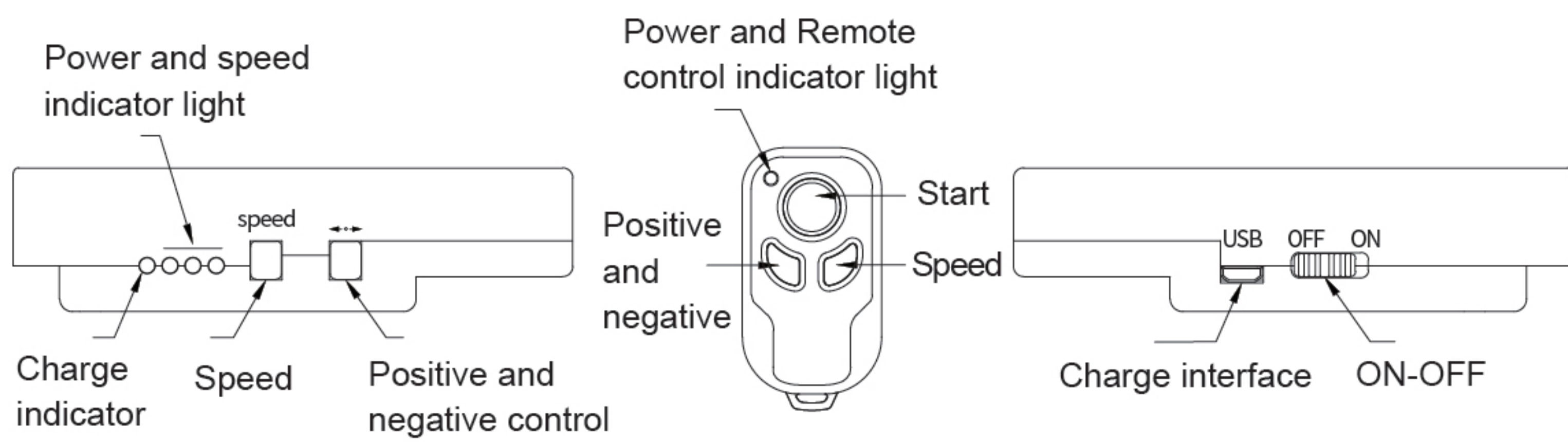

L4 Generation 2 autodolly
product specification

Product structure

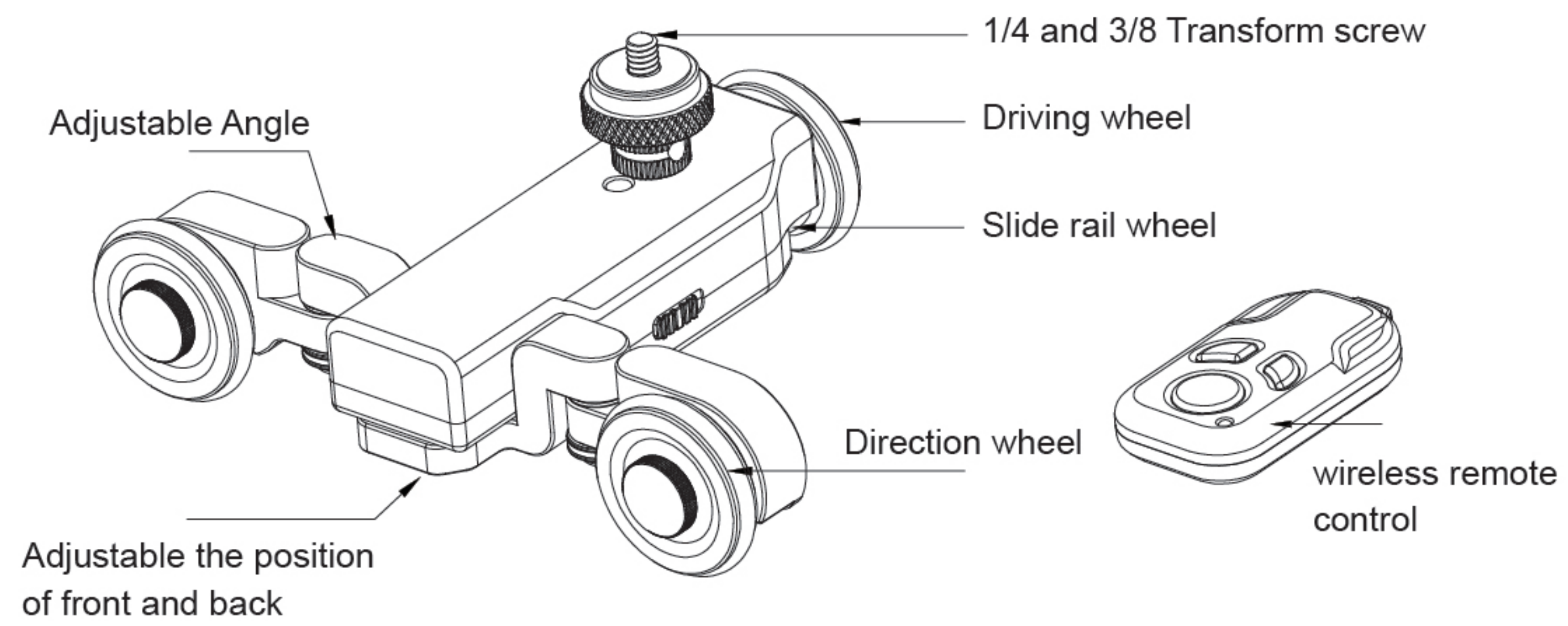

Annotation:

- Four lights on the fuselage, red while charging, green when it is full, three are Power and speed indicator light, it flash represent power. The default speed is three(max speed).
- wireless remote control indicator, when press the key, the light flash represent the sign is sent, it lasts bright represent no power.

Camera Angle

1. Straight shot:Put the two direction wheels in the same line,placed it on a smooth surface or a carbon fiber slide to use, the center distance of two slider tube is 80mm.Then it can realize Straight shot, as the following picture A
2. Curve shoot , Adjust the Angle of the two Direction wheels and placed it on a smooth surface, then it can realize Curve shot, as the following picture B
3. Pitch shot, need USE with spherical base plate, adjust the barycenter, then you can shot with different angle. as the following picture C



Application step

1. After adjusting and installing well, Turn on the power switch, Press the Positive and negative key of dolly or the start key of remote control. Then it can work normally,as the following picture D
2. By the key of dolly or remote control can control the all kinds of function,as the following picture E
3. When the transform screw is too loose or tight, pls use m4 hex wrench to adjust,as the following picture F

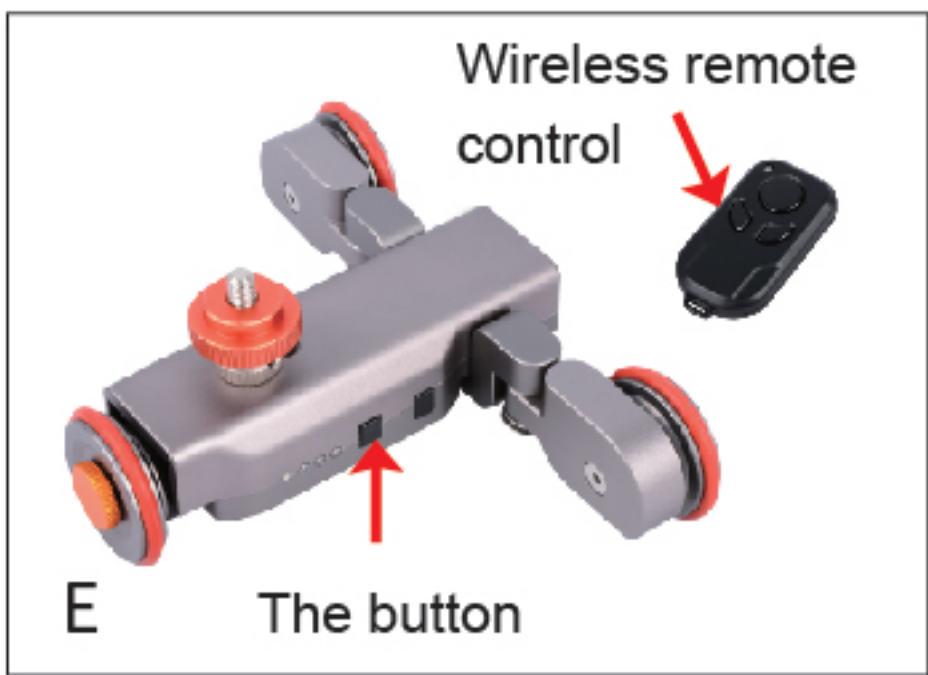

Specification

Speed One	1.5CM/S
Speed Two	2.0CM/S
Speed Three	2.5CM/S
Max load weight	3kg
The distance of wireless remote control	6M
Time of endurance	6H
Charge time	6-7H
Remote control battery	Preferred the original brand batteries, such as Digititan, Panasonic, SONY etc. (other brand battery may be empty mark, voltage or current is not enough, lead to useless) battery model: CR2032, 3 v lithium battery.

Attention

- 1、 Do not use heavy force to turn the drive wheel
- 2、 Do not use upon 3kg
- 3、 Take out the battery when the wireless remote control is free
- 4、 Do not use on the rough surface
- 5、 Must fix the camera and adjust the barycenter, before using

Warning:

changes or modifications not expressly approved by the party responsible for compliance could void the user's authority to operate the equipment.

This device complies with Part 15 of the FCC Rules. Operation is subject to the following two conditions: (1) this device may not cause harmful interference, and (2) this device must accept any interference received, including interference that may cause undesired operation. changes or modifications not expressly approved by the party responsible for compliance could void the user's authority to operate the equipment.

NOTE: This equipment has been tested and found to comply with the limits for a Class B digital device, pursuant to Part 15 of the FCC Rules. These limits are designed to provide reasonable protection against harmful interference in a residential installation. This equipment generates, uses and can radiate radio frequency energy and, if not installed and used in accordance with the instructions, may cause harmful interference to radio communications. However, there is no guarantee that interference will not occur in a particular installation. If this equipment does cause harmful interference to radio or television reception, which can be determined by turning the equipment off and on, the user is encouraged to try to correct the interference by one or more of the following measures:

- Reorient or relocate the receiving antenna.
- Increase the separation between the equipment and receiver.
- Connect the equipment into an outlet on a circuit different from that to which the receiver is connected.
- Consult the dealer or an experienced radio/TV technician for help.

NOTE: This device and its antenna(s) must not be collocated or operation in conjunction with any other antenna or transmitter.