

封面

技术要求:

- 1) 颜色C: 4C(参考最终封样) ;
- 2) 材质M: 80G白牛卡;
- 3) 工艺F: 模切+风琴折;
- 4) 环 保: 产品环保认证需满足包装指令+REACH要求;
符合最新版《联创宏声有害物质管理标准》;
同时须符合双方签订的《环保协议书》;
- 5)测试要求: 无;
- 6)其 他: (1)颜色与样板(样板只能存放六个月) 不能存在严重色;
差色彩误差在-3%~3%之间;;
(2)印刷字唛、图案不能存在模糊不清或有重影;
(3)贴纸切割位与样板不符, 有切偏或未切断等;
(4)折合後, 各折合邊位紙質不能有爆開、起皱;
(5)印刷内容及内容排版位置需与样板或文档相符.

											
			产品型号 零件名称			TEND1032BL02000					
						说明书					
V2	更新封底Air改大写 梁安丽 2024/10/16		零件编号								
变 更	原 因	签名/日期	图纸编号			LC8. 865. 5026					
标 记	签 名 / 日 期										
制 图	梁安丽	2024/10/16	版本	比例	单位	A	±0.05	±0.1	±0.2	±0.3	±0.4
标准化	廖秀敏	2024/10/16	V2	1:1	MM	B	±0.1	±0.2	±0.3	±0.4	±0.5
审 核	李王华 曾永华 2024/10/16					C	±0.2	±0.5	±0.7	±1.2	±2.0
批 准	卢华庭 2024/10/16					等级	<5	5~15	15~60	60~250	>250

TU01 Air说明书

材质：80G白牛卡纸

工艺：模切+风琴折

颜色：双面印刷4C

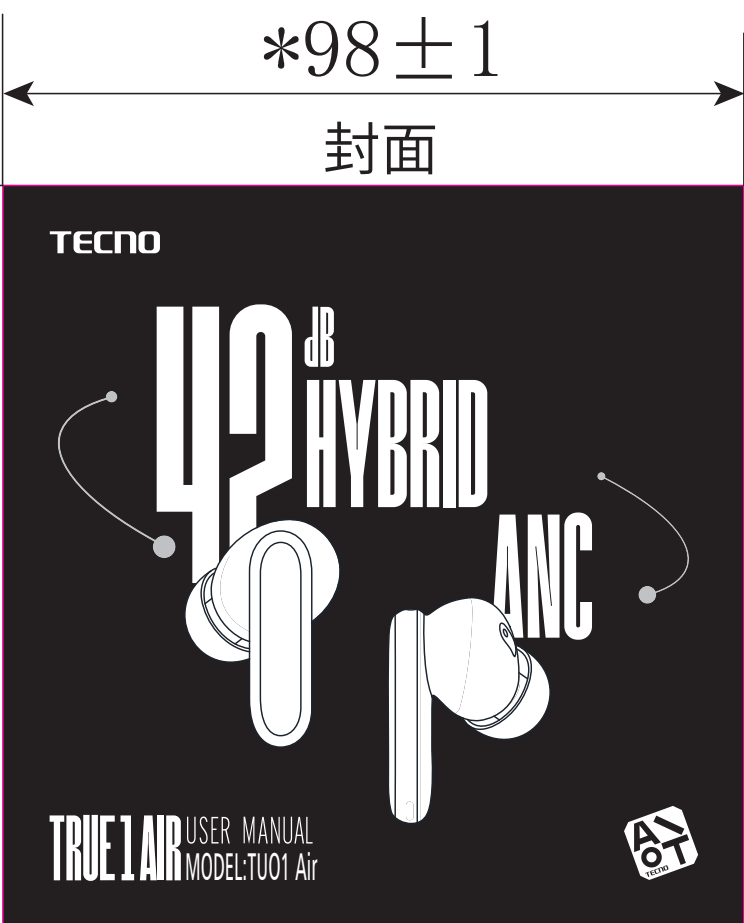

Packing List

2* Bluetooth earphone
1* Charging box
1* Charging cable
1* User Manual

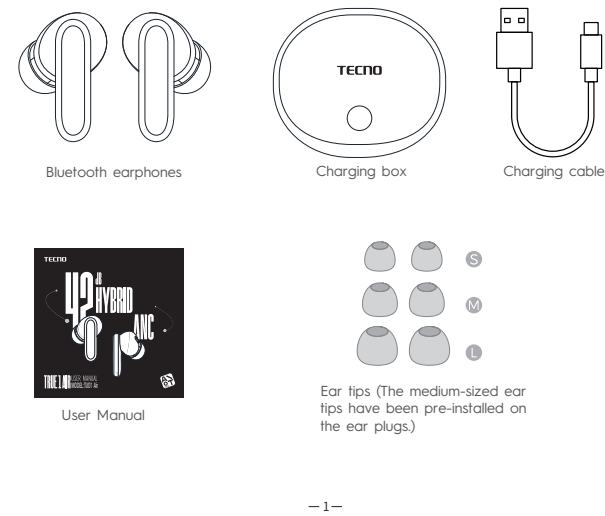

Overview

1. Charging pins
2. Charging box indicator light
3. Charging port
4. Reset button

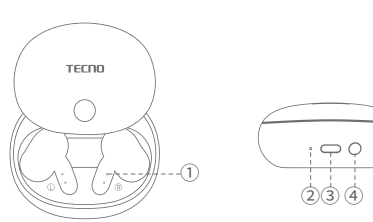

Mobile phone models supporting intelligent pop-up window for connection

TECNO phones running HIOS 13 or later versions.

Basic Features

Model	TU01 Air
Charging Port	Type-C
Earphone battery capacity	55mAh
Charging box battery capacity	440mAh
Charging voltage/current	5V/1A (charging box) 5V/0.2A (earphones)
Music playback endurance	50H (50% volume, earphones-charging box)
Transmission range	≤10m
Bluetooth name	TECNO True 1 Air
Operating temperature	Charge: 0°C-45°C Discharge: -10°C-45°C
Storage temperature	-20°C ~ 70°C
Earphones charging time	~2h
Charging box charging time	~2h

Charging Box Indicator Light Status Prompt

Charging case state and operation	Indicator light prompt
Bluetooth is not connected to the device: the white light flashes slowly, on for 1 second and off for 1 second. The state is synchronized with that of the earbuds for 2 minutes.	Bluetooth connected successfully: the white light is always on (if in the case).
Bluetooth is not connected to the device: the white light flashes slowly, on for 1 second and off for 1 second. The state is synchronized with that of the earbuds for 2 minutes.	Normal battery level of the charging case: the white light is on for 5 seconds, low battery level: the white light flashes quickly for 5 seconds.
Close the cover of the charging case when the earbuds are in the case or not in the case.	When the earbud pairing list is cleared, the white light flashes three times, Bluetooth is not connected to the device: the white light flashes slowly, on for 1 second and off for 1 second. The state is synchronized with that of the earbuds for 5 minutes.
Press and hold the button on the charging case for 4 seconds when both earbuds are in the charging case and the cover is open.	Bluetooth connected successfully: the white light is always on (if in the case).
Press and hold the button on the charging case for 8 seconds when both earbuds are in the charging case and the cover is open.	Force TWS pairing of left and right earphones, quickly breathe 3 times under connection status.
Charge the case when the cover is open/case	The breathing light effect (white light) of the battery level of the case is displayed, on for 1 second and off for 1 second, and will be turned off when the power is full.

Earphones Usage

Charge the charging box

1. Connect the smaller part of USB-C cable to the Type-C charging port of the charging box.
2. Connect the port at the other end to a USB wall charger (DC5V) or a powered-on computer.

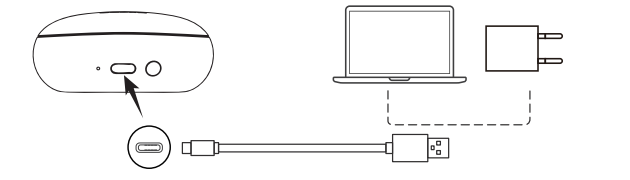

Charge the earbuds through the charging case

When charging the earbuds through the charging case for the first time, tear off the insulating films on the earbuds.



Proper use of the earphones

If it is not comfortable to wear ear tips, please take them off, replace them with the ones in larger or smaller size and try for the best fit; Follow the figure to ensure that you wear the ear tips correctly.

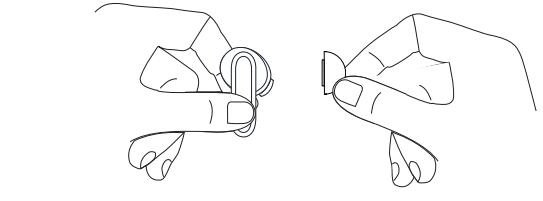

Power On/Off

Power On

When the cover of the charging case is opened, the earbuds are automatically turned on.

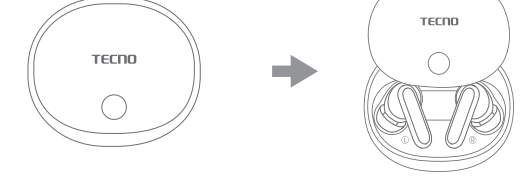

Power Off

When the earbuds are turned on, putting the earbuds into the charging case and closing the cover of the charging case will turn them off.

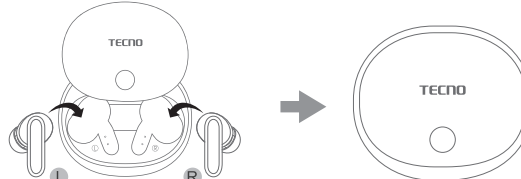

Connection to Intelligent Device

- Put the earphones in the charging case, and press the button on the case to enable pairing mode. You can search for the Bluetooth name "TECNO True 1 Air" on your mobile phone for pairing.
- When the earbuds are in the charging case, open the cover, and the earbuds will be automatically turned on and the left and right earbuds will pair with each other successfully.
- If there is no connection record, the earbuds will enter the mobile phone pairing mode. When the pairing times out for 5 minutes, the earbuds will be turned off automatically.
- If there are connection records, the earbuds will be automatically reconnected to the last connected device. The reconnection time is about 12 to 14 seconds. If the reconnection fails, the earbuds will enter the pairing mode. When the pairing times out for 5 minutes, the earbuds will be turned off automatically.

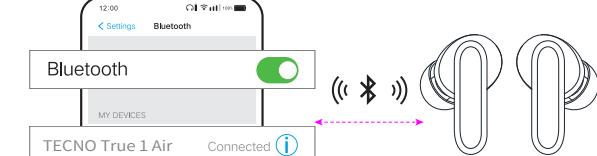

- If both earbuds are in the case and the cover is open, pressing and holding the button on the charging case for 4 seconds will clear the earbud pairing list. If the cover is open and there is only one earbud in the case, pressing and holding the button on the charging case for 4 seconds will not clear the records.
- When the cover is open and both earbuds are in the case, pressing and holding the button on the charging case for 8 seconds will force left and right headphones TWS pairing.

Noise Control

- When both earbuds are connected in the non-call state, wear the earbuds in both ears, press and hold the touch area on the left/right earbud for 2 second to switch between the following modes: "ANC ON" - ANC OFF - Awareness Mode" in a cycle.
- When wearing only one earphone, the noise cancellation function will be kept off.



TECNO MOBILE LIMITED

TM and Copyright ©2010-2022 TECNO Corporation. All rights reserved. Other product and company names mentioned herein may be trademarks or trade names of their respective owners. Specifications are subject to change without notice. Model names and the availability of particular products may vary by region.

www.tecno-mobile.com

service.us@tecno-mobile.com



More Products



Download Welife App

Customer Preferred Sounds, Effects



Multiple Language

Bluetooth CE RoHS FCC ID: 2ADYY-TU01 AIR MADE IN CHINA

Charging Box Button

- When both earphones are in the charging box, keep the box open and press the charging box button, and the earphones will enter the pairing mode and can be connected to a new device.
- Press and hold the button for 4 seconds to clear the pairing record of the earphones, and the pairing mode can also be entered.
- When only one earphone is in the charging box, the above operation on the button is invalid.

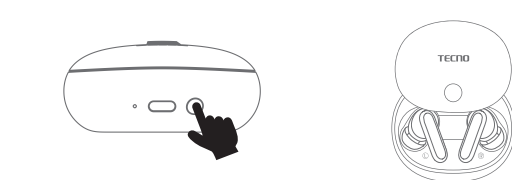

Note:
Clear the pairing list:
Bluetooth is not connected to the device: the white light flashes slowly, on for 1 second and off for 1 second. The state is synchronized with that of the earbuds for 2 minutes.
Bluetooth connected successfully: the white light is always on (if in the case).

Download the Welife App for More Features

Scan the QR code to quickly download the Welife app for pre-set effects, artistic connection pop-ups, customer support, and more smart audio features to discover.

Turn on the earbuds, then open the app and tap "Add Device" to add the earbuds.

Multiple Sound Effects to Enjoy

Support Bass Booster, Treble Booster, Vocal Booster, etc. Choose the one that suits you best.

Quick Connection Pop-up:

It supports auto pop-ups for earbuds connection reminder, and also custom pop-up themes. It is supported by multiple phone brands. For TECNO phones, customization of pop-up themes is available for HIOS4+ devices.

Cancel Confirm

Quick Activation of Game Mode:

Enable game mode quickly in the app to achieve better synchronization of audio and video for an enhanced gaming experience.

Earphone Touch Key Customization

With free customization of functions triggered by earphone touch keys, keep one step ahead of others in answering calls and controlling music. Tap and hold the earphones touch area to switch among "Noise Cancellation/Off/Transparency". A quicker cycle switch between "Noise Cancellation/Transparency" can be set in Welife App.

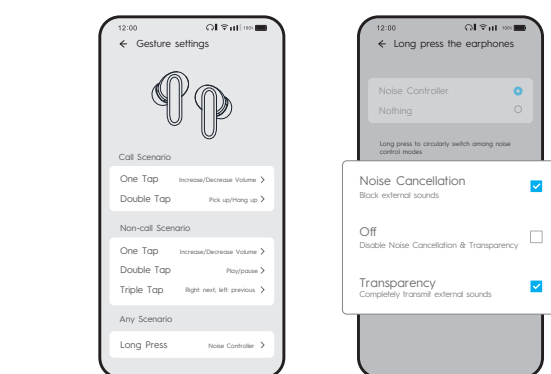

Call Mode

- Double tap to answer the call (when there is an incoming call) and double tap to end the call (during the call)



Call Mode

- (When there is an incoming call) Pressing and holding the button for 2 seconds will reject the call.

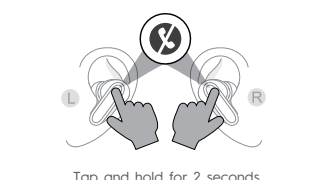

Music Mode

- Double tap to play/pause music.

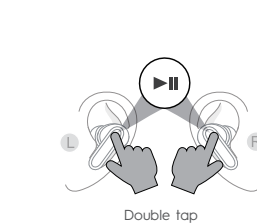

Volume*/Volume-

- Tap the left earphone to turn down the volume, and tap the right earphone to turn up the volume(Single ear mode, unable to increase or decrease volume).

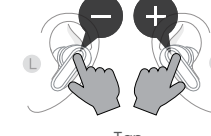

Voice Assistant and Game Mode

- Triple-tap the right earbud to enable/disable Voice Assistant
- Triple-tap the left earbud to enter/exit Game Mode

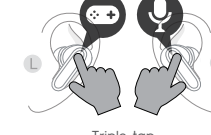

Switch Among Noise Cancellation Modes

- Tap and hold L/R earphone for 2 seconds to switch among noise cancellation modes



FCC Caution:

Labeling requirements.

This device complies with Part 15 of the FCC Rules. Operation is subject to the following two conditions:
(1) This device may not cause harmful interference.
(2) This device must accept any interference received, including interference that may cause undesired operation.

Information to user.

Any changes or modifications not expressly approved by the party responsible for compliance could void the user's authority to operate the equipment.

Information to the user.

Note: This equipment has been tested and found to comply with the limits for a Class B digital device, pursuant to Part 15 of the FCC Rules. These limits are designed to provide reasonable protection against harmful interference in a residential installation. This equipment generates uses and can radiate radio frequency energy and, if not installed and used in accordance with the instructions, may cause harmful interference to radio or television reception, which can be determined by turning the equipment off and on, the user is encouraged to try to correct the interference by one or more of the following measures:
-- Reorient or relocate the receiving antenna.
-- Increase the separation between the equipment and receiver.
-- Connect the equipment into an outlet on a circuit different from that to which the receiver is connected.
-- Consult the dealer or an experienced radio/TV technician for help.

Note: This device and its antenna(s) must not be co-located or operation in conjunction with any other antenna or transmitter.

RF Exposure Statement

The device has been evaluated to meet general RF exposure requirement. The device can be used in portable exposure condition without restriction.

User Manual

TWS Earphone

Model: TU01 Air

Hereby, TECNO MOBILE LIMITED

declares that this TWS Earphone is in compliance with the essential requirements and other relevant provisions of directive 2014/53/EU.

CAUTION:

- Risk of explosion if battery is replaced by an incorrect type, dispose of used batteries according to the instructions.
 - disposal of a battery into fire or a hot oven, or mechanically crushing or cutting of a battery, that can result in an explosion;
 - leaving a battery in an extremely high temperature surrounding environment that can result in an explosion or the leakage of flammable liquid or gas;
 - a battery subjected to extremely low air pressure that may result in an explosion or the leakage of flammable liquid or gas.
- EUT Temperature: -10°C ~ +60°C (Standardone), 5°C ~ +40°C (with adapter).
-



The full text of the EU declaration of conformity is available at the following internet address: <https://www.tecno-mobile.com/declaration/#/>

Frequency Range(RF):

BT: 2400-2483.5MHz(TX/RX)

Max. Of Transmit power (only for CE) :

BT(EDR): 7.35dBm

BLE: 6.35dBm

EU DECLARATION OF CONFORMITY in accordance with

Annex VI of Directive 2014/53/EU of the European Parliament and of the Council

1.For the following Radio equipment:

Model: TU01 Air

Product: TWS Earphone

Trade name or Brand: TECNO

Software / Hardware number: V1.0/V1.0

Manufacturer: TECNO MOBILE LIMITED

Address: FLAT N 16/F BLOCK B UNIVERSAL INDUSTRIAL CENTRE 19-25 SHAN MEI STREET FO TAN NT HONGKONG

5. This declaration of conformity is issued under the sole responsibility of the Manufacturer.

4. Object of the declaration (identification of the radio equipment allowing traceability; it may include a colour image of sufficient clarity where necessary for the identification of the radio equipment).

5. The object of the declaration described above is in conformity with the relevant Union harmonization legislation: Directive 2014/53/EU (RED)

6.References to the relevant harmonised standards used or references to the other technical specifications in relation to which conformity is declared

Article 31a

Health:

EN 62479:2010

EN 50663:2017

Article 31a

Electrical safety:

EN62368-1:2014+A11:2017

EN IEC 62368-1:2020+A11:2020

Article 31b:

ETSI EN 301 489-1 V22.3 (2019-1)

ETSI EN 301 489-17 V32.4 (2020-09)

Article 31c:

ETSI EN 300 328 V22.2 (2019-07)

7. Notified Body Name: Eurofins Electrical and Electronic Testing NA, Inc. Notified Body Number: 0950

Notified Body Assessment Performed: Module B/C on Article 31a, 31b, 31c

Technical File Identification Number: N/A

8. Where applicable, description of accessories and components, including software, which allow the radio equipment to operate as intended and covered by the EU declaration of conformity.

User instructions are provided in the User Manual. The Software and Hardware versions are specified above.

9. Additional Information: Referring to Article 10.2 of the Directive, this equipment is so constructed that it can be operated in all Member States, without infringing applicable requirements on the use of radio spectrum.

Referring to Article 10.10 of the Directive, there are no restrictions on putting this equipment into service or of requirements for authorisation of use. Please refer to the User Manual for details.

On behalf of:

Manufacturer: TECNO MOBILE LIMITED

Address: FLAT N 16/F BLOCK B UNIVERSAL INDUSTRIAL CENTRE 19-25 SHAN MEI STREET FO TAN NT HONGKONG

(place and date of issue): Shenzhen, 2024-09-02

(name, function): YangDaxuan/Manager

(signature):

(Name and signature of person responsible)