



# QUICK START GUIDE

TEMPERATURE SENSOR



TS30x

## 1. Packing List

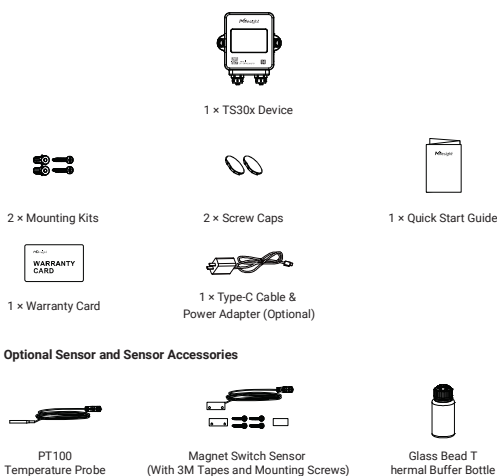

## 2. Hardware Introduction

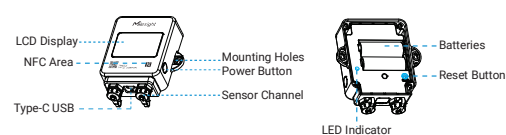

## 3. Button Descriptions

### Power Button

Function	Action	LCD Display
Power On/Off	Press and hold the power button for more than 3 seconds	Power On: All icons show 3s Power Off: Off
Update Temperature	Quick press the power button once	Fresh the latest temperature of the current channel
Switch Temperature Display (TS302 with both temperature sensors only)	Quick press the power button twice	Display another channel's latest temperature

### Reset Button

Function	Action	LED Indicator
Reset to Factory Default	Press and hold the reset button for more than 10 seconds	Blinks quickly



Quick Start Guide



Cloud App



All software & files can be downloaded from <https://www.milesight.com/iot/resources/download-center/#documents>

## Better Inside, More in Sight

Milesight IoT Co., Ltd. | [www.milesight.com](http://www.milesight.com)

ADD: Building C09, Software Park Phase III,  
Xiamen 361024, Fujian, China

#### 4. Configuration Guide

##### Method 1: Configured by NFC

1. Download "Milesight ToolBox" App on an NFC-supported smartphone.
2. Open "Milesight ToolBox" App and attach the NFC area of the smartphone to the device. Click "NFC Read" to read the device and click "Write" to configure the device settings. It's suggested to change the default password for security reasons. (Default password: 123456)



##### Method 2: Configured by USB

1. Download ToolBox software from Milesight official website.
2. Remove the USB waterproof plug from the bottom of the device, and connect it to the computer via a type-C USB cable. After connected, the PDF file can be exported directly from the USB drive folder.
3. Open ToolBox software, select type as "General" and select the serial port as USB port, then type the login password (Default password: 123456) to login device to check and configure device. It's suggested to change the default password for security reasons.



#### 5. Installation

##### Device Installation

1. Fix the wall plugs to a flat surface according to the device mounting holes, then secure the device to the wall plugs using screws. When installing, please ensure the LCD display is positioned vertically on the ground below eye level for clear visibility of the content.
2. Cover the screws with cover caps.

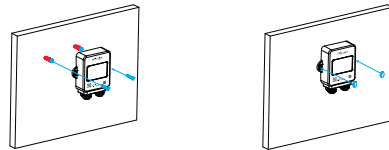

##### Magnet Switch Installation

Fix the two magnet parts with 3M tape or screws, the two parts should be aligned.

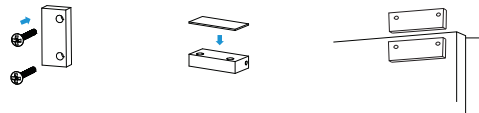

Fixed by Screws

Fixed by 3M Tape

Installation Example

#### Thermal Buffer Bottle

It is necessary to unplug the stopper inside the bottle cap, then restore the cap and insert the PT100 probe into the bottle. When using, it can be placed in places like freezers and refrigerators to ensure more accurate temperature measurement.

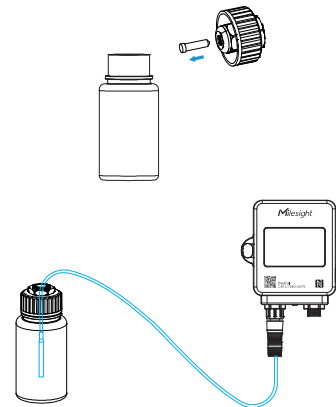

#### 6. FCC Statement

Any changes or modifications not expressly approved by the party responsible for compliance could void the user's authority to operate the equipment.

This device complies with part 15 of the FCC Rules. Operation is subject to the following two conditions:

- (1) This device may not cause harmful interference, and.
- (2) This device must accept any interference received, including interference that may cause undesired operation.

**Note:** This equipment has been tested and found to comply with the limits for a Class B digital device, pursuant to part 15 of the FCC Rules. These limits are designed to provide reasonable protection against harmful interference in a residential installation. This equipment generates, uses and can radiate radio frequency energy and, if not installed and used in accordance with the instructions, may cause harmful interference to radio communications.

However, there is no guarantee that interference will not occur in a particular installation. If this equipment does cause harmful interference to radio or television reception, which can be determined by turning the equipment off and on, the user is encouraged to try to correct the interference by one or more of the following measures:

- Reorient or relocate the receiving antenna.
- Increase the separation between the equipment and receiver.
- Connect the equipment into an outlet on a circuit different from that to which the receiver is connected.
- Consult the dealer or an experienced radio/TV technician for help.

##### FCC Radiation Exposure Statement:

This equipment complies with FCC radiation exposure limits set forth for an uncontrolled environment. This equipment should be installed and operated with minimum distance 20cm between the radiator & your body. This transmitter must not be co-located or operating in conjunction with any other antenna or transmitter.