

# Dual Alarm Clock Radio With Bluetooth

User's Guide for Model CB360 v2530-01



## FCC WARNINGS

Warning: Changes or modifications to this unit not expressly approved by the party responsible for compliance could void the user's authority to operate the equipment.

NOTE: This equipment has been tested and found to comply with the limits for a Class B digital device, pursuant to Part 15 of the FCC Rules. These limits are designed to provide reasonable protection against harmful interference in a residential installation. This equipment generates, uses, and can radiate radio frequency energy and, if not installed and used in accordance with the instructions, may cause harmful interference to radio communications. However, there is no guarantee that interference will not occur in a particular installation. If this equipment does cause harmful interference to radio or television reception, which can be determined by turning the equipment off and on, the user is encouraged to try to correct the interference by one or more of the following measures:

- Reorient or relocate the receiving antenna.
- Increase the separation between the equipment and receiver.
- Connect the equipment into an outlet on a circuit different from that to which the receiver is connected.
- Consult the dealer or an experienced radio/TV technician for help.

## ADDITIONAL WARNINGS AND PRECAUTIONS

- **CAUTION:** TO PREVENT ELECTRIC SHOCK, MATCH WIDE BLADE OF PLUG TO WIDE SLOT, FULLY INSERT.
- Mains plug is used as disconnect device and it should remain readily operable during intended use. In order to disconnect the apparatus from the mains completely, the mains plug should be disconnected from the mains socket outlet completely.
- Caution marking is located at the rear or bottom of the apparatus.
- **WARNING:** To reduce the risk of fire or electric shock, do not expose this apparatus to rain, moisture, dripping, or splashing.

- **CAUTION:** Use of controls or adjustments or performance of procedures other than those specified may result in hazardous radiation exposure.
- **WARNING:** Changes or modifications to this unit not expressly approved by the party responsible for compliance could void the user's authority to operate the equipment.
- **WARNING:** Do not place this unit directly onto furniture surfaces with any type of soft, porous, or sensitive finish. As with any rubber compound made with oils, the feet could cause marks or staining where the feet reside. We recommend using a protective barrier such as a cloth or a piece of glass between the unit and the surface to reduce the risk of damage and/or staining.
- **CAUTION:** Danger of explosion if battery is incorrectly replaced. Replace only with the same or equivalent type.
- **WARNING:** Shock hazard - Do Not Open.
- Battery shall not be exposed to excessive heat such as sunshine, fire or the like.
- Keep new and used batteries away from children. If the battery compartment does not close securely, stop using the product and keep it away from children.
- **WARNING: DO NOT INGEST BATTERY, CHEMICAL BURN HAZARD.** If you think batteries might have been swallowed or placed inside any part of the body, seek immediate medical attention.
- If the coin/button cell battery supplied with this product is swallowed, it can cause severe internal burns in just 2 hours and can lead to death.
- Completely replace all old batteries with new ones.
- Batteries should be recycled or disposed of as per state and local guidelines.



**WARNING :** This product can expose you to chemicals including lead, which is known to the State of California to cause cancer and birth defects or other reproductive harm. For more information go to [www.P65Warnings.ca.gov](http://www.P65Warnings.ca.gov). **This product meets and complies with required Federal product guidelines.**

## Overview

### Features

- Bluetooth 5.0
- Voice assistant
- 1.4" green LED display
- Dual alarm
- Sleep timer
- Dimmer Control - Hi/Low
- Digital FM Radio
- USB charging port (5V 1A) for charging external devices
- DC power input: requires AC/DC power adapter (included)
- Battery back up

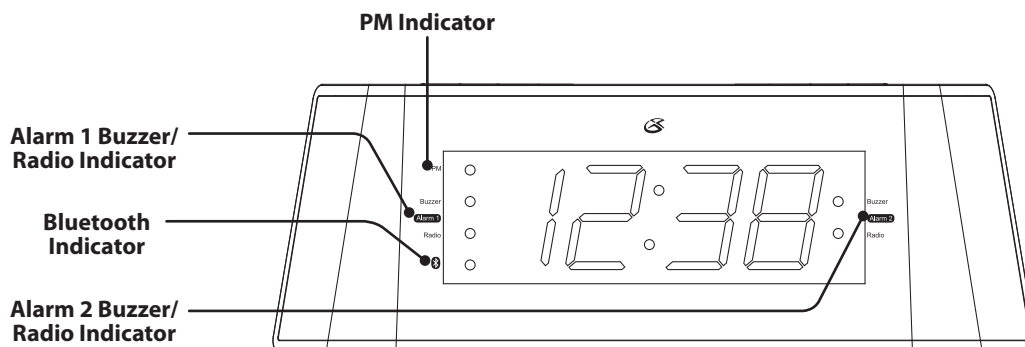

**Power/Source**  
Press power ON. Press and hold to power OFF.  
Press to change source between FM, Bluetooth (power on).

**Time Set/Preset**  
Press and hold to begin setting the clock (RADIO OFF).  
Press and hold to set preset stations (RADIO ON), then press repeatedly to select preset 1-10 (power on).

**Volume**  
Press to adjust volume.

**Snooze/Sleep/Dimmer**  
Press to snooze the alarm after it sounds.  
Press repeatedly to set the sleep timer.  
Press and hold to dim the display.

**Microphones**

**Alarm Set/AL 1/AL 2**  
Press and hold to start setting alarm (Radio off).  
Press to switch between AL 1, AL 2, Radio, Buzzer (Radio off).

**Play/Pause/Pair**  
Press to Play/Pause. Press and hold to enter into pairing mode.

**Tuning/Min/Hour**  
Press to Tune the radio.  
Press to adjust the minute or hour when setting the clock or alarm (RADIO OFF).

**Backup Battery Compartment**

**Speaker**

**USB Charging Port**

**FM Antenna**

**DC Power Input**

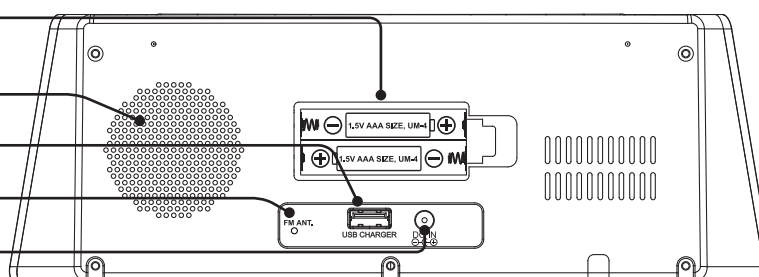

## Power, Battery Backup, and Charging

To power the unit, plug the AC/DC power adapter (included) into the DC power port on the rear of the unit and a standard AC power outlet.

Battery backup is used to save the time on the clock, in the event of a power failure. Requires 2 AA batteries (not included).

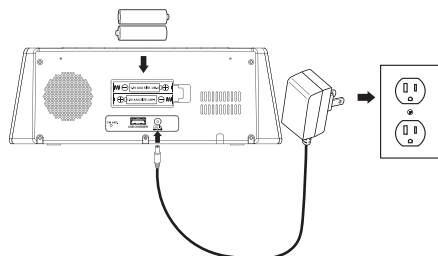

Charge a phone or mobile device using a USB charging cable (not included) and connect it to the USB charging port on the rear of the unit. **Note:** this USB charging port is not suitable for charging tablets. **Power output: 5V 1A only.**

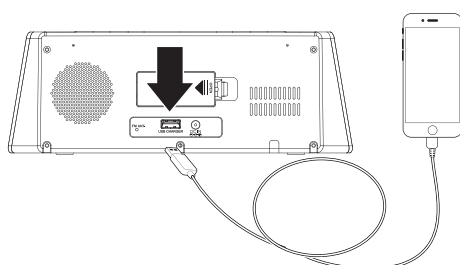

## Bluetooth Wireless

### Pairing to a Bluetooth Device and Playing Audio

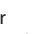
- When powered on, the clock will automatically enter into **Bluetooth mode**. The  symbol on the display will begin flashing and a voice prompt will sound from the speaker. *When pairing, remain within 3 feet of the unit.*
- Using the controls on your Bluetooth device, select **CB360** from your Bluetooth settings to pair. When successfully paired, the  symbol on the display will turn solid and a voice prompt will sound. *You can refer to the user's manual for your specific device for instructions on pairing and connecting Bluetooth devices.*
- Audio played through the connected Bluetooth device should now be heard through the speakers. Use the controls on the connected Bluetooth device to select and begin playing audio. Play, pause or skip audio using the controls on the connected device.
- After initial pairing, the unit will stay paired unless unpaired manually by the user or erased due to a reset of the device. Note: If your device should become unpaired or you find it is unable to connect, press & hold the **Play/Pause/Pair** button to enter into Pairing Mode. A voice will announce "Bluetooth is connecting" and you can connect to the speaker manually.
- Note: The clock time will automatically be updated to match your phone's time when connected. If using an iPhone, access your Bluetooth settings menu, select CB360 and turn on "Show Notifications" to synch your phone's time to the clock.**

## Voice Assistant

When your mobile phone is connected to the clock via Bluetooth, you can use voice assistant.

- Pair your phone to the clock (see Bluetooth section above). **Note: If using an iPhone, access your Bluetooth settings menu, select CB360 and turn on "Show Notifications" this is the only way to synch your iPhone's time to the clock.**
- The clock's time will automatically update to the time on the connected phone and the voice assistant may be used.

## International Support

To download this User's Guide in English, Spanish, or French, or to get answers to frequently asked questions, visit the support section at: [www.gpx.com](http://www.gpx.com)

Para descargar este Manual del Usuario en inglés, español y francés, o para obtener respuestas a preguntas frecuentes, visite la sección de apoyo en: [www.gpx.com](http://www.gpx.com)

Pour télécharger ce guide de l'utilisateur en anglais, espagnol ou français, ou pour obtenir des réponses à des questions fréquemment posées, consultez la rubrique d'assistance sur: [www.gpx.com](http://www.gpx.com)

For Warranty Information and the most up-to-date version of this User's Guide, go to [www.gpx.com](http://www.gpx.com)

**Customer Service:** 1-888-999-4215 | **Email Support:** [prodinfo@dpiinc.com](mailto:prodinfo@dpiinc.com) | **Email Parts:** [partsinfo@dpiinc.com](mailto:partsinfo@dpiinc.com)

Copyright © 2020 Digital Products International (DPI, Inc.) All other trademarks appearing herein are the property of their respective owners. Specifications are subject to change without notice.

## Clock

### To Set the Clock Manually

- With the radio off, press and hold the **Time Set** button until the display begins flashing.
- Press the **Hour/Min** buttons to adjust the time. Note the **PM indicator**.
- Press the **Time Set** button again to finish.

## Alarm and Sleep Timer

### Setting the Alarm

- With the radio off, press and hold the **Alarm Set** button to set the time for Alarm 1 or/ and Alarm 2.
- The display will flash and show the time the Alarm 1 is set to go off. Press the **Hour/Min** buttons to adjust the time. Note the **PM indicator**.
- Once you have set your desired time, press the **Alarm Set** button to confirm.
- After the alarm time is set, select the alarm type (Buzzer or Radio) by pressing the **Hour/Min** buttons.
- Press **Alarm Set** to confirm.
- Then the display will flash and show the time Alarm 2 is set to go off. Press the **Hour/Min** buttons to adjust the time. Note the **PM indicator**.
- Once you have set your desired time, press the **Alarm Set** button to set.
- After the alarm time is set, select the alarm type (Buzzer or Radio) by press the **Hour/Min** buttons.
- Press **Alarm Set** to confirm.

### Disabling the Alarm

- Press the **Alarm Set** button until the alarm indicator is no longer lit.

### Snooze and Alarm Reset

After the alarm sounds:

- Press the **Snooze/Sleep** button to delay the alarm for 9 minutes.
- Press the **Power** button to turn the alarm off until the set alarm time is reached again.

### Setting the Sleep Timer

- Press the **Sleep** button repeatedly to set the sleep timer. *Timer duration is displayed in minutes.*
- Once the set sleep time has expired the alarm will sound, then the unit automatically power off.

## FM Radio

The clock radio is equipped with an FM wire. To improve radio reception, adjust the FM wire of the clock radio.

### Tuning the Radio

- Press the **Power** button to power the clock radio ON, then press again to select **FM Mode**.
- Press the **Tuning +/-** buttons to adjust the radio to the desired frequency.
- Press and hold the **Tuning +/-** buttons to scan for available frequencies.
- Press the **Volume +/-** buttons to adjust the volume.
- Press the **Power** to turn the radio off.

### Saving Radio Presets

- Tune to the desired FM frequency (see above steps).
- Press and hold the **Preset** button. The display will begin flashing a preset. Ex: "P01".
- Press the **Tuning +/-** buttons to select the preset to be saved. (P01 to P10).
- Press the **Preset** button to save that preset.
- With the radio ON, press the **Preset buttons** to cycle through radio presets to cycle through radio presets.

