

# Operation and Maintenance Manual



## Radio-control System (RCS-FT1) for Boom Truck Series

---

**⚠ CAUTION:** Read this manual before operating.  
Save this manual for future reference.

## Safety Caution



### Warning



Incorrect operation and inspection/maintenance of the crane is very dangerous, causing bodily accidents such as death or serious injury. Before using the crane, carefully read the operation and maintenance manual of the crane and this manual so that you fully understand them. Never operate and inspect/maintain the crane until you fully understand the manuals.

### FCC NOTICE

This device complies with Part 15 of the FCC Rules. Operation is subject to the following two conditions:

- (1) This device may not cause harmful interference, and
- (2) This device must accept any interference received, including interference that may cause undesired operation.

#### (1) Do not remove the certificate label.

The purpose of the certificate label on the radio-control system is to certify that the device conforms to the Radio Law. Using a system without the certificate label is illegal. Do not remove the certificate label.

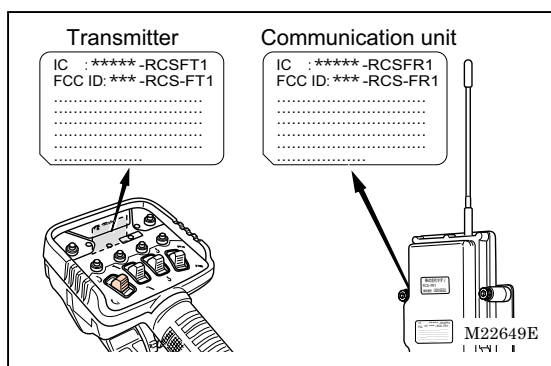

#### (2) Dismantling/modification is prohibited.

Do not dismantle or modify the radio-control system. Dismantling or modifying the radio-control system is illegal and punishable.

Request a repair at the nearest TADANO distributor or dealer if the radio-control system has a problem.

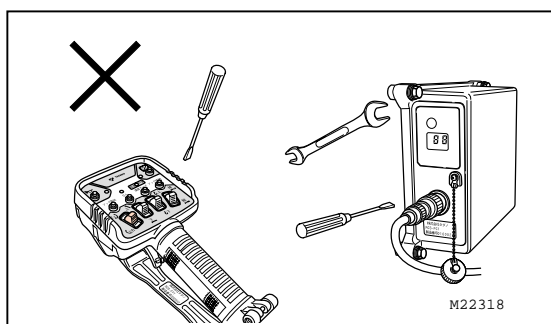

**(3) Always keep the transmitter clean.**

When the transmitter gets dusty or dirty, wipe the dust or dirt away with a dry soft cloth.

The attached dust or dirt may give unfavorable impact on operations of the motion selection switches or speed control lever, causing operation failures or malfunctions of the crane.

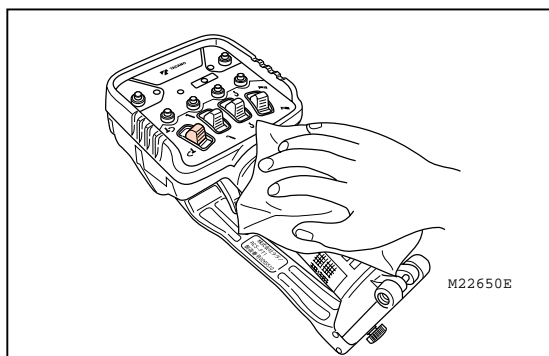
**(4) Handle the transmitter with care.**

Do not throw or drop the transmitter, as a strong shock may cause damage or failure.

When you carry the transmitter with you, do not drop it. Hang the transmitter onto a portable hook or use an extended strap to hang the transmitter from your neck.

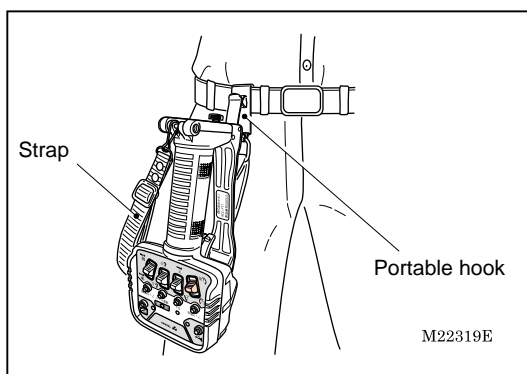
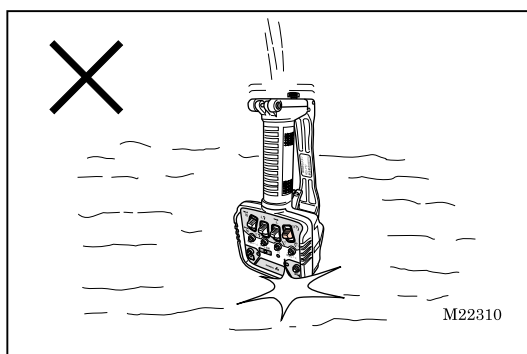
**(5) Store the transmitter in a safe place.**

Store the radio-control transmitter in a safe place after replacing it back into the transmitter-storing bag. Do not leave or store it in a place exposed to sunlight or rain or a place with a high temperature or high humidity.

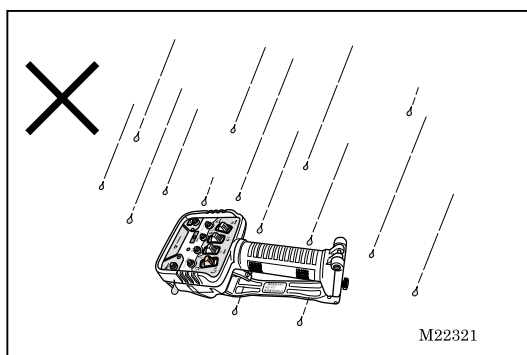

**(6) Remove the batteries of the radio-control transmitter when not in use for a long time.**

Remove the batteries of the transmitter when the transmitter is not used for a long time, as the batteries may leak if not removed.

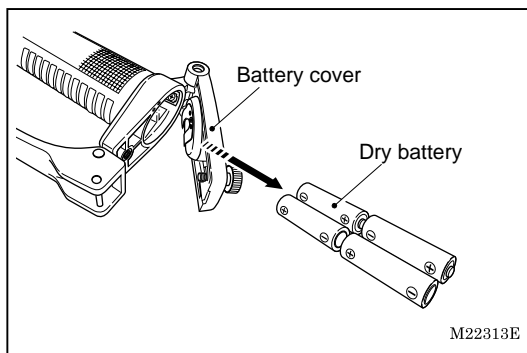

**(7) High pressure cleaning is prohibited.**

Electric devices, such as control unit and communication unit, may develop trouble if water enters inside them. Please do not clean the electric devices with high pressure.

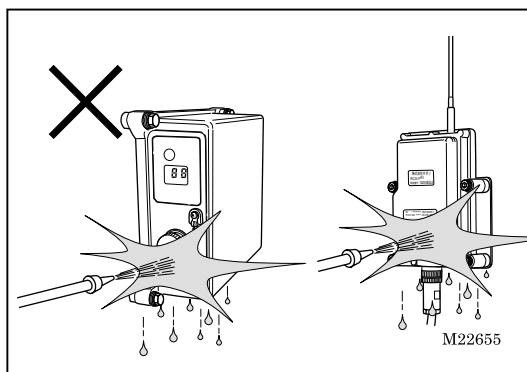

**(8) Pay attention to surrounding conditions.**

It is dangerous if your attention is paid only to lifted cargos.

Also pay full attention to the conditions of the main unit of the crane.

Especially, be careful with a vehicle turnover.

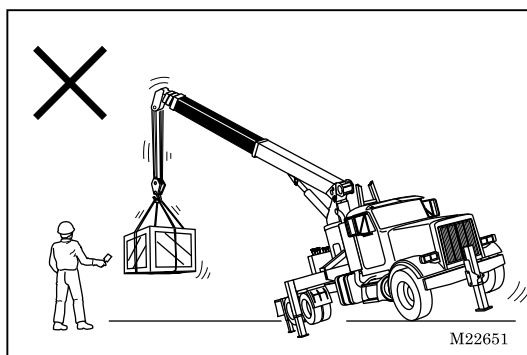

**(9) Keep the lifted cargo weight lower than the rated lifting capacity for empty chassis.**

Be careful with overloading to prevent accidents.

### (10) Be careful with radio wave conditions.

Since the radio-control system uses radio waves, it cannot avoid influences of electromagnetic interference, radio interference and exogenous noise. Such influences may hinder the radio wave transmission, stopping the crane operation.

Stopping of the crane during the operation may cause dangers. It is especially dangerous during a swing operation of the crane. Pay attention to the following when operating the radio-control system.

- It is dangerous to operate the crane under conditions with low radio wave transmission, especially during a swing operation of the crane since the crane intermittently moves. Before starting the operation, confirm that there is no problem in the crane operation under no load condition.
- Too large a distance between the transmitter and communication unit may not only hinder the radio wave transmission but also increase influences of noise. Normally, operate within the operating radius of the crane.
- Obstacles such as wire nettings and metal doors between the transmitter and communication unit may hinder the radio wave transmission.
- Use manual control operation under unfavorable radio transmission conditions.
- Noise from a vehicle's air-conditioner used during the operation may cause an intermittent crane operation. Refrain from using an air-conditioner when its noise influences the radio-control operation.
- Noise from an approaching motorcycle to the operation site may cause an intermittent crane operation. Confirm that there is no motorcycle approaching during the operation.

