

## User Manual

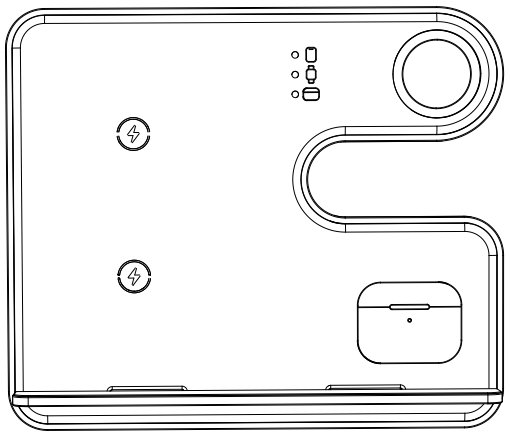

Please read the instructions carefully before using

English   

This product is a 3 in 1 multi-functional wireless charging station, which supports fast charging for phone, Watch and earphone at the same time, it provides high efficiency and stable wireless charging for you.

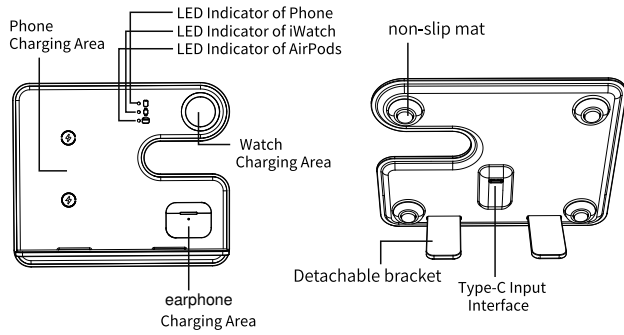

Assemble according to the instructions in the following diagram

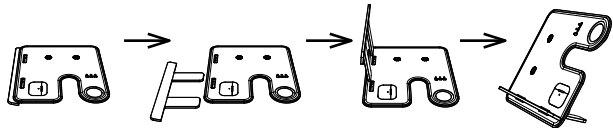

1. Use charging cable provided in the package to connect with the wireless charger, plug the adapter in the power supply.
2. Place the devices to be charged in the corresponding charging area, then it will start charging.

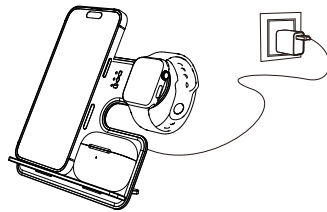

These 3 LED indicator lights will change according to the charging status of phone, iWatch and AirPods.

	Phone	iWatch	AirPods
<b>Power On</b>	Blue light breathing for 3 seconds	Blue light breathing for 3 seconds	Blue light breathing for 5 seconds
<b>Standby</b>	Turn off	Turn off	Turn off
<b>Charging</b>	Blue light turn on for 30 seconds and then turn off	Blue light turn on for 30 seconds and then turn off	Blue light turn on for 30 seconds and then turn off
<b>Completed</b>	Turn off	Turn off	Turn off
<b>FOD &amp; Error</b>	Blue light flashing	Blue light flashing	Blue light flashing

Input: 9V = 2A  
Phone Output: 15W/10W/7.5W/5W  
Earbuds Output: 3.0W  
Watch Output: 2.5W  
Input socket: Type-C  
Transmission Distance (for Phone): ≤4mm  
Product Size: 152\*136\*12mm(disassembled)

**1. Phone**  
Phone with wireless charging function and compatible with charging protocol

- 2. iWatch**  
Apple Watch 9/8/7/6/5/4/3/2/SE 2/SE/Ultra/Ultra 2
- 3. AirPods**  
AirPods Charging: for AirPods 2/3/Pro/Pro2(can work with A2700, A2566, A2190, A1938 AirPods case)

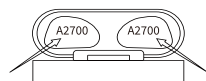

Note: Does not support A2897, A1602 AirPods case

A: Please check the following steps:

1. Please make sure your devices have wireless charging function and can be charged wirelessly.
2. Please use the adapter and cable provided in the package
3. Please check if the charging indicator light is on, if not, please unplug and reinsert the adapter and cable.
4. Please use other 18W adapter and charging cable to check if the adapter and cable are damaged.
5. Please make sure that the thickness of the phone case is <4mm (if there is a case) and there are no any metal, pop rings, credit cards or magnetic interference charges.
6. Please align the coil of your devices with the charging center.
7. Update your device to the latest system and restart the device.

**Q: What should I do if the charging is slow?**

A: Please check the following steps

1. Please make sure to use the 18W adapter and cable provided in the package.
2. Charging efficiency depends on the receiving power of your devices and it is not recommended to keep the APP running during slow charging.

**Q:** What should I do if the charger heats up during charging?

1. It is normal for the receiving coil or transmitter board to generate heat during wireless charging. If the charger is too hot please take your phone off from the charger to wait the charger to cool down and charge again.
2. It is recommended to avoid using the charger in high temperature and sun exposure environments as possible.



**Made in China**

This device complies with part 15 of the FCC Rules. Operation is subject to the following two conditions:

(1) This device may not cause harmful interference, and (2) this device must accept any interference received, including interference that may cause undesired operation.

Any Changes or modifications not expressly approved by the party responsible for compliance could void the user's authority to operate the equipment.

Note: This equipment has been tested and found to comply with the limits for Class B digital device, pursuant to part 15 of the FCC Rules. These limits are designed to provide reasonable protection against harmful interference in residential installation. This equipment generates uses and can radiate radiofrequency energy and it not installed and used in accordance with the instructions may cause harmful interference to radio communications. However, there is no guarantee that interference will not occur in a particular installation. If this equipment does cause harmful interference to radio or television reception, which can be determined by turning the equipment off and on, the user is encouraged to try to correct the interference by one or more of the following measures: Reorient or relocate the receiving antenna. Increase the separation between the equipment and receiver. Connect the equipment into an outlet on a circuit different from that to which the receiver is connected.

This device complies with Industry Canada's licence-exempt RSSs. Operation is subject to the following two conditions:

- (1) This device may not cause interference; and
- (2) This device must accept any interference, including interference that may cause undesired operation of the device.

Le matériel muni du ISED radiation exposure limits se fait pour un environnement contrôlé. Durant l'opération du dispositif, la distance de 10cm doit être maintenue autour du dispositif et au-dessus de la surface supérieure du dispositif.

Cet appareil est conforme aux CNR exemptes de licence d'Industrie Canada. Son fonctionnement est soumis aux deux conditions suivantes :

- ( 1 ) Ce dispositif ne peut causer d'interférences ; et
- ( 2 ) Ce dispositif doit accepter toute interférence , y compris les interférences qui peuvent causer un mauvais fonctionnement de l'appareil.

L'équipement respecte les limites d'exposition aux rayonnements ionisants fixées pour un environnement non contrôlé. Pendant le fonctionnement du dispositif, une distance de 10cm devrait être maintenue autour du dispositif et au-dessus de la surface supérieure du dispositif.