



**DEERC**

**14+**  
age

# Instructions For Use

## 日本語マニュアル

## Gebruiksaanweisungen

V1.0

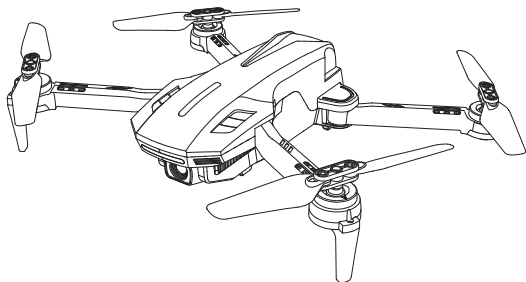

**D70**



usa@deerc.com (USA)

eu@deerc.com (EU)

jp@deerc.com (JP)



+1(855)777-8866



English	01-33
日本語	34-59
Deutsch	60-90

# Contents

Disclaimer & Warning .....	1
Safety Guidelines .....	1
Maintenance .....	5
Package Contents .....	6
Drone Details .....	7
Transmitter Functions .....	8
Joystick Mode .....	9
Preparation Before Flight	
Charging .....	10
Download App .....	11
Arms .....	11
Drone Battery .....	12
Propellers .....	13
Phone Holder .....	14
Flight	
Pairing .....	15
Connect to Wi-Fi .....	16
One Key Takeoff/Landing .....	17
Functions Details	
Take Photo/Record Video .....	18
Camera Angle Adjustment .....	18
High-Speed Rotation .....	19
Circle Fly .....	19
Speed Switch .....	20

Emergency Stop .....	20
360° Flip .....	21
Altitude-Hold Function .....	21
Headless Mode .....	22
Attitude Adjustment	
Trimmer .....	24
Calibrate the Gyro.....	25
Specification .....	26
Contact Us .....	27
General Information .....	28

## **DISCLAIMER & WARNING**

1. Please read this Disclaimer & Warning and Safety Guidelines carefully before using our product. This product is not recommended for people under the age of 14. By using this product, you hereby agree to this disclaimer and signify that you have read it fully. You agree that you are responsible for your own conduct and any damage caused while using this product, and any consequence. You agree to only use this product for its designed purposes and in accordance with the local laws, regulations and all applicable policies and guidelines that DEERC may provide.

2. When using this product, please be sure to strictly abide by the specification requirements and safety guidelines stated in this document. Any personal injury, property damage, legal disputes and all other adverse events caused by the violation of any of the safety instructions or due to any other factor, WILL NOT be DEERC's responsibility.

## **SAFETY GUIDELINES**

### **CHECK BEFORE USE**

- ① This product is a high precision drone that integrates various electronic stability and control mechanisms. Please be sure to configure this drone carefully and correctly to ensure safe, accident-free operation.
- ② Ensure that the batteries of the drone and transmitter are clean, undamaged, and fully charged before every use.
- ③ Ensure that all the propellers are undamaged and are installed in the correct orientation.

## SAFETY GUIDELINES

④ Please perform a thorough check of the product before each use. Inspect the integrity of the parts, any signs of cracks and wear off on the propellers, battery power and effectiveness of the indicator, etc. If there is any problem found after checking the drone, please refrain from using it until the problem is resolved.

### FLIGHT ENVIRONMENT



**Fly in Open Areas**

**Maintain Line  
of Sight**

**Fly Below  
131 ft (40 m)**



Avoid flying over or near obstacles, crowds, high voltage power lines, trees, airports or bodies of water.

DO NOT fly near strong electromagnetic sources such as power lines and base stations as it may affect the onboard compass.



DO NOT use this drone in adverse weather conditions such as rain, snow, fog, and wind.

# SAFETY GUIDELINES

## OPERATION REQUIREMENTS

- ① DO NOT use this product to follow any moving vehicles.
- ② During the flight, turn off the motors only in case of an emergency.
- ③ When the battery runs low, return the drone back to your starting point.
- ④ DO NOT use this product if you feel tired, take medicine or feel unwell and drink alcohol.
- ⑤ Be aware of the volume of noise that the drone produces. Please ensure to keep your distance to avoid ear damage.



- ⑥ **Stay away from the rotating propellers and motors.**



- ⑦ **DO NOT fly in any spaces where drones are prohibited. Please respect people's right to privacy by not flying your drone close to others.**

## USE OF BATTERY

- ① Please ensure batteries are fitted in the correct orientation as shown in the instruction manual.
- ② Avoid short circuits by fitting the batteries correctly, and do not crush or squeeze the batteries as this could cause the risk of a fire or explosion.
- ③ DO NOT mix new and old batteries as this can lead to a poor performance of the product.
- ④ Please dispose of used batteries carefully, do not litter and recycle where ever possible.
- ⑤ DO NOT expose dead batteries to heat or fire or they may explode.
- ⑥ If the device is not going to be used for an extended period of time, please remove batteries to prevent potential damage to the drone from battery leakage.

## SAFETY GUIDELINES

- ⑦ Only use the USB charging cable that comes with the drone to charge the battery.
- ⑧ DO NOT connect the battery directly to wall outlets or car cigarette lighter sockets as this will damage your battery since they have different voltages.
- ⑨ DO NOT attempt to disassemble or modify the battery in any way
- ⑩ DO NOT use the battery if it gives off an odor, generates heat, becomes discolored, deformed or appears abnormal in any way. If any of these situations occur while the battery is in use or being charged, remove it from the device or charger immediately and discontinue use.
- ⑪ DO NOT pierce the battery casing with a nail or any other sharp object, break it open with a hammer, or step on it! Dispose or recycle this battery as it may cause personal injury or damage to your drone.
- ⑫ Always charge the batteries on a fireproof surface and away from combustible materials. DO NOT charge on surfaces that can catch fire, which includes: wood, cloth, and carpet.
- ⑬ DO NOT immerse the battery in water or get it wet.
- ⑭ DO NOT solder the battery terminal in any way.
- ⑮ Keep batteries out of reach of children or pets.
- ⑯ DO NOT short-circuit the battery by connecting wires or any other metal object to the positive(+) and negative(-) terminals.



**Li-Po Battery Disposal & Recycling**

Waste Lithium-polymer batteries must not be placed with household trash. To dispose of waste batteries, please contact the local environmental or waste agencies, the supplier of your model, or your nearest Li-Po battery recycling center.





## MAINTENANCE

- ① Clean the drone after each use with a clean, soft cloth.
- ② Avoid prolonged exposure to direct sunlight and avoid buildup of heat on the drone or batteries.
- ③ This device is not waterproof and must not be submerged or subjected to water under any circumstance. Failure to keep the device completely dry may likely damage the unit permanently. Be aware that although it might be dry where you are, droplets of rain or mist from a river or waterfall could damage your drone where it is flying.
- ④ Frequently check the charging plug and other accessories for signs of damage. If any part of the device or cables are damaged, avoid using or charging until the damaged parts are replaced.

## PACKAGE CONTENTS

		
Drone	Transmitter	Drone Battery
		
USB Charging Cable	Propeller	Screwdriver
		
Dust Cover (For transmitter)	Phone Holder	Instructions For Use

## DRONE DETAILS

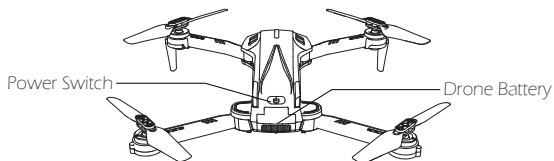
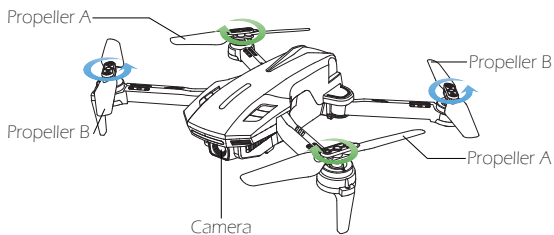

# TRANSMITTER FUNCTIONS

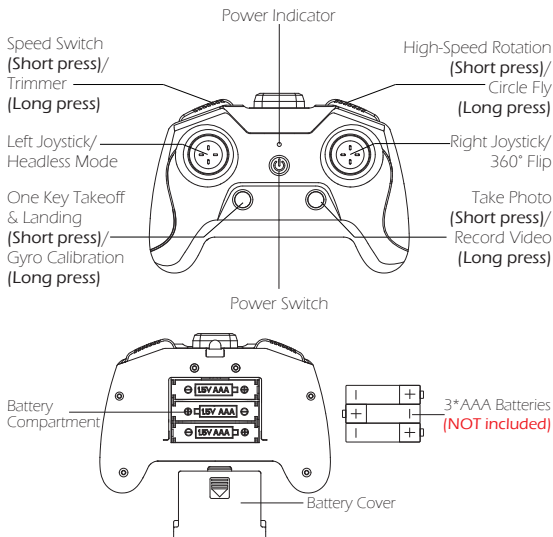

Open the battery cover on the back of the transmitter, insert the three AAA batteries (**Not included**) into the battery compartment. Then close the battery cover to complete the installation.

**\* Low Battery Signal:** The power indicator on the transmitter will flash and the transmitter will beep continuously.

**⚠ - Install batteries carefully.**

- Do not mix old and new batteries.

- Do not mix different types of batteries.

# JOYSTICK MODE

**MODE 2** (Left hand throttle MODE 2 will be the default setting.)

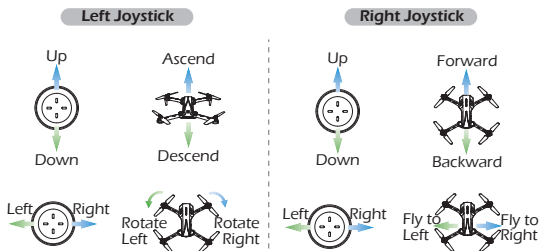

## MODE 1

To enter MODE 1, turn on the transmitter while holding the “Speed Switch/Trimmer” button. (Please do not release the “Speed Switch/Trimmer” button until the transmitter is powered on.)

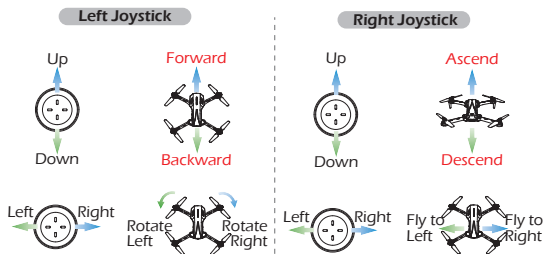

# PREPARATION BEFORE FLIGHT

## CHARGING

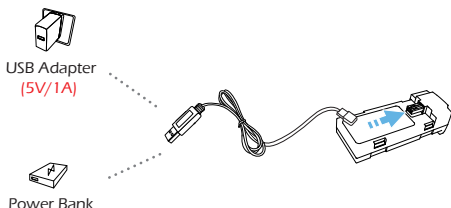

- ① Connect the the drone's battery with the USB Charging Cable.
- ② Plug the USB Charging Cable into a USB charging port on the power bank or USB adapter (5V/1A).
- ③ Charging time: about 70 minutes.
- ④ a. When the battery is charging, the indicator light on the USB Charging Cable is Red.  
b. When the battery is fully charged, the indicator light on the USB Charging Cable will turn Green.

**\* Low Battery Signal:** The indicator lights on the drone will flash continuously and the transmitter will beep during the flight.



- Before charging, please read the instructions in the "Use of Battery" section of the "Safety Guidelines" carefully!
- Please use the original charging cable to charge the battery.
- DO NOT charge the drone battery immediately after a flight as the temperature of the battery may be too high. Please wait until it cools down to room temperature before charging again.

# PREPARATION BEFORE FLIGHT

## DOWNLOAD APP



iOS



Android APP on Google Play

Scan the corresponding QR code and download the **Deerc FPV** app for free.

Required Operating Systems: **iOS 12.0 or later/Android 4.4 or later.**

## ARMS

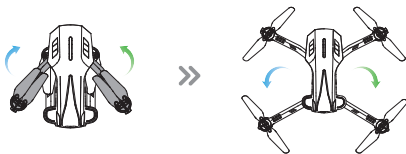

All arms of the drone are folded before the drone is packaged at the factory. First, unfold the front arms, then unfold the rear arms.

# PREPARATION BEFORE FLIGHT

## DRONE BATTERY

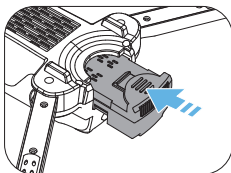

**Installation:** Push the battery into the battery compartment at the rear of the drone. Make sure that you hear a click sound, which indicates that the battery is firmly installed.



The battery should be installed firmly. Otherwise, the flight safety of your drone may be affected. The drone may crash due to a power cut during the flight.

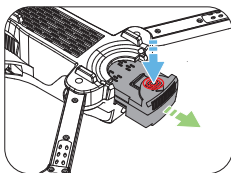

**Removal:** Press the lock button on the battery, and pull the battery out from the fuselage.



# PREPARATION BEFORE FLIGHT

## PROPELLERS

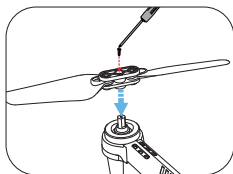
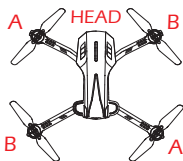

### Installation:

- ① An "A" or "B" is printed on the back of each propeller.
- ② Lock the propellers to the corresponding motor shafts (the motor shafts are also marked) with a screw.
- ③ Rotate each screw clockwise.

 - The propeller is installed before the drone is packaged at the factory.

- The drone will not fly unless the correct propeller is installed on the correct motor shaft.

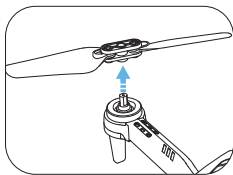
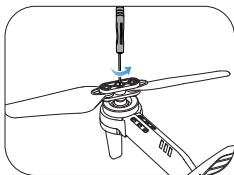

**Removal:** For propeller removal, use a screwdriver (provided) to rotate counter-clockwise and remove the propellers.

## PREPARATION BEFORE FLIGHT

### PHONE HOLDER

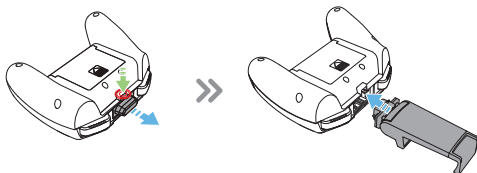

- ① Remove the dust cover.
- ② Insert the phone holder into a slot on the top of the transmitter.



- ③ The phone holder can be adjusted to an angle you like.

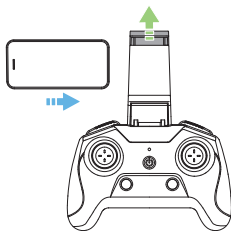

- ④ Open the phone holder and put your phone in.

# FLIGHT

All of the following operations in this manual use **MODE 2**.

\* If you use the transmitter to control the drone first, the APP will not be able to control it. Conversely, if you use the APP to control the drone first, the transmitter and the drone will not be paired.

## PAIRING

① Long press the Power Switch Button to turn on the drone. The drone indicators start flashing.

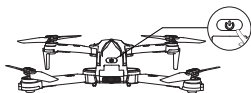

② Place the drone on a flat and level surface, with its head facing forward and its tail pointing towards the pilot.

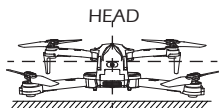

③ Short press the Power Switch to turn on the transmitter. Once the transmitter sends out a long beep and the Power Indicator changes from blinking to solid, the drone will be paired with the transmitter.

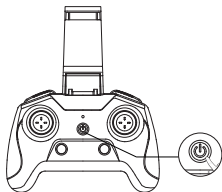

# FLIGHT

## CONNECT TO WI-FI

Connect your phone to the Wi-Fi network created by the drone. You can check the drone's status on the **Deerc FPV** App.

① Make sure to turn off Bluetooth, Mobile Data, and VPN. Enter your phone's Wi-Fi settings and click Wi-Fi to search for the Wi-Fi of the drone. (Make sure to turn on the drone before going to the Wi-Fi settings on your phone)

② Select the Wi-Fi network: **DeercFPV-\*\*\*\*\***.

③ Wait for a couple of seconds for your phone to connect to the drone's Wi-Fi.

④ Enter the **Deerc FPV** application.

> The connection between your phone and the drone is established automatically.





Because the Wi-Fi network created by the drone cannot access the Internet, your phone may inform you in various ways, like saying the connection isn't secure, or there is no internet connection, etc. Please ignore these messages. Or, in the case of getting Pop-ups, choose the option that allows you to stay with the current Wi-Fi.

# FLIGHT

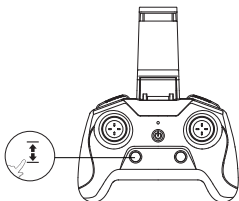
## ONE KEY TAKEOFF/LANDING





- ① **Unlock:** Short press the (  ) button to unlock the motors.
- ② **Takeoff:** Short press the same button again, the drone will automatically take off and hover at 4 ft. At this time, you can control this drone by using the joysticks.
- ③ **Landing:** When the drone is flying, short press the (  ) button, and the drone will automatically land on the ground.

-  - You must keep your drone in visual line of sight all the time. If you can't see it, you can't control it.
- Pull the left joystick down to the bottom, and the motors will stop spinning. The drone is thus locked.

## FUNCTIONS DETAILS

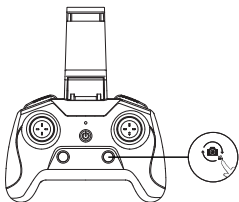
### TAKE PHOTO/RECORD VIDEO



**Take Photo:** Short press the (  ) button on the transmitter to take pictures. The transmitter will beep once, and the drone's indicator will flash once. This indicates that the camera has successfully taken a picture.

**Record Video:** Long press the (  ) button on the transmitter to record videos. The transmitter will long beep once, which indicates that the camera has started recording video. Long press again to exit the recording. (You will hear two beeps from the transmitter.)

### CAMERA ANGLE ADJUSTMENT

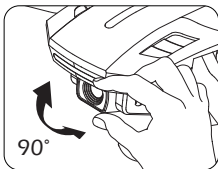

You can adjust the camera's shooting angle by rotating the camera manually. (The camera has a 90° tilt range.)

## FUNCTIONS DETAILS

### HIGH-SPEED ROTATION

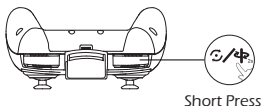

Short press the (  ) button, the transmitter will beep once, the drone begins to rotate quickly. The drone will exit the High-Speed Rotation function automatically after 10 seconds, or you can also push the right joystick in any direction to stop the rotation.

### CIRCLE FLY

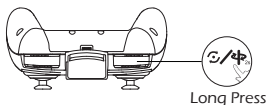
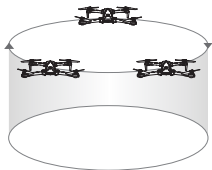

Long press the (  ) button, the transmitter will make a long beep, which indicates that the drone has entered the Circle Fly function. The drone will exit the Circle Fly Rotation function automatically after 10 seconds, or you can also push the right joystick in any direction to stop the Circle Fly.

## FUNCTIONS DETAILS

### SPEED SWITCH

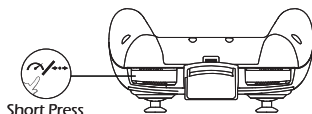

This drone comes with 3 speed modes (Low/Medium/High). Short press the (  ) button to switch between low, medium, and high speed. The transmitter beeps once to indicate Low Speed, beeps twice to indicate Medium Speed and beeps three times to indicate High Speed. (The Low Speed is the default speed mode.)

### EMERGENCY STOP

 The Emergency Stop function should only be used in case of emergency during the flight to avoid any damage or injury.

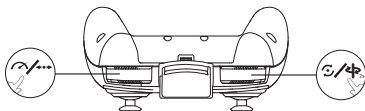

Short press the upper left and upper right buttons of the transmitter at the same time, the motors will stop immediately. Be aware that you risk breakage of the drone if it falls a large distance or hits anything at a high rate of speed.



## FUNCTIONS DETAILS

### 360° FLIP

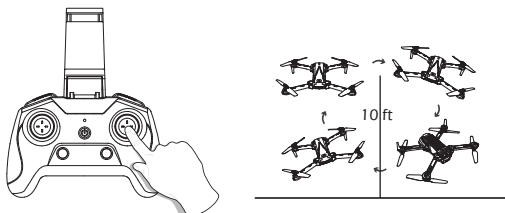

When you get familiar with all the functions of the drone, you can try this amazing flip mode. When the drone is at least 10ft from the ground. Press down on the right joystick, then push the right joystick forward/backward or leftward/rightward. The drone will do a flip toward the corresponding direction.



**360° Flip functions better when the battery is fully charged.**

### ALTITUDE-HOLD FUNCTION

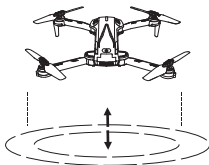

The drone is designed with altitude-hold function so the drone can maintain its altitude after you release the left joystick (the left joystick will automatically spring back to the middle).

## FUNCTIONS DETAILS

### HEADLESS MODE

The Headless Mode is a great training tool for beginner pilots. It is also useful when the drone is too far from the pilot (which makes it difficult to tell its orientation). It keeps the drone traveling forward, backward, left, or right when you move the right joystick in those directions, regardless of which way the front of the head of the drone points to.

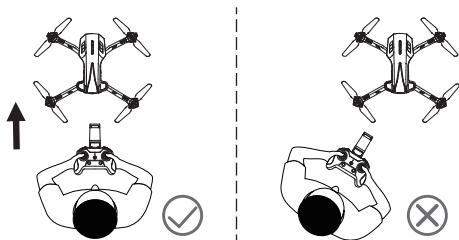

**The pilot should stay facing the same direction that the drone's head points to when it takes off.**



**Entering:** Press down on the left joystick on the transmitter. The transmitter will beep continuously, which indicates the drone is in Headless Mode.

**Exiting:** Press down on the left joystick again, and you will hear two beeps which indicates the drone exits the Headless Mode.

## FUNCTIONS DETAILS

### \* Why is the orientation of the drone important?

In normal flying mode, the control of the drone movement can sometimes be counter-intuitive for beginners. For instance, when the drone is in the air with its head pointing to your right, if you push the right joystick forward, the drone will fly to your right, instead of flying forward.

With the headless mode, the drone has a fixed "head." In Headless Mode, the drone always remembers the side its head points to during takeoff as the front side. This means that if the drone takes off with its head pointing forward, it doesn't matter how the drone is oriented in the air, when you push the right joystick forward, the drone will fly forward. Or, when its head is pointing to you, if you push the right joystick to the left, the drone will fly to your left.

# ATTITUDE ADJUSTMENT

## TRIMMER

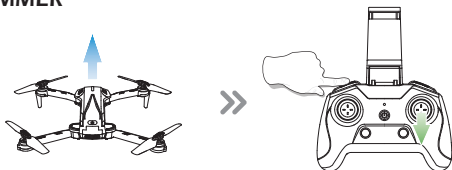

### The Forward Trim

If the drone tends to drift forward:

1. Press down the (  ) button and do not release it.
2. At the same time, push the right joystick backward one time.
3. Depending on how the drone drifts, it may take several pushes to balance the drone.
4. After each push, wait 2 seconds to watch the drone's movement. If it still drifts, push the joystick backward again.
5. Repeat STEP 4 until the drone drifts forward no more.

\* You can also fix the Backward/Sideward Trim using a similar method, i.e., pushing the right joystick to the direction opposite the drift.

 Trim adjustments are designed to counter drifts not caused by airflow.

# ATTITUDE ADJUSTMENT

## CALIBRATE THE GYRO



Make sure to place the drone on a level surface before calibrating the gyro. Long press the Gyro Calibration button for 2 Seconds to calibrate the gyro. The transmitter will send out a long beep which indicates the calibration is completed.



**ONLY use this function when:**

1. There is no influence of air flow, AND
2. You CANNOT fix the drift using the trimmer function.

## SPECIFICATIONS

### DRONE

Model: D70

Weight: 94g/3.3oz

Max Flight Time: 11 minutes (per battery)

Motor Model: 716

Operating Temperature Range: 32° to 104°F (0° to 40°C)

Size: 236×200×48mm (Unfolded)

126×79×48mm (Folded)

### DRONE BATTERY

Capacity: 800mAh

Voltage: 3.7V

Battery Type: Lithium-ion Polymer Battery

Charging Temperature Range: 41° to 104°F (5° to 40°C)

Charging Time: 70 minutes (depends on charging power and remaining battery power)

### TRANSMITTER

Operating Frequency: 2452-2474 MHz

Flight Distance: 131 ft (outdoors and unobstructed)

Operating Temperature Range: 32° to 104°F (0° to 40°C)

Battery Type: 3\*1.5V AAA Battery (Not included)

## SPECIFICATIONS

### CAMERA

Operating Frequency: 2417 MHz

Photo Resolution: 1280×720P

Video Resolution: 1280×720P@20fps

Transmission Distance: 98 ft(outdoor and unobstructed)

Photo Formats: JPEG

Video Formats: AVI/MP4

Operating Temperature Range: 32° to 104°F (0° to 40°C)

### USB CHARGING CABLE

Input: 5V/1A

Rated Power: ≤5 W

## CONTACT US

Please do not hesitate to contact us if you need further support.



4:00 PM ~ 7:00 AM (PST)



usa@deerc.com (USA)

eu@deerc.com (EU)

jp@deerc.com (JP)



+1(855)777-8866



For online support, please scan  
this code with Live Chat.

## GENERAL INFORMATION

### FCC Notice:

This device complies with Part 15 of the FCC Rules.

Operation is subject to the following two conditions:

- (1) This device may not cause harmful interference, and
- (2) This device must accept any interference received, including interference that may cause undesired operation.

The Supplier's Declaration of Conformity is available at the following address:

[https://www.deerc.com/Download/US/D70\\_FCC\\_sDoC.pdf](https://www.deerc.com/Download/US/D70_FCC_sDoC.pdf).

NOTE: This equipment has been tested and found to comply with the limits for a Class B digital device, pursuant to Part 15 of the FCC Rules. These limits are set to provide reasonable protection against harmful interference in a residential installation. This equipment generates uses and can radiate radio frequency energy, if not installed and used in accordance with the instructions, it may cause harmful interference to radio communications. However, there is no guarantee that interference will not occur in a particular installation. If this equipment does cause harmful interference to radio or television reception, which can not be determined by turning the equipment off and on, the user is encouraged to try one or more of the following measures:

- Reorient or relocate the receiving antenna.
- Separation more distance between the equipment and receiver.
- Connect the equipment to an outlet on a circuit different from the receiver.
- Consult the dealer or an experienced radio/TV technician for help.



## GENERAL INFORMATION

**WARNING:** Changes or modifications not expressly approved by the party responsible for compliance could void the user's authority to operate the equipment.

### RF Exposure

The equipment complies with FCC radiation exposure limits set forth for an uncontrolled environment. This device should be installed and operated with minimum distance 20cm between the radiator & your body.

### IC Notice:

This device complies with Canada Industry licence-exempt RSS standard (s).

Operation is subject to the following two conditions:

- (1) this device may not cause interference; and
- (2) this device must accept any interference. Including interference that may cause undesired operation of the device.

### CAN ICES-003 (B)

#### Avis d'Industrie Canada

Le présent appareil est conforme aux CNR d'industrie Canada applicables aux appareils radio exem pts de licence L'exploitation est autorisée aux deux conditions suivantes:

- 1) l'appareil ne doit pas produire de brouillage; et
- 2) l'utilisateur de l'appareil doit accepter brouillage radioélectrique subi même si le brouillage est susceptible d'encompromettre le fonctionnement. mauvais fonctionnement de l'appareil. Cet appareil numérique de la classe B est conforme à la norme NMB-003 du Canada.

## GENERAL INFORMATION

CAN NMB-003 (B)

RF Exposure

Radiation Exposure Statement:

This equipment complies with IC radiation exposure limits set forth for an uncontrolled environment. This equipment should be installed and operated with a minimum distance of 20cm between the radiator & your body.

Déclaration d'exposition aux radiations:

Cet équipement est conforme aux limites d'exposition aux rayonnements IC établies pour un environnement non contrôlé. Cet équipement doit être installé et utilisé avec un minimum de 20 cm de distance entre la source de rayonnement et votre corps.

### HOW TO RECYCLE THIS PRODUCT

This symbol on the product or its documentation indicates that it **MUST** not be disposed of together with household waste.

Uncontrolled waste disposal may harm the environment or human health.

Please separate your device from other types of waste for recycling it responsibly.

This will help to foster the sustainable re-use of material resources.

We suggest you contact your retailer, inquire at your local town hall or business store to find out where and how the drone can be recycled.



## GENERAL INFORMATION

### BATTERY WARNING:

1. Failure to follow all the instructions may result in serious injury, irreparable damage to the battery may cause a fire, smoke or explosion as well.
2. Always check the battery's condition before charging or using it.
3. Please replace the battery if the battery is dropped or has any peculiar smell, overheating, discoloration, deformation or leakage happens.
4. Never use anything other than the approved LiPo charger to charge the battery. Always use a balancing charger for LiPo cells or a LiPo cell balancer. It is recommended that you use the one provided with the product.
5. The battery temperature must never exceed 60°C(140°F) otherwise the battery could be damaged or ignited.
6. Never charge the battery on a flammable surface, near flammable products or inside a vehicle (preferably place the battery on a non-flammable and non-conductive surface).
7. Never leave the battery unattended during the charging process. Never disassemble or modify the housing's wiring, or puncture the cells. Always ensure that the charger output voltage corresponds to the voltage of the battery. DO NOT short circuit the batteries.
8. Never expose the Li-Po battery to moisture or direct sunlight, or store it in a place where temperatures could exceed 60°C(car in the sun, for example).
9. Always keep it out of reach of children.
10. Improper battery use may result in a fire, explosion or other hazards.
11. Non-rechargeable batteries are not allowed to be recharged. Rechargeable batteries should be charged under adults' supervision.
12. DO NOT mix different types of batteries including the new and used ones.

## GENERAL INFORMATION

13. Batteries MUST be inserted with the correct polarity.
14. The supply terminals MUST not to be short-circuited. Regular examination of transformer or battery charger for any damage to their cords, plugs, enclosures and other parts MUST be done. If there is damage, they MUST not be used until the damage has been repaired.
15. The packaging has to be kept since it contains important information.
16. This toy should only be connected to the equipment with symbol Class II. 

EU RF Power(EIRP): <10 dBm (2452MHz ~ 2474 MHz)

### Caution

1. The max operating of the EUT is 45°C, and shouldn't be lower than -10°C.
2. The device complies with RF specifications when the device used at 0mm from your body.
3. Declaration of Conformity.

## GENERAL INFORMATION

We, Xiamen Huoshiquan Import & Export CO.,LTD  
hereby, declare that the compliance of the essential requirements with  
the

Directive 2014/53/EU, the RoHS Directive 2011/65/EU and Safety  
Directive 2009/48/EC have been fully fulfilled on our product with  
indication below:

Product Name: Remote control four axis series

Model/Mark: D70/DEERC

The Statement of compliance is available at the following address:

[http://www.deerc.com/Download/CE/D70\\_EU\\_DOC.pdf](http://www.deerc.com/Download/CE/D70_EU_DOC.pdf)

This product can be used among EU member states.

## MANUFACTURER INFORMATION

Manufactured by

Xiamen Huoshiquan Import & Export CO.,LTD.

Address: Unit 1, Room 501, Hongxiang Building, No.258 Hubin Nan  
Road, Siming District, Xiamen, China

+1(855)777-8866



MADE IN CHINA(CN)