



Wetterstation

Thermo Hydro Quadro NLX

Instruction manual

Visit our website via the following QR Code or web link to find further information on this product or the available translations of these instructions.



www.bresser.de/P7000023



WARRANTY



www.bresser.de/warranty_terms

1 Imprint

Bresser GmbH

Gutenbergstr. 2
46414 Rhede
Germany

<http://www.bresser.de>

If you wish to submit a warranty claim or service request, please refer to the “Warranty” and “Service” information in this document. Please be aware that any requests or submissions sent directly to the manufacturer cannot be processed.

Errors excepted. Subject to technical modifications.

© 2020 Bresser GmbH

All rights reserved.

Reproduction of this document, including extracts, in any form (photocopied, printed etc.) or the use and distribution of this document by electronic means (image file, website etc.) is not permitted without the prior written consent of the manufacturer.

The terms and brand names of the respective companies used in this document are protected by brand, patent or product law in Germany, the European Union and/or other countries.

2 Validity information

This documentation is valid for the products with the article numbers listed below:

7000023

Manual version: 0620

Manual description:

Quickstart_7000023_Thermo-Hydro-Quadro-NLX_en-US
_BRESSER_v062020a

With any service inquiries, please state these information.

3 About this Instruction Manual



NOTICE

These operating instructions are to be considered a component of the device.

Please read the safety instructions and the operating instructions carefully before use.

Keep these instructions for renewed use at a later date. When the device is sold or given to someone else, the instruction manual must be provided to the new owner/user of the product.

4 General safety instructions



⚠ DANGER

Risk of electric shock

This device has electronic parts operated via a power source (power supply and/or batteries). Improper use of this product can cause an electric shock. An electric shock can cause serious or potentially fatal injuries. The following safety information must be observed at all times.

- Children must only use the device under adult supervision! Only use the device as described in the manual; otherwise, you run the risk of an electric shock.

-
- Disconnect the device from the power supply by pulling the power plug when it is not used or in case of longer interruption of operation and before starting any work on maintenance and cleaning.
 - Position your device so that it can be disconnected from the power supply at any time. The power socket should be installed near the device and should be easily accessible as the mains cable plug is used to disconnect the device from the power supply.
 - To disconnect the device from the power supply, always pull on the plug. Never pull on the cable.
 - Before starting up the device, check the device, the cables and the connections for signs of damage.
 - Never use a damaged device or a device with damaged live parts. Damaged parts must be immediately replaced by an authorised service company.
 - Only use the device in complete dry environment and do not touch it with wet or moist parts of your body.



DANGER



Risk of suffocation

Improper use of this product can result in suffocation. This is particularly dangerous for children. The following safety information must be observed at all times.

-
- Keep packaging materials (plastic bags, rubber bands etc.) away from children. They can cause suffocation.
 - This product contains small parts that could be swallowed by children. There is a risk of choking!



DANGER

Risk of explosion

Improper use of this product can cause an explosion. The following safety information must be observed at all times to prevent an explosion.

- Do not expose the device to high temperatures. Use only the supplied power supply or the recommended batteries. Do not short-circuit the device or batteries or throw them into a fire! Excessive heat or improper handling could trigger a short circuit, a fire, or an explosion.



NOTICE

Risk of damage to property

Improper handling can result in damage to the device and/or to the accessories. Always observe the following safety information when using the device.

- Never disassemble the device. In the event of a fault, please contact your specialist retailer. The specialist retailer will contact the service centre and send the device for repair if necessary.
- Do not expose this device to higher temperatures and protect it from water and high humidity.
- Do not immerse the unit in water!
- Protect the device from severe shocks!
- For this device only use accessories and spare parts that comply with the technical information.
- Use only the recommended batteries. Always replace weak or empty batteries with a new, complete set of batteries at full capacity. Do not use batteries from dif-

ferent brands or with different capacities. Remove the batteries from the unit if it has not been used for a long time.

- Never use rechargeable batteries.



NOTICE

Risk of voltage damage!

The manufacturer is not liable for voltage damage due to improperly inserted batteries or through the use of an improper power adapter!

5 Parts overview and scope of delivery

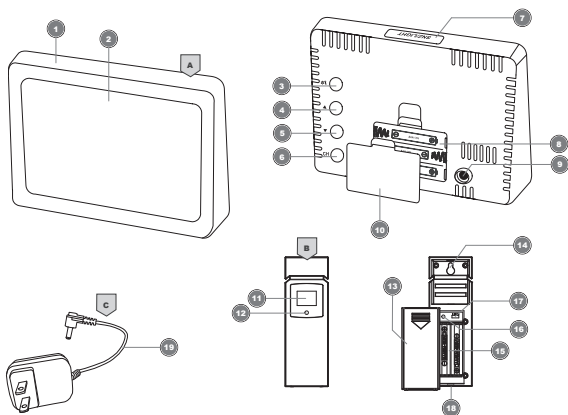

Illustration 1: All parts of base station (top) and wireless sensor (bottom)

- | | | | |
|---|------------------------|---|------------------------|
| 1 | Housing (base station) | 2 | Display (base station) |
|---|------------------------|---|------------------------|

3	SET button (basic settings)	4	UP button (increase value)
5	DOWN button (decrease value or initiate RCC signal reception)	6	CH button (channel selection)
7	SNZ/LIGHT button (set snooze function / display brightness)	8	Battery compartment
9	DC connection socket for coaxial power connector	10	Battery compartment cover
11	Display (Sensor)	12	Function indicator
13	Battery compartment cover	14	Wall mount fixture
15	Battery compartment	16	RESET button (reset all settings)
17	Slide control for channel selection	18	Stand
19	Power adapter with coaxial power connector		

Scope of delivery:

Weather station (A), thermal/hygro sensor (B) (3 pieces), power adapter (C)

6 Screen display

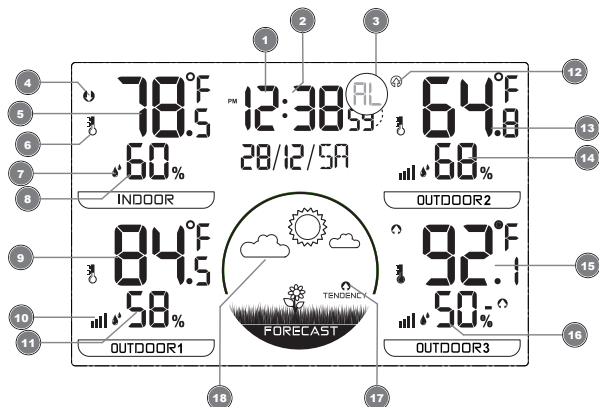

Illustration 2: Screen display

1	Current time	2	Symbol for enabled alarm
3	Display of seconds or symbol for the alarm time (depending on the selected mode)	4	Trend symbol 'falling'
5	Temperature indoors (in °C or °F)	6	Symbol for the temperature
7	Symbol for the humidity	8	Indoor humidity (in %)
9	Temperature outdoors (in °C or °F) (remote sensor 1)	10	Symbol for the sensor connection status
11	Humidity outdoors (in %) (remote sensor 1)	12	Trend symbol 'rising'

13	Outdoor temperature (in °C or °F) (remote sensor 2)	14	Humidity outdoors (in %) (remote sensor 2)
15	Temperature outdoors (in °C or °F) (remote sensor 3)	16	Humidity outdoors (in %) (remote sensor 3)
17	Weather trend symbol (better, steady, worse)	18	Weather forecast graphics (12 hours)

7 Before starting operation

NOTICE



Avoid connectivity disruptions!

To avoid connectivity disruptions between the devices, consider the following points before starting operation.

1. Place base station (receiver) and remote sensor (sender) together as close as possible.
2. Set up power supply for the base station and wait until the indoor temperature is displayed.
3. Set up power supply for the remote sensor.
4. Position the base station and the remote sensor within the effective transmission range.
5. Ensure that the base station and remote sensor are assigned to the same channel.

When changing batteries always change batteries in the main unit as well as all remote units and replace them in the correct order, so the remote connection can be re-established. If either of the devices is mains-powered, the power supply must be disconnected for a short moment also for this device when exchanging the batteries. If batteries are

exchanged in only one of the devices (i.e. the remote sensor) the signal can't be received or can't be received correctly.

Note, that the effective range is vastly affected by building materials and position of the main and remote units. Due to external influences (various atomic devices and other sources of interference), the maximum distance can be greatly reduced. In such cases we suggest to position the main unit and the remote sensor at other places. Sometimes all it takes is a relocation of one of these components of a few inches!

Though the remote unit is weather proof, it should be placed away from direct sunlight, rain or snow.

8 Setting up power supply

Base device

1. Insert the DC connector into the connection socket of the base station.
2. Insert the mains plug into the power outlet.
3. The device is energized directly.
4. Wait until the indoor temperature is displayed on the base station.

NOTICE! For permanent operation, mains power supply is recommended. Alternatively a power supply with batteries is also possible, to keep the time setting in case of power failure. Proceed as follows:

5. Remove the battery compartment cover.
6. Insert the batteries into the battery compartment. Ensure that the battery polarity (+/-) is correct.
7. Replace the battery compartment cover.

-
8. Wait until the indoor temperature is displayed on the base station.

NOTICE! When switching from mains power supply to battery power supply or vice versa, the power supply is being disabled for a short moment for technical reasons. Exception: permanent battery operation.

Remote sensor

9. Remove the battery compartment cover.
10. Insert the batteries into the battery compartment. Ensure that the battery polarity (+/-) is correct.
11. Set the channel selector switch to the desired channel.

NOTICE! This weather station can be operated with one or more remote sensors. Each remote sensor being connected must be operated on a different channel. If only one remote sensor is connected, it should be operated on channel 1.

12. Replace the battery compartment cover.

9 Automatic time setting

After the power is restored, the unit automatically searches for the atomic signal. It takes about 3-8 minutes to complete this process.

If the atomic signal is received correctly, the date and time are set automatically and the reception symbol is displayed.

If no atomic signal is received, proceed as follows:

1. Press the DOWN button for approx. 2 seconds to initiate the reception of the atomic signal again.

-
2. If no atomic signal is still received, the time setting must be made manually.

Read the detailed manual for more information about manual time and alarm setting (see download information on page 2).

10 Alarm setting

Alarm time setting

1. In normal display mode, press SET button to switch to alarm time display (AL).
2. Press and hold SET button for approx. 3 seconds to enter alarm time setting mode.
3. Digits to be set are flashing.
4. Press UP or DOWN button to change the value.
5. Press SET button to confirm and continue to the next setting.
6. Settings order: hours > minutes
7. Finally press the SET button to save the settings and exit the setting mode.

Enable/disable alarm

8. In normal display mode, press SET button to switch to alarm time display (AL).
9. Press DOWN button to enable the alarm. The A symbol will be displayed.
10. Press DOWN button again to disable the alarm. The A symbol will disappear from the display.

11 Receiving measurements automatically

Once the power supply is enabled, the base station will display the measurement readings for indoors. Readings from the outdoor sensor will be displayed within 3 minutes after powering it on.

If no signal is received, proceed as follows:

Press the CH button for about 3 seconds to initiate reception of measurements again.

12 Display brightness regulation

1. In normal display mode, press SNOOZE/LIGHT button, to activate the full display brightness for 10 seconds.
2. In mains adapter operation (DC 5V) the backlight remains always activated. The light sensor ensures that the brightness is automatically reduced in a dark environment.
3. NOTICE! In battery mode the display brightness regulation is disabled.

13 EC Declaration of Conformity

Hereby, Bresser GmbH declares that the equipment type with item number 7000023 : is in compliance with Directive: 2014/30/EU. The full text of the EU declaration of conformity is available at the following internet address:
www.bresser.de/download/7000023/CE/7000023_CE.pdf

14 FCC Compliance Statement

This device complies with Part 15 of the FCC Rules. Operation is subject to the following two conditions: (1) this device may not cause harmful interference, and (2) this device must accept any interference received, including interference that may cause undesired operation.

Changes or modifications not expressly approved by the party responsible for compliance could void the user's authority to operate the equipment.

This equipment has been tested and found to comply with the limits for a Class B digital device, pursuant to Part 15 of the FCC Rules. These limits are designed to provide reasonable protection against harmful interference in a residential installation. This equipment generates, uses and can radiate radio frequency energy and, if not installed and used in accordance with the instructions, may cause harmful interference to radio communications. However, there is no guarantee that interference will not occur in a particular installation.

If this equipment does cause harmful interference to radio or television reception, which can be determined by turning the equipment off and on, the user is encouraged to try to correct the interference by one or more of the following measures:

- Reorient or relocate the receiving antenna.
- Increase the separation between the equipment and receiver.
- Connect the equipment into an outlet on a circuit different from that to which the receiver is connected.
- Consult the dealer or an experienced radio/TV technician for help.

15 Disposal



Dispose of the packaging materials properly, according to their type, such as paper or cardboard. Contact your local waste-disposal service or environmental authority for information on the proper disposal.

16 Warranty

www.explorescientific.com/warranty

17 Specifications

Power supply

Mains adapter

Batteries needed

6x AAA (Micro), 1.5V

Transmission frequency

433 MHz

Transmission range

30 m

DIMENSIONS & WEIGHTS

Total length

122 mm

Total width

28 mm

Total height

186 mm

Net weight (without access.)

275 g