

Getting to Know Humidifier LED Screen Icon

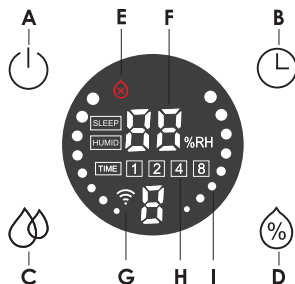

Panel Button

- A. Switch Button
- B. Time Button
- C. Mist Level
- D. Humidity Button

Screen Icon

- E. No Water Indicator
- F. Humidity Indicator
- G. WiFi Indicator
- H. Timer
- I. Mist Level Indicator

'E.' Note:

- When the machine is short of water, the screen will pop out '  ' and flash red, and the machine will enter the standby state after 3 seconds.

'F.' Note:

- When you do not set the humidity range, the humidifier will automatically detect the humidity range of the current environment and display it on the LED screen (with an error of 5%).

How to Control Your Smart Humidifier



Power Button

- Press to turn on/off your humidifier.

Standby mode

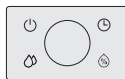

Press first time

Working mode



Press second time

Standby mode

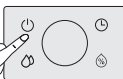

Timing Function Button

- Press repeatedly to switch the time setting: 1H→2H→4H→8H→Sleep mode;
- After the timer finish, the humidifier will enter the standby state.

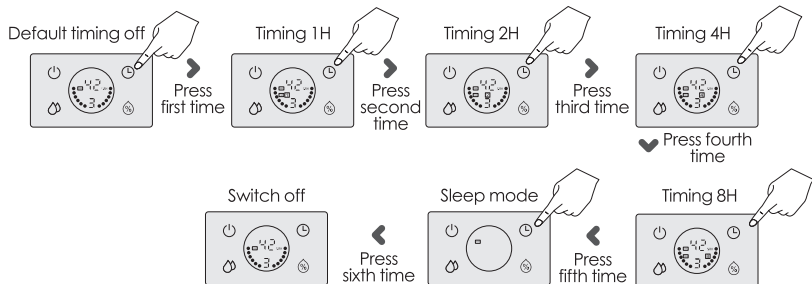

Sleep Mode

- Turn on sleep mode, the LED screen will turn off in 3-5 seconds;
- The spray mode works for 5 minutes each time, and pauses for 5 minutes, 10 minutes, and 15 minutes in sequence (5-10-15-5-10-15, and so on).

Mist Level Button

- Press repeatedly to switch gears to set the mist size: Low→Medium→High;
- The subsequent mist size will default to the size you used last time.

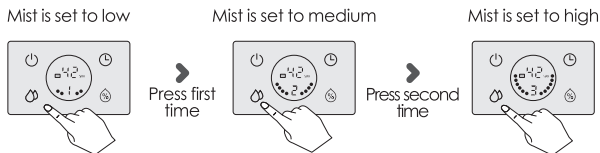

Constant Humidity Button

- When the machine is working, press repeatedly to switch the humidity range;
- The humidity range is 40%-90%, and each press increases by 5%;
- When the humidifier reaches the range you set, the humidifier will stop spraying;
- When you do not set the humidity range, the humidifier will automatically detect the humidity range of the current environment and display it on the LED screen (with an error of 5%).

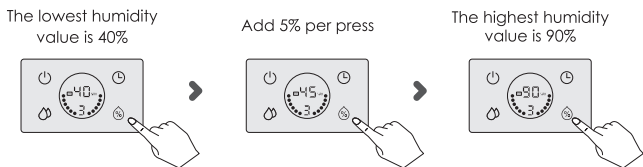

Steps for Filling Water

1. Remove all packaging and take out the user manual, quick guide & brush in the water tank.

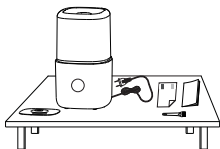

2. The humidifier should be placed on a flat surface.

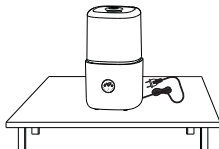

3. Open the cover and fill in water, or take up the water tank and take it to the tap to add water.



4. Note that water must not exceed the maximum water level.

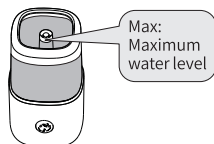

5. Cover the tank cover and plug in the power cord.

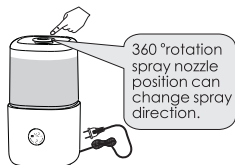

6. Please insert the wires in a standard way and keep your hands dry.

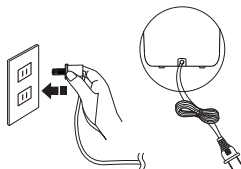

Precautions

- The machine has a water tank detect function. When the machine is working, picking up the water tank will stop spraying. Putting down the water tank will spray again. (Fig.1)

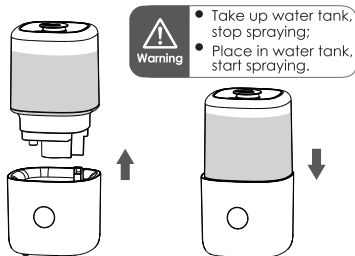

Fig.1

- DO NOT** add essential oils, water treatment fluids or water filters into the water tank and base. (Fig.2 Fig.3)

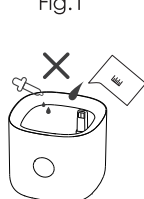

Fig.2

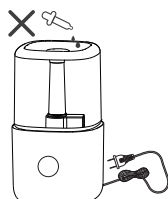

Fig.3

- Only** add essential oils to the essential oil tank. (Fig.4)
- DO NOT** add water directly to the base. (Fig.5)



Fig.4

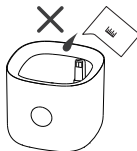

Fig.5

- DO NOT** add water through the mist tube. (Fig.6)
- Make sure that the nozzle cap is back in the water tank, otherwise, the humidifier may not be able to spray fog. (Fig.7)

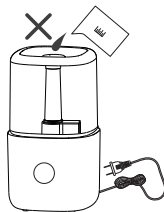

Fig.6

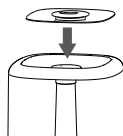

Fig.7

Cleaning and Maintenance

1. Add appropriate amount of water and clean the machine with a cleaning brush.



2. Wipe the atomizer with a cotton swab dipped in the citric acid solution.

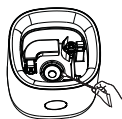

3. Rinse with water and wipe with a soft cloth.



4. Remove the upper cover and nozzle in turn, wash with water, and wipe with a damp soft cloth.



5. Wipe with a soft damp cloth and dry with a dry towel.



Note:

- It is recommended not to use detergent for cleaning, long-term use may cause corrosion of the shell;
- **DO NOT** use hard and sharp devices to touch or hit the atomizing sheet;
- **DO NOT** use a cleaner like a steel ball to clean the water tank, which will scratch the water tank.

Note:

- **DO NOT** pour water from the direction of the export position.

