

AKRAM

Bluetooth Tower Speaker

(FRENCH USER GUIDE)
FRANÇAIS (SOMMARIO)

IN THE BOX



PLEASE NOTE

Playing wireless music
To play music from an Apple Wireless Tower Speaker, make sure you are connected to a Bluetooth-enabled device. Once connected, press PLAY on your Bluetooth device when playback has begun, you can control the music with your connected device or the buttons of the Bluetooth speaker with device that have the **CONNECT** icon on it.

Play/Pause
• Quick press the **SCANNING** button on the speaker or the remote control to pause the music.
• To resume music playback, quick press the **SCANNING** button again.

Skipping Songs
• Quick press the **DISCONNECT** button on the speaker or the remote control to go to the previous song.
• Quick press to **DISCONNECT** button on the speaker or the remote control to go to the next song.

LOCATION OF CONTROLS

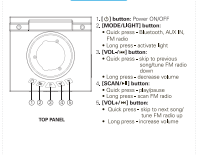

PLEASE NOTE

Adjusting the volume
• Long press the **VOLUME UP** button on the speaker or the **+** button on the remote control to increase the volume.
• Long press the **VOLUME DOWN** button on the speaker or the **-** button on the remote control to decrease the volume.
• Press the **STOP** button on the remote control to pause the music. Press again to turn the sound back on.

Power/Standby
Press the **POWER** button on the remote control to adjust speaker settings.

LOCATION OF CONTROL PANELS

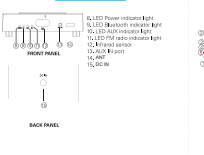

PLEASE NOTE

Listening to the radio by receiving
1. Press the **MODE/LIGHT** button on the speaker or the **MODE** button on the remote control to turn on the LED FM radio indicator light.
2. Press the **DISCONNECT** button on the speaker for several times, or press the **SCANNING** button on the remote control to search for radio stations. If no station is found, press the **DISCONNECT** button on the speaker or the **DISCONNECT** button on the remote control to return to the previous station.
3. After searching, press the numeric buttons to select FM preset stations. Or pressing **+** and **-** to select preset stations.
4. Press **STOP** to stop the radio.

NOTE: After opening and using radios, the Wireless Tower Speaker is connected to the power supply. Please do not disconnect the power supply while using the radio.

Listening to the radio by manual search
Quick press the **DISCONNECT** button on the speaker or the **DISCONNECT** button on the remote control to search for the next radio station.

LOCATION OF CONTROL PANELS

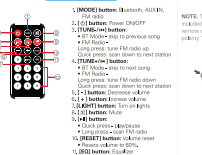

PLEASE NOTE

Using as a USB speaker
1. Quick press the **MODE/LIGHT** button on the speaker or the **MODE** button on the remote control to turn on the LED FM radio indicator light.
2. Connect the USB cable to the USB port on the back of the speaker, and the other end of the cable to an external device (e.g., MP3 player, computer, tablet, etc.).
3. Use the controls on your connected device to control music playback and volume.

NOTE: After opening and using radios, the Wireless Tower Speaker is connected to the power supply. Please do not disconnect the power supply while using the radio.

INSTALLING THE BATTERY

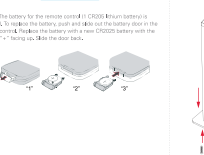

PLEASE NOTE

CHARGING DETAILS
The Wireless Tower Speaker has a USB input. You can use the USB input as a charging port for charging external devices such as MP3 players, smartphones, etc.
1. Connect your device to the speaker's USB port using your device's USB charging cable.
2. Check your device's charging status in the settings.

EXTERNAL SPEAKER

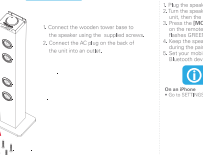

PLEASE NOTE

REMOVAL INSTRUCTIONS
1. Make sure your Bluetooth device supports A2DP profile.
2. Turn on the volume on your Bluetooth device.
3. Now that everything is ready, the speaker should begin to play. However, to stop the music, use the controls on your connected device to control music playback and volume.
1. Make sure the Wireless Tower Speaker is turned ON before beginning the pairing process.
2. Keep the Wireless Tower Speaker and Bluetooth-enabled device within 3 feet of each other during the pairing process.
3. Press the **MODE/LIGHT** button on the speaker or the **MODE** button on the remote control to connect to the Bluetooth-enabled device with the **CONNECT** icon on the speaker.

PAIRING THE SPEAKER



PLEASE NOTE

PAIRING THE SPEAKER OVER A PHONE
1. Make sure your Bluetooth device supports A2DP profile.
2. Turn on the volume on your Bluetooth device.
3. Now that everything is ready, the speaker should begin to play. However, to stop the music, use the controls on your connected device to control music playback and volume.

PAIRING THE SPEAKER OVER A PHONE

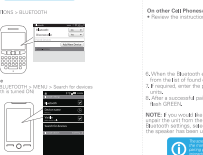

PLEASE NOTE

PAIRING THE SPEAKER OVER A PHONE
1. Make sure your Bluetooth device supports A2DP profile.
2. Turn on the volume on your Bluetooth device.
3. Now that everything is ready, the speaker should begin to play. However, to stop the music, use the controls on your connected device to control music playback and volume.

PAIRING THE SPEAKER OVER A PHONE

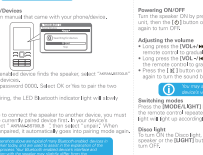

PLEASE NOTE

PAIRING THE SPEAKER OVER A PHONE
1. Make sure your Bluetooth device supports A2DP profile.
2. Turn on the volume on your Bluetooth device.
3. Now that everything is ready, the speaker should begin to play. However, to stop the music, use the controls on your connected device to control music playback and volume.

PAIRING THE SPEAKER OVER A PHONE



PLEASE NOTE

PAIRING THE SPEAKER OVER A PHONE
1. Make sure your Bluetooth device supports A2DP profile.
2. Turn on the volume on your Bluetooth device.
3. Now that everything is ready, the speaker should begin to play. However, to stop the music, use the controls on your connected device to control music playback and volume.

