

1. Antenna
2. LCD display
3. Down button for group and volume adjustment
4. On / Off / Mute / Set button — Transmitter  
On / Off / Set button — Receiver
5. Up button for group and volume adjustment
- 6-1. Headset socket for Transmitter
- 6-2. Earphone / Headset socket for Receiver
7. Two-Way communication switch — Main Transmitter(HOS)  
Talk switch — Secondary transmitter(SLV)
8. Push talk button — Receiver
9. Lanyard connection point
10. Label area
11. Battery compartment and built-in Li-polymer battery
12. Lid of battery compartment and screws

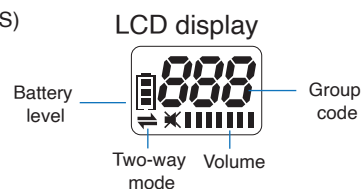

## LCD Display Illustration

	501T / 501TPlus (Transmitter)	501R (Receiver)		501T / 501TPlus (Transmitter)	501R (Receiver)
	Group change			Two-way mode on	
	Earphone mute			There is a secondary transmitter or receiver talking	
	Earphone volume			—	No signal received
	Microphone is muted	—		10% → 30% → 70% → 100% battery remaining	

## Operating Instructions

### Connected to a headset or earpiece:

- Both the transmitter and receiver come equipped with a built-in microphone, allowing users to connect a headset or earpiece as needed.

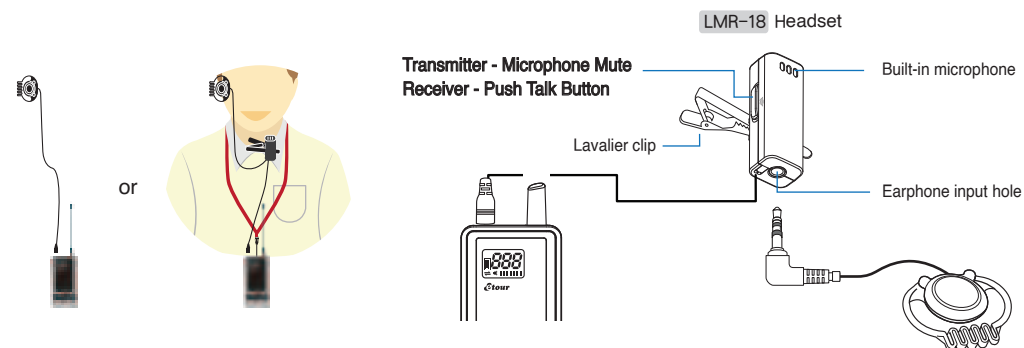

## Power On and Off

- Press and hold the power button / for 2 seconds to turn on the system, and press and hold it again for 2 seconds to power off the system.
- Make sure that the transmitter and receiver(s) are operating under the same code. The receiver display will keep flashing when no transmission signal is being received.
- When using multiple groups in the same space, avoid using the same group code.



### Power-saving mode:

- If the receiver does not receive a signal within approximately 20 minutes, it will automatically shut down.
- If the microphone on the transmitter is in mute mode, it will automatically shut down after 20 minutes.



## How to Adjust the Volume

### Headphone volume:

- Press the or button to decrease or increase the headphone volume. When headphone is muted, the will appear.

**Volume memory** - It will set to the last used volume when power on next time.

### Transmitter microphone is muted:

- Press the button briefly and the volume icon starts flashing , indicating the transmitter is in mute mode; press it again to unmute.

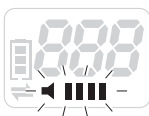

## Group Code Setting and Adjustment

The factory default group code of the device is "001", which can be customized by the user from 001 to 999. Code adjustments can be set manually or via a dedicated charger.

### 1: Manual setting

- Press and buttons simultaneously for 2 seconds. The group code starts flashing. Press or button to select your desired code. Press / button briefly to confirm the selected code or wait for approximately 5 seconds to automatically store the selected code.
- Receiver: Select a different group  
On certain occasions, the receiver can also choose to join a different group by manually adjusting the group code.

### 2: Synchronize group settings through a dedicated charger, please refer to the charger user guide for details.

When the transmitter's group code changes, the codes on the receivers in the same group will also be updated simultaneously.

The last used group code will be displayed when powering on.

## Battery Autonomy and Charging

- When battery icon is displayed at fully autonomy , the battery contains sufficient power.
- When the battery icon is displayed as empty and flashing , this indicates low battery and only 10% battery remaining. Recharge the battery immediately via USB certified traveling charger (optional accessories) or appropriated Linkx charger station. It will take approx. 7 hours to reach full charge and provide approx. 13 hours of continuous operation.
- While charging, the battery icon displays on LCD → → back and forth.

The transmitter or receiver will shut down automatically when charging is taking place. If you want to use the system while it's charging, simply press the power button again to turn the system back on.

## Initiate Two-Way Communication Function

The transmitter that is powered on first is the main transmitter, which can activate the two-way communication function and determine whether there can be 2 or 3 speakers.

- When TG-501T is selected as the main transmitter and two-way communication is enabled, the system allows the main transmitter to speak continuously and additionally supports:

a. 1 secondary transmitter or b. 1 receiver to speak

- When TG-501T Plus is selected as the main transmitter and two-way communication is enabled, the system allows the main transmitter to speak continuously and additionally supports:

a. 2 secondary transmitters or b. 2 receivers or

c. 1 secondary transmitter + 1 receiver to speak

The conversation will be heard by all the participant within the group.

### Main transmitter

- When the two-way communication switch is turned on on off, two-way icon " " will appear on all displays in the group.
- Press the mute button momentary to mute or unmute the microphone
- Switch off the two-way communication function on off to end the two-way communication mode.

### Secondary transmitter

- The second transmitter that is turned on using the same group code as the main transmitter is the secondary transmitter.
- Slide the two-way communication switch on off to "on" position to speak.  
 After the speech is completely finished, remember to slide the communication function switch on off to avoid occupying the speaking quota.
- Press the mute button momentary to mute or unmute the microphone

### Receiver

- When you need to speak, press and hold the side button of the receiver while speaking into its built-in microphone on top. When finished, release the button so the next person can speak.

When speaking, the two-way communication icon flashes.

If there is already a secondary transmitter or receiver in the group speaking, you must wait for them to finish speaking and release the talk button.

- A quick double click of the communication button switches the receiver to continuous talk mode.**

When the receiver needs to talk for a long time, he can quickly double-click the talk button to lock into continuous talk mode. In this mode, there is no need to hold down the button and other receivers cannot interrupt the conversation. To exit this mode, just click the button again.

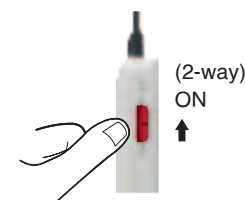

The receiver or secondary transmitter is speaking.

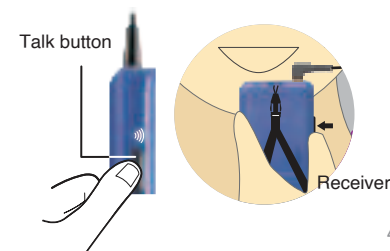

## Reboot or Restart when the LCD display is Frozen or Stuck

In the unlikely event that your tour guide system becomes frozen and unresponsive, you can attempt a force shut down and then reboot/restart your guide system.

Follow these steps:

1. Find the "Force Shut Down" button (#14) recessed and located on the side of the device
2. Use a pencil or similar sharp object to gently press and hold the button for 1 second.  
The device will be turned off. Turn on the device again and confirm that the configuration has been restored back to the previous setting.

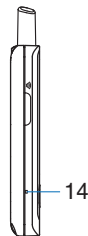

Side view

### FCC Interference Statement

This equipment has been tested and found to comply with the limits for a Class B digital device, pursuant to Part 15 of the FCC Rules. These limits are designed to provide reasonable protection against harmful interference in a residential installation.

This equipment generates, uses and can radiate radio frequency energy and, if not installed and used in accordance with the instructions, may cause harmful interference to radio communications. However, there is no guarantee that interference will not occur in a particular installation.

If this equipment does cause harmful interference to radio or television reception, which can be determined by turning the equipment off and on, the user is encouraged to try to correct the interference by one of the following measures:

- Reorient or relocate the receiving antenna.
- Increase the separation between the equipment and receiver.
- Connect the equipment into an outlet on a circuit different from that to which the receiver is connected.
- Consult the dealer or an experienced radio/TV technician for help.

This device complies with Part 15 of the FCC Rules. Operation is subject to the following two conditions:

- (1) This device may not cause harmful interference, and
- (2) This device must accept any interference received, including interference that may cause undesired operation.

**FCC Caution:** To assure continued compliance, any changes or modifications not expressly approved by the party responsible for compliance could void the user's authority to operate this equipment. (Example - use only shielded interface cables when connecting to computer or peripheral devices).

### FCC Radiation Exposure Statement

This equipment complies with FCC RF radiation exposure limits set forth for an uncontrolled environment. This equipment should be installed and operated with a minimum distance of 0.5 centimeters between the radiator and your body.

This transmitter must not be co-located or operating in conjunction with any other antenna or transmitter.

The antennas used for this transmitter must be installed to provide a separation distance of at least 0.5 cm from all persons and must not be co-located or operating in conjunction with any other antenna or transmitter.

Linkx Electronics Co., LTD V.1