

Product Information

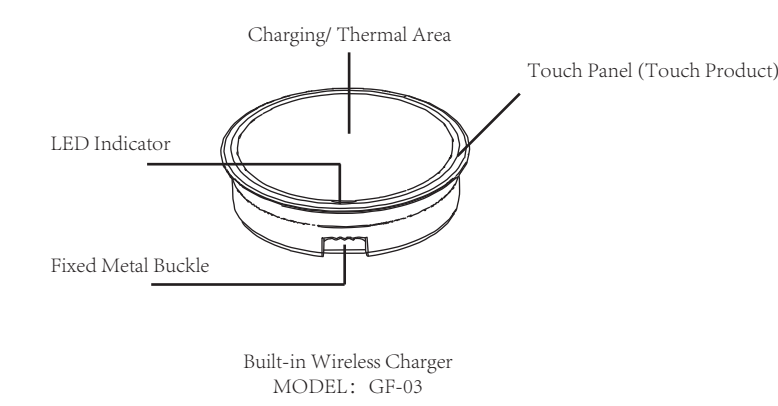

Accessories

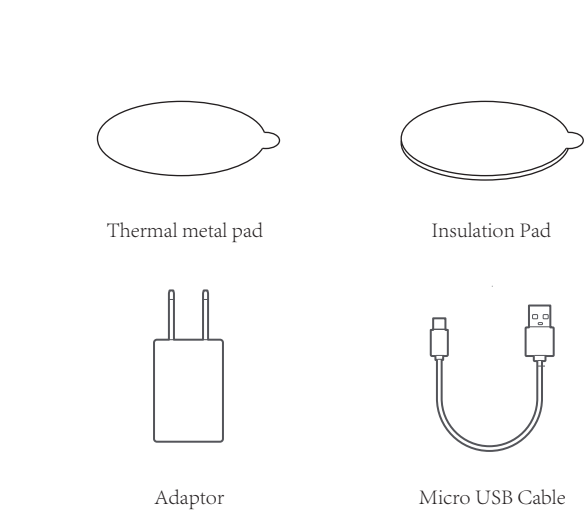

Instruction of Cutting out Grommet hole

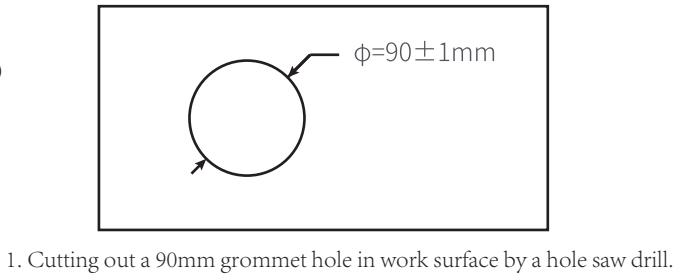

Wireless Operation Manual

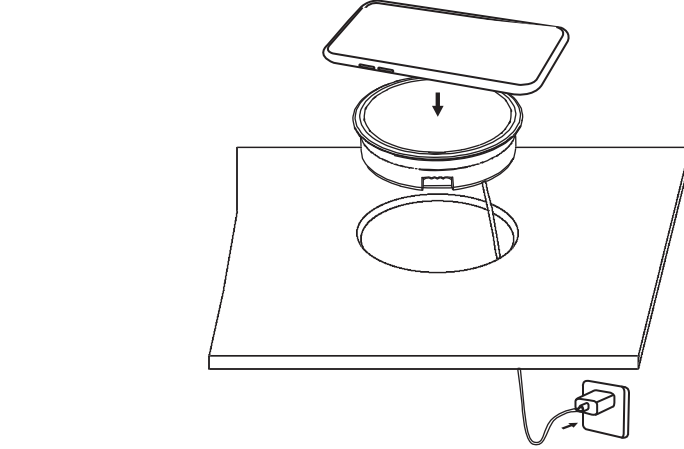

- 1. Connect the device with Micro USB cable and adaptor and plug into the power socket.
- 2. Fit into the grommet hole in work surface and lock it up.
- 3. Place your device directly on the wireless receiver (focus on the charging area).
- 4. The device will be charged automatically.

Thermal Pad Manual

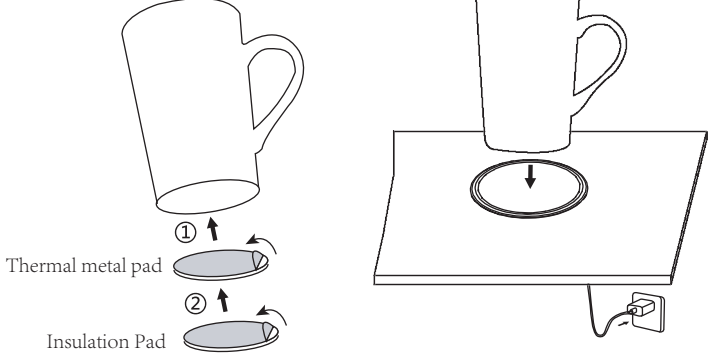

- 1. Remove the blue protection film from the thermal metal pad and stick firmly under your cup.
 - 2. Remove the protection film from the Insulation Pad and stick firmly under your cup.
 - 3. Recommend to charge with the in-box adaptor or a qualified QC adapter.
 - 4. Please focus your cup on the thermal area to get the best heating-effect.
 - 5. Touch-on version: The thermal function will be switched on when touching the aluminum panel.
- Original Version: The thermal function will be switched on when placing a cup on it.

LED Display Guide

Working Condition	Standby mode	Charging	Thermal function	Over-time protection	Foreign Objects detection
LED Indicator	NA	Breathing-light in Green	Red Light	Alternative Flashing with red and green light	Flashing with red light

Product Faulty

Faulty	Analysis	Solutions
Failure in thermal function	1. An insufficiency in charging Requirement (12V/1.5A) 2. Defect in Type-C connection 3. The thickness of a cup's bottom exceeds 4mm.	1. Use a qualified adapter. 2. Re-plug the Type C 3. Use a suitable cup (the thickness of the bottom of a cup is less than 4mm)
Ineffective Heating function	1. Disconnection with thermal pad and the cup.	1. Change the thermal pad and stick firmly to the bottom of the cup.
Charging slowly	1. Over-heating of the wireless device.	1. Re-charge the phone after cooling down the wireless device.

Features

- 1. Support Qi EPP 15W, compatible to Qi wireless charging phone.
- 2. The thermal function with rated power to 18W.
- 3. The thermal pad is applicable to most of cups, which can show the personal style.
- 4. The thermal function will turn off automatically after 4 hours of operation.
- 5. When charging with an empty cup, the wireless charger will turn off automatically.

FCC Warning

This device complies with part 15 of the FCC Rules. Operation is subject to the following two conditions:(1) This device may not cause harmful interference, and (2)this device must accept any interference received, including interference that may cause undesired operation.

Any Changes or modifications not expressly approved by the party responsible for compliance could void the user's authority to operate the equipment.

This equipment has been tested and found to comply with the limits for a Class B digital device, pursuant to part 15 of the FCC Rules. These limits are designed to provide reasonable protection against harmful interference in a residential installation. This equipment generates uses and can radiate radio frequency energy and, if not installed and used in accordance with the instructions, may cause harmful interference to radio communications. However, there is no guarantee that interference will not occur in a particular installation. If this equipment does cause harmful interference to radio or television reception, which can be determined by turning the equipment off and on, the user is encouraged to try to correct the interference by one or more of the following measures:

- Reorient or relocate the receiving antenna.
- Increase the separation between the equipment and receiver.
- Connect the equipment into an outlet on a circuit different from that to which the receiver is connected.
- Consult the dealer or an experienced radio/TV technician for help.

The device has been evaluated to meet general RF exposure requirement. The device can be used in portable exposure condition without restriction.

FCC RF exposure statement:

The equipment complies with FCC radiation exposure limits set forth for an uncontrolled environment. During the operation of device a distance of 15 cm surrounding the device and 20 cm above the top surface of the device must be respected.