

Quick Guide

① First Time Turning ON/OFF

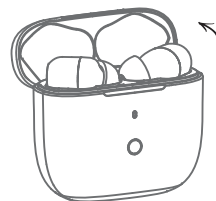

State 1

- Open cover of charging base to turn on automatically.
- Close cover of charging base to power off automatically.



State 2

- When the charging base has no power and the headsets have power, long touch the touch area of headset(R) or headset(L) for 2 seconds to turn on.

② TWS Pairing

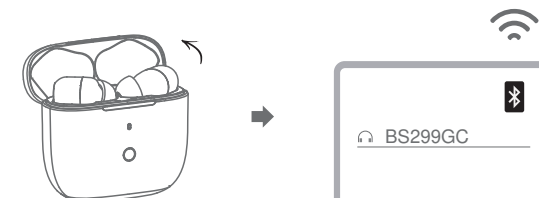

First Time Pairing

- 1 Open cover of charging base, headsets will enter pairing mode automatically.
- 2 Turn on Bluetooth of phone and choose " BS299GC " from Bluetooth list to pair. Headset will prompt "connected" after paired successfully.

Reconnection

After first time pairing, just open the cover of charging base and wait for a few seconds to reconnect automatically.

*The above operation should be ensured that the product has power.

③ ANC/Transparency Mode

x3

Short touch headset (R) for 3 times to switch ANC / Transparency Mode.

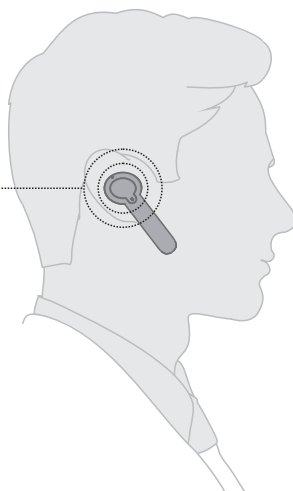

④ Gaming Mode

x4

Short touch headset (L) for 4 times to turn on/off Gaming Mode.

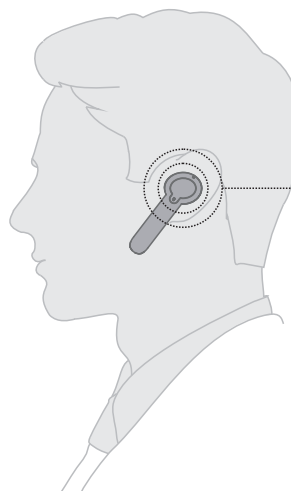

⑤ Delete Pairing Records on the Headset

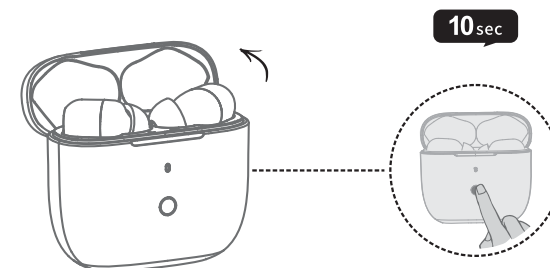

Open the cover of charging base when the headsets inside it, long press the button of charging base for 10 seconds, the indicator light flashes blue for 6 times quickly.

⑥ Charging Ways

Charging Ways of Charging Base
Use the Type-C cable to charge.

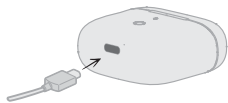

Charging Ways of Headset
Put the headsets into charging base to charge automatically.

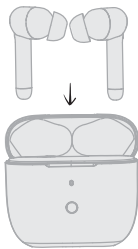

⑦ Headset Control

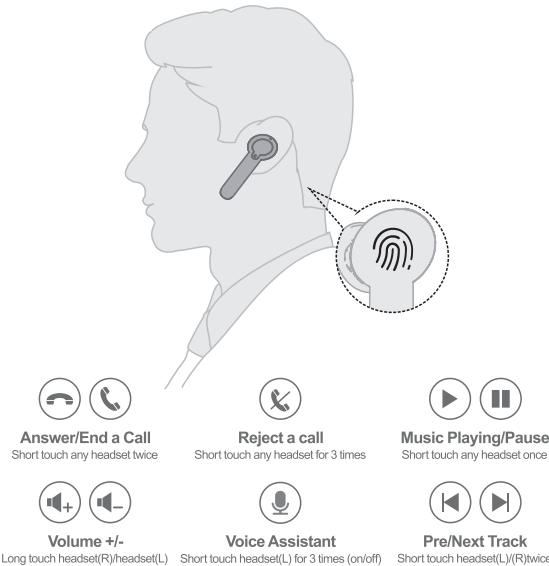

⑧ Common Faults and Exclusion

Faults	Reasons	Solutions
Can not turn on	Low battery protection	Charging headsets for 1-2 hours
	Take out the headsets from the charging base too fast	Take out the headsets from the charging base after 2 seconds
Can not turn on by opening the charging base /No indicator light when headset being charged	Charging base low battery protection	Charging both the headsets and charging base for 1-2 hours
No sounds after pairing	Wrong pairing	Pairing again
The two headsets TWS pairing failure/TWS paired successful but can not find the headset(R)	Too many pairing records	Delete pairing records according to user manual and pairing again
Charging base without indicator light when being charged	DC power supply doesn't output power	Check whether the TYPE-C charging cable is plugged
Headsets without indicator light when being charged	The headsets couldn't being charged in charging base	①Checking headset charging interface whether has touched to POGO PIN of charging base and the location is correct or not. ②Charging for charging base
Turning off automatically	Low battery	Charging headset for 1-2 hours
Headset echo	Volume is too loud or environment is noisy	Adjust the volume at phone or change a place
Noise in call	Environmental interference caused or distance between headset and mobile is too far	Change a place or move to close the headset and mobile
Low voice of the calling party	Wearing headset is wrong	Adjusting wearing position of headset

⑨ Indicator of Charging Base

Status No.	Status	Charging Base Performance
Status	Battery Status of Charging Base	The times of flashing blue lights for charging base means corresponding battery: quickly flash once means less than 25% battery, twice means 25%-50% battery, 3 times means 50%-75% battery and 4 times means 75%-100% battery. Blue light is always on when fully be charged.

*The indicator of charging base flashes blue quickly every 2 seconds.

⑩ Indicator of Headset

Status No.	Status	Headset Performance
Status 1	TWS Pairing Mode	The indicator light of headset flashes red and blue quickly and alternately.
Status 2	Pairing Mode with Bluetooth Device	After paired, master headset flashes red and blue slowly and alternately, slave headset flashes blue once every 5 seconds.
Status 3	Headset Charging	Red light always on while being charged and will light off when fully being charged.
Status 4	Power On	The indicator light flashes blue for 3 times.
Status 5	Power Off	The indicator light flashes red for 3 times. (Put headsets into charging base and close the cover to power off.)

⑪ Specifications

Bluetooth Version: V5.1	Bluetooth Profiles Supported: HFP, HSP, A2DP, AVRCP
Audio Decoding Protocol: SBC, AAC	Transmission Power: Class 2
Operation Range: Up to 10 meters	Frequency Range: 2.4GHz-2.48GHz
Battery of Earbuds: 40mAh Li-polymer Battery	Charging Voltage of Headset: DC 5V±0.2V
Charging Time of Headset: About 1.5 hours	Battery of Charging Base: 500mAh Li-polymer Battery
Charging Voltage of Charging Base: DC 4.75V-5.25V	Charging Voltage of Charging Base: About 1.5 hours
Charging Headset Times from Charging Base: 2-3 times	Music Playing Time: ≥4 hours
Talk Time*: ≥3.5 hours	Standby Time*: About 10 hours
Driver: 12mm	Driver Sensitivity: 113±1.5dB(1KHz)
Driver Impedance: 32Ω ±15%	Driver Frequency Ring Range: 20Hz-20KHz
Dimensions of Charging Base(mm): L59.9 X W25 X H54.7	Dimensions of Headset(mm): L42.1 X W19.8 X H23.1
Weight(one headset): About 5.0g	Total Weight: About 49.3g

*The time mentioned above may vary due to user's operation mode and device settings.

NOTE: This equipment has been tested and found to comply with the limits for a Class B digital device, pursuant to part 15 of the FCC Rules. These limits are designed to provide reasonable protection against harmful interference in a residential installation. This equipment generates uses and can radiate radio frequency energy and, if not installed and used in accordance with the instructions, may cause harmful interference to radio communications. However, there is no guarantee that interference will not occur in a particular installation. If this equipment does cause harmful interference to radio or television reception, which can be determined by turning the equipment off and on, the user is encouraged to try to correct the interference by one or more of the following measures:

- Reorient or relocate the receiving antenna.
- Increase the separation between the equipment and receiver.
- Connect the equipment into an outlet on a circuit different from that to which the receiver is connected.
- Consult the dealer or an experienced radio/TV technician for help

Changes or modifications not expressly approved by the party responsible for compliance could void the user's authority to operate the equipment. This device complies with Part 15 of the FCC Rules. Operation is subject to the following two conditions:

- (1) this device may not cause harmful interference, and
- (2) this device must accept any interference received, including interference that may cause undesired operation.