

360 VR Camera

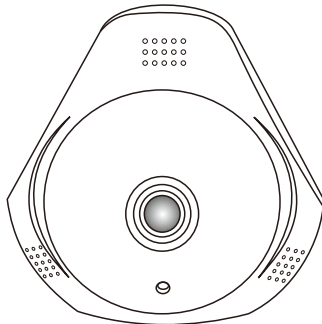

The image is a technical line drawing of a 360-degree VR camera. It has a hexagonal body with a central lens. Above the lens is a small sensor array, and below it is a small circular button. The sides of the camera feature additional sensor arrays. The drawing is simple, using only black lines on a white background.

Quick Start Guide

Model: T5600HCA

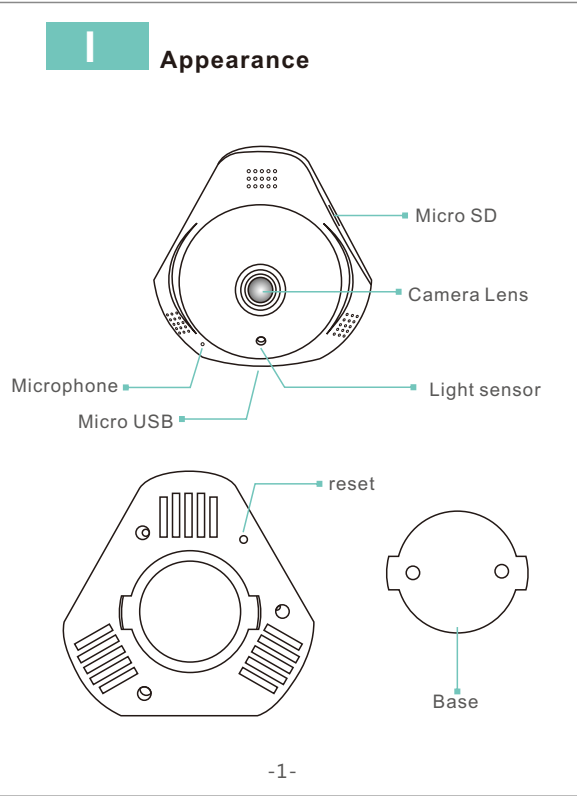

Before using the product, please read the guide carefully to avoid any damages to the product in virtue of faulty operation or misuse.



2 Installation

Preparation prior to Installation

1. 2.4G wireless router is required.
2. support Android 4.4 and above, iOS 8.0 and above
3. Download and install the APP:
 - A. Open the App Store , search "GOSCOM" and install.
 - B. Open the Google Play Store , search "GOSCOM" and install.
4. Here is an operation example of Android APP, and it can serve as a reference for the IOS APP.
5. power-on Camera and there will be prompt sound indicating power on succeed



Camera Power Adapter Wall Socket

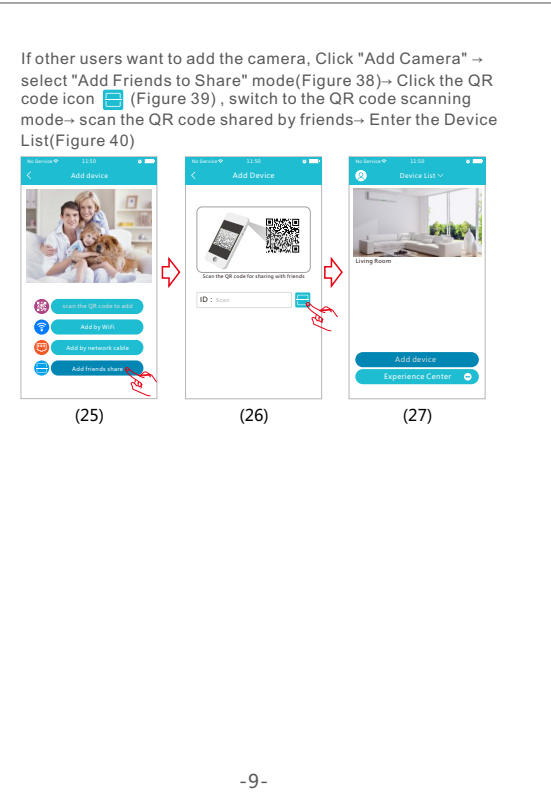
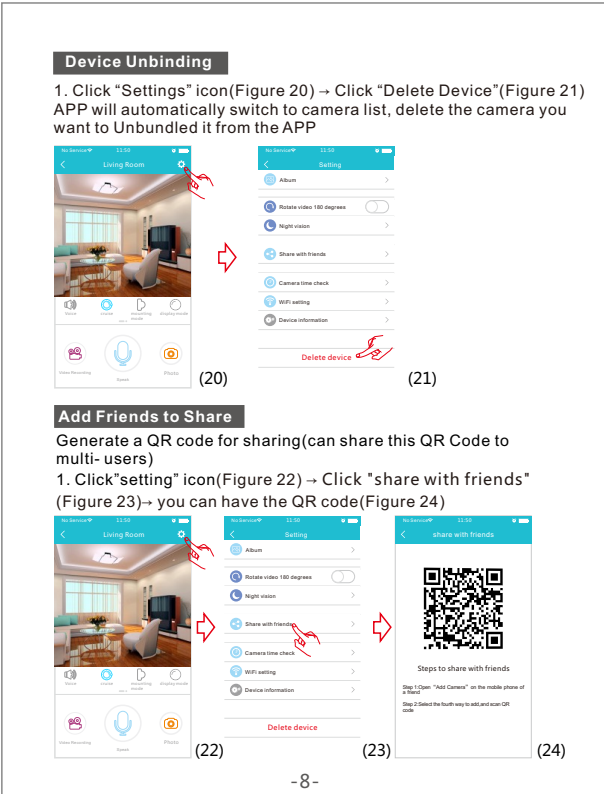
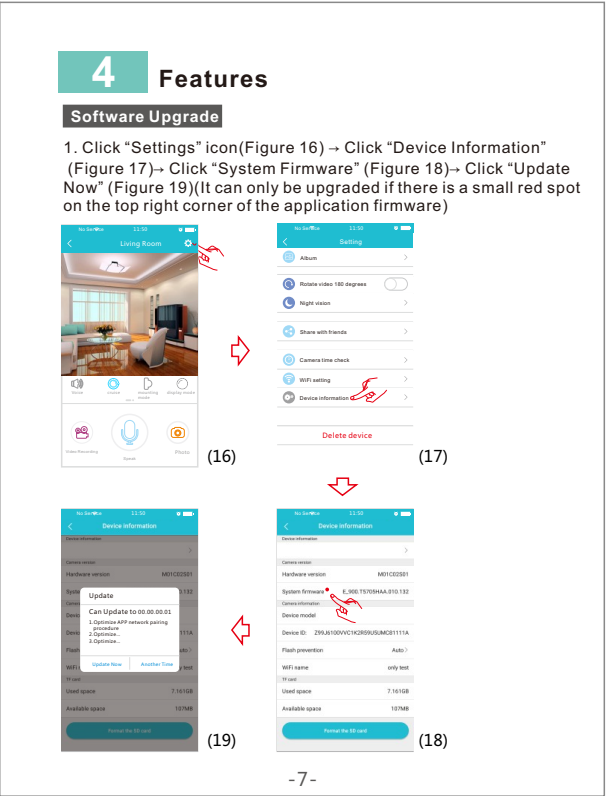
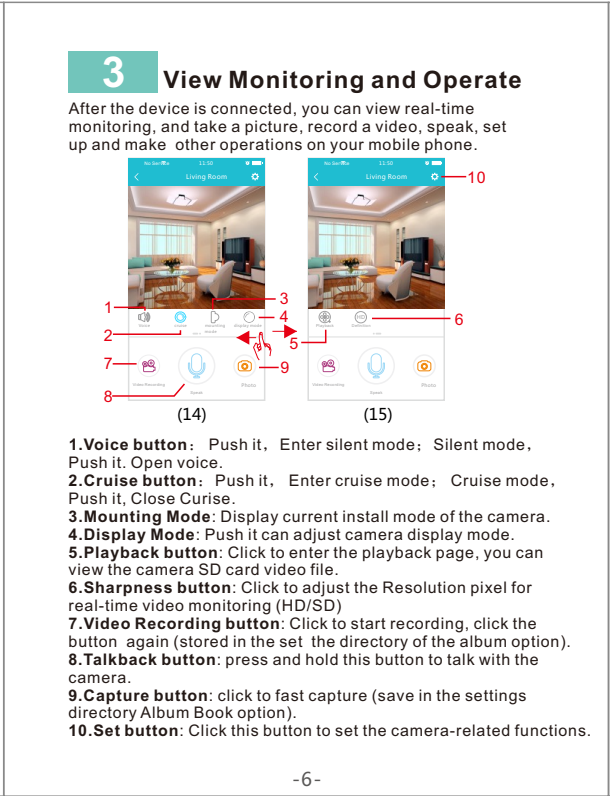
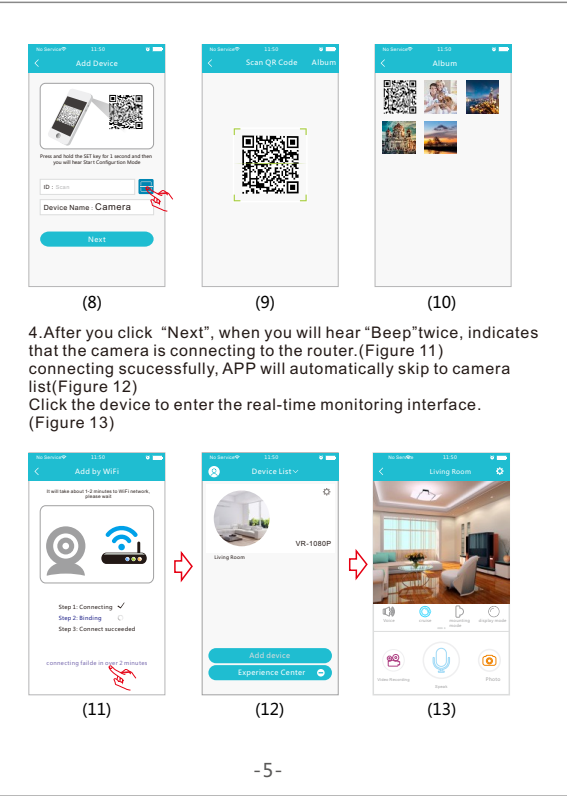
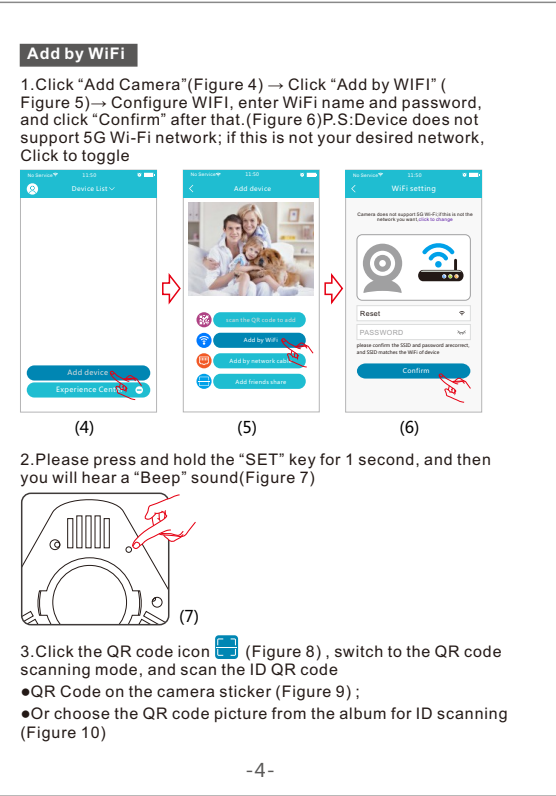
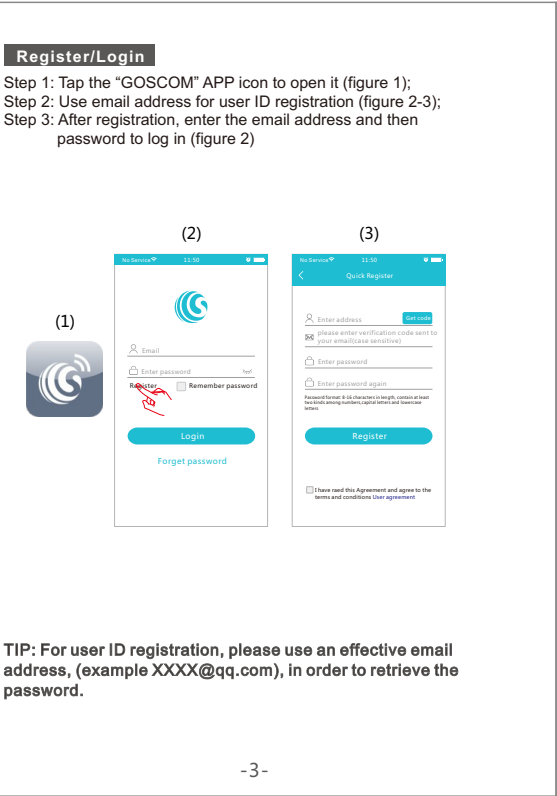

<div>5</div> <div>Product Specifications</div>	
Model No.	T5600HCA
Image sensor	CMOS
Camera resolution	1920x1080
viewing angle	360°
Night vision range	5m
Transmission Range	100 min the open
Operation voltage	DC+5V/1A
Operation temperature	-10℃ ~ + 50℃
Operation humidity	15% ~ 85% RH
Size (HxDxW)	85 x82 x40mm
Net weight	286g

