

## Appendix 1:

### Step 1:

Once your camera is set up, open the mydlink app and sign in using your mydlink account.

**Note:** If you are away from your home network, you must tap **Remote** before logging in. If you are at home, tap **Local** before logging in.

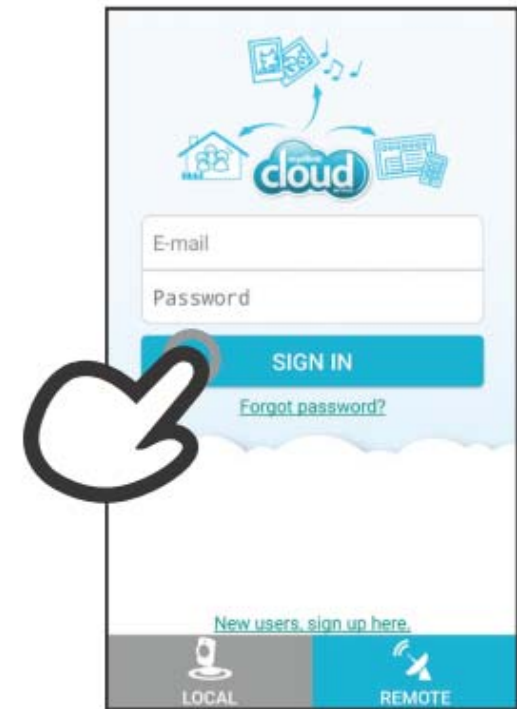

### Step 2:

Tap **Add a new Camera** to firstly setup your camera.



### Step 3:

If you have the QR code that is printed on device label, tap **Yes** and then scan the QR code.

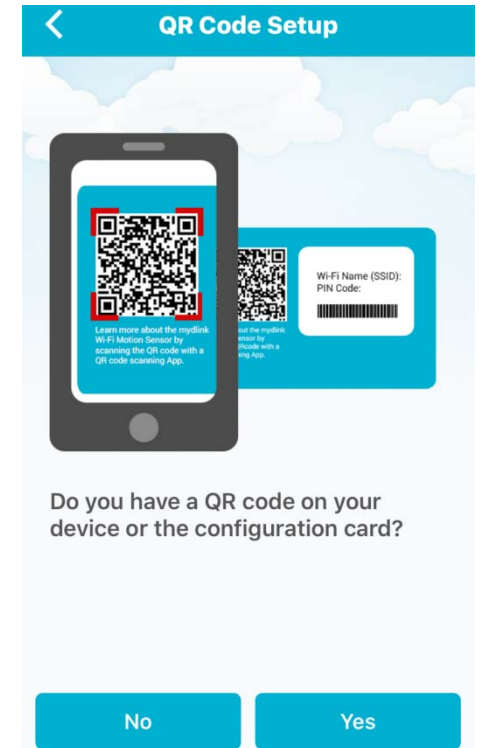

### Step 4:

Make sure your device is ready to setup. And turn on your Bluetooth module on your mobile device.

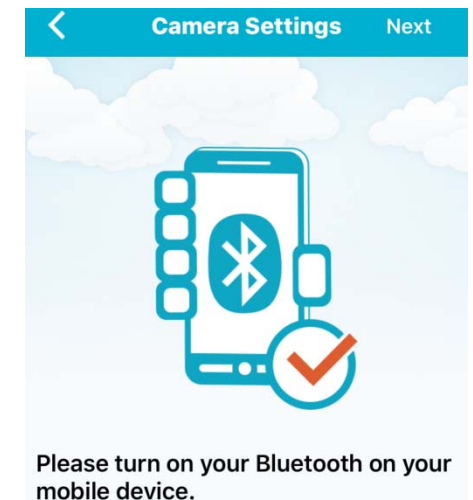

### Step 5:

Select the available router that you want to connect, and enter the WiFi password.

 **Wi-Fi Setting** [Next](#)

To ensure your Wi-Fi connection is stable, choose a Wi-Fi network with a strong signal. 

Home Router

### Step 6:

Change camera's password to protect your device.

 **Camera Settings** [Next](#)

Device Name DCS-8100LH  
mydlink No 12345678

Set a password to protect your camera.

**Password** Required

Your password is case-sensitive, must have 6 to 30 letters or numbers, and must have no spaces or symbols.

### Step 7:

Select the mydlink service option if you want to register your camera with mydlink service.

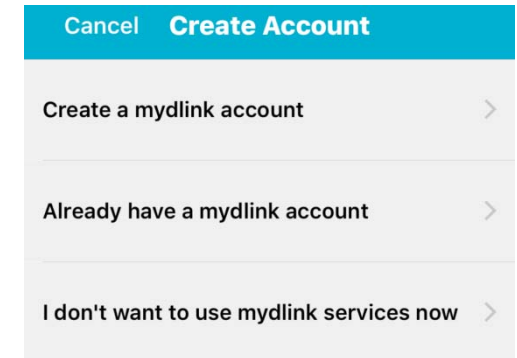

### Step 8:

After the setup procedure, app will scan for your DCS-8100LH. Once it is done scanning, tap the camera and you will be taken to its live view screen where you can monitor and control the camera functions in real time.

