

Mimitakara®



@goodHearing T1

User Manual

WELCOME	1
YOUR HEARING AID	2
ACCESSORIES	4
FEATURES	5
SET UP	6
Power ON / OFF	6
Wearing Instructions	7
Charging Instructions	9
PAIRING	12
Call Features	14
Notes & Tips	15
USER SUPPORT	17
Maintenance	17
Troubleshooting	19
Familiar with Hearing Aid	21
Warning and Reminder	23
FAQ	24
SPECIFICATION	26
LEGAL INFORMATION	27

WELCOME

Mimitakara welcomes you to join and to be a part of our global family. This is a fabulous decision for choosing Mimitakara Hearing Aids to accompany you in day-to-day life. If this is your first experience with Mimitakara products, believe us it's gonna be awesome and merely takes a few minutes to get familiar.

This user guide will take you through all its operations and initial setup. For a better user experience, we recommend wearing it throughout the day.

Mimitakara Connecting Hearts

YOUR HEARING AID

You have purchased T1, a goodHearing series device that uses our patented Millisecond Shift Technology to restore hearing loss. To suit your requirement in various environmental situations. It uses sound processing with Up to 8 channels combined with three different hearing modes, to suit your requirement in various environmental situations.

True wireless technology with our Hearing Aids capability in the latest T1 provides you to switch between the Bluetooth mode to Hearing Aid mode effortlessly and vice versa. You can easily answer your phone, watch TV, listen to music, enjoy high-quality listening all just with the help of T1.

Mimitakara One Product Many Solutions

Note: We strongly recommend seeking professional assistance first, understand hearing condition & eliminate pathological problems before wearing. Volume should be adjusted in moderation range, high volume may cause hearing damage.

Mimitakara TWS T1 is not intended for children under 3 years of age.

ACCESSORIES

- ① Wireless Charging Case
- ② Hearing Aid (Blue - Left Ear / Red - Right Ear)
- ③ Single-layer Earbuds: Large, Medium, Small
(The main body is equipped with Medium Earbuds)
- ④ Double-layer Earbuds: Medium, Small
- ⑤ Type C Charging Cable

①



②



③



④



⑤



FEATURES



SET UP

Learn more about your T1 hardware, assembling and charging, and how to get started using your new T1.

Power ON / OFF

- Power ON: Remove the T1 from the Wireless Charging Case, it will power on automatically.
- ※ It may not power ON if the battery is low, please recharge the unit before start using it.
- Power OFF: Place the T1 inside the Charging Case, it will turn off and start charging automatically.
- ※ Please store your T1 in the Charging Case when not using it.
- ※ Don't need to reset your setting, T1 will store your last hearing setting preference.

Wearing Instructions

Attach the Earbuds:

1. Select the Earbuds size that best fits your ear.
2. Hook the Earbud's groove to the T1 fixation hook on one side and gently pull the Earbud to cover the T1.

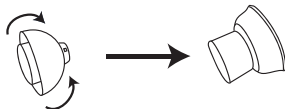

- ※ Do not pull the Earbud excessively when you attach or detach it because it may tear.
3. Follow the same procedure for the other T1.

Wear the T1:

Place the T1 in your ears correctly for a comfortable fit.



1. Insert the Earbuds into your ears with the T1 facing the bottom of your ears.
(Blue - Left Ear / Red - Right Ear)
2. Adjust the Earbuds by rotating them to the left or right to fit your ears comfortably.
Both Hearing Aids must fit tightly to avoid feedback sound (Will emit whistling sound if not fit tightly).

Charging Instructions





Your device case is also the charger.

1. Place the Hearing Aid Plugs into the Wireless Charging Case. Do not insert Plugs in the charging case if they are wet or dirty.
2. Close the charging case and connect the Type C cable as shown. The T1 and charging case are charged simultaneously.

Charging method:

The charging head for plugging the USB cable into a wall outlet not included. Use only charging devices rated with an output voltage of 5V and an output current of over 250mA (USB Adapter not included). It takes about 3 hours to charge and provides about 10 hours of continuous use of hearing aids when fully charged. Plug the USB Type C Charging Cable into the Wireless Charging Case and the other end into the USB Adapter (Self purchase).

Battery indicator instructions:

BATTERY INDICATOR	BATTERY LEVEL
	Below 25%
	50% Remain
	75% Remain
	100% Fully Charged

NOTE: You can check the battery level for the T1 in your smartphone. (On the battery section for iOS device, on top of the notification bar in Android device).

CAUTION:

- Charging speed or efficiency can vary depending on device condition or surrounding environment.
- When the hearing aid is not in use, immediately put it back into the charging case to charge,

if used completely without charging, will reduce the battery life.

- Continuously charge and discharge will also decrease the battery's health slowly, it is recommended to replace the battery every two years. Please visit the nearest store or contact the dealer, do not replace it by yourself.

PAIRING

To start using your Hearing Aid connect them to your device.

Connect the Hearing Aids to your phone:

To connect your Hearing Aids to a smartphone, install the goodHearing App on the smartphone. You can download the App from the Apple Store or the Google Play Store.

1. Removed your Hearing Aid from the charging case to enter Bluetooth pairing mode.

- Turn on your phone's Bluetooth device first, then click on the "Bluetooth" in Settings.
- Enter the Bluetooth configuration page, search and select **goodHearing T1** to pair.
- Once the pairing is successful, the connection is complete.

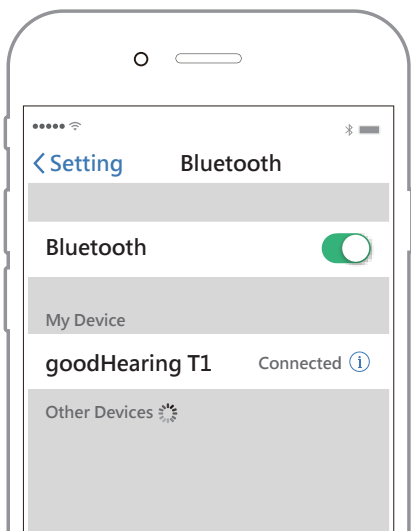

2. From the Apps screen of the smartphone, tap goodHearing App. If necessary, update the App to the latest version.
3. Tap Allow, Register / Sign In, and select your device.
4. Follow the prompts to complete the connection.

Disconnect:

To disconnect your Hearing Aid from a smart-phone, simply remove your Hearing Aid and place it back into the Wireless Charging Case.

Call Features

You can talk over the phone using your T1

Incoming Calls:

When you receive a call while wearing the Hearing Aids, the ringtone will play in the Hearing Aid. You can also configure your Hearing Aid say the phone number or name that is saved in your contacts of the incoming call.

Phone Controls:

Manage calls by tapping on your smartphone screen.

Notes

1. Turn on Bluetooth on your phone side (Host Bluetooth device).
2. Bluetooth hearing aids need to be paired with the same (Host Bluetooth device) only once. Next time the hearing aid starts, it automatically connects to the last connected device, if it's in range.

Tips

- This product has a rechargeable design and the battery can be used for approximately 2 years under normal operating conditions.
- To effectively extend the life of rechargeable batteries, when not in use for a long time, please charge the hearing aid battery before turning.
- Do not allow infants or involuntary persons to use this product.

- This hearing aid is strictly prohibited from self-disassembly, modification, repair ... such acts, the above behavior does not fall within the scope of a warranty.
- Before use, clean the ear canal and use it to prevent ear canal secretions from clogging the horn hole and affecting the quality of the receiver.
- Depending on the characteristics of the rechargeable battery, the volume will be weaker than usual when the battery is low;
- For those with hearing loss problems, please seek the assistance of a professional physician, understand their hearing conditions to eliminate pathological problems, and then wear the hearing aid will be good.
- Use the appropriate volume, too high volume can damage/ affect the hearing.

USER SUPPORT

Maintenance

- Clean the ear canal each time you use it



- After use, use a small brush to remove the earwax around the earbuds, be sure to keep the small holes in the earbuds open, to maintain long-term normal operation, earwax blockage may affect the effectiveness of hearing aids. Please try to keep your hearing aid dry and clean. Humid, earwax, ear water and so on will affect the service life and performance of the hearing aid.

1. Use a cleaning brush or a soft cloth to clean the hearing aids, microphones, and dirt on the charging holes.
2. Never clean your hearing aid with water, solvents, cleaning fluids, or cleaning oil.
3. If the hearing aid is not in use for a long time, charge it regularly every week and keep your hearing aid in the charging case.
4. Avoid direct sunlight, Keep at a dry & safe place.
5. Avoid excessive high and low temperatures.
6. Avoid places that are accessible to infants and young children.

Troubleshooting

For any reason, do not service your hearing aid yourself, that can easily cause more damage to the hearing aid and you. Refer to troubleshooting when your hearing aid is unusable or unusual. If the troubleshooting doesn't solve your problem, please contact initial point of purchase or our customer service team at:

www.digisineproducts.com

www.mimitakarahealth.com

Symptoms	Maybe the cause	Work-around
It's not loud enough	The battery is too low	Use after charging
	There is a blockage in the horn and earbuds	Clean the blockage or replace the earbuds
	Hearing values have changed	Please adjust the volume or contact customer support
	Dirt piles up	Clean the horn and microphone
Performance is not stable	The battery is too low	Use after charging
	There is a blockage in the horn and earbuds	Clean the blockage or replace the earbuds
The sound is not clear / distortion / no sound	The battery is too low	Use after charging
	There is a blockage in the horn and earbuds	Clean the blockage or replace the earbuds
	There is a problem with the hearing aid	Please contact the customer support
Hearing aids whistling	The horn is not plugged properly into the ear canal	Please plug the horn into the ear canal
	The earbuds are not the right size	Replace the appropriate size earbuds

Familiar with Hearing Aid

The average user is expected to take weeks to get completely used to hearing aids. You must practice repeatedly until the brain can adapt to the new sounds provided by hearing aids. Hearing is part of sharing thoughts, plans, and senses.

Reading lips, facial expressions, and gestures can help and smoothen the learning process.

The parts that your family and friends need to be aware of

1. Ask the user to focus before the conversion.
2. In a quiet environment, let the user watch himself talk.
3. Speak clear & gently. Speaking loudly/ too low makes speech comprehension worse.
4. Avoid repeating the same word when you can't hear clearly, and try other synonyms to increase understanding.

The section that the user should pay attention to

1. Approach and watch the speaker with focus.
2. Choose to talk in a quiet environment and sit face-to-face with the speaker.
3. Try different locations to find the best listening position.
4. Background noise may make you feel a little uncomfortable and depressed, but please be patient. Try to listen to information when the background noise is reduced.
5. Let others know what you need, and note that the average person is "uninformed" about your hearing.
6. Proper expectations and try to understand the limits of hearing aid capabilities.
7. Using hearing aids is a learning process that combines longing, repeated practice, and patience.

Warning and Reminder

- Keep the device dry
- Keep away from direct sunlight
- Keep away from reach of children
- Keep away from high temperature areas
- Avoid liquid near the device
- Avoid discharging the battery for long periods
- Avoid overcharging the device for excessive time periods
- Do not use the device at high volumes
- Do not listen for excessive time periods
- Do not attempt to fix the unit yourself, take it to an authorized dealer
- Ensure the earphones are fitted securely in the ear to reduce sound leak

FAQ

No Sound

- Increase the volume in the App
- Clean out the Earbuds
- Recharge the Hearing Aid
- Reinsert the hearing aids until it fit tightly
- Wait several seconds and check again

Sound distorted

- Clean or exchange the Earbuds
- Reinsert the hearing aids until it fit tightly

Can't power on

- Out of battery and needs to be charged

Charging problems

- Check that the USB is connected correctly
- Ensure that the power supply is normal
(Wall outlet switch is on)

Is it compatible for both Android and iOS systems?

Yes, is compatible for both Android and iOS systems

There is a lag when I change from listening to media on my phone and back to the hearing aid function is this normal?

Yes, there may be up to 5 second delay depends on the operating system you currently running on your phone

Can I pick up phone calls with the hearing aid?

Yes, you can, depend on Android or iOS system, your phones will have a default tone that the hearing aid will play as a ringtone

SPECIFICATION

Max. Output @ SPL 90 dB

120 ± 5 dB

Max. Gain

35 ± 5 dB

Continuous Use

Up to 10 hours per charge

Listening Mode

5 Modes

Suitable for

People with Mild to Moderate hearing loss

Storage Temperature:

14°F ~ 140°F

Storage Humidity

30% ~ 85%

Dimension

44 x 20 x 27mm

Weight

42.2g

Place of Origin

Taiwan

LEGAL INFORMATION

Warranty

1. Mimitakara provides a one-year warranty,
2. Under normal conditions use, provides free repair services. Earplugs, horns, horn lines, (Personal hygiene accessories are not covered by the warranty)
3. The product improperly handled/ miss-used/ damaged shall be charged at the discretion when they need to be repaired.
4. Serious damage product or self-disassembly or modification will not be repaired.
5. Damage caused by uncontrolled factors such as natural disasters and fires is not covered in the warranty.
6. If you need repair services, please send the product with the warranty form to the company.
7. 30 day risk free money back guarantee
8. 31 to 60 days restocking fee

FCC

Federal Communications Commission (FCC) Statement

15.105(b)

This equipment has been tested and found to comply with the limits for a Class B digital device, pursuant to part 15 of the FCC rules. These limits are designed to provide reasonable protection against harmful interference in a residential installation.

This equipment generates, uses and can radiate radio frequency energy and, if not installed and used in accordance with the instructions, may cause harmful interference to radio communications. However, there is no guarantee that interference will not occur in a particular installation.

If this equipment does cause harmful interference to radio or television reception, which can be determined by turning the equipment off and on, the user is encouraged to try to correct the interference by one or more of the following measures:

- Reorient or relocate the receiving antenna.
- Increase the separation between the equipment and receiver.
- Connect the equipment into an outlet on a circuit different from that to which the receiver is connected.
- Consult the dealer or an experienced radio/TV technician for help.

15.21

You are cautioned that changes or modifications not expressly approved by the part responsible for compliance could void the user's authority to operate the equipment.

FCC RF Radiation Exposure Statement:

1. This Transmitter must not be co-located or operating in conjunction with any other antenna or transmitter.

2. For portable operation, this device has been tested and meets FCC RF exposure guidelines. When used with an accessory that contains metal may not ensure compliance with FCC RF exposure guidelines.

This device complies with Part 15 of the FCC Rules.

Operation is subject to the following two conditions:

- 1) this device may not cause harmful interference and
- 2) this device must accept any interference received, including interference that may cause undesired operation.

