

80.00 mm

3704.10.5101.01说明书
成品尺寸：80*103MM
材质工艺：105G双铜+风琴4折5面+打圆角

103.00 mm



TWS Weetla U-Air+

True Wireless Earbuds Model: U-Air+

Package Contents

- ① Ear Hooks(3 pairs)
- ② Earbuds(L/R)+ Charging Case
- ③ USB-C Charging Cable
- ④ Ear Tips(3 pairs)
- ⑤ User Manual

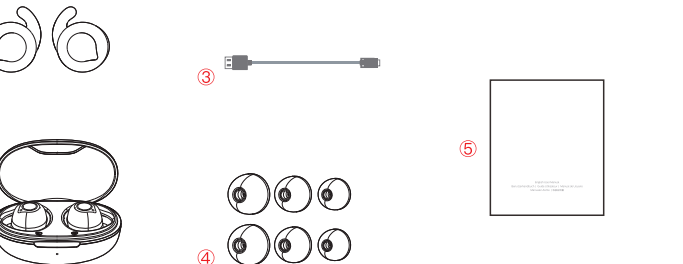

Product Parts

- ① Charging Case
- ② Charging contacts
- ③ Charging Case Indicator Light
- ④ Ear Hooks
- ⑤ Ear Tips
- ⑥ Earbuds Indicator Light
- ⑦ Touch Button
- ⑧ Microphone
- ⑨ USB-C Charging Interface

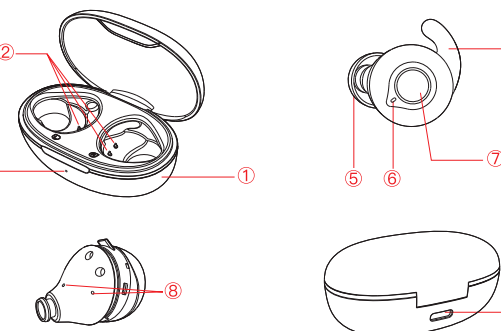

Replace Ear Tips

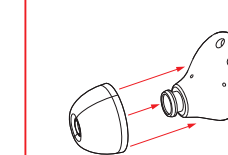

Replace Ear Hooks

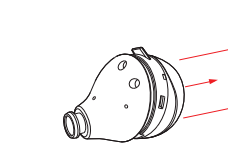

Earbuds wear

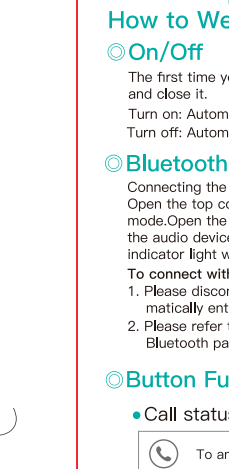

Note: When wearing the ear wings, rotate the direction of the ear Hooks according to your comfort.

How to Replace the Era Tips and Ear Hooks How to Wear the Earbuds

On/Off

The first time you use the earbuds, please tear off the insulation sticker, put it in the charging case, and close it.
Turn on: Automatic power on when opening the charging case
Turn off: Automatic power of when puffing the earbuds into the charging case and closing the cover.

Bluetooth Connection Guidelines

Connecting the earbuds with a Bluetooth device.
Open the top cover of the charging case, and the earbuds will automatically enter the Bluetooth pairing mode. Open the Bluetooth function in the Bluetooth device, refresh the Bluetooth device search and click the audio device named "Weetla U-Air+" to connect. After successfully connecting, the earbuds indicator light will turn off.
To connect with other devices, please follow the below two ways:
1. Please disconnect the earbuds with the currently connected Bluetooth device, and the earbuds will automatically enter the Bluetooth pairing mode.
2. Please refer to the Earbuds reset operation. After successfully resetting, the earbuds will enter the Bluetooth pairing mode.

Button Functionality

Call status

	To answer the call	Double-click the MFB button of any headset to answer the call
--	--------------------	---

	To hang up the call	Double-click the MFB button of any headset to hang up the call
	To reject the call	Press and hold any headset MFB button for 2 seconds
	Cancel dialling	Double-click any headset function key to cancel dialling

Music status

	Play/Pause	One-touch any headset MFB button, you can pause the music
	Previous song	Double-click the left earphone MFB button to switch to the previous song
	Next song	Double click the MFB button on the right earphone to switch to the next song
	Volume +	In music mode/call mode, long press the right ear MFB button to increase the volume, release the volume to stop increasing.
	Volume -	In music mode/call mode, long press the left ear MFB button to decrease the volume, release the volume to stop the decrease
	Siri/Google Assistant	Siri/Google Assistant is in standby/music state, click 3 times to start Siri, operate again to exit
	To clear the pairing information	Press and hold the left and right ears for 10 seconds when the device is turned off

Earbuds Indicator Light Display

Bluetooth Pairing: Green light flashes slowly.
Successful Connection: The Indicator light is off.
Low Battery: Green light flashes every 20 seconds.

Charging Case Indicator Light Display

- 1. Charging case battery is low: Blue light flashes four times and then turns off when opening the cover of charging case.
- 2. Charging case is charging: Red light flashes slowly.
- 3. Charging case is fully charged: Red light turns on.

Charging Guidelines

- 1. Charging the earbuds: Put the earbuds into the charging case, then close the cover to start the automatic charging.
- 2. Charging the charging case: Plug one end of the USB cable into a power supply that supports 5V output, and the other end into the charging port of the charging case. When the charging case battery is fully charged, the red light will be on.
Charging time: about 120 min

How to Reset the Earbuds

When the earbuds are powered off, press and hold simultaneously the left and right earbuds touch buttons for 10 seconds. The green light of the earbuds will flash twice, indicating that the earbuds are successfully reset.
Note: After resetting, if there is a Bluetooth device that has been connected to the earbuds, you need to delete the pairing record to allow the earbuds to be discovered and paired again.

Left & Right Earbuds Pairing Guidelines

Firstly, disconnect the earbuds from the Bluetooth device, put the left and right earbuds into the charging case and close the cover of the charging case to turn off the earbuds. Take both earbuds out of the charging case at the same time, and the earbuds will enter pairing mode (green light flashes slowly).

Then, triple-tap separately the touch button on the left and right earbuds to start pairing each other (green light will flash quickly). After a few seconds, the green light on the left earbud will flash slowly, and the green light on the right earbud will be off, indicating that the left and right earbuds are successfully paired and connected.
Note: Only when the left and right earbuds lose connection.

Specifications

Bluetooth version	BTS 2
Support protocol	A2DP, AVRCP, HSP, HFP
Bluetooth distance	10m
Speaker specification	10mm dynamic coil
Frequency response range	20HZ-20KHZ
Earbuds battery capacity	40mAh/3.7V
Charging case battery capacity	500mAh/3.7V
Maximum transmission power	8dm(Typ)

FCC statement

Changes or modifications not expressly approved by the party responsible for compliance could void the user's authority to operate the equipment. This equipment has been tested and found to comply with the limits for a Class B digital device, pursuant to Part 15 of the FCC Rules. These limits are designed to provide reasonable protection against harmful interference in a residential installation. This equipment generates uses and can radiate radio frequency energy and, if not installed and used in accordance with the instructions, may cause harmful interference to radio communications. However, there is no guarantee that interference will not occur in a particular installation. If this equipment does cause harmful interference to radio or television reception, which can be determined by turning the equipment off and on, the user is encouraged to try to correct the interference by one or more of the following measures:
— Reorient or relocate the receiving antenna

- Increase the separation between the equipment and receiver.
- Connect the equipment into an outlet on a circuit different from that to which the receiver is connected.
- Consult the dealer or an experienced radio/TV technician for help. This device complies with part 5 of the FCC rules. Operation is subject to the following two conditions:
(1) this device may not cause harmful interference –no, and
(2) this device must accept any interference received, including interference that may cause undesired operation.



support@weetla.com



www.weetla.com

Thank you for purchasing the Weetla earbuds. For more latest products, parts and accessories. Please visit: www.weetla.com

For any assistance, please contact
Phone number: +1 209-718-4733
Email: support@weetla.com

FCC STATEMENT :

This device complies with Part 15 of the FCC Rules. Operation is subject to the following two conditions:

- (1) This device may not cause harmful interference, and
- (2) This device must accept any interference received, including interference that may cause undesired operation.

Warning: Changes or modifications not expressly approved by the party responsible for compliance could void the user's authority to operate the equipment.

NOTE: This equipment has been tested and found to comply with the limits for a Class B digital device, pursuant to Part 15 of the FCC Rules. These limits are designed to provide reasonable protection against harmful interference in a residential installation.

This equipment generates uses and can radiate radio frequency energy and, if not installed and used in accordance with the instructions, may cause harmful interference to radio communications. However, there is no guarantee that interference will not occur in a particular installation. If this equipment does cause harmful interference to radio or television reception, which can be determined by turning the equipment off and on, the user is encouraged to try to correct the interference by one or more of the following measures:

- Reorient or relocate the receiving antenna.

- Increase the separation between the equipment and receiver.

- Connect the equipment into an outlet on a circuit different from that to which the receiver is connected.

- Consult the dealer or an experienced radio/TV technician for help.

RF warning statement:

The device has been evaluated to meet general RF exposure requirement. The device can be used in portable exposure condition without restriction.

- English: "

This device complies with Industry Canada licence-exempt RSS standard(s). Operation is subject to the following two conditions:
(1) this device may not cause interference, and
(2) this device must accept any interference, including interference that may cause undesired operation of the device."

- French:"

Le présent appareil est conforme aux CNR d'Industrie Canada applicables aux appareils radio exempts de licence. L'exploitation est autorisée aux deux conditions suivantes :
(1) l'appareil nedit pas produire de brouillage, et
(2) l'utilisateur de l'appareil doit accepter tout brouillage radioélectrique subi, même si le brouillage est susceptible d'en compromettre le fonctionnement."