



LOGIC
T10L
10" 4G TABLET

QUICK GUIDE / GUÍA RÁPIDA

INDEX

1. Safe Notice.....
2. Device Overview.....
3. Basic Operation.....
3.1 Boot.....
3.2 Shutdown.....
3.3 Standby.....
3.4 Restart.....
3.5 Install SIM Card and TF Card.....
3.6 Connect Network.....
3.7 Connect to Bluetooth Devices.....

1
2
3
3
3
3
4
4
4
5

1. Safety Notices

- 1
2
3
4
5
6
7
8
9
10

Avoid dropping the unit on the ground or by other strong impact.
Do not use in extreme cold, heat (<35°C), excessively humid, dusty environment, long-term use, do not let the machine in the sun.
Try to avoid using in magnetic or electrostatic environments.
If water or other liquids where to spill on the unit then immediately shut it down and wipe the device dry before using it again.
Do not use any cleaner or other liquid containing chemical ingredients to clean the machine to avoid corrosion and moisture damage, if absolutely necessary cleaning, use a soft, dry cloth or paper towel.
The company's hardware and software were non-normal operation, the machine repair or other data loss resulting from unforeseen circumstances or delete is not responsible for, nor bear the losses caused.
When using the file card of T-Flash, do not remove the card to avoid damage to the memory card or device.
Please feel free to back up your important data to avoid loss.
Do not disassemble the unit, otherwise it will lose warranty rights.
Manuals and software may sometimes update at any time without notice, causing discrepancies, please prevail in kind.

2. Device Overview

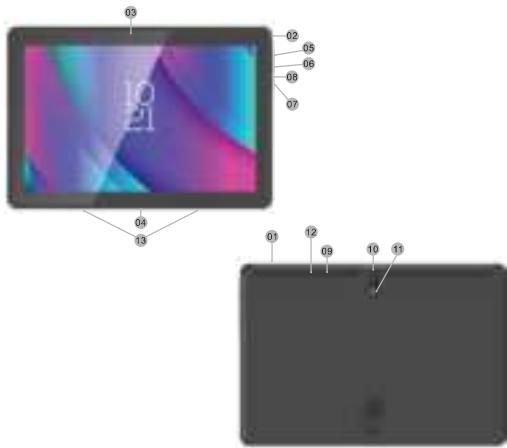

- 1) **Type-C connector:** Type-C interface can read and write U disk / removable hard disk and other equipment data.
- 2) **Headphone jack:** You can connect a 3.5 mm stereo headset.
- 3) **Front camera:** You can take pictures and video.
- 4) **Microphone:** Your voice can be heard by the other person during a voice call.
- 5) **Volume up key:** Press this button to increase the volume.
- 6) **Volume down key:** Press this button to decrease the volume.

- 7) **Power button:** You can use the power button to power on/off, standby or wake up the device.
- 8) **Reset button:** Press this button to restart the device.
- 9) **TF card reader:** Support Micro SD, maximum capacity to 128GB.
- 10) **Rear camera:** You can take pictures and video.
- 11) **Flash light:** Provides LED lighting for darker environments.
- 12) **SIM card slot:** It can support 1 SIM Card.
- 13) **Speakers:** Built-in speakers allow you to hear the sound without linking extra equipment.

3. Basic Operation

3.1 Boot

Press the On/Off button 3-5 seconds and release the seed.
(Note: There is no response when you press the power button, the device may need to recharge).

3.2 Shutdown

- ① Press and hold for 4 seconds to enter the shutdown screen, and then click "Shut Down".
- ② Press for 10 seconds to force shut down.

3.3 Standby

In the power-on state short press the power button to enter standby or wakes up from standby.

3.4 Restart

Press and hold for 4 seconds to enter the shutdown screen, and then click "Restart".

3.5 Install SIM Card and TF Card

• Install SIM Card

When installing the SIM card, the device must be turned off first

- 1) In the back side of the tablet locate the groove along the upper right corner to remove the SIM and TF cover.
- 2) Insert a SIM Card into the SIM Card slot as indicated on the engraved illustrations on the device.
- 3) Finally press the boot button to start using the phone card and the internet.

• Install TF Card

Insert the TF Card in the TF Card slot as illustrated in the image bellow to access its content of the TF card. Support insert or remove.

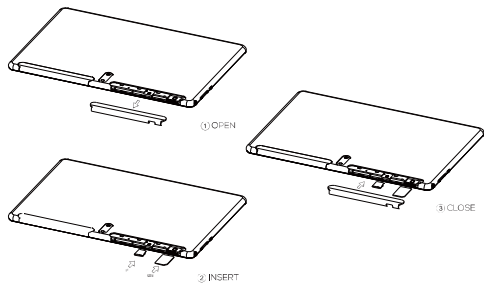

3.6 Connect Network

- 1) In the main menu or interface, choose setting application procedure.
- 2) Click "Network & Internet", open Wi-Fi, MID will automatically search the available W-Fi wireless internet.



- 3) Choose the Wi-Fi internet you want to connect, if it has password, it will popup the password window, enter password, click connect.
- Once connected you may set up your email, browse the web and access online content.

3.7 Connect to Bluetooth Devices

Bluetooth function operation

- 1) Click setting application in main menu interface.
- 2) Click connected devices.
- 3) Click bluetooth.
- 4) Turn On the bluetooth feature to start searching for nearby devices.
- 5) Click the available bluetooth device you want to connect to and a prompt will appear requesting to enter password and other device related information to connect.



- 6) After pairing is successful you may choose the operation you want to execute.

LOGIC
makes sense

This device complies with Part 15 of the FCC rules. Operation is subject to the following two conditions: 1) this device may not cause harmful interference, and 2) this device must accept any interference received, including interference that may cause undesired operation.

Note: This equipment has been tested and found to comply with the limits for a Class B digital device, pursuant to part 15 of the FCC Rules. These limits are designed to provide reasonable protection against harmful interference in a residential installation. This equipment generates uses and can radiate radio frequency energy and, if not installed and used in accordance with the instructions, may cause harmful interference to radio communications. However, there is no guarantee that interference will not occur in particular installation. If this equipment does cause harmful interference to radio or television reception, which can be determined by turning the equipment off and on, the user is encouraged to try to correct the interference by one or more of the following measures:

--Reorient or relocate the receiving antenna.

--Increase the separation between the equipment and receiver.

--Connect the equipment into an outlet on a circuit different from that to which the receiver is connected.

--Consult the dealer or an experienced radio/TV technician for help.

Changes or modifications not expressly approved by the party responsible for compliance could void the user's authority to operate the equipment.

Specific Absorption Rate (SAR) certification information

The device conforms to U.S. Federal Communications Commission (FCC) standards that limit human exposure to radio frequency (RF) energy emitted by radio and telecommunications equipment. These standards prevent the sale of mobile devices that exceed a maximum exposure level (known as the Specific Absorption Rate, or SAR) of 1.60W/kg. SAR information on this and other model devices can be accessed online on the FCC's website through transition.fcc.gov/oet/rfsafety/sar.html.

In normal use, the actual SAR is likely to be much lower, as the device has been designed to emit only the RF energy necessary to transmit a signal to the nearest base station. By automatically emitting lower levels when possible, your device reduces your overall exposure to RF energy.

The FCC has granted an Equipment Authorization for this model device based on the compliance of all reported SAR levels with the FCC RF exposure guidelines. This device has a FCC ID:O55104320 and the specific SAR levels for this device can be found at the following FCC website : www.fcc.gov/oet/ea/.

To maintain compliance with FCC RF exposure requirements, use accessories that maintain a 10mm separation distance between the user's body and the back of the handset. The use of belt clips, holsters and similar accessories should not contain metallic components in its assembly. The use of accessories that do not satisfy these requirements may not comply with FCC RF exposure requirements, and should be avoided.

Radiation Exposure Statement

This device complies with RF radiation exposure limits set forth for an uncontrolled environment. This transmitter must not be co-located or operating in conjunction with any other antenna or transmitter.