

50mm

80mm

**Selfie Stick Instructions:**

FCC ID: QIFA010

**To Use with iOS Devices:**

Move the power switch to the ON position. A blue light will flash indicating the device is ready to pair with your smart phone.

Ensure your smart phone has Bluetooth enabled. Select "Selfie Stick" from available devices to pair. The blue light will turn off when paired successfully.

Open the camera app on your smart phone and select the touch screen facing camera.

Load your smart phone into the adjustable cradle. The rubber attachment maybe required for smaller smart phones.

Adjust the selfie stick to a suitable length and angle. The button on the rubber portion of the handle can be used to activate the shutter.

**Charge:**

Using the Micro USB cable included connect the selfie stick to a computer's USB port or a USB compatible AC wall adapter. A red light will glow to indicate it is charging. The light will turn off once it is fully charged.

**Specifications:**

Battery Capacity : 55mAh  
Charging Voltage : 5V  
Charging Time : 1 hour  
Compatibility : Android and iOS smart phones

**To Use with Android Devices:**

Move the power switch to the ON position. A blue light will flash indicating the device is ready to pair with your smart phone.

Ensure your smart phone has Bluetooth enabled. Select "Selfie Stick" from available devices to pair. The blue light will turn off when paired successfully.

Open the camera app on your Android device.

Ensure that the front facing camera is activated.

Load your smart phone into the adjustable cradle. The rubber attachment maybe required for smaller smart phones.

Adjust the selfie stick to a suitable length and angle and press the Selfie Stick shutter button marked: "PRESS" on the Selfie Stick handle to take photos.

**Some Android devices work differently with this item:**

For some devices, the shutter button works as a zoom function once it's connected via Bluetooth.

- Open the camera, click on the Settings icon (gear shaped icon). Continue to click on the icon in the top right corner of the gear to get into the next layer.
- Continue to select the settings icon until the following screen is visible:



- Click on "Volume Key" or "Zoom Key":

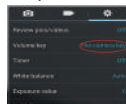

- In this menu, choose "Camera Button" to have the button on the handle function as a shutter button. To use it as a zoom function, select "Zoom Button" as shown:

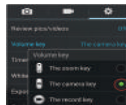

- Exit the Settings window and return to camera mode. The remote button on the handle will now work as a camera shutter or zoom button.

Some Android devices will be required to download the free app called "Camera 360" in order to use the settings mentioned above.

iOS 4.0 / Android 4.0 required.

Made in China

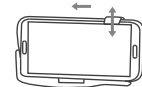
**Loading Smartphones Into the Cradle**

Insert mobile phone into the phone clamp by sliding or lifting the spring loaded side clamp.

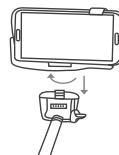

The clamp is then affixed to the extension arm screw.



Follow the instructions to connect your smartphone via Bluetooth. Activate your smartphone's camera application.



Extend the telescopic arm via the extension arm to desired distance.



When desired position is reached and in focus, press shutter button located on the extension arm handle.

NOTE: This equipment has been tested and found to comply with the limits for a Class B digital device, pursuant to part 15 of the FCC Rules. These limits are designed to provide reasonable protection against harmful interference in a residential installation. This equipment generates uses and can radiate radio frequency energy and, if not installed and used in accordance with the instructions, may cause harmful interference to radio communications. However, there is no guarantee that interference will not occur in a particular installation. If this equipment does cause harmful interference to radio or television reception, which can be determined by turning the equipment off and on, the user is encouraged to try to correct the interference by one or more of the following measures:

- Reorient or relocate the receiving antenna.
- Increase the separation between the equipment and receiver.
- Connect the equipment into an outlet on a circuit different from that to which the receiver is connected.
- Consult the dealer or an experienced radio/TV technician for help.

Changes or modifications not expressly approved by the party responsible for compliance could void the user's authority to operate the equipment. This device complies with Part 15 of the FCC Rules. Operation is subject to the following two conditions:

- (1) this device may not cause harmful interference, and
- (2) this device must accept any interference received, including interference that may cause undesired operation.

材质:128G铜版纸