

## Installation (continued)

- Carefully feed the fan's electrical wiring through the motor housing cap (G), then install the cap as shown.

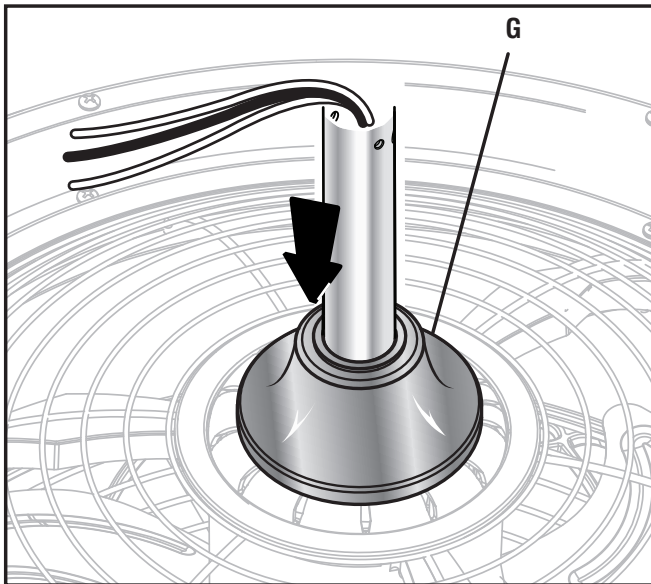

- Carefully feed the fan's electrical wiring through the center arm support (E), then install the support (E) with the cupped side facing up.



**NOTE:** If you do not intend to use the decorative arms (F) supplied with this ceiling fan, you can skip this step because the center arm support (E) will not be needed. However, if you are installing using an extended-length downrod (not provided), you may still wish to use the center arm support (E) and the cover discussed in the next step for a more finished appearance, even when not using the decorative arms (F).

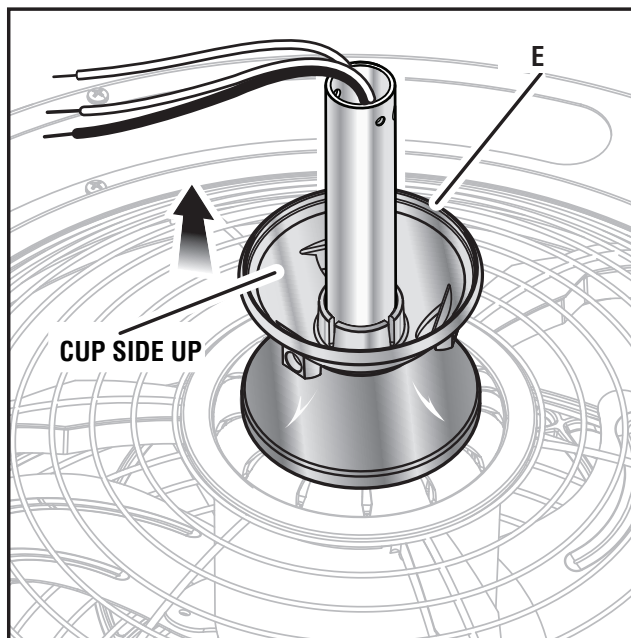

- This step is needed only if you are installing your ceiling fan using an extended-length downrod (not provided) and have installed the center arm support (E) from the previous step. If you are using the downrod (B) provided in this package, or if you are using an extended-length downrod but chose not to install the center arm support (E), skip this step and proceed directly to installing the canopy screw cover ring (D) and canopy (C).
- Carefully feed the fan's electrical wiring through the center arm support cover (M), then install the support with the cupped side facing down.

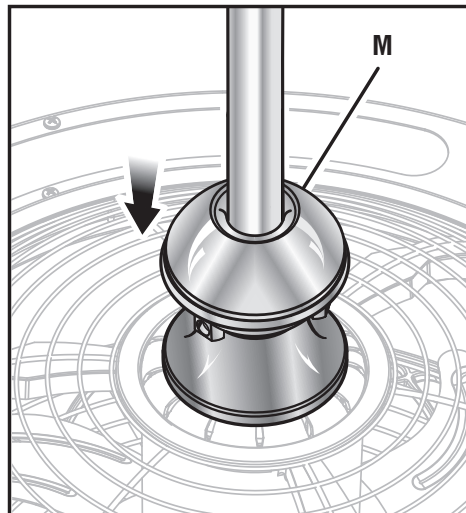

- Carefully feed the fan's electrical wiring through the canopy screw cover ring (D) and canopy (C), then install the cover ring (D) and canopy (C) on the downrod (B) as shown.



**NOTE:** Make sure the notched openings on the rim of the canopy screw cover ring (D) are facing up.

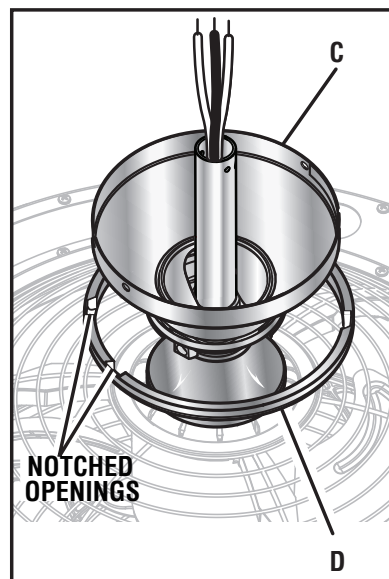

## Installation (continued)

- Carefully feed the fan's electrical wiring through the pivot ball, then reinstall the pivot ball on the downrod (B) with the flat side facing the ceiling.

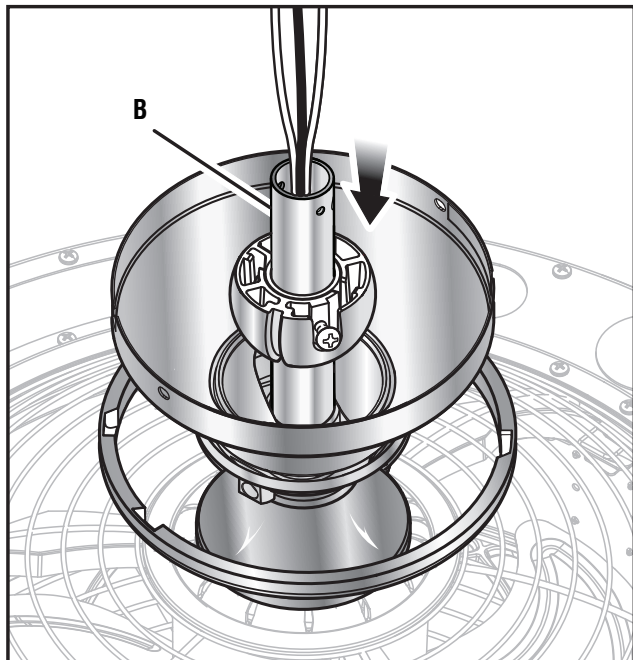

- Reinstall the ground wire with the wire facing up to ensure proper grounding. Make sure the star washer is reinstalled in the location shown below.

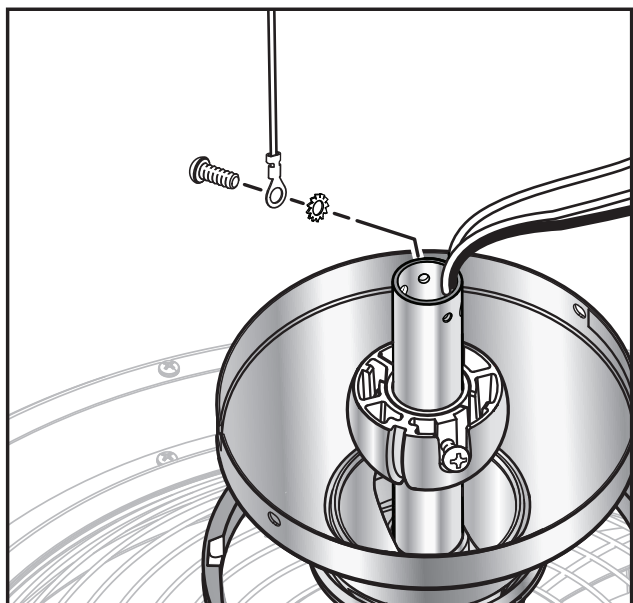

- Reinstall the retainer pin (N) in the downrod (B).

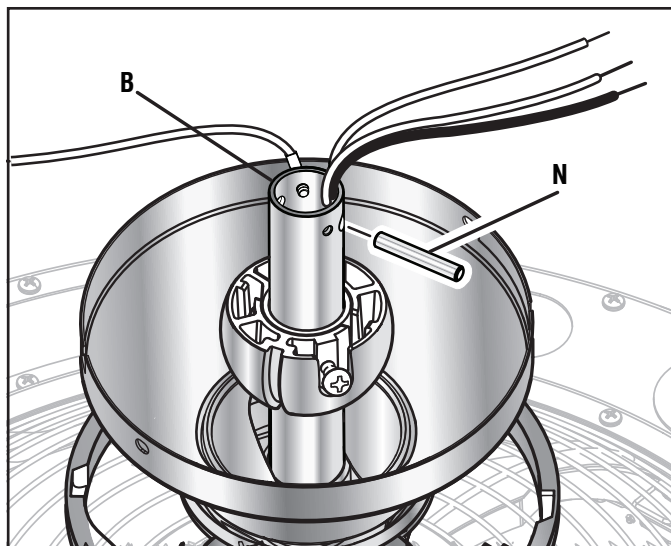

**STOP** For Canadian installations, refer to the Canada Installation Addendum and install the support cable on the retainer pin (N) now.

- Lift the pivot ball back to the top of the downrod (B) until the retainer pin (N) is captured. Tighten the screw to secure.



**NOTE:** When the pivot ball is oriented correctly on the downrod (B), it will also cover the ground screw and will be flush with the top of the downrod (B).

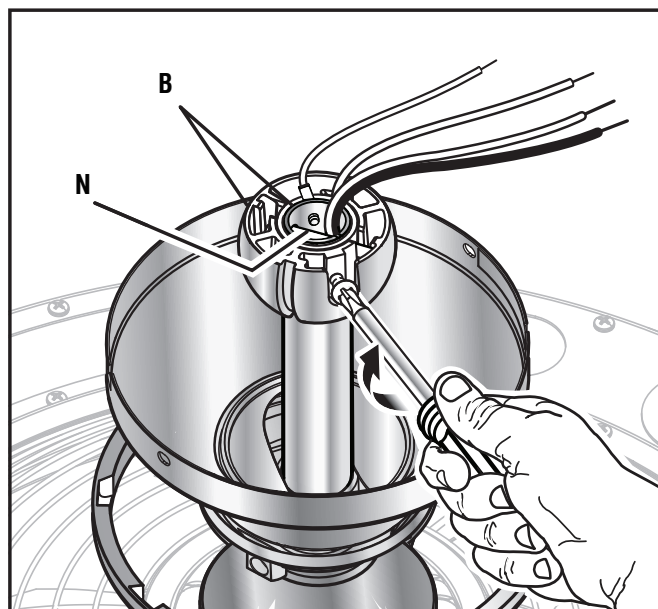

## Installation (continued)

### 3 Hanging The Ceiling Fan



#### WARNING

Once you begin the process of hanging the ceiling fan, do not leave the fan unattended until the installation process is complete.

- Carefully lift the assembled fan up to the mounting bracket assembly (A) and seat the pivot ball portion of the downrod (B) in the mounting bracket socket (A). Rotate the fan as needed so the tab on the mounting bracket socket (A) seats in the groove in the pivot ball (B).



#### WARNING

Failure to engage the fan's tab into the groove on the mounting bracket (A) could allow the fan to wobble and/or fall. A falling fan could cause serious personal injury or death.

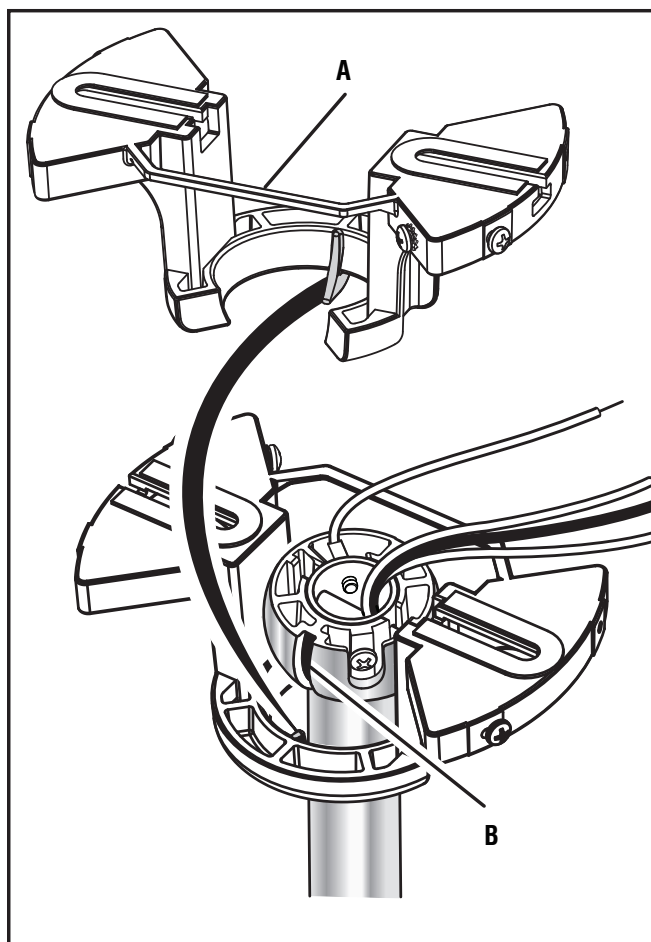

- Verify the remote receiver (I) and the remote control (J) are paired. To pair the fan with the remote control, press and hold the POWER button and the AIRFLOW DOWN button at the same time within 30 seconds after the ceiling fan is powered on, until a beep sound is played that indicates devices successfully paired. Power off and repeat the above method to re-pair if the pairing fails.

POWER BUTTON

AIRFLOW DOWN BUTTON

