

# Bullet 8TE

ORIGINALITY DESIGN SMART - AND BEAUTIFUL

.....



## QUICK GUIDE

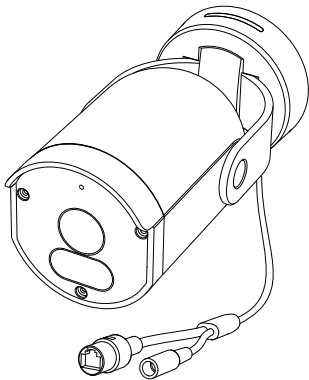

# What's in the box

Consult the checklist below for all components.



Camera



Power adapter



Screw package

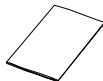

Manual



Screwdriver

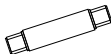

Waterproof terminal

## Description

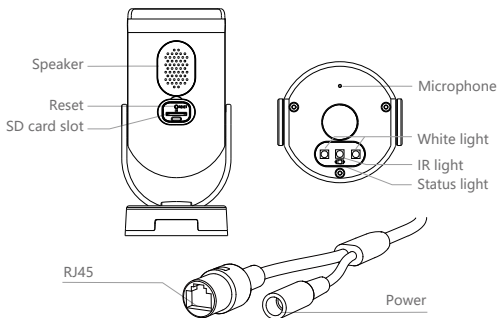

Power	12V/1A
-------	--------

- |              |   |
|--------------|---|
| Status light | <ul style="list-style-type: none"><li>• Blinking red light: wait for network connection (slow)<br/>connecting the network (fast)</li><li>• Solid blue light on: camera is working correctly</li><li>• Solid red light on: camera is malfunctional</li></ul> |
|--------------|---|

Microphone	Capture sound for your video
------------	------------------------------

SD card slot	Support local SD Card storage (Max.128G)
--------------	--

Reset	Press and hold for 5 seconds to reset the camera (if you have modified settings, they will return to factory defaults)
-------	--

RJ45	Interface for wired network. Support to connect the camera to the network through a network cable, if the camera is installed in a place where wireless network is not available, such as a basement. Make sure that the network cable is directly connected to a router.
------	---

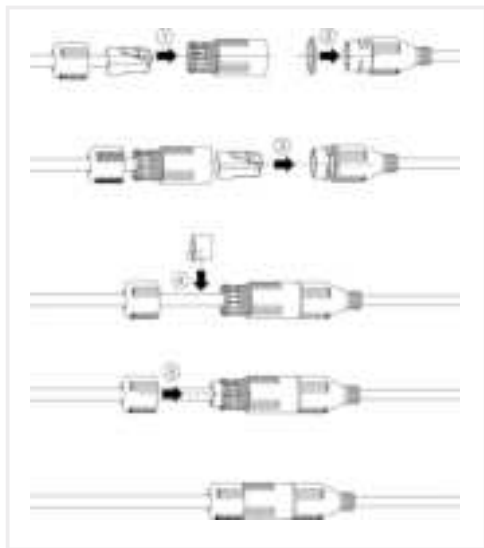

## Bracket Installation

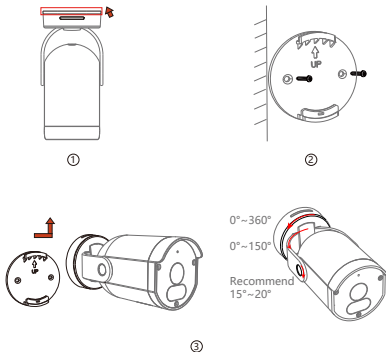

1. Push the bracket in the direction shown to take apart.
2. Install the bracket to the wall with screws. Put the UP logo up.
3. Insert the bracket upward and then push the bracket in the opposite direction of step 1, to lock the bracket with the camera.

(Optional) You can adjust the camera horizontally or vertically by manual. It is recommended to adjust camera horizontally between 0 to 150 degrees, and vertically between 15 to 20 degrees. You can also rotate the bracket from 0 to 360 degrees.

## Download

CloudEdge is available for both iOS and Android OS. Search the name 'CloudEdge' in App Store or Google Play, or scan the QR-Code to download the App.

## Support



## Add device

Log in the CloudEdge, select "Add Device", and add the smart camera to the App according to the screen tips(Make the smart camera close to the router when configuring).



**NOTE:** If you need to re-select the WiFi network, please press and hold the "RESET" button for 5 seconds, the device will restart, and the indicator will be flashing red.

## Set up router

The device only supports 2.4GHz Wi-Fi

Ensure you have the SSID and password



Please keep network available

2.4GHz



5GHz



**Note:** The length of the Wi-Fi SSID and password should not exceed 24 characters

If your device has trouble connecting to the Wi-Fi network, or if you wish to switch networks, press and hold the RESET button for 5 seconds to reset the device

- Step 1 Open the App, click "Sign up now" to register.  
If you already have an account, click "Log in" to log in.



- Step 2 Input a legal Email address and check the privacy agreement.  
Then enter the nickname and password.





# Add Device

## 1 Pair device to the App

### Pairing method 1

- a. Enable Bluetooth on your phone
- b. In the App, tap **Add Device** or **+ > Add Device**. The device will be searched for via Bluetooth and appear on the screen. Follow the on-screen instructions to complete pairing.



**Note:** If the device is not in the red slow flashing after 30 seconds of turning on, press and hold the reset button for 5 seconds to reset, and then restart to pair the camera with the App

- 1) Set up the parameters of router firstly and then record the SSID and password of your Wi-Fi. Make sure the Wi-Fi is stable and fluent.  
2) Connect your smartphone to the Wi-Fi.

**Note:**

- Please consider the installation position of camera before selecting a router which also provides Wi-Fi for your smartphone, because the camera have to be connected to the router by network cable.
- Camera only supports 2.4GHz Wi-Fi network.
- The number of bits in the SSID and passwords of the router should not exceed 24 digits.

- 1) Take out the camera, the adapter and the prepared network cable.  
2) Connect the camera to the router via the network cable.  
3) Power on the camera via adapter.
- Click "Add Device" or "+", and then select "Power Plug Camera" >> "Smart Camera(LAN)" to add device.

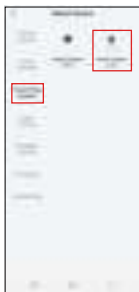

- 4 Power on the device.  
Make sure that connection method is "Wired network".



- 5 Reset the camera until the status indicator is flashing quickly and a prompt tone is heard.  
Click "Next" and the devices on the same network segment will be auto searched.



- 6 In the device adding list, select the device you need and then tap "+".



- 7 When connecting, you should make sure your router, mobile, and camera are on the same network segment. When camera added successfully, click "Next". And you can select family and room, or click "🏠" to DIY the camera's name.



- 8 Click the added device icon, and then you can enter live view interface. In live view interface, click "⚙️", and you can set up the parameters of common functions.

## Video flip

Flip your video stream up or down for maximum flexibility.

## Motion detection

Support smart motion detection. The camera will detect movements, and then send you push notifications and app alerts.

## Record

Support 24H continuous recording with high capacity SD storage or Cloud storage.

## Full color vision

With white light, the captured pictures and videos of motion detection are colorful which can provide you a better vision.

## RJ45

Support power supply and data transmission through the Ethernet, which is much safer for camera using and is more flexible for wires arrangement.

## Day & Night

Never miss a moment, even in complete darkness, with powerful night-vision technology.



Daytime



Night

Q: The device cannot be previewed properly?

A: Check whether the network is normal, you can place the camera close to the router, and if not, it is recommended to reset the device and add it again.

Q: Why is it still in the list of devices after resetting?

A: The reset device only resets the network configuration of the camera, but cannot change the configuration on the App, remove the camera, and must be deleted by the App.

Q: How to cut the camera network to another router?

A: First remove and reset the device on the App and then configure the device again by the App.

Q: Why doesn't the device identify the SD card?

A: It is recommended to plug in SD card after power cut. Confirm whether the SD card is normally available and the format is FAT32. And the TF card can't be identified when the Internet environment is not good.

Q: Why I can't get the notifications with my cell phone App?

A: Please confirm that the App has been running on the phone, and the relevant reminder function has been opened; Message notification and authority confirmation in the mobile phone system have been opened.

## FCC Statement

This equipment has been tested and found to comply with the limits for a Class B digital device, pursuant to part 15 of the FCC Rules. These limits are designed to provide reasonable protection against harmful interference in a residential installation. This equipment generates, uses and can radiate radio frequency energy and, if not installed and used in accordance with the instructions, may cause harmful interference to radio communications. However, there is no guarantee that interference will not occur in a particular installation. If this equipment does cause harmful interference to radio or television reception, which can be determined by turning the equipment off and on, the user is encouraged to try to correct the interference by one or more of the following measures:

- Reorient or relocate the receiving antenna
- Increase the separation between the equipment and receiver
- Connect the equipment into an outlet on a circuit different from that to which the receiver is connected.
- Consult the dealer or an experienced radio/TV technician for help.

## RF EXPOSURE WARNING

FCC Radiation Exposure Statement: This device complies with FCC radiation exposure limits set forth for an uncontrolled environment and it also complies with Part 15 of the FCC RF Rules. This equipment must be installed and operated in accordance with provided instructions and the antenna(s) used for this transmitter must be installed to provide a separation distance of at least 20 cm from all persons and must not be co-located or operating in conjunction with any other antenna or transmitter. End-users and installers must be provided with antenna installation instructions and consider removing the no-collocation statement.

This device complies with Part 15 of the FCC Rules. Operation is subject to the following two conditions: (1) this device may not cause harmful interference, and (2) this device must accept any interference received, including interference that may cause undesired operation

## Caution!

Any changes or modifications not expressly approved by the party responsible for compliance could void the user's authority to operate the equipment.

## Battery Safety

1. Your device contains a rechargeable lithium-ion battery and should be replaced only by a qualified service provider. Do not disassemble, open, crush, bend, deform, puncture, shred or attempt to access the battery in your device
2. Do not modify or remanufacture the battery, attempt to insert foreign objects into the battery, or immerse or expose it to water or other liquids, expose to fire, explosion or other hazard.
3. Do not use a battery if its case appears damaged, swollen, or compromised. Examples include, but are not limited to, leaking, odors, dents, corrosion, rust, cracks, swelling, melting, and scratches.
4. Do not put the battery in trash that is disposed of in landfills. When disposing of the battery, comply with local ordinances or regulations.

© 2024. All rights reserved. All trade names are registered trademarks of respective companies. Apple, the Apple logo, iPhone are trademarks of Apple Inc. registered in the U.S. and other countries. Google, the Google logo, Android are trademarks of Google Inc. App Store is a service mark of Apple Inc. Google Play is a service mark of Google Inc.

### **Power Adapter Safety**

1. The power plug is intended to serve as a disconnect device. Do not drop or cause an impact to the power adapter.
2. If the power cable is damaged (for example, the cord is exposed or broken), or the plug loosens, stop using it at once. Continued use may lead to electric shock or fire.
3. Do not touch the device or the power adapter with wet hands. Doing so may lead to short circuits, malfunctions, or electric shocks.

### **Child's Safety**

1. Comply with all precautions with regard to child's safety. Letting children play with the device or its accessories may be dangerous.
2. The device and its accessories are not intended for use by children. Children should only use the device with adult supervision.

### **Operation Requirements**

1. Use the device under allowed humidity and temperature conditions.
2. Do not aim the device at strong light sources (such as lamp light, and sunlight) when focusing it, to avoid reducing the lifespan of the CMOS sensor, and causing overbrightness and flickering.
3. Observe local laws and regulations, and respect the privacy and legal rights of others.

### **Industry Canada (ISED) Compliance Statement**

This device complies with Industry Canada's licence-exempt RSS(s). Operation is subject to the following two conditions:

- (1) This device may not cause interference; and
- (2) This device must accept any interference, including interference that may cause undesired operation of the device.

Le présent appareil est conforme aux CNR d'Industrie Canada applicables aux appareils radio exempts de licence. L'exploitation est autorisée aux deux conditions suivantes :

- (1) l'appareil ne doit pas produire de brouillage;
- (2) l'utilisateur de l'appareil doit accepter tout brouillage radioélectrique subi, même si le brouillage est susceptible d'en compromettre le fonctionnement.

The device meets the exemption from the routine evaluation limits in section 2.5 of RSS 102 and compliance with RSS-102 RF exposure, users can obtain Canadian information on RF exposure and compliance.

Le dispositif rencontre l'exemption des limites courantes d'évaluation dans la section 2.5 de RSS 102 et la conformité à l'exposition de RSS-102 rf, utilisateurs peuvent obtenir l'information canadienne sur l'exposition et la conformité de rf.

This transmitter must not be co-located or operating in conjunction with any other antenna or transmitter. This equipment should be installed and operated with a minimum distance of 20 centimeters between the radiator and your body.

Cet émetteur ne doit pas être Co-placé ou ne fonctionnant en même temps qu'aucune autre antenne ou émetteur. Cet équipement devrait être installé et actionné avec une distance minimum de 20 centimètres entre le radiateur et votre corps.