

List of products

Connection interface	USB Cable, U-disk, WIFI, WLAN port
Control panel	LCD Screen
Size of panel	4.0 Inches
Motor	Servo motor
CCD-Camera	Real Camera for contour cutting
Registration mark type	Circle mark, L corner mark
QR code reading	Yes, auto find cutting file from U-disk
Save favorite cutting file function	yes
Number of cutting head	1
Cutting accuracy	0.1mm
Repeat accuracy	0.1mm
Capacity of cutting	Support cutting 100gsm to 300 gsm paper
Material width	350mm
Max cutting width	350mm
Max running speed	1600mm/s
Max cutting speed	1600mm/s
Max cutting force	2000g
Cutting head type	Voice coil
Drawing pen	1pcs
Memory	16M
Suitable cutting material	Adhesive, cardboard, coated paper
Maximum machine power	110V-230V
Max watt	<150W
Machine size	71*52*38.5cm
Package size	80*58*50cm
Net/Gross weight	50kg/61kg

FCC Warning Statement

Changes or modifications not expressly approved by the party responsible for compliance could void the user’s authority to operate the equipment. This equipment has been tested and found to comply with the limits for a Class B digital device, pursuant to Part 15 of the FCC Rules. These limits are designed to provide reasonable protection against harmful interference in a residential installation. This equipment generates uses and can radiate radio frequency energy and, if not installed and used in accordance with the instructions, may cause harmful interference to radio communications. However, there is no guarantee that interference will not occur in a particular installation. If this equipment does cause harmful interference to radio or television reception, which can be determined by turning the equipment off and on, the user is encouraged to try to correct the interference by one or more of the following measures:

- Reorient or relocate the receiving antenna.
- Increase the separation between the equipment and receiver.
- Connect the equipment into an outlet on a circuit different from that to which the receiver is connected.
- Consult the dealer or an experienced radio/TV technician for help.

This device complies with part 15 of the FCC Rules. Operation is subject to the following two conditions: (1) This device may not cause harmful interference, and (2) this device must accept any interference received, including interference that may cause undesired operation.

RF Exposure Statement

To maintain compliance with FCC’s RF Exposure guidelines, This equipment should be installed and operated with minimum distance of 20cm the radiator your body. This device and its antenna(s) must not be co-located or operation in conjunction with any other antenna or transmitter.



A3MAX4-WD

HIGH-SPEED DIE CUTTING

MACHINE

Usage Guidelines



Product standard spare part list

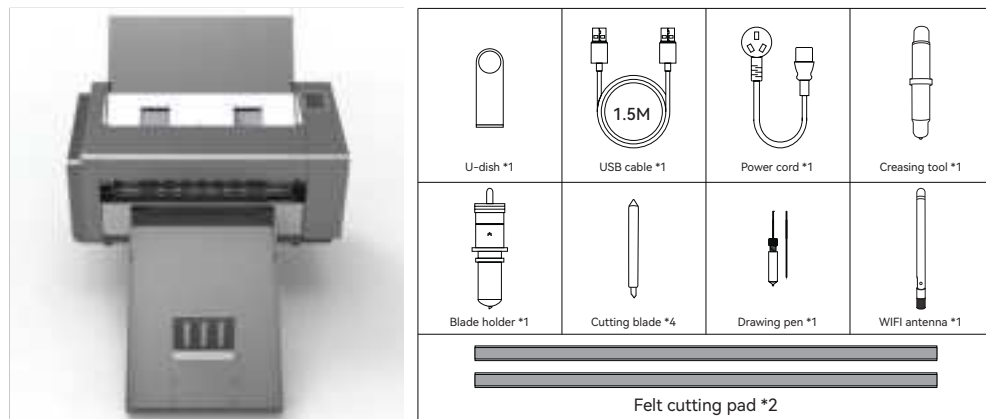

Appearance and function

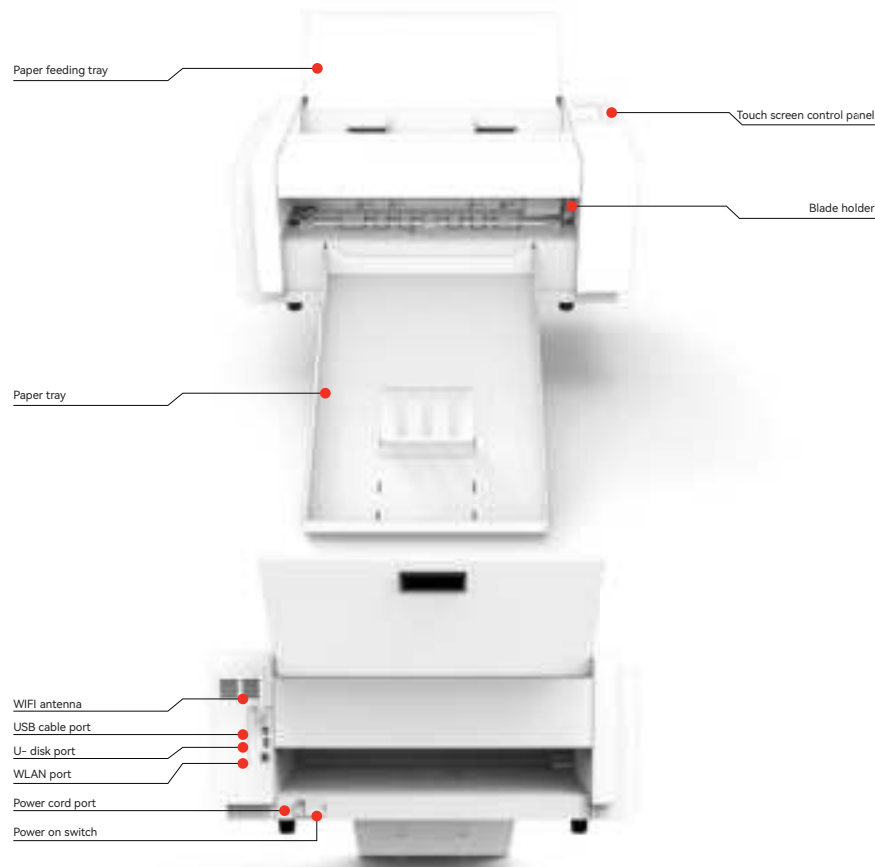

Usage Guidelines

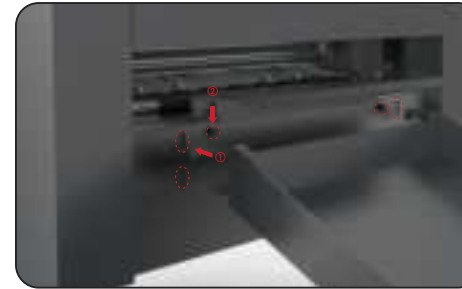

1、Install the paper tray

- ①Insert the tray into the machine according to the hole;
- ②Insert the paper tray foot into the hole and fix it.

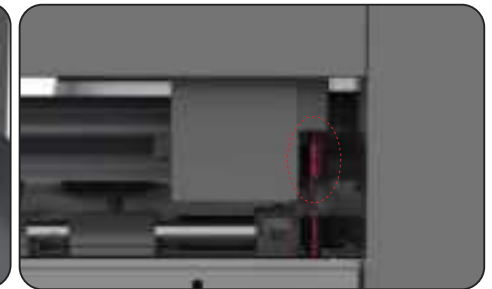

2、Install the cutter head

- ①Turn the plum blossom button as shown in the figure counterclockwise to loosen the cutter holder and insert the cutter head vertically;
- ②Tighten the plum blossom button clockwise to fix the cutter holder.



3、Install the WIFI antenna

- ①Align the WIFI antenna with the antenna interface and tighten it clockwise

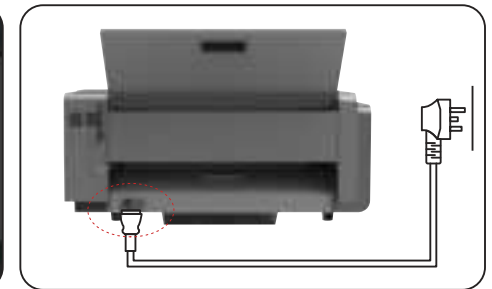

4、Connect the power cord and turn on the power

- Connect the power cord to the power cord interface and press the switch button to turn on the power

Recommended settings for blade tip exploding and blade force / cutting speed

The exploding tip of the cutting blade is recommended to have a length of about 0.2mm, but new users tend to use a longer tip. Cut only the surface layer of the self-adhesive, leaving only the smallest scratch on the bottom layer. This way, you can easily tear off the self-adhesive. If you can't cut through small corners or some small details, you can increase the tip length appropriately.

The recommended speed setting is 11 level. Set 25-30 blade force for cutting self-adhesive materials.

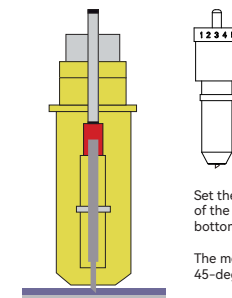

Set the tip of the blade to cut only the surface of the material without cutting through the bottom layer.

The most commonly used knife is the 45-degree knife (black cap).

For thicker materials, use the 60-degree knife (blue cap).

Loop settings



1.Click counting for loop setting



2.Set copy as loop

WIFI Settings



1. Scan WIFI network
2. Enter WIFI password
3. Set IP address
4. Click Connect

*The IP address of the cutting machine must be consistent with the IP address of the software
 *Due to WIFI module adaptation issues, the current WIFI wireless connection method may not support the following situations. If the following situations occur, please use WLAN network cable connection method or data cable connection method.

1. Router bridging
2. 5G network environment
3. Some models of routers

Camera calibration

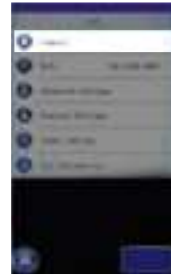

- 1.Load paper for calibration and install drawing pen with blade force 50, cutting speed 10 level, drawing pen tip is away from paper 2mm.
- 2.Click Set - Camera - Click Calibrate, hold on OK until arrow turning into red, and then click start.

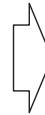

- 3.Cutter will draw square with crossing. Click red crossing at middle of black crossing, and then click ok. Cutter will automatically fix the calibration.
- 4.Click home to save the parameter.



A3MAX4-WD Overspeed die cutter support Camera Cut \ CorelDRAW

*Software download:

To download the Camera Cut software, please consult the Shanghai Xiangbao manufacturer or check the USB flash drive included with the machine.

*Activation:

Enter the "Serial Number" and "Email Address" and click the "Next" button to complete the software activation.

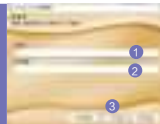

Instructions for using CorelDRAW plug-in

1. Select the corresponding CDR version to install the plug-in
2. After opening the CDR software, right-click on the toolbar and check CameraCut Call the plug-in.

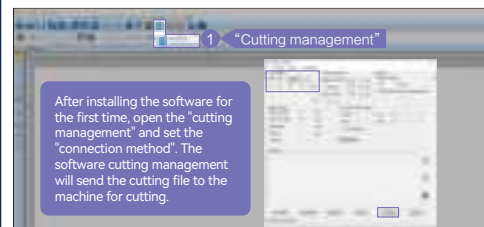
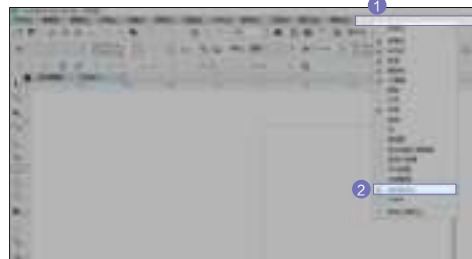

After installing the software for the first time, open the "cutting management" and set the "connection method". The software cutting management will send the cutting file to the machine for cutting.

Contour cutting

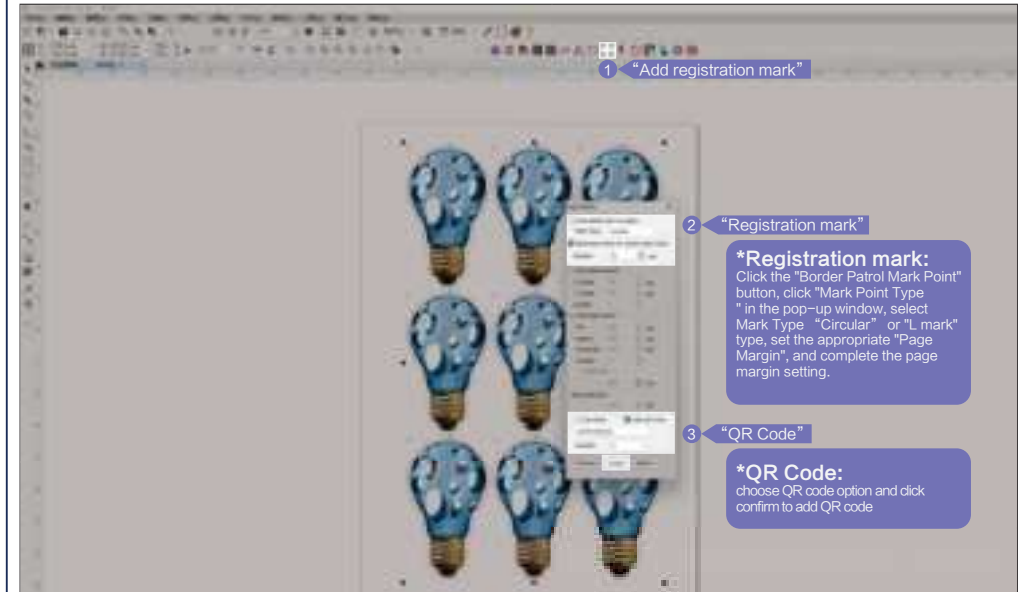

1 "Add registration mark"

2 "Registration mark"

***Registration mark:**
 Click the "Border Patrol Mark Point" button, click "Mark Point Type" in the pop-up window, select Mark Type "Circular" or "L mark" type, set the appropriate "Page Margin", and complete the page margin setting.

3 "QR Code"

***QR Code:**
 choose QR code option and click confirm to add QR code

WIFI Connection

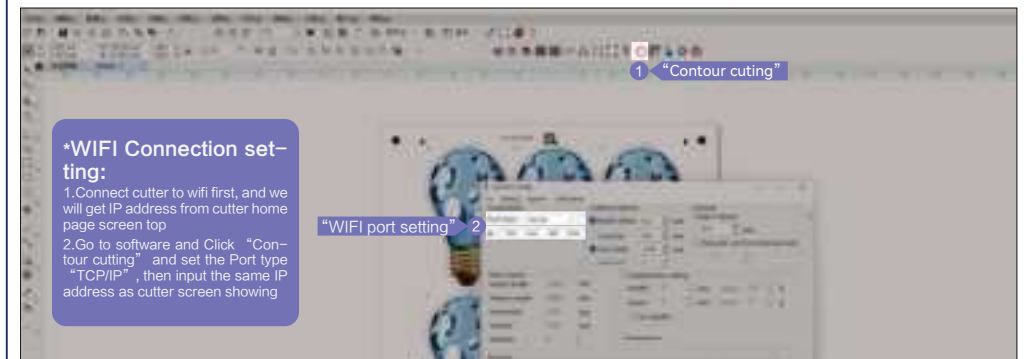

1 "Contour cutting"

*WIFI Connection setting:

- 1.Connect cutter to wifi first, and we will get IP address from cutter home page screen top
- 2.Go to software and Click "Contour cutting" and set the Port type "TCP/IP", then input the same IP address as cutter screen showing

"WIFI port setting" 2

USB Cable Connection setting

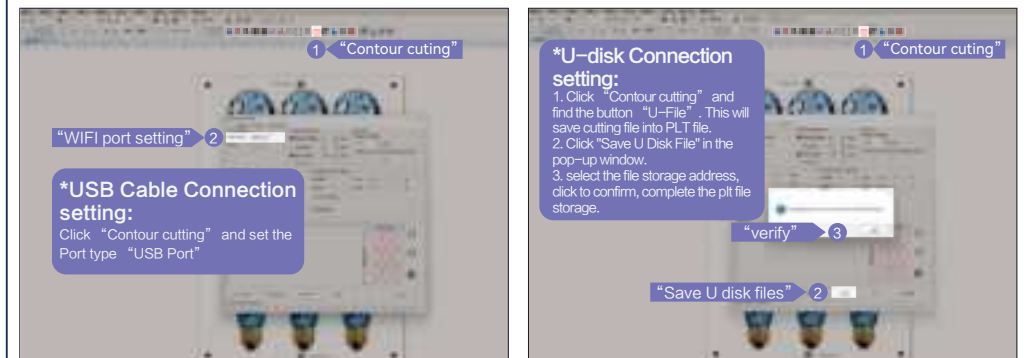

1 "Contour cutting"

"WIFI port setting" 2

*USB Cable Connection setting:

Click "Contour cutting" and set the Port type "USB Port"

*U-disk Connection setting:

1. Click "Contour cutting" and find the button "U-File". This will save cutting file into PLT file.
2. Click "Save U Disk File" in the pop-up window.
3. select the file storage address, click to confirm, complete the plt file storage.

"verify" 3

"Save U disk files" 2