

# IQ MOTION QUICK INSTALL GUIDE

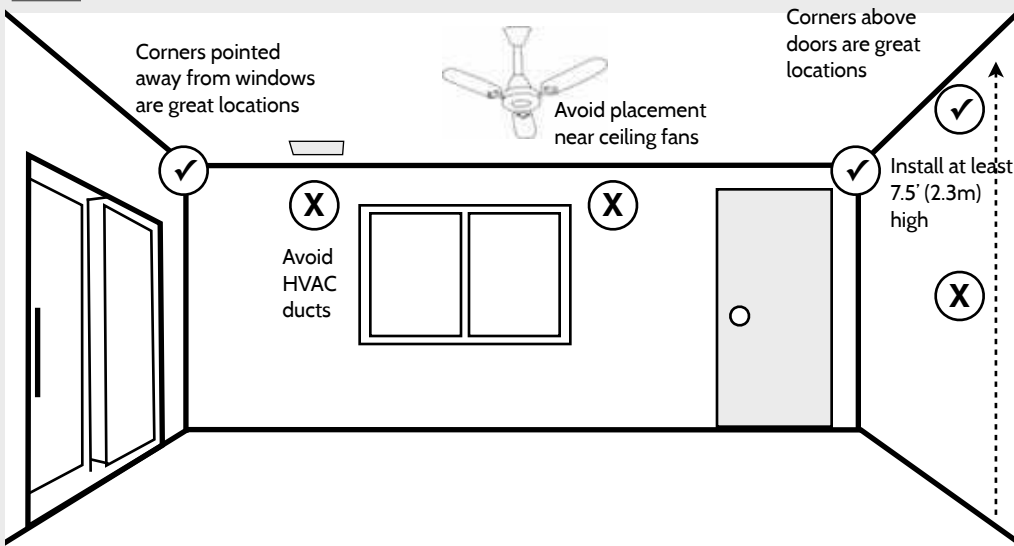

## STEP 1 CHOOSE INSTALLATION LOCATION



## STEP 2 OPEN DEVICE CASING

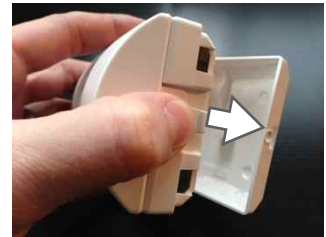
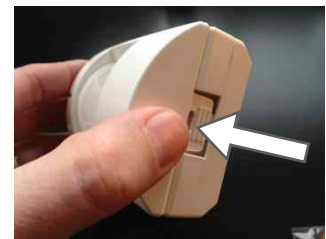

## STEP 3 REMOVE BATTERY TAB



## STEP 4 CHOOSE MOUNTING TYPE

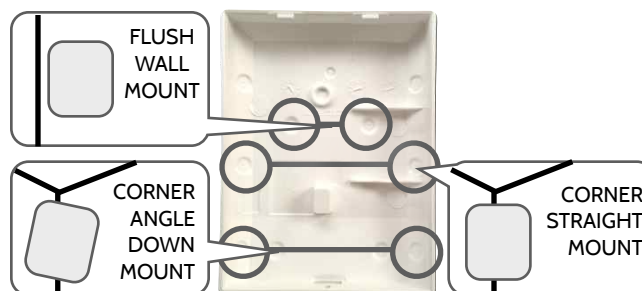

## STEP 5 SECURE ALL HARDWARE



## STEP 4 LEARN INTO PANEL



a. Touch "Settings"



b. Touch "Installation"



c. Touch "Security Sensors"



d. Touch "Quick Install"



e. Trip sensor by opening casing until you hear the panel chime



f. Check information on panel, make any changes and click "Save"



g. Test sensor to ensure proper function

## SPECIFICATION CHARTS

DETECTING AREA (Unit = meter) 40lbs at 35'

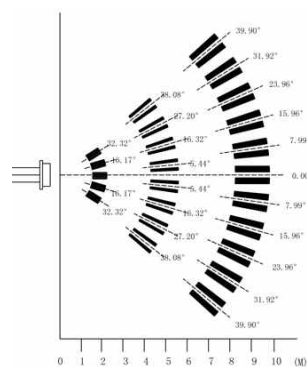

DIMENSION (Unit = m/m)

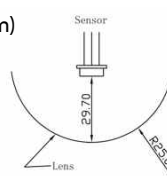
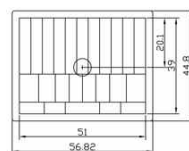

## DOCUMENTATION INFORMATION

Document#: IQDW-QG-07-13

Revision#: 20121130

Issue Date: 11-30-2012

Qolsys Part #: QS-1200-p01

Firmware : 20130401

Qolsys Inc. proprietary. Reproduction without permission is not permitted.

## SUPPORT

**GOT QUESTIONS?**  
CONTACT TECH SUPPORT

[TechSupport@Qolsys.com](mailto:TechSupport@Qolsys.com)