

SONOFF

TX EU-RF

User manual V1.0

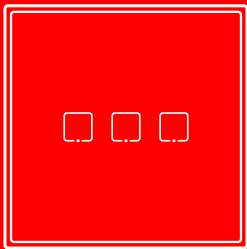

433MHz Wireless Stick-on Smart Wall Switch

· 中文-----1-2

· Español-----7-8

· Русский язык---13-14

· English-----3-4

· Français-----9-10

· Português-----15-16

· Deutsch-----5-6

· Italiano-----11-12

· FCC Warning----- 17



取出电池绝缘片

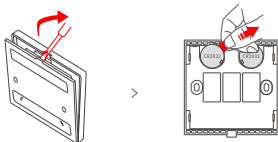

① 设备分带电池和不带电池版本。

产品介绍

本设备与SONOFF TX 墙壁开关(带433MHz)系列配套使用,同时支持433MHz通讯协议的其它开关设备。

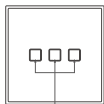

手动触摸开关/RF配对按键

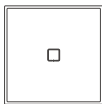

1C

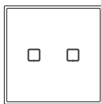

2C

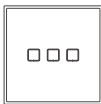

3C

① 设备支持单键值学习, RF的学习与清除方法请参考您购买的开关设备说明书指示操作。

产品参数

产品型号	T2EU1C-RF/T2EU2C-RF/T2EU3C-RF/T3EU1C-RF/T3EU2C-RF/T3EU3C-RF		
供电	6V(3V纽扣电池 × 2)		
电池型号	CR2032	RF	433.92MHz
材料	PC+钢化玻璃	产品尺寸	86x86x9mm

① T3EU1C-RF/T3EU2C-RF/T3EU3C-RF 黑色版本暂未上线。

支持适配的 SONOFF 开关设备

●RFR2 ●BASICRFR3 ●SlampherR2 ●4CHPROR3 ●TX EU/UK/US 墙壁开关 (带433MHz) 系列

控制方式

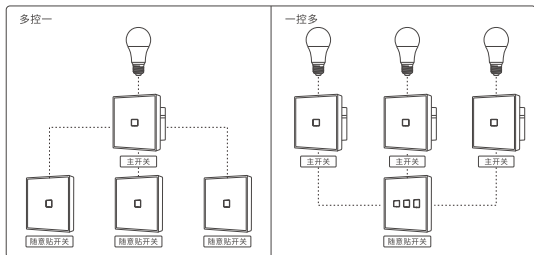

安装方法

方法1:

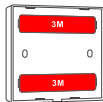

方法2:

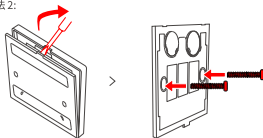

① 设备重量<1Kg, 建议安装高度<2米。

Pull out the battery insulation sheet

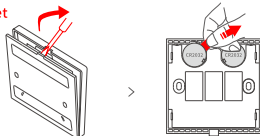

- ① The device has the version with battery and without battery.

Product Introduction

This device is used with SONOFF TX Wi-Fi smart wall switches (with 433MHz) together, and also works with other 433MHz smart devices.

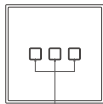

Touch switch/RF pairing button



1C

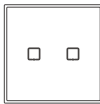

2C

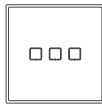

3C

- ① The device only supports pairing one button at a time. Please refer to the switch user manual for RF pairing and clearing method.

Product Specification

Model	T2EU1C-RF/T2EU2C-RF/T2EU3C-RF/T3EU1C-RF/T3EU2C-RF/T3EU3C-RF		
Power supply	6V (3V button cell x 2)		
Battery model	CR2032	RF	433.92MHz
Materials	PC+tempered glass panel	Dimension	86x86x9mm

- ① T3EU1C-RF/T3EU2C-RF/T3EU3C-RF with black color are not released yet.

Supported SONOFF devices

- RFR2
- BASICRFR3
- SlampherR2
- 4CHPROR3
- TX EU/UK/US Wi-Fi smart wall switches (with 433MHz) series

Control Ways

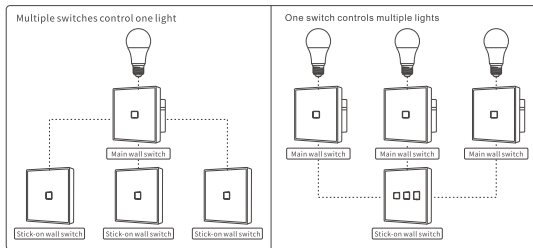

Installation Methods

Method 1:

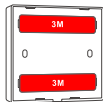

Method 2:

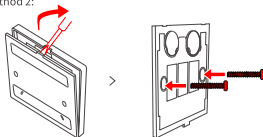

ⓘ The device weight is less than 1kg. The installation height of less than 2m is recommended.

Ziehen Sie die Batterieisolierungsfolie heraus

- ① Das Gerät ist in der Version mit Batterie und ohne Batterie verfügbar.

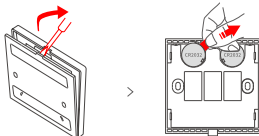

Produkt-Einführung

Dieses Gerät wird zusammen mit den intelligenten Wi-Fi-Wandschaltern SONOFF TX (mit 433MHz) verwendet und funktioniert auch mit anderen intelligenten 433MHz-Geräten.

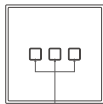

Manueller Berührungsschalter
RF-Paarungstaste

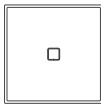

1C

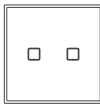

2C

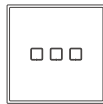

3C

- ① Das Gerät unterstützt die Paarung jeweils einer Taste. Informationen zur RF-Paarung und der Clearing-Methode entnehmen Sie bitte dem Benutzerhandbuch des Schalters.

Produkt-Spezifikation

Modell	T2EU1C-RF/T2EU2C-RF/T2EU3C-RF/T3EU1C-RF/T3EU2C-RF/T3EU3C-RF		
Stromversorgung	6V (3V-Tastenzelle x 2)		
Batterie-Modell	CR2032	HF	433,92MHz
Materialiens	PC+gehärtete Glasscheibe	Abmessungen	86x86x9mm

- ① T3EU1C-RF/T3EU2C-RF/T3EU3C-RF mit schwarzer Farbe sind noch nicht freigegeben.

Unterstützte SONOFF-Geräte

- RFR2
- BASICRFR3
- SlampherR2
- 4CHPROR3
- TX EU/UK/US Intelligente Wi-Fi-Wandschalter Serien (mit 433MHz)

Steuerungsmöglichkeiten

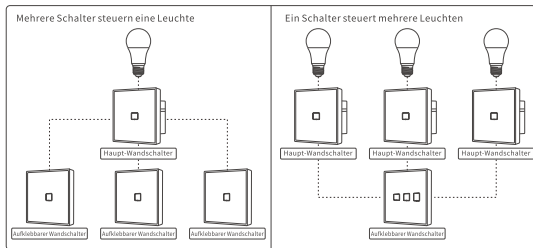

Installationsmethoden

Methode 1:

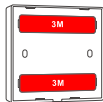

Methode 2:

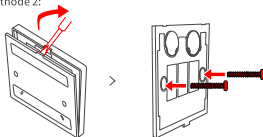

① Das Gerätewicht beträgt weniger als 1kg. Es wird eine Installationshöhe von weniger als 2m empfohlen.

Retire la lámina de aislamiento de la batería.

- ① El dispositivo viene en el diseño con batería y sin batería.

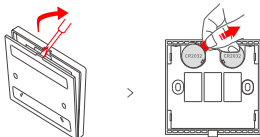

Introducción del producto

Este dispositivo se utiliza con interruptores de pared inteligentes SONOFF TX Wi-Fi (con 433MHz) juntos, y también funciona con otros dispositivos inteligentes de 433 MHz.

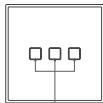

Interruptor táctil manual
botón de emparejamiento por radiofrecuencia

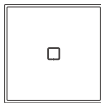

1C

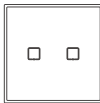

2C

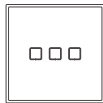

3C

- ① El dispositivo solo admite el emparejamiento de un botón cada vez. Consulte el manual de usuario del interruptor para conocer el método de emparejamiento por radiofrecuencia y autorización.

Especificaciones del producto

Modelo	T2EU1C-RF/T2EU2C-RF/T2EU3C-RF/T3EU1C-RF/T3EU2C-RF/T3EU3C-RF		
Fuente de alimentación	6 V (2 baterías de botón de 3 V)		
Modelo de la batería	CR2032	RF	433,92MHz
Materiales	PC+panel de vidrio templado	Dimensiones	86x86x9mm

- ① T3EU1C-RF/T3EU2C-RF/T3EU3C-RF mit schwarzer Farbe sind noch nicht freigegeben.

Dispositivos SONOFF compatibles

- RFR2
- BASICRFR3
- SlampherR2
- Serie de interruptores de pared inteligentes TX EU/UK/US Wi-Fi (con 433 MHz)

●4CHPROR3

Formas de control

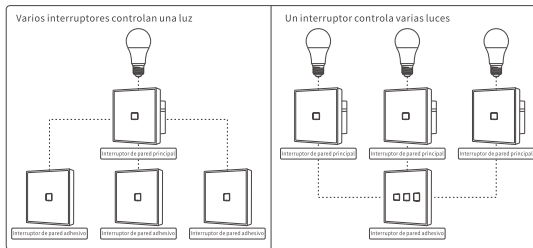

Métodos de instalación

Método 1:

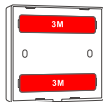

Método 2:

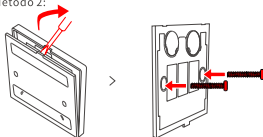

① El peso del dispositivo es inferior a 1kg. Se recomienda una altura de instalación inferior a 2m.

Retirez la feuille d'isolation de la batterie.

- ① Cet appareil existe en deux versions, à savoir avec batterie et sans batterie.

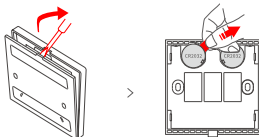

Présentation du produit

Cet appareil a été conçu pour être utilisé conjointement avec les commutateurs muraux intelligents Wi-Fi SONOFF TX (avec 433 MHz), et fonctionne également avec d'autres appareils intelligents à 433 MHz.

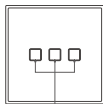

Interrupteur tactile manuel
bouton d'appairage RF

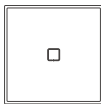

1C

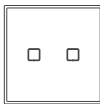

2C

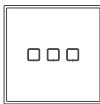

3C

- ① L'appareil ne permet d'appairer qu'un seul bouton à la fois. Veuillez vous référer au manuel d'utilisation du commutateur pour l'appariement RF et la méthode de nettoyage.

Caractéristiques techniques

Modèle	T2EU1C-RF/T2EU2C-RF/T2EU3C-RF/T3EU1C-RF/T3EU2C-RF/T3EU3C-RF		
Alimentation électrique	6 V (2 piles bouton de 3 V)		
Modèle de batterie	CR2032	FR	433,92MHz
Matériaux	PC+panneau de verre trempé	Dimensions	86x86x9mm

- ① T3EU1C-RF/T3EU2C-RF/T3EU3C-RF avec la couleur noire ne sont pas encore disponibles.

Appareils SONOFF pris en charge

- RFR2
- BASICRFR3
- SlampherR2
- 4CHPROR3
- TX EU/UK/US Wi-Fi smart wall switches (with 433MHz) series

Moyens de contrôle

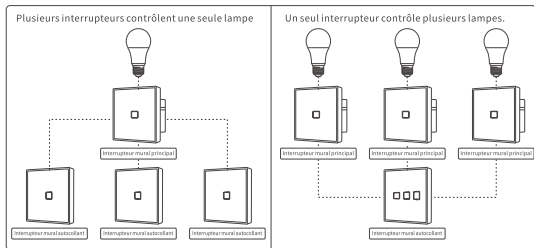

Méthodes d'installation

Méthode 1:

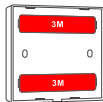

Méthode 2:

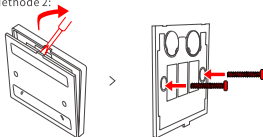

① Le poids du dispositif est inférieur à 1kg. Il est recommandé d'installer le dispositif à une hauteur inférieure à 2m.

Rimuovere il foglio di isolamento della batteria

- ① Il dispositivo possiede la versione con batteria e senza batteria.

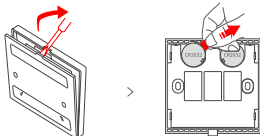

Descrizione del prodotto

Questo dispositivo viene utilizzato insieme agli interruttori a parete intelligenti SONOFF TX Wi-Fi (con 433MHz) oltre che con altri dispositivi intelligenti a 433MHz.

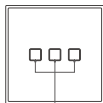

Interruttore manuale a sfioramento
Pulsante di associazione RF

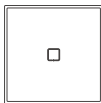

1C

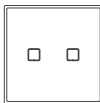

2C

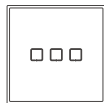

3C

- ① Il dispositivo supporta l'associazione di un solo pulsante alla volta. Fare riferimento al manuale d'uso del pulsante per la procedura di associazione e di cancellazione RF.

Specifiche del prodotto

Modello	T2EU1C-RF/T2EU2C-RF/T2EU3C-RF/T3EU1C-RF/T3EU2C-RF/T3EU3C-RF		
Alimentazione elettrica	6V (2 batterie a bottone da 3V)		
Codice batteria	CR2032	RF	433,92MHz
Materiali	PC+pannello in vetro temperato	Dimensioni	86x86x9mm

- ① I modelli T3EU1C-RF/T3EU2C-RF/T3EU3C-RF di colore nero non sono ancora disponibili sul mercato.

Dispositivi SONOFF supportati

- RFR2
- BASICRFR3
- SlampherR2
- Interruttori a parete intelligenti Wi-Fi (a 433MHz) serie TX EU/UK/US

●4CHPROR3

Metodi di controllo

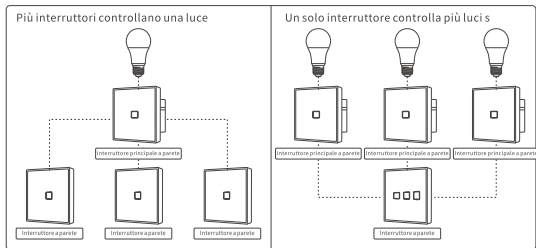

Metodi di installazione

Metodi 1:

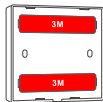

Metodi 2:

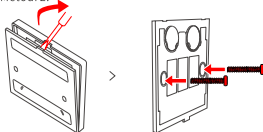

① Il peso del dispositivo è inferiore a 1kg. Si raccomanda un'altezza di installazione inferiore a 2m.

Снимите изоляционный лист батареи.

- ① Устройство имеет версию с батареей и без батареи.

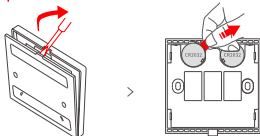

Знакомство с изделием

Данное устройство используется вместе с настенными смарт-переключателями SONOFF TX Wi-Fi (с частотой 433 Мгц), а также работает с другими смарт-устройствами с частотой 433 Мгц.

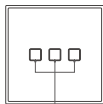

Ручной сенсорный переключатель
кнопка сопряжения RF

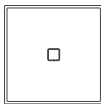

1C

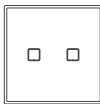

2C

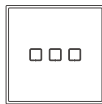

3C

- ① Устройство поддерживает сопряжение только одной кнопки за раз. Обратитесь к руководству пользователя переключателя для информации о сопряжении RF и способе очистки.

Спецификация продукта

Модель	T2EU1C-RF/T2EU2C-RF/T2EU3C-RF/T3EU1C-RF/T3EU2C-RF/T3EU3C-RF		
Источник питания	6 В (кнопочный элемент 3 В x 2)		
Модель батареи	CR2032	РЧ	433,92 Мгц
Материал	PC+панель из закаленного стекла	Размеры	86x86x9 мм

- ① T3EU1C-RF/T3EU2C-RF/T3EU3C-RF в черном цвете еще не выпущены.

Поддерживаемые устройства SONOFF

- RFR2
- BASICRFR3
- SlampherR2
- 4CHPROR3
- Серия настенных смарт-переключателей Wi-Fi TX EU / UK / US (с частотой 433 МГц)

Способы управления

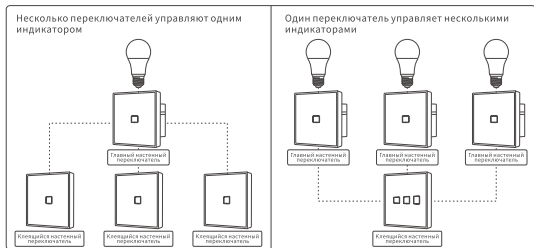

Способы установки

Способ 1:

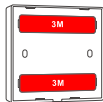

Способ 2:

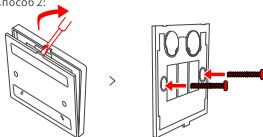

① Вес устройства составляет менее 1kg. Рекомендуется устанавливать устройство на высоте менее 2м.

Retire a plástico de isolamento da bateria

- ① O aparelho possui a versão com bateria e sem bateria.

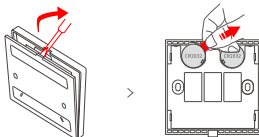

Introdução ao produto

Este dispositivo é usado com interruptores de parede inteligente SONOFF TX Wi-Fi (com 433 MHz) juntos e também funcionam com outros dispositivos inteligentes de 433 MHz.

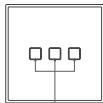

Interruptor de toque manual
botão de emparelhamento RF

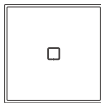

1C

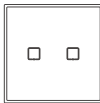

2C

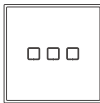

3C

- ① O dispositivo só oferece suporte ao emparelhamento de um botão de cada vez. Consulte o manual do usuário do interruptor para obter o método de emparelhamento e compensação de RF.

Parâmetros do produto

Modelo	T2EU1C-RF/T2EU2C-RF/T2EU3C-RF/T3EU1C-RF/T3EU2C-RF/T3EU3C-RF		
Fonte de alimentação	6V (célula-botão de 3V x 2)		
Modelo da bateria	CR2032	RF	433,92MHz
Material	PC + painel de vidro temperado	Dimensão	86x86x9mm

- ① T3EU1C-RF / T3EU2C-RF / T3EU3C-RF com cor preta ainda não foram lançados.

Dispositivos SONOFF suportados

- RFR2
- BASICRFR3
- SlampherR2
- TX EU/UK/US Interruptores de parede inteligente Wi-Fi (com 433 MHz) série

- 4CHPROR3

Formas de controlar

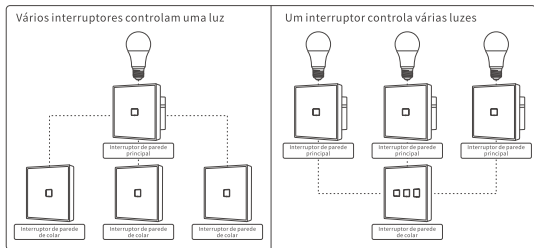

Métodos de instalação

Método 1:

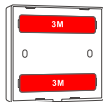

Método 2:

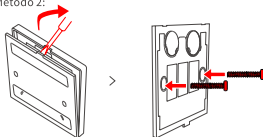

① O peso do dispositivo é inferior a 1kg. Recomenda-se uma altura de instalação inferior a 2m.

FCC Warning

Changes or modifications not expressly approved by the party responsible for compliance could void the user's authority to operate the equipment.

This device complies with part 15 of the FCC Rules. Operation is subject to the following two conditions: (1) This device may not cause harmful interference, and (2) this device must accept any interference received, including interference that may cause undesired operation.

FCC Radiation Exposure Statement:

This equipment complies with FCC radiation exposure limits set forth for an uncontrolled environment.

This transmitter must not be co-located or operating in conjunction with any other antenna or transmitter.

Note:

This equipment has been tested and found to comply with the limits for a Class B digital device, pursuant to part 15 of the FCC Rules. These limits are designed to provide reasonable protection against harmful interference in a residential installation. This equipment generates, uses and can radiate radio frequency energy and, if not installed and used in accordance with the instructions, may cause harmful interference to radio communications. However, there is no guarantee that interference will not occur in a particular installation. If this equipment does cause harmful interference to radio or television reception, which can be determined by turning the equipment off and on, the user is encouraged to try to correct the interference by one or more of the following measures:

- Reorient or relocate the receiving antenna.
- Increase the separation between the equipment and receiver.
- Connect the equipment into an outlet on a circuit different from that to which the receiver is connected.
- Consult the dealer or an experienced radio/TV technician for help.

Hereby, Shenzhen Sonoff Technologies Co., Ltd. declares that the radio equipment type T2EU1C-RF/T2EU2C-RF/T2EU3C-RF/T3EU1C-RF/T3EU2C-RF/T3EU3C-RF is in compliance with Directive 2014/53/EU. The full text of the EU declaration of conformity is available at the following internet address:

<https://www.sonoff.tech/usermanuals>



Shenzhen Sonoff Technologies Co., Ltd.

1001, BLDG8, Lianhua Industrial Park, shenzhen, GD, China

ZIP code: 518000

Website: sonoff.tech

MADE IN CHINA

