

**FCC Statement**  
Warning: Changes or modifications to this unit not expressly approved by the party responsible for compliance could void the user's authority to operate the equipment.

NOTE: This equipment has been tested and found to comply with the limits for a Class B digital device, pursuant to Part 15 of the FCC Rules. These limits are designed to provide reasonable protection against harmful interference in a residential installation. This equipment generates, uses and can radiate radio frequency energy and, if not installed and used in accordance with the instructions, may cause harmful interference to radio communications.

However, there is no guarantee that interference will not occur in a particular installation. If this equipment does cause harmful interference to radio or television reception, which can be determined by turning the equipment off and on, the user is encouraged to try to correct the interference by one or more of the following measures:

- Reorient or relocate the receiving antenna.
- Increase the separation between the equipment and receiver.
- Connect the equipment into an outlet on a circuit different from that to which the receiver is connected.
- Consult the dealer or an experienced radio/TV technician for help.

This device complies with Part 15 of the FCC Rules. Operation is subject to the following two conditions:  
(1) This device may not cause harmful interference.  
(2) This device must accept any interference received, including interference that may cause undesired operation.

**ISED Regulatory Compliance**  
This device contains licence-exempt transmitter(s)/receiver(s) that comply with Innovation, Science and Economic Development Canada's licence-exempt RSS(s). Operation is subject to the following two conditions:  
1. This device may not cause interference.  
2. This device must accept any interference, including interference that may cause undesired operation of the device.  
*L'émetteur/récepteur exempt de licence contenu dans le présent appareil est conforme aux CNR d'Innovation, Sciences et Développement économique Canada applicables aux appareils radio exempts de licence. L'exploitation est autorisée aux deux conditions suivantes :*  
1. L'appareil ne doit pas produire de brouillage;  
2. L'appareil doit accepter tout brouillage radioélectrique subi, même si le brouillage est susceptible d'en compromettre le fonctionnement.

**RF Exposure Compliance**  
This equipment complies with FCC/IC radiation exposure limits set forth for an uncontrolled environment. This equipment should be installed and operated with minimum distance 20cm between the radiator and your body.  
*Cet équipement est conforme aux limites d'exposition aux radiations FCC/IC établies pour un environnement non contrôlé. Cet équipement doit être installé et utilisé avec une distance minimale de 20 cm entre le radiateur et votre corps.*

**Toucan**  
**VuPoint Solutions, Inc. (USA):**  
710 Nogales Street, City of Industry, CA 91748  
**VuPoint (Europe) Company Limited:**  
Innovation Center, Longbridge Technology Park,  
Longbridge, Birmingham B31 2T5  
For additional info, visit our website at [www.toucansolution.com](http://www.toucansolution.com)

©2022 VUPOINT SOLUTIONS, INC. All Rights Reserved.  
The Toucan logo and Toucan are trademarks or registered trademarks of VuPoint Solutions Inc. in the United States and other countries. The Bluetooth® word mark and logos are registered trademarks owned by Bluetooth SIG, Inc. Product names, logos, brands and other trademarks referred to herein are the property of their respective trademark holders. All trademarks remain the property of their respective holders, and are used only to describe the products or services being provided. These trademark holders are not affiliated with VuPoint Solutions, Inc. They do not sponsor or endorse VuPoint Solutions, Inc.'s products or services.

# Thank You for Purchasing CONFERENCE SPEAKER S100

## What's in the Box

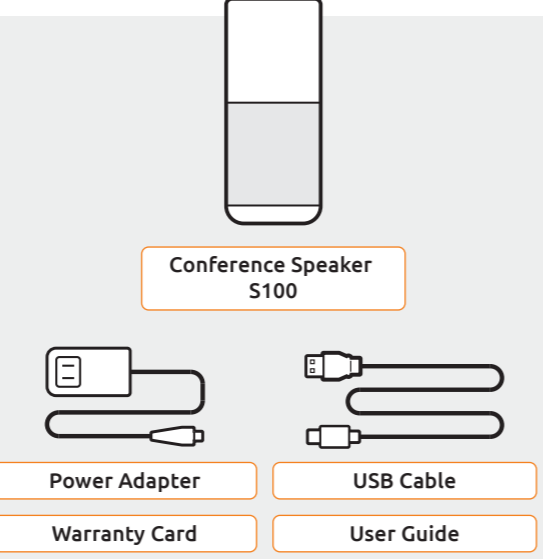

## Getting to know your Conference Speaker S100

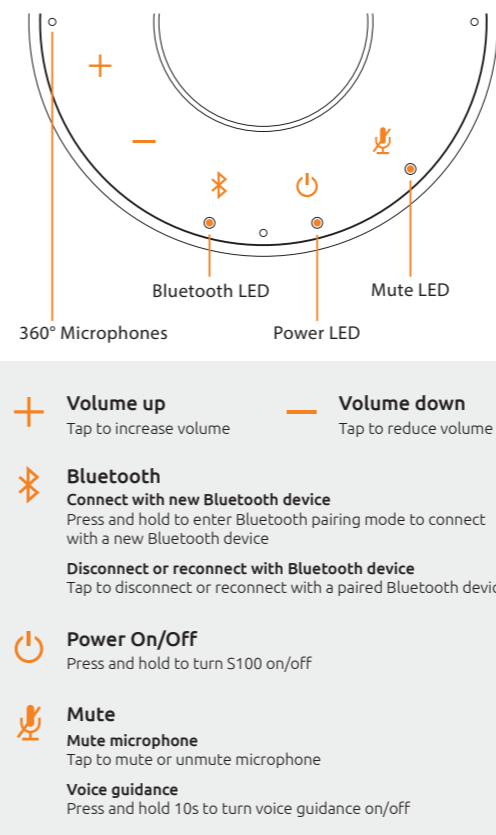

## Getting Started

- 1 Turn on S100**
- Plug the included power adapter into a power outlet and connect the other end to S100.
  - Press and hold for 1 second to turn S100 on and 2 seconds to turn it off.

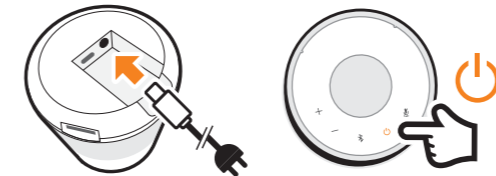

## 2 Connect S100 to your computer

- Plug the included USB cable into your computer and connect the end with the type-C connector to S100.
- Select S100 as the default microphone and speaker source.

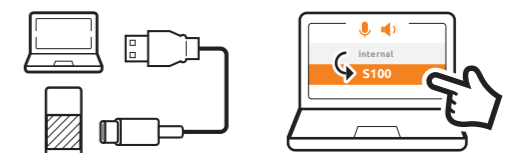

## 3 Connect S100 with a Bluetooth Device

- Press and hold for 2 seconds until the Bluetooth LED on S100 begins flashing. You will hear connection guidance voice prompts.
- Enable Bluetooth on your Bluetooth device.
- Select S100 from the list of available Bluetooth devices to connect.
- You will hear a successful connection message from S100.
- Tap to disconnect with connecting Bluetooth device.



## 4 Mute/Unmute

- Tap while calling to mute or unmute the microphone.



For detailed product information, set up procedures and FAQ's please visit our website: [www.toucansolution.com](http://www.toucansolution.com) or scan the QR code.

**FCC Statement**  
Warning: Changes or modifications to this unit not expressly approved by the party responsible for compliance could void the user's authority to operate the equipment.

NOTE: This equipment has been tested and found to comply with the limits for a Class B digital device, pursuant to Part 15 of the FCC Rules. These limits are designed to provide reasonable protection against harmful interference in a residential installation. This equipment generates, uses and can radiate radio frequency energy and, if not installed and used in accordance with the instructions, may cause harmful interference to radio communications.

However, there is no guarantee that interference will not occur in a particular installation. If this equipment does cause harmful interference to radio or television reception, which can be determined by turning the equipment off and on, the user is encouraged to try to correct the interference by one or more of the following measures:

- Reorient or relocate the receiving antenna.
- Increase the separation between the equipment and receiver.
- Connect the equipment into an outlet on a circuit different from that to which the receiver is connected.
- Consult the dealer or an experienced radio/TV technician for help.

This device complies with Part 15 of the FCC Rules. Operation is subject to the following two conditions:  
(1) This device may not cause harmful interference.  
(2) This device must accept any interference received, including interference that may cause undesired operation.

**ISED Regulatory Compliance**  
This device contains licence-exempt transmitter(s)/receiver(s) that comply with Innovation, Science and Economic Development Canada's licence-exempt RSS(s). Operation is subject to the following two conditions:  
1. This device may not cause interference.  
2. This device must accept any interference, including interference that may cause undesired operation of the device.  
*L'émetteur/récepteur exempt de licence contenu dans le présent appareil est conforme aux CNR d'Innovation, Sciences et Développement économique Canada applicables aux appareils radio exempts de licence. L'exploitation est autorisée aux deux conditions suivantes :*  
1. L'appareil ne doit pas produire de brouillage;  
2. L'appareil doit accepter tout brouillage radioélectrique subi, même si le brouillage est susceptible d'en compromettre le fonctionnement.

**RF Exposure Compliance**  
This equipment complies with FCC/IC radiation exposure limits set forth for an uncontrolled environment. This equipment should be installed and operated with minimum distance 20cm between the radiator and your body.  
*Cet équipement est conforme aux limites d'exposition aux radiations FCC/IC établies pour un environnement non contrôlé. Cet équipement doit être installé et utilisé avec une distance minimale de 20 cm entre le radiateur et votre corps.*

**Toucan**  
**VuPoint Solutions, Inc. (USA):**  
710 Nogales Street, City of Industry, CA 91748  
**VuPoint (Europe) Company Limited:**  
Innovation Center, Longbridge Technology Park,  
Longbridge, Birmingham B31 2T5  
For additional info, visit our website at [www.toucansolution.com](http://www.toucansolution.com)

©2022 VUPOINT SOLUTIONS, INC. All Rights Reserved.  
The Toucan logo and Toucan are trademarks or registered trademarks of VuPoint Solutions Inc. in the United States and other countries. The Bluetooth® word mark and logos are registered trademarks owned by Bluetooth SIG, Inc. Product names, logos, brands and other trademarks referred to herein are the property of their respective trademark holders. All trademarks remain the property of their respective holders, and are used only to describe the products or services being provided. These trademark holders are not affiliated with VuPoint Solutions, Inc. They do not sponsor or endorse VuPoint Solutions, Inc.'s products or services.

# Thank You for Purchasing VIDEO CONFERENCE SYSTEM HD SC100

## What's in the Box

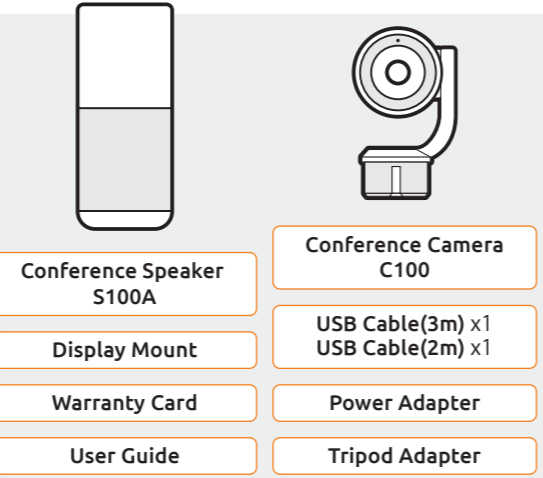

## Getting to know your Video Conference System HD SC100

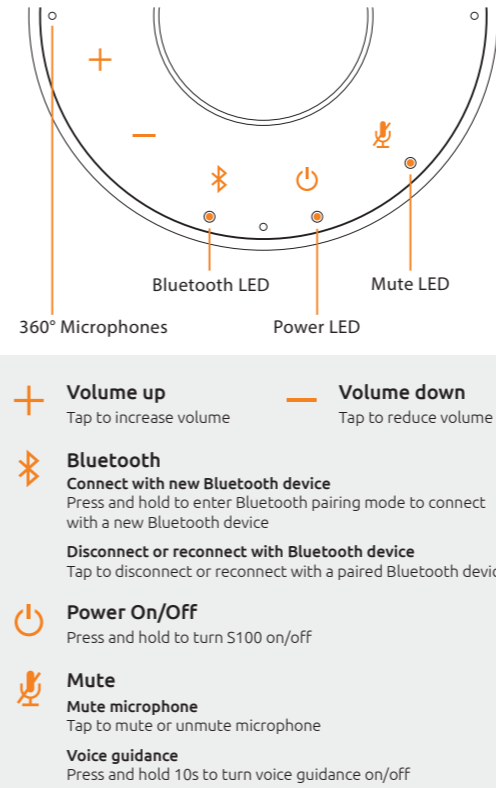

## Getting Started

- 1 Turn on SC100**
- Remove the top cover of S100A conference speaker and snap in C100 conference camera module.
  - Plug the included power adapter into a power outlet and connect the other end to SC100
  - Press and hold on the top of the speaker for 1 second to turn SC100 on and 2 seconds to turn it off.

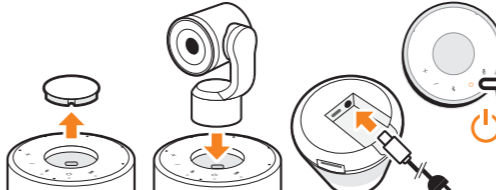

## 2 Connect SC100 to your computer

- Plug the included USB cable into your computer and connect the end with the type-C connector to SC100.
- Select S100A as the default microphone and speaker source. Select C100 as the default camera source.



## 3 Connect SC100 with a Bluetooth Device (Audio Only)

- Press and hold for 2 seconds until the Bluetooth LED on S100A begins flashing. You will hear connection guidance voice prompts.
- Enable Bluetooth on your Bluetooth device.
- Select S100A from the list of available Bluetooth devices to connect.
- You will hear a successful connection message from S100A.
- Tap to disconnect with connecting Bluetooth device.

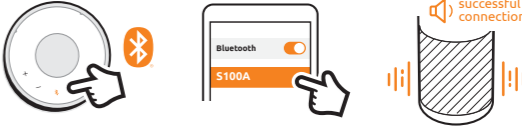

## 4 Mute/Unmute

- Tap while calling to mute or unmute the microphone.

## Mount C100 on Display

- Snap C100 into tripod adapter and attach it to the included display mount.
- Mount C100 on top of the display and adjust the camera view to correct position.
- Plug the included USB cable into either USB port at the bottom of S100A and connect the other end with the type-C connector to C100
- Select S100A and C100 as the default audio and video source on your computer

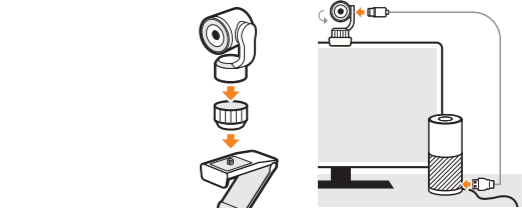

For detailed product information, set up procedures and FAQ's please visit our website: [www.toucansolution.com](http://www.toucansolution.com) or scan the QR code.

# Thank You for Purchasing STREAMING WEBCAM W100

## Getting to know your STREAMING WEBCAM W100

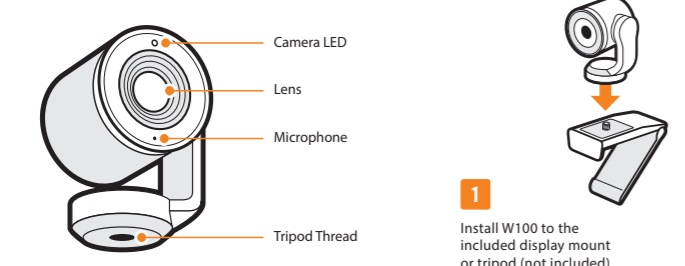

## Getting Started

- 1**
- Install W100 to the included display mount or tripod (not included).

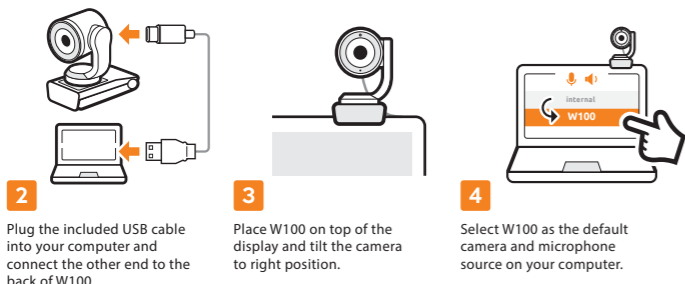

- 2**
- Plug the included USB cable into your computer and connect the other end to the back of W100.
- 3**
- Place W100 on top of the display and tilt the camera to right position.
- 4**
- Select W100 as the default camera and microphone source on your computer.

## What's in the Box



For detailed product information, set up procedures and FAQ's please visit our website: [www.toucansolution.com](http://www.toucansolution.com) or scan the QR code.

**FCC Statement**  
Warning: Changes or modifications to this unit not expressly approved by the party responsible for compliance could void the user's authority to operate the equipment.

NOTE: This equipment has been tested and found to comply with the limits for a Class B digital device, pursuant to Part 15 of the FCC Rules. These limits are designed to provide reasonable protection against harmful interference in a residential installation. This equipment generates, uses and can radiate radio frequency energy and, if not installed and used in accordance with the instructions, may cause harmful interference to radio communications.

However, there is no guarantee that interference will not occur in a particular installation. If this equipment does cause harmful interference to radio or television reception, which can be determined by turning the equipment off and on, the user is encouraged to try to correct the interference by one or more of the following measures:

- Reorient or relocate the receiving antenna.
- Increase the separation between the equipment and receiver.
- Connect the equipment into an outlet on a circuit different from that to which the receiver is connected.
- Consult the dealer or an experienced radio/TV technician for help.

This device complies with Part 15 of the FCC Rules. Operation is subject to the following two conditions:  
(1) This device may not cause harmful interference.  
(2) This device must accept any interference received, including interference that may cause undesired operation.

**ISED Regulatory Compliance**  
This device contains licence-exempt transmitter(s)/receiver(s) that comply with Innovation, Science and Economic Development Canada's licence-exempt RSS(s). Operation is subject to the following two conditions:  
1. This device may not cause interference.  
2. This device must accept any interference, including interference that may cause undesired operation of the device.  
*L'émetteur/récepteur exempt de licence contenu dans le présent appareil est conforme aux CNR d'Innovation, Sciences et Développement économique Canada applicables aux appareils radio exempts de licence. L'exploitation est autorisée aux deux conditions suivantes :*  
1. L'appareil ne doit pas produire de brouillage;  
2. L'appareil doit accepter tout brouillage radioélectrique subi, même si le brouillage est susceptible d'en compromettre le fonctionnement.

**RF Exposure Compliance**  
This equipment complies with FCC/IC radiation exposure limits set forth for an uncontrolled environment. This equipment should be installed and operated with minimum distance 20cm between the radiator and your body.  
*Cet équipement est conforme aux limites d'exposition aux radiations FCC/IC établies pour un environnement non contrôlé. Cet équipement doit être installé et utilisé avec une distance minimale de 20 cm entre le radiateur et votre corps.*

**Toucan**  
**VuPoint Solutions, Inc. (USA):**  
710 Nogales Street, City of Industry, CA 91748  
**VuPoint (Europe) Company Limited:**  
Innovation Center, Longbridge Technology Park,  
Longbridge, Birmingham B31 2T5  
For additional info, visit our website at [www.toucansolution.com](http://www.toucansolution.com)

©2022 VUPOINT SOLUTIONS, INC. All Rights Reserved.  
The Toucan logo and Toucan are trademarks or registered trademarks of VuPoint Solutions Inc. in the United States and other countries. All trademarks remain the property of their respective holders, and are used only to describe the products or services being provided. These trademark holders are not affiliated with VuPoint Solutions, Inc. They do not sponsor or endorse VuPoint Solutions, Inc.'s products or services.