

R1

USER GUIDE
BEDIENUNGSANLEITUNG

Table of Contents

1 Introduction	2
1.1 Features	2
1.2 Package Contents	2
1.3 Product Overview	3
2 Getting Started	4
2.1 Inserting the Memory Card	4
2.2 Installation	5
2.3 Adjust Device Position	7
2.4 Connecting to Power	7
2.5 Set Date & Time	8
2.6 Language	8
2.7 Default Settings	9
2.8 Factory Reset	9
3 Using the Car Dash Camera	10
3.1 Recording Videos	10
3.2 Recording Screen	10
3.3 Adjusting the Settings	11
3.4 Adjust the Recording Resolution	12
3.5 Loop Recording	12
3.6 Emergency Video Protection	12
3.7 Motion Detection	12
3.8 Vibration Detection	13
3.9 Parking Monitoring	13
3.10 Auto Power Off	13
3.11 Screen Auto Off	13
3.12 Taking a Snapshot	13
3.13 Audio Recording	14
3.14 Playback Videos & Photos	14
3.15 Deleting Video & Photo Files	14
3.16 Enable Wi-Fi	14
3.17 Screen Stamps	14
3.18 Key Tone	15
3.19 Driver Safety Alerts	15
4 Wi-Fi Setup and Companion App	15
4.1 Wi-Fi Application Functions	16
5 Menu Overview	17
6 FAQs	19
7 Customer Support	20
8 Warranty	20
9 Product Specifications	21
FCC Statement	22

1 Introduction

Thank you for buying the R1 car dashcam. Protect you and your vehicle with real-time video and audio recording while you're driving. Please read this manual carefully before using this product. We hope you enjoy using this product.

1.1 Features

- Wi-Fi
- 2304x1296P Resolutions (Front Camera Only)
- 2.7" LCD Color Screen
- Up to 155-degree wide angle lens
- Built-in G-Sensor
- Motion Detection
- Parking Mode
- Audio Recording

1.2 Package Contents

Dash Camera



Suction Cup Mount



Rear Camera with USB Cable



Car Charger with USB Cable



USB Cable



User Guide



Warranty Card



Pry Tool



Adhesive Cable Clips



1.3 Product Overview

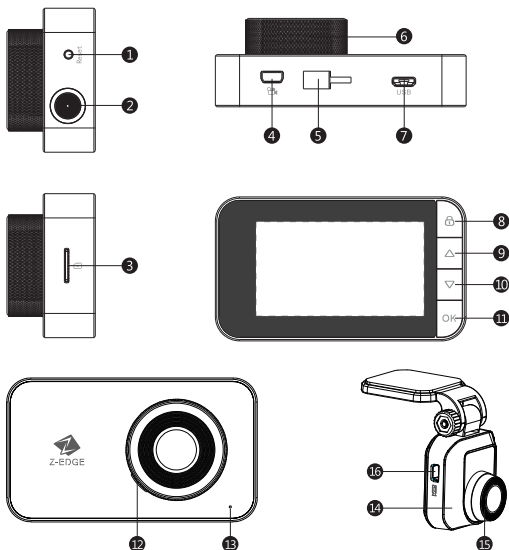

- | | |
|-------------------------------|--------------------------------|
| 1 Reset Button | 9 Up Button |
| 2 Power Button | 10 Down Button |
| 3 TF/Micro SD Card Slot | 11 OK Button |
| 4 Rear Camera Port (Mini USB) | 12 Speaker |
| 5 Suction Cup Mount Slot | 13 Mic |
| 6 Lens | 14 Rear Camera |
| 7 Power/Data Port (Micro USB) | 15 Rear View Lens |
| 8 Menu Button | 16 Rear Camera Port (Mini USB) |

2 Getting Started

2.1 Inserting the Memory Card

Insert the memory card, with the pins facing towards the back of the device, until it clicks into place.

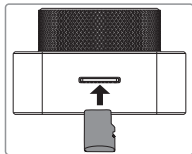

Storage Capacity	Video Recording Time
16GB	2.5 Hours
32GB	5 Hours
64GB	10 Hours
128GB	20 Hours
256GB	40 Hours
For reference only front + rear camera recording at 1080P	

Remove Memory Card

Push the edge of the memory card inward until you feel it click, then allow it to push out until you can remove it from the slot.



WARNING:

We recommend that you format the memory card in the dash camera directly before use. **General Setting>Format SD card**. Please note that all data saved on the memory card will be erased after formatting.

Note:

- Supports Micro SDXC cards up to 256GB (Class 10 or above).
- Do not remove or insert the memory card while the device is powered on - this may damage the memory card.

2.2 Installation

Please follow the below instructions for mounting your dashcam to the windshield of your vehicle:

Front Camera Installation

1. Slide the car mount into the slot on top of the device until a click sound is heard.
2. Connect the dash camera to the power outlet in your car, (see 2.4)
3. Turn the camera on, whilst looking at the display screen, find a suitable location for installing your dashcam on your windshield.

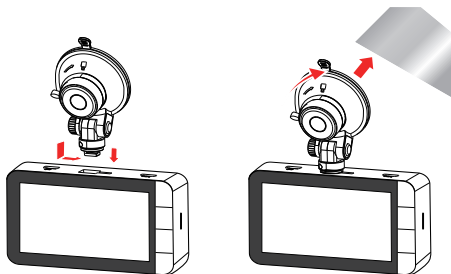

4. Press the suction-cup firmly against your windshield, and rotate the lever clockwise (12 o'clock) to secure.
5. Use the hand tool provided to tuck the power cable into the headliner.
6. In most cases, the power cable can be tucked behind the rubber trim along the A-pillar and doorframe, use the hand tool provided or gently tug on the rubber trim to remove it to make room for the power cable. The rubber trim can be replaced after using the hand tool. In rare cases, it may be necessary to remove the A-pillar cover.

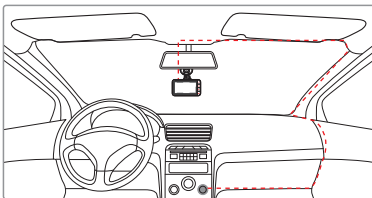

7. Trace the cable down the side of the doorframe to the floor of the vehicle. Then lift the carpet in the passenger side foot-well and trace the cable beneath this.
8. Alternatively, route the power cable down the doorframe and tuck it behind/ below the glove box. Use the cable clips if required.
9. Bring the cable out by the center console to the lighter/auxiliary power socket.

Rear Camera Installation

1. Connect one end of the Mini USB cable into the Mini USB Port (4) on the dash camera. Connect the other end into the Mini USB Port (16) on the rear camera.
2. Turn the camera on. The rear-lens view automatically appears on the display screen in Dual (PiP) format.

Tip: To view full-screen, press the '**Menu**' button (8) to enter the General Settings menu. Use the '**Up**' and '**Down**' buttons (9 & 10) to select the Screen Display option and press the '**OK**' button (11) to confirm. Then select Rear Camera using '**Up**' and '**Down**' buttons (9 & 10) and confirm with the '**OK**' button (11).

3. While looking at the display screen and without removing the adhesive backing, find a suitable location for installing your rear-lens camera on your rear windshield.
4. Having found a suitable location on your rear windshield, peel off the protective plastic backing from the adhesive mount. Press the adhesive pad firmly against your rear windshield to secure.
5. For a more organized car environment, the rear camera USB cable can be routed as indicated by the dashed line in the diagram. Use the pry tool to tuck the cable behind the car panels or headliner.

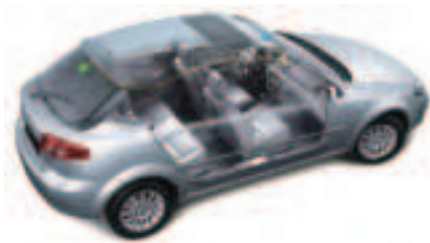

Note: Consult your vehicle's technical manual or consult a professional if you are not sure how to remove interior panels.



WARNING:

Do not install the device on a tinted window - doing so may damage the tint film.

2.3 Adjust Device Position

1. Loosen the nut to swivel the device vertically. Click into place and secure by tightening the nut.
2. Swivel the device horizontally for a clear view.

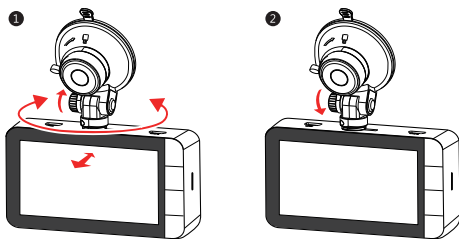

2.4 Connecting to Power

Use only the supplied car adapter to power the dashcam and charge the built-in battery.

1. Plug one end of the USB charging cable into the Mini USB port on the dash camera (7).
2. Plug the other end into the car charger, and insert that into your vehicle's lighter socket.

Automatic Power

- Once the vehicle's engine is switched on, the dashcam automatically powers on.
- When the vehicle engine is switched off, the dashcam automatically saves the recording and power off within 10 seconds.

Manual Power

- To manually turn the power on, press and hold the '**Power**' Button (2) for up to 3 seconds.
- To manually turn the power off, press, and hold the '**Power**' Button (2) for 3 seconds.



WARNING:

If the environment reaches 115-degrees Fahrenheit or above, the car charger may stop charging the dash cam battery. This is characteristic of a Lithium Polymer battery and is not a malfunction.

2.5 Set Date & Time

Before using the device, we recommend you set the correct date and time:

1. If the device is recording, short press the '**OK**' button (11) to stop recording, and enter Standby Mode.
2. Press the '**Menu**' button (8) to enter the General Settings menu.
3. Press the '**Up**' and '**Down**' buttons (9 & 10) to select Date/Time and press the '**OK**' button (11) to confirm.
4. Press the '**Up**' and '**Down**' buttons (9 & 10) to adjust the values and then press the '**OK**' button (11) to confirm and move to the next field.
5. With all fields correct, press the '**OK**' button (11) to save and exit the menu.



WARNING:

Date/Time settings may automatically reset themselves if the battery is allowed to drain completely.

2.6 Language

The language can be set from the language menu.

1. Press the '**Menu**' button (8) to enter the General Settings menu.
2. Use the '**Up**' and '**Down**' buttons (9 & 10) to choose the language menu.
3. Press the '**OK**' button (11) to confirm.
4. Press the '**Up**' and '**Down**' buttons (9 & 10) to choose the desired language and then press the '**OK**' button (11) to confirm the option.
5. The '**Menu**' button (8) can be used to return from the menu. **General Settings**
> **Language** > **English / Chinese (Simp) / Chinese (Trad) / German / Japanese**

2.7 Default Settings

Menu	Options	Default	Drive	Scenic	Park
Resolution	1080P+1080P, 1296P+1080P	1296P+1080P	1296P+1080P	1296P+1080P	1296P+1080P
Audio Recording	On/Off	On	On	On	On
Loop Recording	1min,3mins,5mins	3mins	3mins	5mins	1min
Date Stamp	On/Off	On	On	Off	On
Device Auto Off	Off,1min,3mins,5mins	1min	1min	3mins	1min
G-Sensor	Off,Low,Normal,High	Normal	Normal	Low	High
Logo Stamp	On/Off	On	On	On	On
Parking Mode	On/Off	Off	On	On	On
Screen Auto Off	Off,1min,3mins,5mins	3mins	1min	Off	1min
WDR	On/Off	On	On	On	On

There are three preset scenario modes for everyday driving, scenic driving or when the vehicle is parked. These aim to offer the optimum settings for the best video recording in each of these instances.

You can choose to enable any one of these modes from the settings menu.

General Settings > Scenario Mode > Default / Drive / Scenic / Park

2.8 Factory Reset

To reset the dashcam to factory default

Soft Reset

1. If the device is recording, short press the '**OK**' button (11) to stop recording, and enter Standby Mode.
2. Press the '**Menu**' button (8) to enter the General Settings menu.
3. Press the '**Up**' and '**Down**' buttons (9 & 10) to select Restore Factory Settings.
4. Press the '**OK**' button (11) to select.
5. Press the '**Up**' and '**Down**' buttons (9 & 10) to select confirm.
6. Press the '**OK**' button (11) to select.

Hard Reset

If the dash camera does not respond, you can force a factory reset using the reset button. To reset the dashcam to the factory default settings, long-press the '**Reset**' button (1) until the dashcam's screen turns off.

3 Using the Car Dash Camera

3.1 Recording Videos

With an SD card inserted and the device connected to power, when the car engine is switched on, the dashcam automatically powers on and starts recording. When the vehicle engine is switched off, the dashcam will automatically save the recording and power off within 10 seconds.

Alternatively, short press the 'OK' button (11) to stop/start video recording manually.

3.2 Recording Screen

While the dash camera is recording



- 1. Record
- 2. Resolution
- 3. WDR
- 4. Parking Mode
- 5. Audio Recording Status
- 6. Wi-Fi

- 7. Protect Video
- 8. Snapshot
- 9. Audio Recording
- 10. Stop
- 11. Date Time
- 12. Battery

While the dash camera is in standby



- | | |
|---------------------------|---------------|
| 1. Pause | 8. Settings |
| 2. Resolution | 9. Camera |
| 3. WDR | 10. Playback |
| 4. Parking Mode | 11. Record |
| 5. Motion Detection | 12. Date Time |
| 6. Audio Recording Status | 13. Battery |
| 7. Wi-Fi | |

3.3 Adjusting the Settings

Customize the video recording and other general settings via the on-screen display (OSD) menus:

If the device is recording, short press the 'OK' button (11) to stop and enter Standby Mode.

1. Press the '**Menu**' button (8) to enter the General Settings menu.
2. Press the '**Up**' and '**Down**' buttons (9 & 10) to select a menu option and press the '**OK**' button (11) to enter the selected menu.
3. Press the '**Up**' and '**Down**' buttons (9 & 10) to select the desired setting and press the '**OK**' button (11) to confirm the setting.
4. From the General Settings menu, press the '**Menu**' button (8) to exit the menu.

3.4 Adjust the Recording Resolution

The resolutions can be adjusted in the general settings. The R1 dash camera supports 1296P and 1080P front camera recording and 1080P rear camera recording.

The rear camera options will only show when the rear cameras is connected to the dash camera.

Front camera only:

General Settings > Resolution > 1296P /1080P

Front and Rear Camera:

General Settings > Resolution > 1296P+1080P /1080P+1080P

3.5 Loop Recording

Videos are recorded and saved to the memory card in set intervals. Once the memory card is full, Loop Recording automatically overwrites the earliest unprotected saved file. This prevents long duration video clips from being lost in a single overwrite. Video files can be saved to the memory card in 1, 3 or 5 minute intervals: **General Settings > Loop Recording > 1 min / 3 mins / 5 mins**

3.6 Emergency Video Protection

If the G-sensor sensitivity is set to low, medium or high (see and senses an unusual impact or collision the Dash Camera will automatically protect the currently recorded video file from being overwritten. A EMR icon appears top left to signify the current recording is protected and a yellow bar denotes the protected video clip as it records.

To manually protect a video file during a recording, short press the 'Menu' button (8).

3.7 Motion Detection

With **Motion Detection** enabled, video recording is automatically started when movement is detected by the camera lens. After approximately 60 seconds with no movement detected, video recording is automatically paused.

Enable/disable feature: **General Settings > Motion Detection Mode > Motion Detection > On / Off**

Note:

Motion detection will only work if the camera is powered on. It is different from Parking Mode that relies on a G-sensor being activated to trigger it and can be activated when the camera is powered On or Off.

3.8 Vibration Detection

The **Vibration Detection** feature senses for unusual impacts or collisions detected by the built-in G-Sensor. It automatically triggers the **Emergency Video Protection**.

Set the sensitivity to automatically trigger these features with smaller or larger vibrations (feature can also be turned Off).

G-sensor sensitive can be adjusted from the: **General Settings > Sensitivity > Off / Low / Middle / High**

3.9 Parking Monitoring

Enable **Parking Mode** feature for the dash camera to continue monitoring your vehicle for unusual impact or collision when the engine is turned off and parked. If a vibration is detected, the device will automatically turn on and begin recording. Approximately 30 seconds after the motion or vibration is finished, the device will automatically return to monitoring mode. All recordings are automatically protected from being overwritten.

Enable/disable feature: **General Settings> Motion Detection Mode > Parking Mode> On/Off**

3.10 Auto Power Off

Enable the **Auto Power Off** feature for the dash camera to automatically turn off when it is not recording. This can be set to Off, 1 min, 3mins. To disable the auto power off function set it to off.

General Settings>Auto Power Off > Off / 1 min / 3 mins.

3.11 Screen Auto Off

Enable the **Screen Saver** feature for the LCD display to automatically power off. This prevents the screen from being a distraction to the driver. This feature can be set to Off, 1 min, 3mins. The screen will automatically power off after the set duration of time. Set the feature to Off for the screen to remain on constantly while the device is powered.

General Settings>Screen Saver > Off / 1 min / 3 mins.

3.12 Taking a Snapshot

To take a Snapshot press the up button (9) when the dash camera is powered on and is recording or in standby.

3.13 Audio Recording

When the dash camera is recording the **Audio Recording** function can be enabled or disabled by pressing the up button (9).

3.14 Playback Videos & Photos

1. If the dash camera is recording, short press the '**OK**' button (11) to stop and enter Standby Mode.
2. Press the '**Down**' button (10) to enter Playback Mode.
3. Press the '**Up**' and '**Down**' buttons (9 & 10) to select between Normal Video, Emergency Video or Photo. Press the '**OK**' button (11) to select or press the '**Menu**' button (8) to return to standby mode.
4. Press the '**Up**' and '**Down**' buttons (9 & 10) to choose the file to preview and '**OK**' button (11) to select.
5. Press the '**Down**' button (10) to preview the file.
6. Press the '**OK**' button (11) to return / pause the preview.
7. Press the '**Menu**' button (8) to return to the Playback menu.

3.15 Deleting Video & Photo Files

1. Go to the Playlist menu (see 3.14).
2. Navigate to the file you wish to manage and press the '**OK**' button (11) to select.
3. Press the '**Up**' button (9) to delete the file.
4. Press the '**Up**' and '**Down**' buttons (9 & 10) to select between Yes and No.
5. Use the '**OK/REC**' button (11) to confirm choice.

3.16 Enable Wi-Fi

With the **Wi-Fi feature** enabled the Android/iOS app can be used on your supported devices to view video recordings and images.

General Settings > Wi-Fi > On / Off

3.17 Screen Stamps

Enable the **logo** or **date and time** stamp to have them appear on your video clips and pictures you can activate them in the menu.

Date and Time Stamp: **General Settings > Screen Stamp > Date Stamp > On / Off**

Logo Stamp: **General Settings > Screen Stamp > Logo Stamp > Off / On**

3.18 Key Tone

Enable the **Key Tone** function to have a chime sound when pressing the keys on the dash camera. **General Settings > Key Tone > Off / On**

3.19 Driver Safety Alerts

The dash camera has a **Driver Fatigue Alarm** and **Light Reminder** alarms that can be set to aid the driver.

The **Driver Fatigue Alarm** can be turned off or set to 1, 2 or 4 hours to remind the driver to take a break on longer journeys.

General Settings > Driving Safety > Driver Fatigue Alarm > Off / One hour / Two hours / Four hours

The **Light Reminder** can be set to remind the driver to turn on the vehicles lights. This is calculated from a light sensor built into the camera.

General Settings > Driving Safety > Light Reminder > Off / On

4 Wi-Fi Setup and App

- 1.1 Search for the "Z-DashCam" App on the Google Play Store (Android device) / Apple App Store (iOS device). Then download and install on your smart device.
- 1.2 Alternatively download by scanning the QR code on the dash camera
Using a QR code reader on your smart device.
 - (1) On the dash camera open the QR code, **General settings > APP Download**.
 - (2) Open the QR code reader on your smart device.
 - (3) Scan the QR code displayed on the screen of the dash camera.
 - (4) Follow the instructions to download and install the App on your device.
2. Check the Wi-Fi feature is enabled on the R1 dash camera. (See 3.16).
3. Open the Wi-Fi settings on your smart device and select the Z-EDGE R1 Dash Camera. The SSID name is Z-EDGE-R1, followed by a 4 characters. E.g. "**Z-EDGER1XXXX**" Enter the password when prompted.
Password: **12345678**
4. Open the "Z-Dash Cam" App on your smart device.
5. On the App, click Connect DVR.

4.1 Wi-Fi Application Functions

NO.	Item	Description
1	Back Arrow	Return to the main screen
2	Microphone	Enable/disable audio recording
3	Video Camera Icon	Record a 10 second clip
4	Compass	Orientate map to North
5	Connection	Disconnect the app from the dash camera.
6	Settings	Open the settings menu and adjust settings for the dash camera.
7	Speed	Toggle between mph & km/h
8	Video Full Screen	Toggle the video view between full and half screen
9	Camera	Take a picture
10	File Manager	View/Play/Download/Delete the saved videos and images
11	Traffic	Show traffic on the map
12	Map	Map location
13	Route	Show & record the dash cam GPS data in the app (Note: Enable GPS on your phone first)
14	Map Full Screen	Toggle the Map view between full and half screen
15	Centre	Center map on dash camera's location

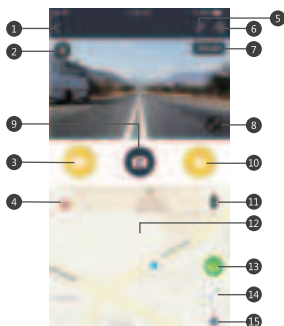

5 Menu Overview

Menu	Feature	Description	Available option
General Settings	App Download	Display QR code to download the App.	-
	Scenario Mode	Set one of the preset modes for different diving Scenarios.	Default/Drive/Scenic/Park
	Resolution	Set the resolution of the videos to be recorded.	Front Camera 1296P/1080P Front & Rear Camera 1296P 1080P / 1080P1080P
	Loop Recording	Set the duration of each video file recorded to the memory card(see 3.5)	1Min/3Mins/5Mins
	Display Setting	Set how the cameras display on the screen.	Front/Back/PreviewPIP
	WDR	Enable/disable the Wide Dynamic Range(WDR).	Off/On
	Sensitivity	Set the G-Sensor sensitivity.	Off/Low/Middle/High
	Screen Auto Off	Select time taken for display screen to automatically turn off during operation.	Off/1Min/3Mins
	Keystone	Enable/disable the sound effect when pressing the buttons.	Off/On
	Volume	Set the volume level.	Off/60%/80%/100%
	Language	Set the language of the user interface.	English/German/Simplified Chinese/Traditional Chinese
	Date/Time	Set the date/time (see 2.5)	YYYY/MM/DD HH:MM

Menu	Feature	Description	Available option
General Settings	Screen Stamp	Add/remove a date and time stamp and Logo Stamp. Visible on saved video recordings and photos.	Off/On
	Driving Safety	Driver Fatigue alarm and Light Reminder.	Driver Fatigue Off/One hour/Two hours/Four hours Light Reminder Off/On
	Motion Detection Mode	Enable/disable motion detection and parking mode.	Motion Detection/ Parking Mode/Off/On
	Power On/ Off Tone	Enable/disable the sound effect when device powers on/off.	Off/On
	WiFi	Enable/disable the wifi.	Off/On
	Auto Power Off	Set an auto power off delay.	Off/1Min/3Mins
	Format SD Card	Format the memory card. Warning: All content on the memory card will be deleted and CANNOT be restored or recovered.	Cancel/Confirm
	Format Warning	Set a reminder to format the SD card.	Off/15 days/30 days/ 60 days
	Restore Factory Settings	Reset all options to the factory default settings.	Cancel/Confirm
	About	Firmware Version.	-

6 FAQs

Where should I place the dash cam?

- We recommend that you mount the car dash cam as close to the center of the windshield as possible. This should neither distract the driver nor block the drivers view (see 2.2).

Why does the dash cam stop recording after some time?

- If motion detection is enabled, the dash cam will automatically stop recording when no movements is detected for more than 15 seconds (see 3.7).
- Your micro SD card may be full and need to be formatted before using again. 1080P HD videos are big in size and G-sensor locked videos cannot be erased automatically. We recommend formatting your memory card every 14 days.

Why do you recommend Class 10 micro SD card or above?

- 1080P HD video has a bigger data flow and hence requires a micro SD card with faster writing speed. If memory cards below Class 10 are used, they may cause the dash cam to freeze or other related video recording/erasing issues.

How do I turn off audio during recording?

- To turn off the Audio Recording, short press the '**Down**' button (10) during recording. (Please note: this does not interrupt the video recording).

How long will my battery last after a full charge?

- The dash cam battery usually takes 2-3 hours to fully charge. This can happen simultaneously whilst the dash cam is plugged into your car and recording. The battery can last 5-10 mins on a full charge depending on the model and environmental temperature.

How do I record videos?

- All dash cams are programmed to automatically record when there is power connected and a memory card inserted. When the engine is turned off, or power is disconnected, the dash cam will stop recording approximately after 3-10 secs. Manually start/stop recording by pressing the '**OK**' button (8).

7 Customer Support

For customer support inquiries please contact:

support@z-edge.com

Or visit our website: www.z-edge.com



@zeroedgeGA
facebook.com/zeroedgeGA/



@zeroedgeGA
pinterest.com/zeroedgeGA



@zeroedgeGA
twitter.com/zeroedgeGA



@zeroedge
youtube.com/zeroedge

Follow us to get the latest updates.

8 Warranty

Thank you for choosing Z-EDGE. Your satisfaction is always our first priority.

All Z-Edge customers have a 30-day money back guarantee, to make sure your shopping experience is worry-free.

By default, the unit warranty-period is set to **12 months** from the unit-shipped date.

You can be corrected to **18 months** by register your product in our official website.

Product Registration URL:

www.z-edge.com/pages/register

9 Product Specifications

Item	Description
Image Sensor	CMOS sensor IMX307+GC2053
Resolution	1296P + 1080P 30FPS
Storage Media	Supports Micro SD, up to 256GB Class 10 or above
Display	2.7" TFT LCD 960*240
Lens	Wide Angle Fixed Focus lens F1.8(front) 155 Degrees, F2.1(rear) 110 Degrees
Still Image (Photo Mode)	Sensor Resolution: 2M Format: JPEG
ISO	Auto
White Balance	Auto
Microphone	Yes
Speaker	Yes
Interface	Micro USB 2.0
Battery	Built-in Li-polymer rechargeable (This battery is NOT replaceable)
Operating Temperature	14° ~ 158° F
Operating Humidity	20 ~ 70% RH
Storage Temperature	-4° ~ 158° F
Dimensions	3.5 x 2 x 1.2 inch, 89 x 52 x 32 mm (LxWxH)
Weight	3.0oz/85g
Car Charger	INPUT: DC 12-24V, OUTPUT: DC 5V 1A

FCC Statement

This equipment has been tested and found to comply with the limits for a Class B digital device, pursuant to Part 15 of the FCC Rules. These limits are designed to provide reasonable protection against harmful interference in a residential installation. This equipment generates, uses and can radiate radio frequency energy and, if not installed and used in accordance with the instructions, may cause harmful interference to radio communications. However, there is no guarantee that interference will not occur in a particular installation. If this equipment does cause harmful interference to radio or television reception, which can be determined by turning the equipment off and on, the user is encouraged to try to correct the interference by one or more of the following measures:

- Reorient or relocate the receiving antenna.
- Increase the separation between the equipment and receiver.
- Connect the equipment into an outlet on a circuit different from that to which the receiver is connected.
- Consult the dealer or an experienced radio/TV technician for help.

This device complies with Part 15 of the FCC Rules. Its operation is subject to the following two conditions: (1) This device may not cause harmful interference, and (2) this device must accept any interference received, including interference that may cause undesired operation.

FCC Caution: Any changes or modifications not expressly approved by the party responsible for compliance could void the user's authority to operate this equipment.

FCC RF Radiation Exposure Statement:

1. This Transmitter must not be co-located or operating in conjunction with any other antenna or transmitter.
2. This equipment complies with RF radiation exposure limits set forth for an uncontrolled environment.
3. This equipment should be installed and operated with minimum distance 20cm between the radiator & your body.



www.z-edge.com
email: support@z-edge.com
R1Z21UMENDE-03