

H4 / H4W

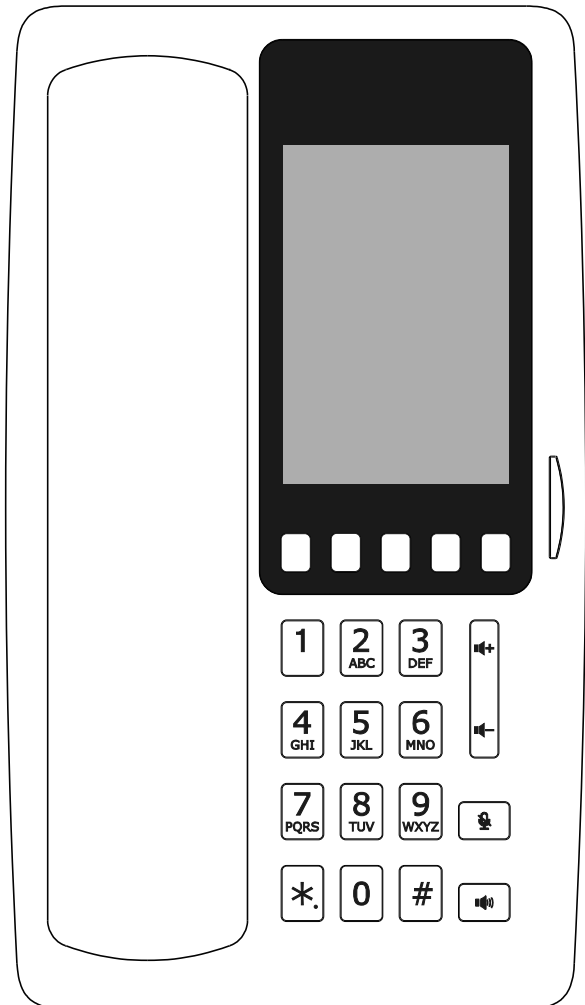

H6W

Quick Installation Guide

English (EN)

Precautions

Warning: Please do not power cycle the device during system boot up or firmware upgrade. You may corrupt firmware images and cause the unit to malfunction.

Warning: Use only the power adapter included in the device package. Using an alternative non-qualified power adapter may possibly damage the unit.

Overview

Fanvil H4/H4W/H6W is a cost-effective, multi-functional, and elegantly designed hotel IP phone. It is equipped with 5 programmable soft keys for service hotlines, meeting the application requirements of various hotel scenarios. H4W/H6W feature built-in dual-band 2.4GHz & 5GHz Wi-Fi (Wi-Fi 6). Moreover, they support functions such as HD audio, 10/100Mbps network port, and integrated PoE, offering a high-quality user experience while reducing the cost of hotel deployment. It is more than just a hotel phone; it can also be applied in multiple scenarios, such as shopping malls, hospitals, and supermarkets.

Packaging list

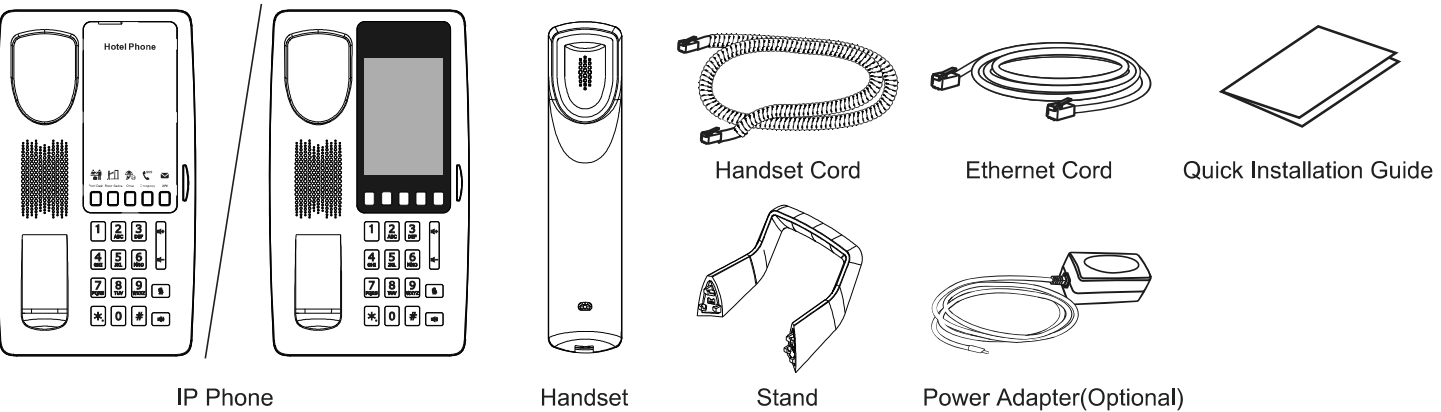

Keys description

* Comparing the H4/H4W and H6W, the H6W features a 3.5-inch screen, whereas the H4/H4W does not have a screen.

Taking H4/H4W as an example:

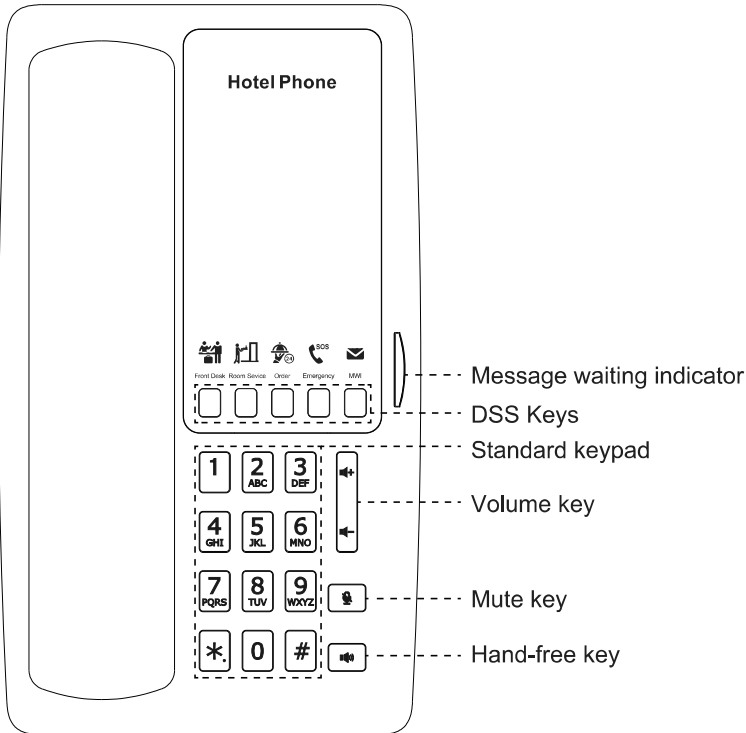

Device installation

Please follow the instructions in below picture to install the device.

• Bracket desktop installation

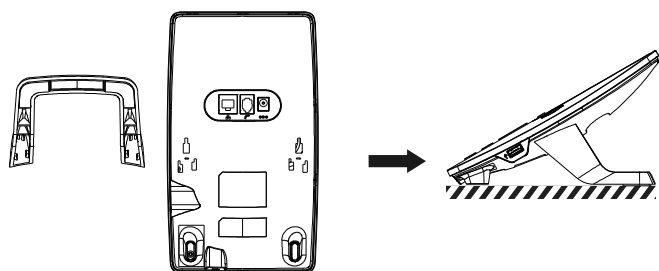

• Connecting to the device

Please connect power adapter, network, USB, handset to the corresponding ports as described in below picture.

- ① USB port: Connect USB device(Charge Only)
- ② Network port: connecting local area network or Internet.
- ③ Handset port: connect IP Phone.
- ④ Power port: connect the power adapter.

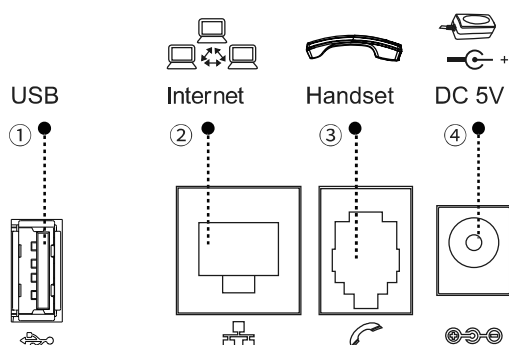

Configuration

Configuration via web

1. H4/H4W: Get the IP address: Press the “#” key for more than 6 seconds to broadcast IP.
H6W: Get the IP address: Press the “#” key for more than 6 seconds, the network IP address information is displayed.
2. Login: Input the IP address in the web browser. The PC and phone should be in the same IP address segment (The default username and password are both ‘admin’.)
3. Configure: Select network/account etc, and fill the relevant content.
4. Save the configuration.

Making a call

1. **Pre-dialing:** enter the phone number and pick up the handset.
2. **Direct dialing:** lift the handset and enter the phone number.
3. **Handsfree:** enter phone number and press or vice versa.
4. **Memory key:** press memory key.

Accepting a call

1. **Using the handset:** pick up the handset.
2. **Using the handsfree:** press .

Programmable keys

1. Log in web page > Function key > DSS Keys, Select the function and fill in the number in the value items.
2. Log in web page > Function Key > Speed Dial List , Select memory key(number keys 0-9) and fill in the number in the value items.

Network connect

Using Ethernet

1. The power on the device and connect the WAN port of the phone to the RJ45 socket of a hub/switch or a router (LAN side of the router) using the Ethernet cable.
2. The default is DHCP mode.

Using Wi-Fi (Configuration via Web)- (only H4W/H6W):

1. Log in web page > Network > Wi-Fi settings, check “Wi-Fi Enable” and add Wi-Fi information.

Using Wi-Fi - (only H6W):

1. The power on the device and make sure the phone is idle.
2. Enter “#*107” to access the menu > Basic > WLAN, Enabled the Wi-Fi Feature.
3. Press scan to search for currently available wireless network.
4. Enter the available network and select the Wi-Fi you want to connect.
5. Press connect soft key and enter the appropriate password to connect to the Wi-Fi. The default is DHCP mode.

Note: You can contact your service provider for additional settings that may be necessary to configure the phone, or download the user manual and FAQ for more detailed information.

FCC Statement

This equipment has been tested and found to comply with the limits for a Class B digital device, pursuant to part 15 of the FCC rules. These limits are designed to provide reasonable protection against harmful interference in a residential installation. This equipment generates, uses and can radiate radio frequency energy and, if not installed and used in accordance with the instructions, may cause harmful interference to radio communications. However, there is no guarantee that interference will not occur in a particular installation. If this equipment does cause harmful interference to radio or television reception, which can be determined by turning the equipment off and on, the user is encouraged to try to correct the interference by one or more of the following measures:

- Reorient or relocate the receiving antenna.
- Increase the separation between the equipment and receiver.
- Connect the equipment into an outlet on a circuit different from that to which the receiver is connected.
- Consult the dealer or an experienced radio/TV technician for help.

To assure continued compliance, any changes or modifications not expressly approved by the party.

Responsible for compliance could void the user's authority to operate this equipment. (Example- use only shielded interface cables when connecting to computer or peripheral devices).

Any Changes or modifications not expressly approved by the party responsible for compliance could void the user's authority to operate the equipment.

This equipment complies with Part 15 of the FCC Rules. Operation is subject to the following two conditions:

- (1) This device may not cause harmful interference, and
- (2) This device must accept any interference received, including interference that may cause undesired operation.

FCC Radiation Exposure Statement:

The equipment complies with FCC Radiation exposure limits set forth for uncontrolled environment. This equipment should be installed and operated with minimum distance 20cm between the radiator and your body.