

MT7937A WIRELESS BARCODE SCANNER

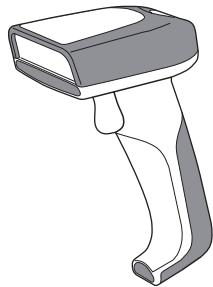

Quick Guide

Full user's manual is available on
the enclosed CD.



Version 1.0

FCC WARNING STATEMENT

This equipment has been tested and found to comply with the limits for a Class B digital device, pursuant to Part 15 of the FCC Rules. These limits are designed to provide reasonable protection against harmful interference in a residential installation.

This equipment generates, uses and can radiate radio frequency energy and, if not installed and used in accordance with the instructions, may cause harmful interference to radio communications. However, there is no guarantee that interference will not occur in a particular installation. If this equipment does cause harmful interference to radio or television reception, which can be determined by turning the equipment off and on, the user is encouraged to try to correct the interference by one of the following measures:

- Reorient or relocate the receiving antenna.
- Increase the separation between the equipment and receiver.
- Connect the equipment into an outlet on a circuit different from that to which the receiver is connected.
- Consult the dealer or an experienced radio/TV technician for help.

CANADIAN DOC STATEMENT

This digital apparatus does not exceed the Class B limits for radio noise for digital apparatus set out in the Radio Interference Regulations of the Canadian Department of Communications.

Le présent appareil numérique n'émet pas de bruits radioélectriques dépassant les limites applicables aux appareils numériques de la classe B prescrites dans le Règlement sur le brouillage radioélectrique édicté par le ministère des Communications du Canada.

CE MARKING AND EUROPEAN UNION COMPLIANCE

Testing for compliance to CE requirements was performed by an independent laboratory. The unit under test was found compliant with all the applicable Directives, 2004/108/EC and 2006/95/EC.

WASTE ELECTRICAL AND ELECTRONIC EQUIPMENT

The WEEE directive places an obligation on all EU-based manufacturers and importers to take-back electronic products at the end of their useful life.

ROHS STATEMENT OF COMPLIANCE

This product is compliant to Directive 2002/95/EC.

NON-MODIFICATION STATEMENT

Changes or modifications not expressly approved by the party responsible for compliance



WARNING AND CAUTION



1. Take any metals into contact with the terminals in connectors.
2. Use the scanner where any inflammable gases.



If following condition occur, immediately power off the host computer, disconnect the interface cable, and contact your nearest dealer.

1. Smoke, abnormal odors or noises come from the scanner.
2. Drop the scanner so as to affect the operation or damage its housing.

Do not do behavior below.

1. Put the scanner in places excessively high temperatures such as expose under direct sunlight.
2. Use the scanner in extremely humid area or drastic temperature changes.
3. Place the scanner in oily smoke or steam environment such as cooking range.
4. Be covered or wrapped up the scanner in bad-ventilated area such as under cloth or blanket.



Do Not

5. Insert or drop foreign materials or water into scanning window or vents.
 6. Using the scanner while hand is wet or damp.
 7. Use the scanner with anti-slip gloves containing plasticizer and chemicals or organic solvents such as benzene, thinner, insecticide etc to clean the housing. Otherwise, it could not result fire and electrical shock but housing may be broken and injured.
 8. Scratch or modify the scanner and bend, twist, pull or heat its interface cable.
 9. Put heavy objects on interface cable.
- Do not stare the light source from the scanning window or do not point the scanning window at other people's eyes or eyesight may be damaged by direct exposure under the light.



Do not put the scanner on an unstable or inclined plane.
The scanner may drop, creating injuries.



Once the interface cable is damaged such as exposed or broken copper wires, stop using immediately and contact your dealer. Otherwise, it could result fire or electrical shock.

OUT OF THE BOX

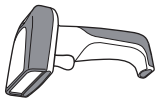

Wireless
Barcode Reader



CD



Quick Guide



Quick Connection Card

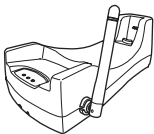

Charging Cradle



USB Charger Cable

INTRODUCTION

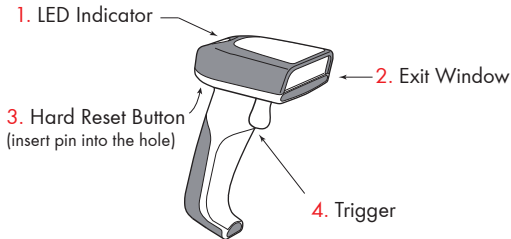

SPECIFICATIONS

Light source	635nm visible red LED
Scan rate	200 scans/sec
Sensor	2048 pixels CCD sensor
Resolution	4mil/ 0.1mm
PCS	40%
Housing	Plastic(ABS)
Profile	SPP, HID
Battery Life	25000 scans (1 scan/ 5 sec)
Charge Time	2 hours (fully charged)
Coverage	100M/330ft. (line of sight)
Operating Temp	0 to 50 °C (32 °F to 122 °F)
Symbologies	All major 1D barcodes incl. GS1 Databar

GETTING STARTED

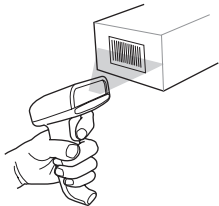

To scan a barcode, make sure the aiming beam crosses every bar and space of the barcode.

CHARGING THE BATTERY

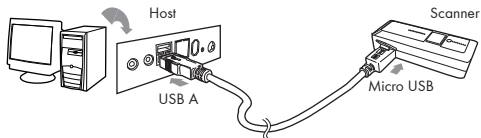

1. Flip open the micro USB port on the scanner.
2. Insert the micro USB connector into the port on the scanner and USB A connector into a USB port on the host PC.

BEEPER INDICATION

Single long beep	Power up
Single beep	Good read
Single short beep	The scanner reads a Code39 of ASCII in configuration procedure
Two beeps	Wireless connection
Two short beeps	The scanner successfully reads a configuration barcode
Five beeps	Low power
Three beeps	Wireless disconnection
Three short beeps	i. The scanner reads a barcodes while disconnected. ii. The scanner reads an unexpected barcode during configuration procedure. (scan [ABORT] to abort and start over)

Several short beeps The scanner switches from one communication mode to another

LED INDICATION

Off	Standby or Power off
Flashing Blue	Disconnected or Discoverable
Blue for 2 sec	Good Read
Flashing Red	Low power
Solid Red	Charging

GETTING CONNECTED

There are two modes of wireless communication:

. E043\$

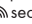

BT - HID

1. Press the trigger for 1 second to activate the scanner.
2. Scan **[DISCONNECT]**
3. Scan **[BT-HID]**; the scanner will emit several short beeps.
4. Select "Wireless Scanner" from discovered device list.
5. The wireless application may prompt you to scan a pincode (see **PINCODE SETUP**  section) it generated.
6. The scanner will beep twice to verify the connection.

. E042\$



BT - SPP

1. Press the trigger for 1 second to activate the scanner.
2. Scan **[DISCONNECT]**
3. Scan **[BT-SPP]**; the scanner will emit several short beeps.
4. Select "Wireless Scanner" from discovered device list.
The default pincode is "1234".
5. Open serial communication software with com port (see Device Manager) properly set up.
6. The scanner will beep twice to verify the connection.

. E031\$



Disconnect

PINCODE SETUP

STEP 1

Pincode Start

. E032\$



STEP 2

Scan numeric barcodes (see **NUMERIC BARCODES**  section on the next pages) based on the pincode generated by the wireless application.



STEP 3

Enter

\$TX



STEP 4

Pincode Stop

. E033\$



NUMERIC BARCODES



1



2



3



4



5

6



7



8



9



0



POWER OFF TIMEOUT

The timeout of inactivity before auto power-off.

Variable Timeout

. B030\$



SET MINUTE
(Range: 00 ~ 60)

. B029\$



SET SECOND
(Range: 00 ~ 60)

The default timeout is 3 minutes 0 second.

For example, to set the timeout as 5 minutes 30 seconds:

1. Scan [Set Minute]
2. Scan [0] & [5] on page 9 & 10.
3. Scan [Set Minute]
4. Scan [Set Second]
5. Scan [3] & [0] on page 9 & 10.
6. Scan [Set Second]

No Timeout (Scanner Always On)

. B021\$



DISABLE
TIMEOUT

SMARTPHONE CONNECTION

Getting Connected - iOS & Android

Simply follow instruction in [BT - HID] (page 7), in which step 5 can be skipped since iOS & Android will not require pin-code for connection.

Touch Keyboard - iOS

. E047\$



ENABLE iOS HOTKEY

After enabling iOS Hotkey(disabled by default), you may simply double-click the trigger to toggle the iPhone/iPad Touch Keyboard.

Touch Keyboard - Android

Please follow below steps to toggle Android virtual keyboard:

1. Enter "Settings"
2. Enter "Language & input"
3. In Keyboard & input window, tap "Default" to continue.
4. Turn off "Hardware - Physical keyboard", and the Touch Keyboard will function properly again.

GENERAL SETTINGS

. A001\$



DEFAULT

. P023\$



ABORT

. A007\$



CHECK
VERSION

BEEPER

. F012\$



BEEP OFF

. F018\$



BEEP ON

READING MODE

TRIGGER

. F002\$



TOGGLE

. F003\$



FLASH

. F001\$



CONTINUOUS

. F005\$



CONTINUOUS
AUTO OFF

. F006\$



KEYBOARD LAYOUT

. C010\$



ENGLISH
(USA)

. C018\$



ENGLISH
(UK)

. C012\$



FRENCH

. C011\$



GERMAN

. C014\$



ITALIAN

. C013\$



SPANISH

JAPAN
(106 key)

. C009\$



CANADIAN
(FRENCH)

. C025\$



CANADIAN
(TRADITIONAL)

. C034\$



NORWEGIAN

. C029\$



SWEDISH

. C026\$



PORTUGUESE

. C031\$



KEYBOARD LAYOUT

. C017\$



CZECH
(QWERTY)

. C022\$



CZECH
(QWERTZ)

. C021\$



HUNGARIAN
(QWERTZ)

. C024\$



HUNGARIAN
(101 KEY)

. C016\$



SWISS
(GERMAN)

. C023\$



SWISS
(FRENCH)

BELGIAN
(AZERTY)

DUTCH

DANISH

SLOVAK

BRAZILIAN
(PORTUGUESE)

ALT CODE

. C030\$



. C028\$



. C027\$



. C032\$



. C033\$



. C015\$



ENABLE SYMBOLOGIES

. A002\$



ENABLE
ALL CODE

. K010\$



CODE 32

. L010\$



UK PLESSEY

. L001\$



MSI

. N001\$



INDUSTRIAL
2 OF 5

. M010\$



MATRIX
2 OF 5

. G010\$



CODE 93

. N017\$



IATA

. L014\$



TELEPEN

. N032\$



GS1 DATABAR

. N010\$



GS1 DATABAR
LIMITED

. N026\$



GS1 DATABAR
EXPANDED

TERMINATOR

. D012\$



. D011\$



. D013\$



. D010\$



. D015\$



. D014\$



CR

LF

CR + LF

NONE

SPACE

TAB

TEST BARCODES

Code 39



CODE-39 TEST

Interleaved 2 of 5



9876543210

Code 128



12345678

EAN



4 7 1 6 4 1 5 9 4 2 0 5 2

FCC RF Radiation Exposure Statement:

This equipment complies with FCC radiation exposure limits set forth for an uncontrolled environment. End users must follow the specific operating instructions for satisfying RF exposure compliance. This transmitter must not be collocated or operating in conjunction with any other antenna or transmitter.