

EDX | SHOCKWAVE

INSTRUCTION MANUAL

MODEL NAME: RUROC SHOCKWAVE BT

WARNING!**READ THIS MANUAL BEFORE USE**

1. The use of this device on public transportation may not be authorized by law. Please check your local laws and use this product only in private spaces.
2. If local law prohibits the use of headphones while riding, do not use. If you do not comply with this warning, Ruroc does not accept any liability.
3. Use of this product at a high volume for a long time may cause damage to your ears & hearing. Please keep the volume at an appropriate level.

PRECAUTIONS OF BATTERY USE

1. Please do not put discarded batteries together with general household garbage. In areas with laws and regulations on recycling & disposal of waste batteries, please follow these regulations.
2. Don't short-circuit the battery. A short circuit occurs when metal objects (keys, jewellery, wires, coins, or other conductors) accidentally connect the positive and negative electrodes of a battery. A short circuit can damage batteries or connectors and may cause significant property damage or personal injury. Please care for the batteries properly and do not leave them in your pocket, wallet or bag with metal objects.
3. Do not set the battery on fire or leave it in a hot place in order to avoid overheating, bursting or combustion.
4. Do not disassemble, weld or modify the battery. Do not puncture the battery with a hard object as the battery may leak, overheat, burst or catch fire.
5. Do not remove, squeeze, heat or burn the battery inside the product. It is strictly prohibited to use sharp objects, screwdrivers, or other devices to puncture or pry the battery open. The above operation may cause the battery to catch fire or burn.
6. If the battery electrolyte (fluid) enters the eye, it can lead to blindness. If you splash the battery electrolyte (fluid) into your eyes, do not rub your eyes with your hands. Rinse thoroughly with water immediately & seek medical attention. If the battery's electrolyte (fluid) sticks to the skin and clothes, wash them immediately with soapy, clean water and seek medical attention if necessary.
7. Do not transfer batteries from other products. Do not use any damaged chargers or batteries. If the temperature of the battery is too high during use, charging or storage, or abnormal phenomena such as discolouration, deformation, bulging & leakage occur in the battery, please stop using and replace the battery to avoid safety problems.
8. The battery is not waterproof; do not use or charge the battery in the kitchen, bathroom or in high-temperature or humidity areas.
9. When charging, the temperature of the battery will rise. Therefore, please do not put the battery inside flammable objects (such as bedding, clothes, etc.) to avoid fire. Doing so may cause the battery to overheat or even explode.

WARRANTY INFORMATION

Ruroc warrants all products to be free of defects in material or workmanship for a period of one year from the date of purchase, subject to the provisions below.

If a Ruroc product fails due to defects in craftsmanship or materials, within the warranty period, we will repair or replace the product free of charge provided that you promptly notify us of any defect (in any event within 7 days) and you immediately cease to use the product in question. Please be aware that this warranty is limited to the original purchaser only.

For detailed information please see the guideline below and/or the product specification following the product.

If you have any questions regarding our products or the above warranty, please feel free to contact our service centre [here](#).

1. Before you return any product, please go to www.ruroc.com/returns and follow the online returns process.
2. Ensure that the returned product is clean and dry before shipping. Dirty and/or foul-smelling helmets will be returned unprocessed or may delay the process with an additional surcharge.
3. Remember to include a note with your name, address, and phone number AND, make sure to include a short statement explaining the warranty problem.

Alternatively, you may also return your product to the store from where you originally purchased the product. Any Ruroc dealer is able to handle the warranty process on your behalf.

NOTE: Damage due to wear and tear, accident, misuse, or neglect, or if you fail to store or use a product other than in accordance with the instructions provided, or damage due to any repairs carried out by you or a third party not authorised by us, is not covered under warranty. Please contact our warranty department if you have any questions.

SAFETY

1. Please keep the products and all spare parts out of the reach of children and pets. Small parts can cause suffocation or other dangerous conditions.
2. Safe startup: be sure to use your product in a safe environment as electronic products may cause distraction or loss of concentration.
3. Pay attention to traffic safety. Please comply with all relevant laws and regulations of the place of use. Never use this product after drinking alcohol or using drugs, or when you are extremely tired.
4. Interference: any interference with a Wireless product can affect its performance. Shut down near medical devices: hospitals & health care facilities may have equipment that is sensitive to radio-frequency. Please effectively follow the rules & regulations of any medical institution & turn off the product when necessary.
5. The use of wireless devices on an aircraft can interfere with the aircraft, so please shut down the electronic device during flights.
6. Do not use this product near a gas station (service station) or where fuel or chemical agents are stored.
7. Accessories and batteries: Please only use accessories and batteries approved by Ruroc. Using other accessories and batteries may damage the product & cause harm.
8. Connecting to other devices: when connecting to other devices, please read the device's instructions carefully for detailed safety instructions & correct product operation. Do not connect incompatible products.
9. DO NOT charge the Shockwave unit whilst riding a motorcycle, the charging unit can cause injury/serious injury in the event of an accident.

FITTING YOUR SHOCKWAVE

1. Remove the Snap-Fit Bluetooth cover on both sides of the helmet. Keep these covers stored securely should you wish to re-use them in the future.

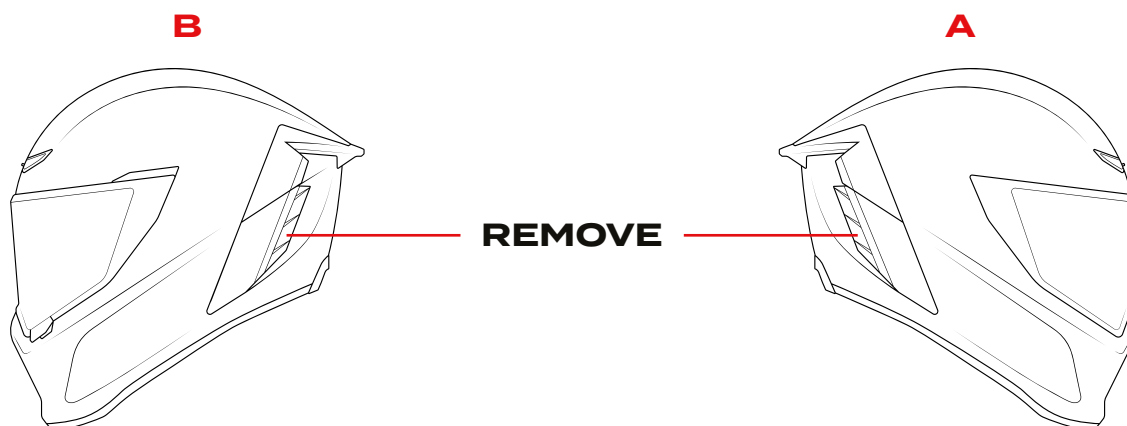

2. Insert Battery into side [A] by lining up the locators with slots in the battery cavity, press until it **'CLICKS'**.

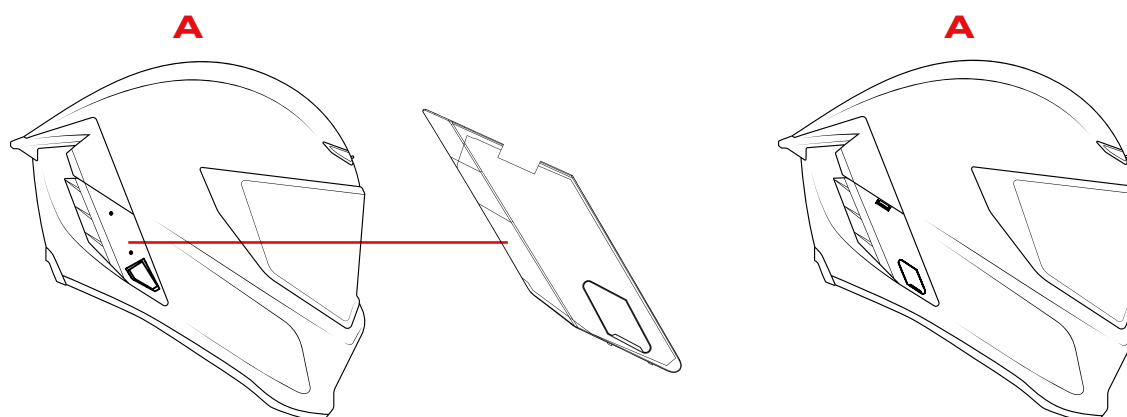

3. Insert Shockwave into side [B] by lining up the locators with slots in the Shockwave cavity, and press until it **'CLICKS'**.

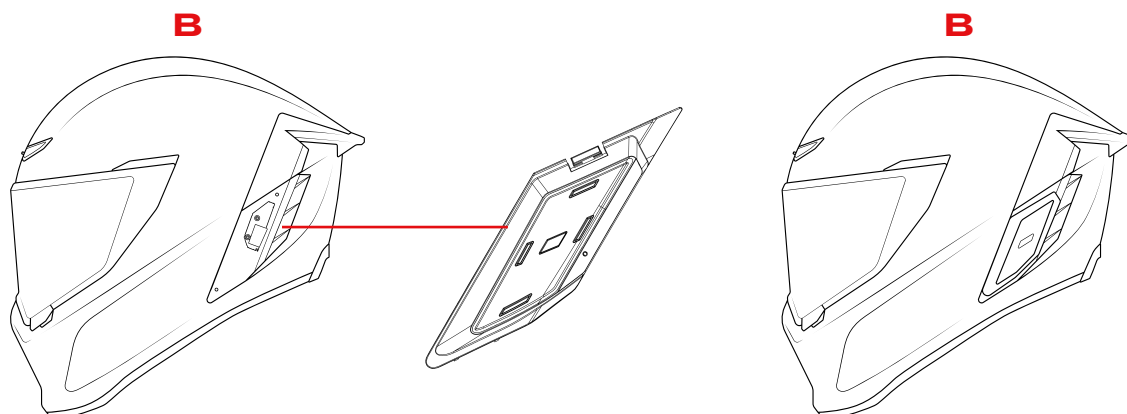

4. More information about how to install your Shockwave can be found [here](#).

CONNECTING YOUR SPEAKERS

1. Gently release the poppers on the cheek pads and remove them from the helmet.

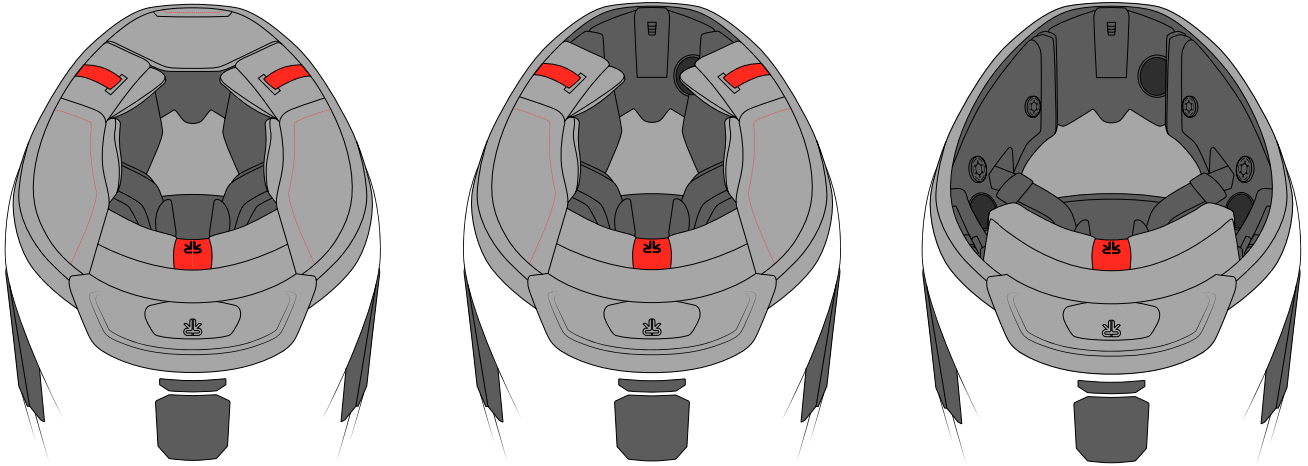

2. Plug the Mic+Speaker cable [C] into the AUX jack port on the helmets left side (right side of below diagrams).

3. Plug the Speaker-only cable [D] into the AUX jack port on the helmets right side (left side of below diagrams)

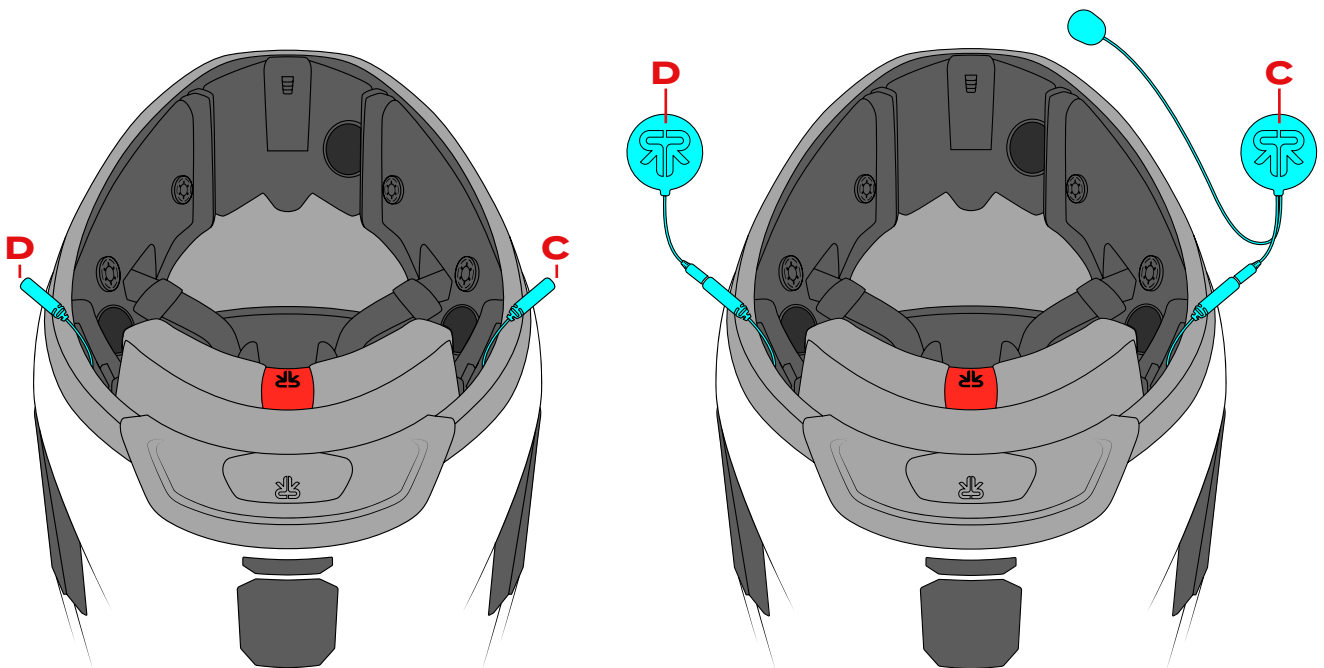

FITTING YOUR SPEAKERS

1. Attach each of the Shockwave speakers where Velcro [E] is located (in the orientation shown in the diagram)
2. Attach the Shockwave Mic where Velcro [F] is located to the side of the chin vent (in the orientation shown in the diagram)

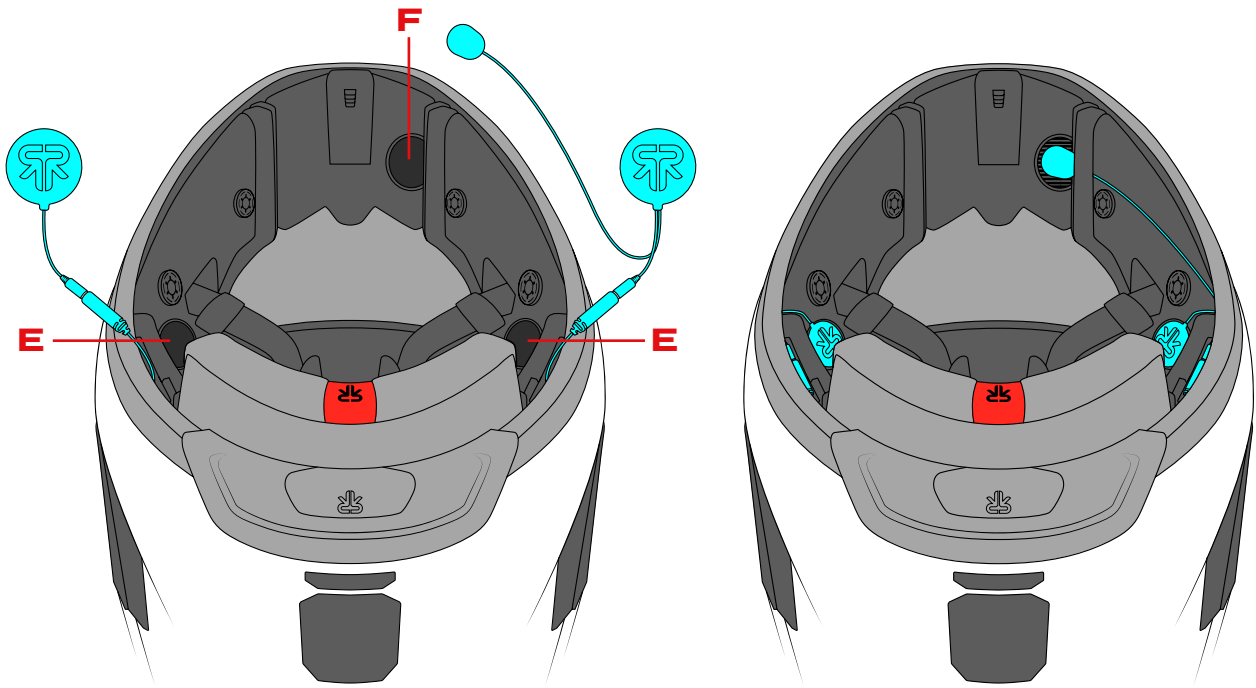

3. Carefully re-attach the cheek pads over the top of the speakers and Mic cable.

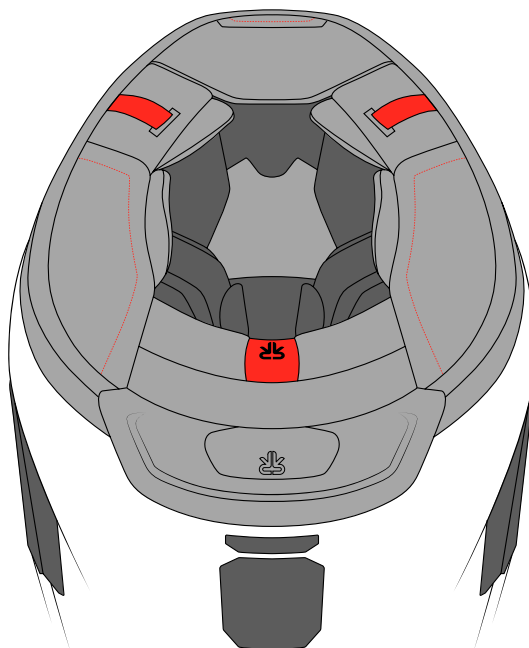

SHOCKWAVE BASICS

TURN ON

Press the **Intercom Button & Media Button for 1 second** to switch on the Shockwave system, you will hear a "Power On" message

TURN OFF

Press the **Intercom Button & Media Button for 1 second** to switch off the Shockwave system, you will hear a "Power Off" message

CHARGING

Plug the USB-C cable into the charging port, the LED will light up **RED** and stay static to indicate it is charging

CHARGED

When the device is fully charged the red LED will flash to indicate that it is fully charged

REBOOT

To reboot the Shockwave, hold the **Intercom Button & Media Button for 10+ seconds**. A voice message of 'Power Off' will sound, and power up the system as normal

RESET

To factory reset the Shockwave hold the **Intercom Button & Media Button & Select/Phone Button for 5+ seconds**, a voice message of 'Reset' will sound, and power up the system as normal

SHOCKWAVE UNIT

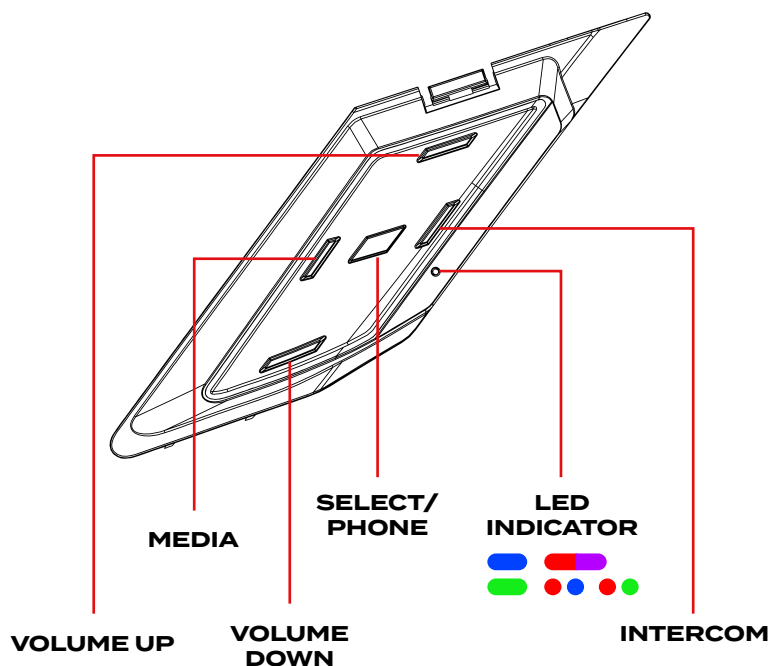

BATTERY

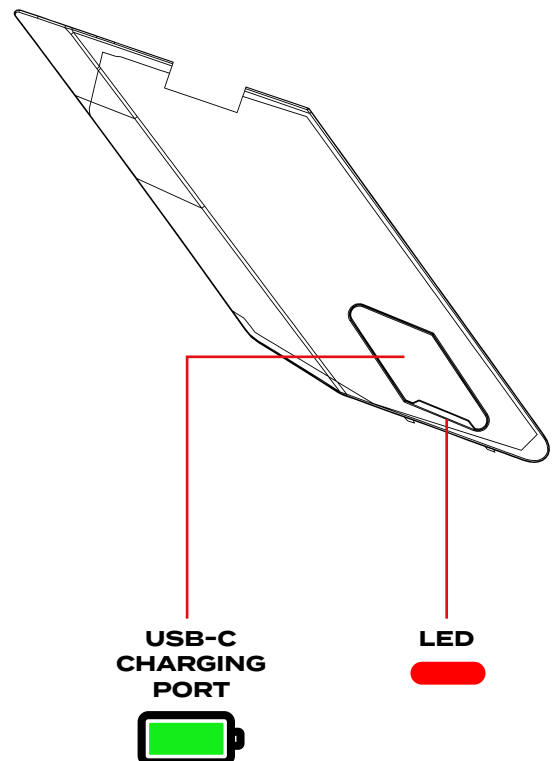

BLUETOOTH CONNECTION

- When connecting the Shockwave system to your device for the first time*, hold the **SELECT/PHONE BUTTON**** for **5 seconds** until you hear 'pairing'.

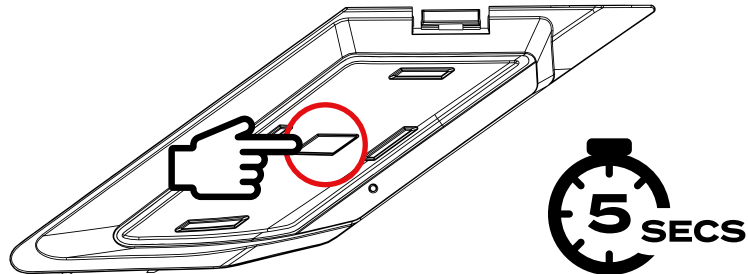

- The **LED** will flash **RED & BLUE** as the Shockwave looks for a connection device

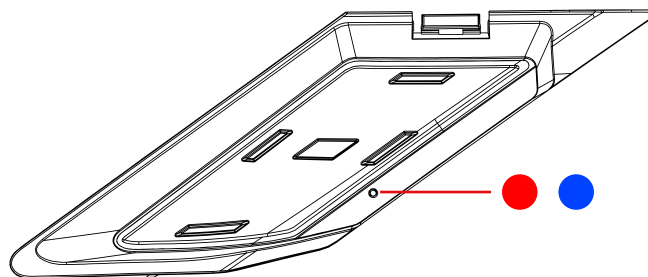

- From your device, enter the Bluetooth® menu and select "SHOCKWAVE BT".

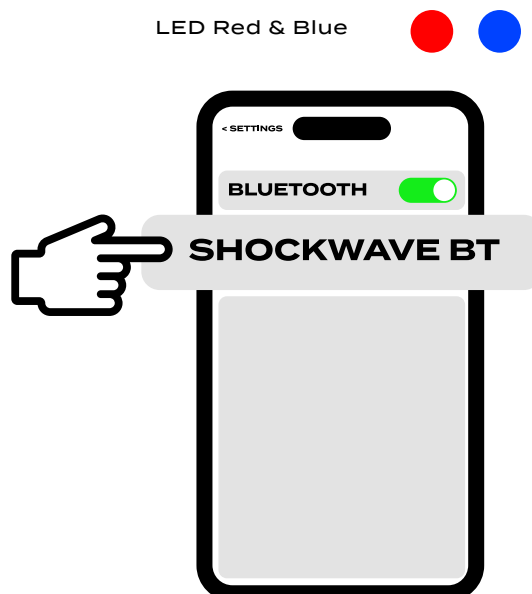

- You will hear the message 'Connected' to confirm the connection, and the **BLUE LED** with flash once periodically while the devices remain paired.

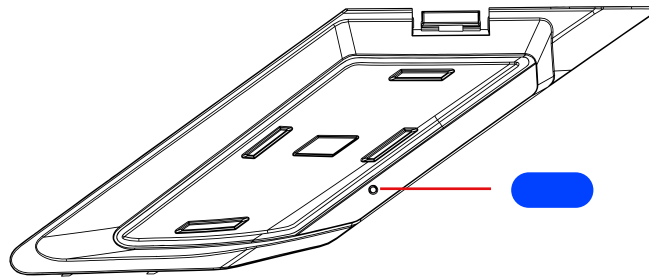

*Your Shockwave will automatically connect to a previously connected device (within range) when powered on.

If the unit is already on, pressing the SELECT/PHONE BUTTON [C**] for 5 seconds will put the unit into pairing mode.

AUDIO CONTROL

- When connected, to start/play a track press the **MEDIA BUTTON** once. (your music app must be open)

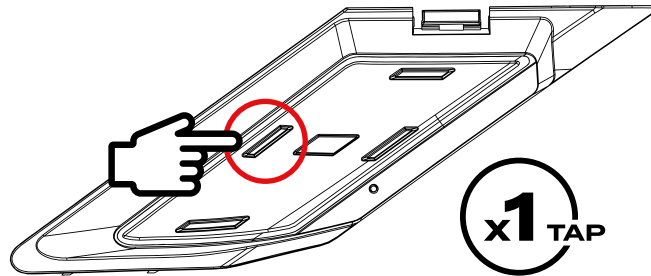

- To skip track forward, press the **MEDIA BUTTON** once.

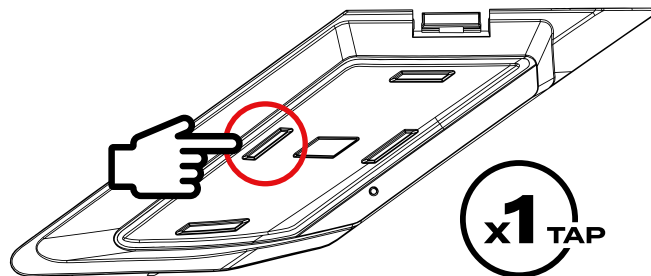

- To skip track backwards, press the **INTERCOM BUTTON** once.

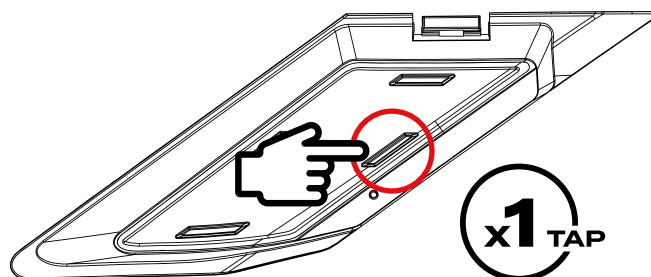

- To turn the volume up, press or hold the **VOLUME UP BUTTON**.

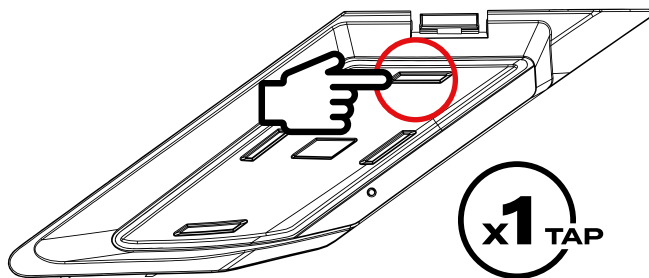

- To turn the volume down, press or hold the **VOLUME DOWN BUTTON**.

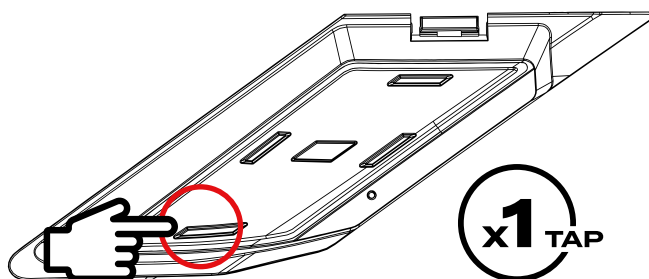

- To pause/stop music, press the **SELECT/PHONE BUTTON** once.

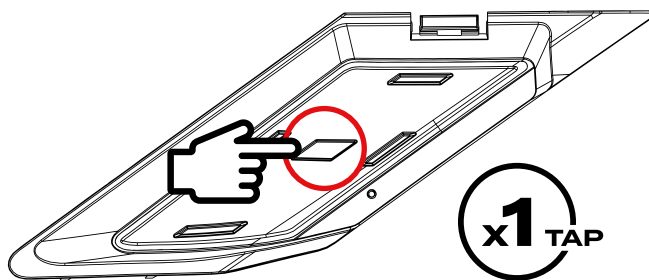

- To resume music, press the **MEDIA BUTTON** once.

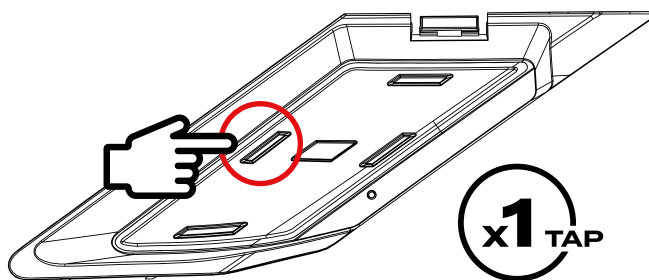

INTERCOM RIDER-PILLION

- When connecting two Shockwave units for the first time, put both units into Bluetooth® pairing mode by holding the **INTERCOM BUTTON** for **5 seconds**.

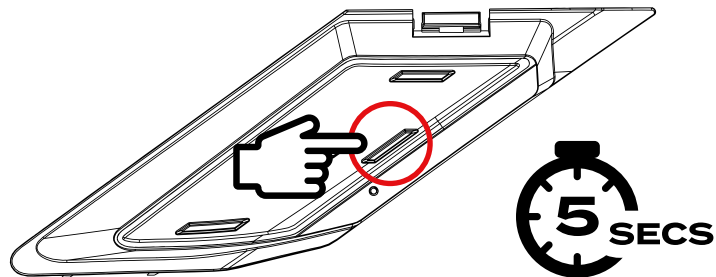

- Once in pairing mode, the **LED** will flash periodically between Red & Blue to show that it is in pairing mode and you will hear the message 'Pairing State'.

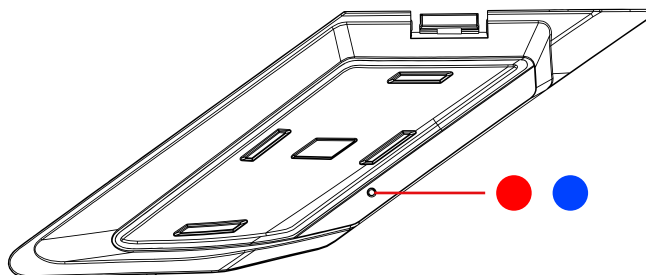

- Then hold down the **INTERCOM BUTTON** for **2 seconds** to open a channel, you will hear a tone through both Shockwave units to indicate a successful connection.

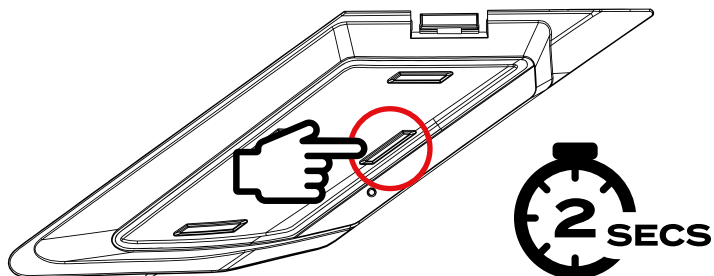

- Successful connection will cause the **LED** to flash **BLUE** periodically on both SHOCKWAVE units to indicate a successful connection.

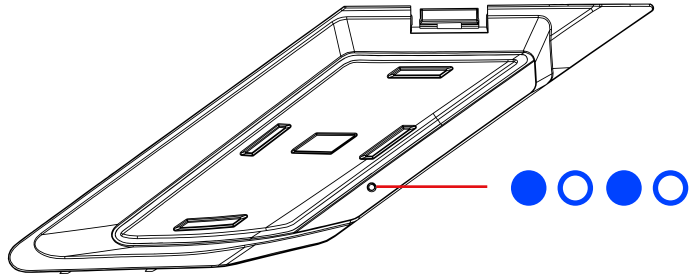

- Once in pairing mode the **LED** will flash periodically between Red & Blue to show that it is in pairing mode and you will hear the message 'Pairing State'.

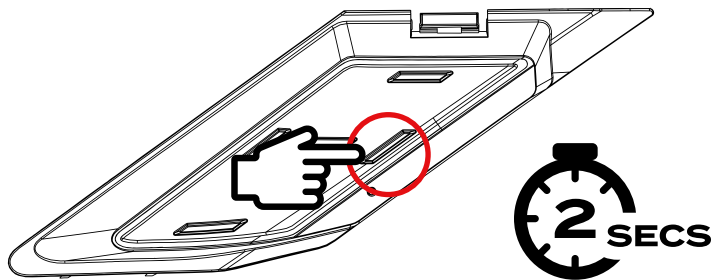

MAKE/RECEIVE CALLS

If the Shockwave is connected to a phone and a number is dialled, it will automatically direct the call through the speakers and activate the microphone.

When the connected phone has a call incoming the Shockwave will cut any music/intercom audio and the call will ring through the speakers.

- To answer an incoming call, press either the **INTERCOM BUTTON**, **MEDIA BUTTON** or **SELECT/PHONE BUTTON** once.

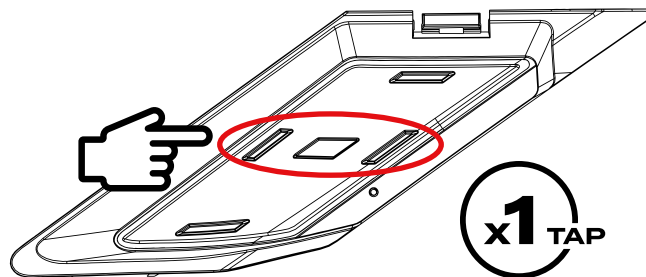

ANY OF THE ABOVE 3 BUTTONS

- To reject an incoming call, press either the **VOLUME UP BUTTON** or **VOLUME DOWN BUTTON** once.

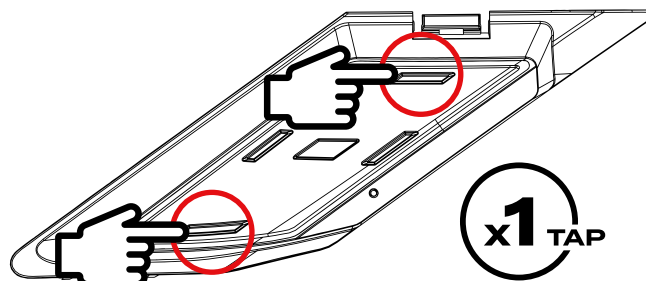

EITHER OF THE ABOVE 2 BUTTONS

- To cancel or end the call, press either the **SELECT/PHONE BUTTON** or **INTERCOM BUTTON** or **MEDIA BUTTON** once.

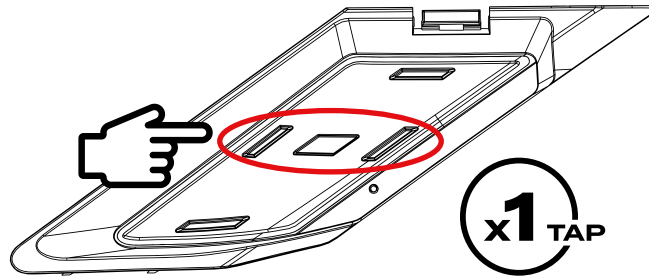

ANY OF THE ABOVE 3 BUTTONS

- To call the last dialled number, press the **SELECT/PHONE BUTTON** X2 times.

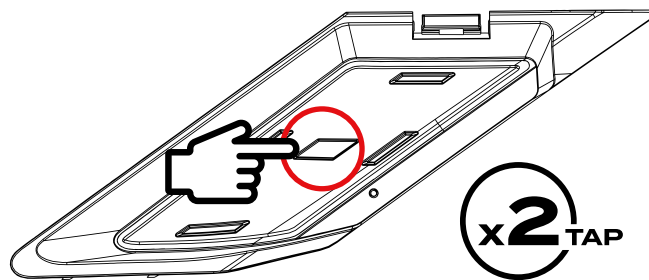

VOICE ASSISTANT

To activate your phones voice assistance features, simply hold the **SELECT/PHONE BUTTON** for **2 seconds**.

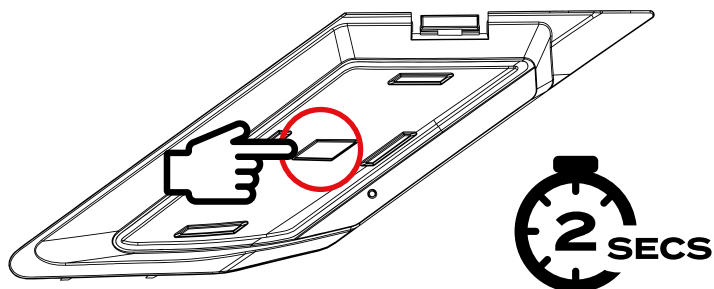

FCC REGULATORY COMPLIANCE

This device complies with part 15 of the FCC Rules. Operation is subject to the following two conditions:

- This device may not cause harmful interference, and (2) this device must accept any interference received, including interference that may cause undesired operation.
- Any change or modifications not expressly approved by the party responsible for compliance could void the user's authority to operate the equipment.
- The transmitter must not be co-located or operating in conjunction with any other antenna or transmitter.
- This equipment complies with RF radiation exposure limits set forth for an uncontrolled environment.
- This device has been evaluated to meet general RF exposure requirements. The device can be used in portable exposure conditions without restriction.

This equipment has been tested and found to comply with the limits for a Class B digital device, pursuant to Part 15 of the FCC Rules.

These limits are designed to provide reasonable protection against harmful interference in a residential installation.

This equipment generates, uses and can radiate radio frequency energy and, if not installed and used in accordance with the instructions, may cause harmful interference to radio communications. However, there is no guarantee that interference will not occur in a particular installation.

If this equipment does cause harmful interference to radio or television reception, which can be determined by turning the equipment off and on, the user is encouraged to try to correct the interference by one or more of the following measures:

- Reorient or relocate the receiving antenna.
- Increase the separation between the equipment and receiver.
- Connect the equipment into an outlet on a circuit different from that to which the receiver is connected.
- Consult the dealer or an experienced radio/TV technician for help.

FCC ID: 2AZ5F-SW-BT

COMPLIANCE CE

This device complies with RF specifications when the device is used in typical operation.

Hereby Ruroc Ltd declares that this product is in compliance with essential requirements and other relevant provisions of Directive 2014/53/EU.

This device can be operated in all EU member states.

For further information, please visit <https://support.ruroc.com/>

ISED COMPLIANCE STATEMENT

This device contains licence-exempt transmitter(s)/receiver(s) that comply with Innovation, Science and Economic Development Canada's licence-exempt RSS(s). Operation is subject to the following two conditions:

- This device may not cause interference.
- This device must accept any interference, including interference that may cause undesired operation of the device.

L'émetteur/récepteur exempt de licence contenu dans le présent appareil est conforme aux CNR d'Innovation, Sciences et Développement économique Canada applicables aux appareils radio exempts de licence. L'exploitation est autorisée aux deux conditions suivantes:

- L'appareil ne doit pas produire de brouillage.
- L'appareil doit accepter tout brouillage radioélectrique subi, même si le brouillage est susceptible d'en compromettre le fonctionnement.

This equipment complies with IC RSS-102 radiation exposure limits set forth for an uncontrolled environment. This transmitter must not be co-located or operating in conjunction with any other antenna or transmitter.

Cet équipement est conforme aux limites d'exposition aux radiations IC CNR-102 établies pour un environnement non contrôlé. Cet émetteur ne doit pas être colocalisé ou fonctionner en conjonction avec une autre antenne ou un autre émetteur.

ATTENTION

1. Installing equipment on the helmet is a modification of the helmet, which may cause the helmet's warranty to fail or hinder the helmet's function. This may cause danger in the event of accidents.
2. Before using the Shockwave Bluetooth system, please ensure that the product is firmly and correctly installed in the helmet. If the product falls off during riding, it may cause injury or accident.
3. To ensure riding safety, please use this product carefully to avoid injury, serious harm or death.
4. In order to maximise the communication distance, aim to use the system in an open space with a clear line of sight.
5. In the case of rain, please keep the USB rubber plug tightly installed during use to prevent water from entering the device.
6. The device contains a 3.8V/650mAh LiPoly (Lithium Polymer) battery that will change with temperature. When the battery is used at a low ambient temperature (0°C), the battery life of the product may be temporarily reduced, with a risk of permanent damage.
7. If the electronic functions fail, please power off the device and try again.

SPECIFICATION

BLUETOOTH® VERSION:
DUAL-MODE BT 5.3 WITH LE AUDIO

SUPPORT:
STAR-MC1 PROCESSOR, BECO
COPROCESSOR

ELECTRIC PARAMETER:
DC 5V/1A

AUDIO ENCODING FORMAT:
SBC, (4) AAC (MPEG-2)

**RIDER-PILLION INTERCOM
COMMUNICATION DISTANCE:**
UP TO 100 METERS

**BLUETOOTH® HEADSET COMMUNICATION
DISTANCE:**
UP TO 10 METERS

CHARGING INTERFACE:
USB TYPE-C

PERMISSIBLE OPERATING TEMPERATURE:
-20~+45°C / -4~+113°F

**RECOMMENDED STORAGE
TEMPERATURE:**
-5~+30°C / 23~+86°F

WATERPROOF RATING: IP64