

H7101说明书

版本:1.0

日期:2021/11/25

折叠尺寸:145×210(mm)

展开尺寸:290X210(mm)

材质:80G书页纸

工艺:单色

折叠方式:骑马钉

页数:32 页





Model: H7101

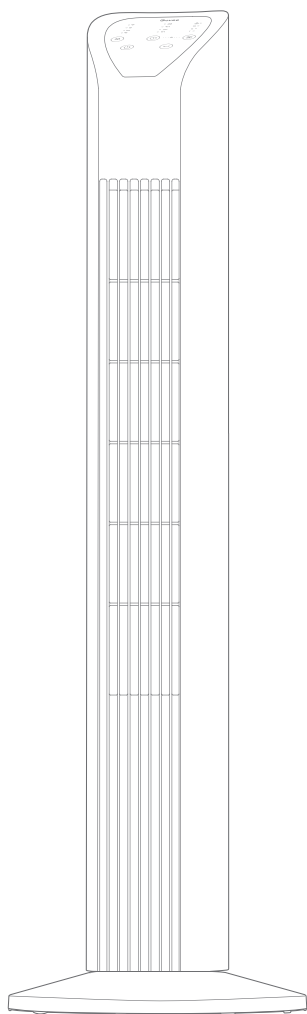

# User Manual

Govee Smart Tower Fan



# Contents

## Safety Instructions

01

General Safety

Power Cord & Plug

Risk of Electric Shock & Leakage

## Included in the Box

02

## Introduction

03

Part Names

Controls

Indicator Status

Functions

## Getting Started

06

## Govee Home App

07

Downloading Govee Home App

Pairing with Govee Home App

## Care & Maintenance

08

Cleaning

Maintenance

## Troubleshooting

09

For Govee Smart Tower Fan

For App & Connectivity

## Appendix

11

After-Sales Service

Specifications

Compliance Information

# READ AND SAVE THESE INSTRUCTIONS

## Safety Instructions

### General Safety

- Only use the fan as described in this manual.
- To reduce the risk of fire or electric shock, do not use this fan with any solid-state speed control device.
- Do not operate this fan if it has been damaged.
- Supervision is required during the installation, operation, cleaning, and maintenance of this fan by children under age 12 or anyone with reduced physical, sensory, or mental capabilities. Children should be supervised to ensure that they do not play with the fan, its parts and packaging material.
- Do not insert fingers or foreign objects in any opening of the fan and do not obstruct the air vents.
- Do not place this fan near any fabric such as curtains, and tablecloths as they might be sucked into the fan and damage the motor and/or cause a fire.
- Do not place any part of this fan (the whole machine, power cord, plug, packaging, etc) near high-temperature heat resources such as hearth, fireplaces, and stoves.
- Do not use this fan on windows, uneven or unstable surfaces, or near water.
- Do not immerse the fan in water and never allow water to drip into the motor housing.
- Unplug this fan from power if it is being moved, repaired, cleaned, used during a thunderstorm, left unattended for a long time or not in use.
- Do not use gasoline, paint thinner or other chemicals to clean the fan.

**CAUTION:** This product employs overload protection (fuse). A blown fuse indicates an overload or short-circuit situation. If the fuse blows, unplug the fan from the outlet. Replace the fuse as per the user servicing instructions (follow product marking for proper fuse rating) and check the fan. If the replacement fuse blows, a short-circuit may be present and the fan should be discarded or returned to an authorized service facility for examination and/or repair.

### Power Cord & Plug

- This fan has a polarized plug (one blade is wider than the other). To reduce the risk of electric shock, this plug is intended to fit in a polarized outlet only one way. If the plug does not fit fully in the outlet, reverse the plug. If it still does not fit, contact a qualified electrician. Do not attempt to defeat this safety feature.
- Never use the cord as a handle or otherwise yank, strain or stretch the power cord.
- Place the fan near the plug so that it can be unplugged immediately from the power if an emergency occurs.

- Do not operate this fan with a damaged cord or plug.
- Do not run cord under carpeting. Do not cover cord with throw rugs, runners, or similar coverings. Do not route cord under furniture or appliances. Arrange cord away from traffic area and where it will not be tripped over.
- If the power cord or the plug is damaged, please contact customer service for repair or similar professionals to avoid danger.

## Risk of Electric Shock & Leakage

- Ensure that all parts of the whole machine have been installed before using, including the front guard, fan blades, and the rear guard.
- Do not insert any foreign objects in the air inlet or outlet when the fan is powered on, as this may damage the fan itself, cause electric shock or fire.
- If any part of the fan is damaged in operation, contact customer service or professionals for repair or replacement. Do not risk repairing or replacing by yourself.

**WARNING:** To reduce the risk of electric shock, do not expose the fan to water or rain.

## Included in the Box

Item	Quantity
Tower Fan	1
Base Plates	2
Screw Nut	1 (pre-installed)
User Manual	1
Quick Start Guide	1

# Introduction

Govee Smart Tower Fan circulates cool air or warmth from your floor to the whole room, meeting all your needs with variable speed control.

## Part Names

- a. Control Panel
- b. Air Outlet
- c. Front Base Plate
- d. Rear Base Plate
- e. Power Cord
- f. Power Plug
- g. Screw Nut
- h. Built-in Handle
- i. Air Inlet
- j. Wind Wheel

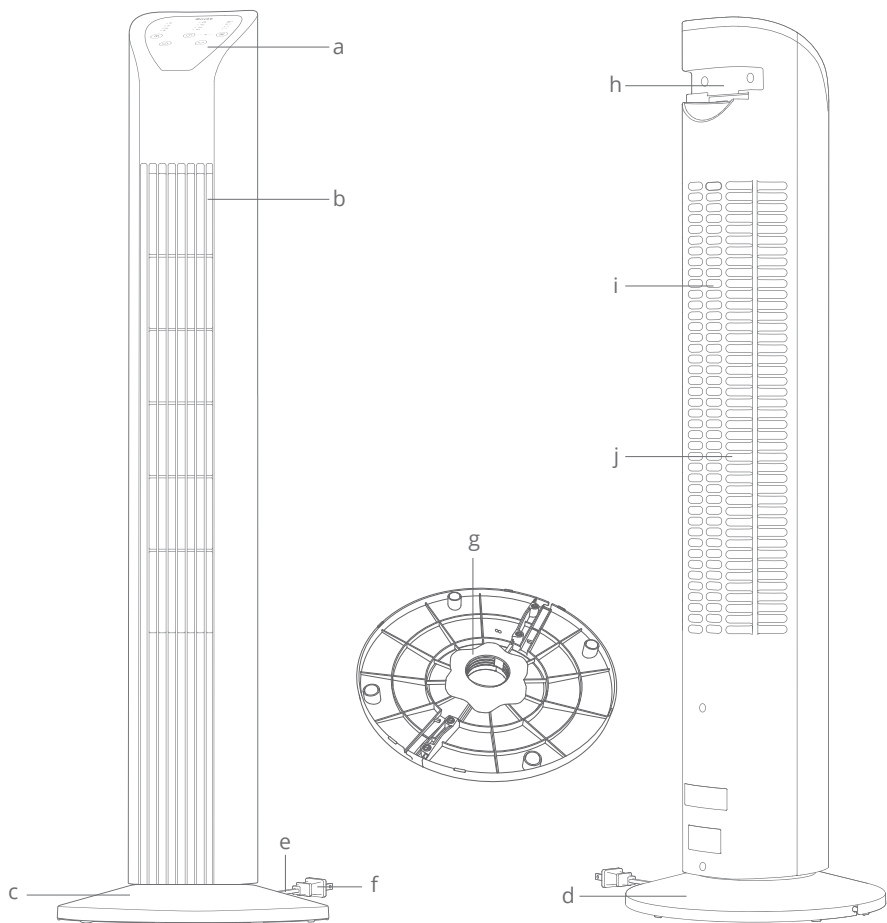

## Controls



### Power Button

Touch to power on or off.

**Note:** Press and hold the Power Button and Speed Button for 10 seconds to restore the fan to factory settings and disconnect it from Wi-Fi and Bluetooth.



### Oscillation Button

Touch to start or stop the oscillation.



### Mode Button

Touch to cycle through Normal Mode, Nature Mode, and Sleep Mode.

**Normal Mode:** Always operates at the current speed.

**Nature Mode:** Simulates a gentle breeze, making you feel like you're in nature.

**Sleep Mode:** Decreases the speed progressively until it reaches the lowest speed, continuously running to lull you to sleep.



### Timer Button

Touch to set a timer.



### Speed Button

Touch to cycle through High Speed III, Medium Speed II, and Low Speed I.

**Note:** Press and hold the Timer Button and Speed Button for 3 seconds to turn the Safety Lock on or off.



# Indicator Status

Indicator	Working Status	Light Status
I	Low Speed	Solid White
II	Medium Speed	Solid White
III	High Speed	Solid White
	Safety Lock is ON	Solid White / Flash
1H 2H 4H	Touch to Set a Timer	Solid White
	Set a Timer via the App	Solid White
	Normal Mode	Solid White
	Nature Mode	Solid White
	Sleep Mode	Solid White
	Connected	Solid White
	Connecting	Quickly Flashes White

## Functions

### Memory Function

The fan will remember its previous settings when powered off. The settings will become active again when the fan is turned back on.

### Safety Lock

Press and hold the Timer Button and Speed Button to turn the safety lock on or off.

# Getting Started

Do not plug your fan into power before finishing the following steps:

1. Place the fan body on a dry, level surface.
2. Assemble the front base plate and the rear base plate together as a whole.
3. Pass the power cord through the hole of the base plate, and fasten the base plate with the fan body.

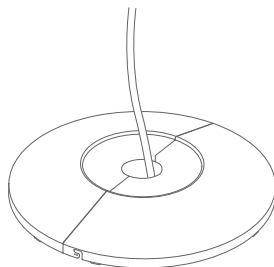
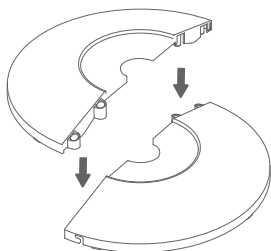

4. Pass the power cord through the hole of the screw nut and tighten the screw with the base plate.

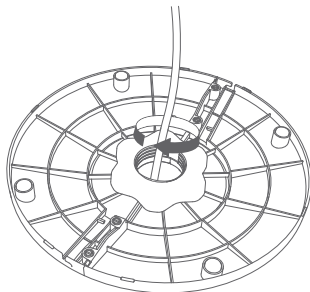

5. Fix the power cord into the buckle of the base plate and place the fan properly on a level surface.

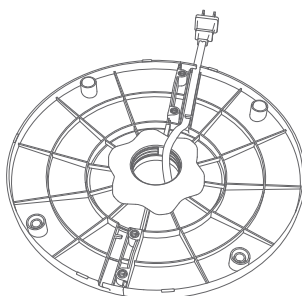

# Govee Home App

You can access more features using Govee Home App.

## Downloading Govee Home App

To download Govee Home App, scan the QR code or search for “Govee” in the Apple App Store® (iOS) or Google Play Store (Android).



Govee Home App



### Note:

- Choose “Allow” to the permissions requested when opening Govee Home App for the first time. These permissions allow the app’s features to function normally and are not used to record personal, private information.
- Due to ongoing updates, Govee Home App may be slightly different than shown in this manual. In case of any differences, always follow the in-app instructions.

## Pairing with Govee Home App

1. Turn on your smartphone’s Bluetooth.
2. Open Govee Home App, tap the “+” icon in the top right corner and search for “H7101.”
3. Tap the device icon and follow the on-screen instructions to complete pairing.

### Note:

- You can use Govee Home App to connect your tower fan to Amazon Alexa or Google Assistant. Follow the in-app instructions to connect to each voice assistant.
- Govee Home App is being continually updated and its features do expand.

# User Servicing Instruction

## Cleaning

To achieve the best performance, clean the fan at least once during the operating season or before storing it when it will not be used for a long period of time.

- Turn the fan off and unplug it from power, then use a soft damp cloth to clean its body, air inlet, and outlet.
- Do not immerse the fan in water and never allow water to drip into the motor housing.
- Do not risk your safety to detach the fan to clean its blade, otherwise this way damage the fan or shorten its lifespan.

## Maintenance

- Fuse replacement

**Note:** The product requires a 2.5 A, 125 V fuse.

1. Grasp the plug and remove from the socket or other outlet device. Do not unplug by pulling the cord.
2. Slide to open the fuse cover on top of the plug towards blades.
3. Remove the fuse carefully by using a small screwdriver to pry it out of the compartment by its metal ends.
4. Replace only with 2.5 A, 125 V fuse to avoid the risk of fire.
5. Close fuse cover. Slide closed the fuse access cover on top of attachment plug.
6. Risk of fire. Do not replace attachment plug. Contains a safety device (fuse) that should not be removed. Discard product if the attachment plug is damaged.

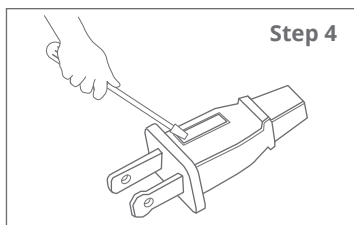
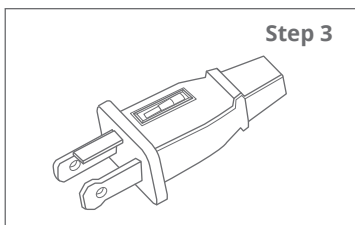
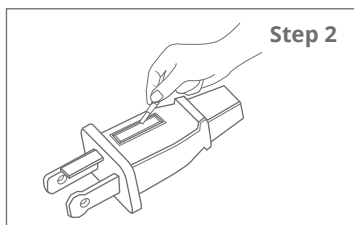
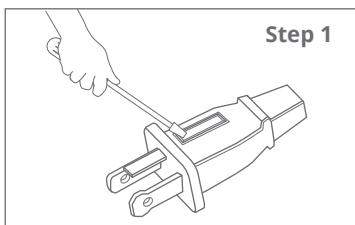

- The fan blade cannot be detached. Do not forcibly pry open the part used to fix the blade, otherwise it cannot be restored.
- The motor is permanently lubricated and requires no oiling.
- Any other servicing not mentioned in this manual should be performed by a professional repair center.

# Troubleshooting

The troubleshooting section below is for solving frequently asked questions. If your problem persists, please contact customer support.

## For Govee Smart Tower Fan

Problem	Possible Solution
The fan cannot be turned on or respond to any button touch.	The fan is not plugged in. Plug it into an outlet.
	Check to see if the power cord is damaged. If so, stop using the fan and contact customer support.
	Plug the fan into a different outlet.
	The fan may be malfunctioning. Contact customer support.
Airflow is weak or slow.	The fan is running at Low Speed. Adjust to a higher speed.
	The air inlet is blocked. Remove the obstruction.
The fan makes strange noises when it is running.	Move the fan to a level surface.
	Contact customer support.
The fan shakes severely.	Refasten the base plate with the fan body and tighten the screw nut.

## For App & Connectivity

1. Cannot connect to Govee Home App.
- Make sure your smartphone is powered on and is not connected with other Bluetooth devices.
  - Enable the smartphone's Location Services.
  - Try connecting with another smartphone.
  - Make sure your app is updated to the latest version.
  - Make sure you connect to your Wi-Fi router's 2.4GHz network and that the network is working correctly.
  - Make sure the Wi-Fi password you entered is correct.
  - Shorten the distance between the fan, Wi-Fi router, and the smartphone.
  - Make sure your fan and the Wi-Fi router are located away from appliances that produce electromagnetic radiation (e.g. microwave ovens, refrigerators, etc.)
  - If you are using a VPN, try turning it off and then connecting the fan.
  - Disable portal authentication for your Wi-Fi network. If portal authentication is enabled, this fan will not be able to access your Wi-Fi network and setup will fail. Portal authentication means that you need to sign in to your Wi-Fi network through a web page before you can use the Internet.

2. Cannot find the device on Bluetooth Device Nearby page of the app.

- The fan may be connected with another smartphone. Disconnect it from the other smartphone first.

3. The fan is offline.

- Make sure the fan is plugged in and powered on, then refresh "My Devices" in Govee Home App by swiping down on the screen.
- Make sure your router is connected to the internet remove and your phone's network connection is working.
- If the Wi-Fi password has been changed, the fan will automatically go offline. Try connecting it to the network again.
- Delete the offline fan from Govee Home App, then add and reconfigure the fan again in the app.

# Appendix

## Specifications

Model Name	H7101
Power Voltage	120V ~, 60Hz
Rated Power	37W
Net Weight	2.3kg/5.07lb
Dimensions	270*270*973mm/10.6*10.6*36inch

## Compliance Information

### FCC Statement

This device complies with Part 15 of the FCC Rules. Operation is subject to the following two conditions: (1) this device may not cause harmful interference, and (2) this device must accept any interference received, including interference that may cause undesired operation. **Warning:** Any changes or modifications not expressly approved by the party responsible for compliance could void the user's authority to operate the equipment.

**Note:** This equipment has been tested and found to comply with the limits for a Class B digital device, pursuant to Part 15 of the FCC Rules. These limits are designed to provide reasonable protection against harmful interference in a residential installation.

This equipment generates uses and can radiate radio frequency energy and, if not installed and used in accordance with the instructions, may cause harmful interference to radio communications. However, there is no guarantee that interference will not occur in a particular installation. If this equipment does cause harmful interference to radio or television reception, which can be determined by turning the equipment off and on, the user is encouraged to try to correct the interference by one or more of the following measures:

- (1)Reorient or relocate the receiving antenna.
- (2)Increase the separation between the equipment and receiver.
- (3)Connect the equipment into an outlet on a circuit different from that to which the receiver is connected.
- (4)Consult the dealer or an experienced radio/TV technician for help.

### FCC Radio Frequency Exposure Statement

The device has been evaluated to meet general RF exposure requirements. The device can be used in fixed/mobile exposure condition. The min separation distance is 20cm.

FCC ID:2AQA6-H7101

The following importer is the responsible party

Name: GOVEE MOMENTS (US) TRADING LIMITED

Address: 13013 WESTERN AVE STE 5 BLUE ISLAND IL 60406-2448

Email: support@govee.com

Contact information: <https://www.govee.com/support>

## IC Statement

This device complies with Industry Canada licence-exempt RSS standard(s). Operation is subject to the following two conditions:

(1) this device may not cause interference, and

(2) this device must accept any interference, including interference that may cause undesired operation of the device.

Le présent appareil est conforme aux CNR d'Industrie Canada applicables aux appareils radio exempts de licence. L'exploitation est autorisée aux deux conditions suivantes:

(1) l'appareil nedit pas produire de brouillage, et

(2) l'utilisateur de l'appareil doit accepter tout brouillage radioélectrique subi, même si le brouillage est susceptible d'en compromettre le fonctionnement.

This Class B digital apparatus complies with Canadian ICES-003.

Cet appareil numérique de la classe B est conforme à la norme NMB-003 du Canada.

### IC RF Statement:

When using the product, maintain a distance of 20cm from the body to ensure compliance with RF exposure requirements.

Lors de l'utilisation du produit, maintenez une distance de 20 cm du corps afin de vous conformer aux exigences en matière d'exposition RF.

The Bluetooth® word mark and logos are registered trademarks owned by Bluetooth SIG, Inc. and any use of such marks by Shenzhen Intellirocks Tech. Co., Ltd. is under license.

## After-Sales Service

 Warranty: 12-Month Limited Warranty

 Support: Lifetime Technical Support

 Email: support@govee.com

 Official Website: [www.govee.com](http://www.govee.com)

 @Govee  @goveeofficial  @govee.official

 @Goveeofficial  @GoveeOfficial





Govee Home App

For FAQs and more information,  
please visit: [www.govee.com](http://www.govee.com)