

# Quick Start Guide

---

Model : MSB400-A-G1

# What's in the box?



OTT



Remote Control / Batteries



AC Adaptor

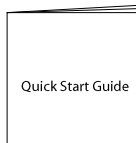

Quick start Guid

**Note: Accessories may vary according to area.**

# Getting to Know Your OTT



1. USB Port: Connect your USB storage device.
2. Status: Light is emitted when your box is in the operation mode.
3. HDMI: Use an HDMI cable to connect to your TV.
4. ETHERNET: Use an Ethernet cable to connect to a wired network. You can also use a wireless network.
5. SPDIF: Use an SPDIF cable to connect to the audio system.
6. DC IN: Use an AC adaptor to connect to the power source.

# Getting to Know Your Remote Control

1. Power: Powers on or off
2. Arrow: Moves the cursor up, down, left or right
3. Menu: Displays the main menu
4. Home: Returns to the home screen
5. Setting: Goes to system setting page
6. Mute
7. OK: Selects a menu or confirms the option
8. Back: Returns to the previous screen
9. Volume: Changes the audio volume

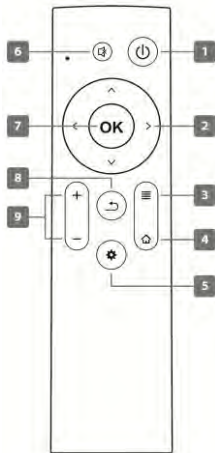

# Connecting Your OTT

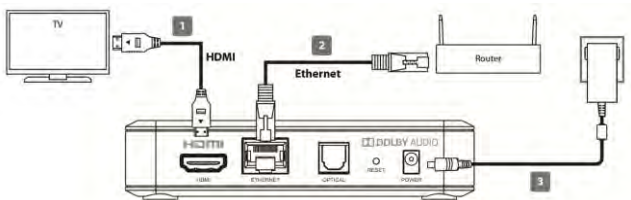

1. Connecting to your TV  
Use an HDMI cable (not supplied) to connect to your TV.
2. Connecting to Internet
  - a. Use an Ethernet cable (not supplied) to connect to your router.
  - b. Or can connect via Wireless network.
3. Powering On  
Use an AC adaptor to DC IN of your OTT, and then plug it into a wall outlet.

# Setting Up Your OTT

When you power on your H3 for the first time, follow the instructions to set it up.

1. Language

Select your language.

2. Network Connection

Your OTT will automatically detect your wired network connection. If your OTT fails to connect to the network, follow the on-screen instructions to set up the wireless network.

Select your network from the network list and enter your network password. Network passwords are case sensitive.

3. Time Zone

Select your region.

4. Result

You have finished the setup.

**Note: The apps and Live TV channel list are subject to change without notice.**

# How to pair the OTT with BT remote

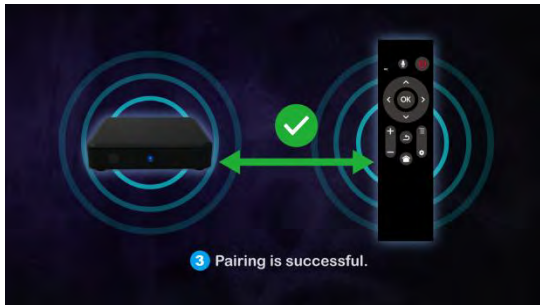

# Troubleshooting

Before contacting your local service center, read the tips below carefully. If the problem persists after completing the following procedure, contact your local product distributor or service center for further instructions.

## Power

OTT does not power on.

- Check the AC power adaptor and make sure it is plugged in to a wall outlet.
- Check your batteries in your remote control.

## Picture

No or poor picture

- Make sure your OTT is powered on and in operation mode.
- Make sure an HDMI cable is firmly connected to the TV.
- Check the brightness level of the TV.

## Sound

No or poor sound

- Check an HDMI cable or S/PDIF cable is connected correctly.
- Check the volume levels of your TV.
- If your OTT is connected to the digital audio device with an SPDIF cable, check the digital audio device is turned on.



## Remote Control

Remote control does not work.

- Check new batteries are properly inserted in the remote control.
- Remove and reinsert the batteries in the remote control.

## Network

Wired network is not connected.

- Check the Ethernet cable is connected to your OTT.
- Check the network settings are properly set up.

Wireless network is not connected.

- Check the correct wireless network is selected.
- To set up the wireless network, go to HOME > Settings > Network > Wireless LAN.

Select the wireless network and enter the PIN code. If your wireless network is not listed, select Add Network.

# Specification

- Power Type: External Adaptor
- Input Voltage: 100V – 240V ~ 0.5A, 50/60Hz
- Power Consumption: 5V/2A
- Protection: Separate Internal Fuse & Lightning protection
- Size (WxDxH): 115 x 110x 27(mm)
- Weight: 203g

# Safety Instructions

Read the safety instructions before using your product to avoid electrical shock or personal injury.

- Do not bend or twist the power cord to avoid damage of the power cord.
- Do not touch the power plug with wet hands to avoid electrical shock.
- Do not install near any heat sources such as radiators, hot registers, stoves or other apparatus that produce heat.
- Do not place naked flame sources, such as lighted candles, on or near the apparatus.
- Use only the cables provided with your product.
- Do not attempt to repair or disassemble your product yourself, as this will void the warranty.
- Before removing your product from your TV, unplug the power source and let it cool as it may get hot to touch.

## Trademarks

- Manufactured under license from Dolby Laboratories. Dolby, Dolby Audio, and the double-D symbol are trademarks of Dolby Laboratories.
- HDMI, the HDMI Logo, and High-Definition Multimedia interface are trademarks and registered trademarks of HDMI Licensing LLC.

## FCC CUSTOMER INFORMATION

This device complies with Part 15 of the FCC Rules. Operation is subject to the following two conditions:

- (1) this device may not cause harmful interference, and
- (2) this device must accept any interference received, including interference that may cause undesired operations.

### FCC RF Radiation Exposure Statement

This equipment complies with FCC RF radiation exposure limits set forth for an uncontrolled environment.

### WARNING

Any changes or modifications not expressly approved by the manufacturer could void the user's authority to operate the equipment. This device and its antenna must not be co-located or operating in conjunction with any other antenna or transmitter.

This equipment should be installed and operated with a minimum distance of 20 centimeters (equal to 8 inches) between the radiator and your body.

# Warranty Certificate

## IMPORTANT:

Keep this Certificate together with the Original invoice or receipt in a safe place and show them to the retailer or place of purchase whenever a warranty repair is necessary.

- Model No.: \_\_\_\_\_
- Serial No.: \_\_\_\_\_
- Date of Purchase: \_\_\_\_\_
- Dealer's Signature: \_\_\_\_\_
- Customer's Signature: \_\_\_\_\_

## Federal Communication Commission Interference Statement

This equipment has been tested and found to comply with the limits for a Class B digital device, pursuant to Part 15 of the FCC Rules. These limits are designed to provide reasonable protection against harmful interference in a residential installation. This equipment generates, uses and can radiate radio frequency energy and, if not installed and used in accordance with the instructions, may cause harmful interference to radio communications. However, there is no guarantee that interference will not occur in a particular installation. If this equipment does cause harmful interference to radio or television reception, which can be determined by turning the equipment off and on, the user is encouraged to try to correct the interference by one of the following measures:

- Reorient or relocate the receiving antenna.
- Increase the separation between the equipment and receiver.
- Connect the equipment into an outlet on a circuit different from that to which the receiver is connected.
- Consult the dealer or an experienced radio/TV technician for help.

This device is restricted for indoor use.