

## Parts list

- 1- card reader ( 30cm cable)
- 2- back plate
- 3- wallboardscrew

## Recommend

- 1-10 -core screened cable (Wiegandsignal cable, shielded wire),22 24AWG
- 2- DC 12V power supply
- 3- Metal or plastic 86 junction box (Propose to place magnetic fabric with same size underneath of the reader if installing with a metal junction box)

## Installation schematic

First floor is fixed on 86 junction box, as shown in Figure 1.

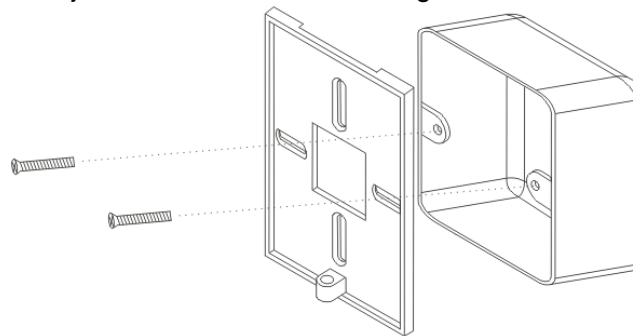

Figure 1

## Wiring

In accordance with the card reader terminal definition, communication lines and junction box for the card reader connects communication lines.

Connection definitions:

Line color	Description
Red	+12V
Black	GND
Green	Wieganddata 0
White	Wieganddata 1
Yellow	Buzzer entry
Brown	Green (GRN) LED input
Purple	Red (RED) LED input
Blue	Tamper output
Orange	Do not use
Metal	Shielding

## Install the reader to the back plate

Put the reader onto the back plate and fasten the screws at the bottom, as shown in Figure 2.

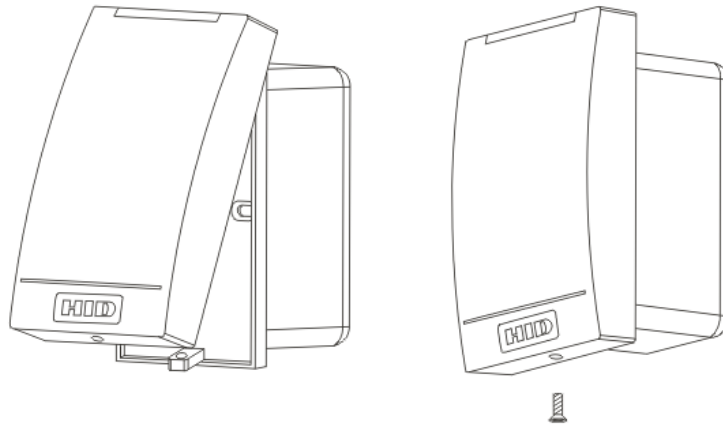
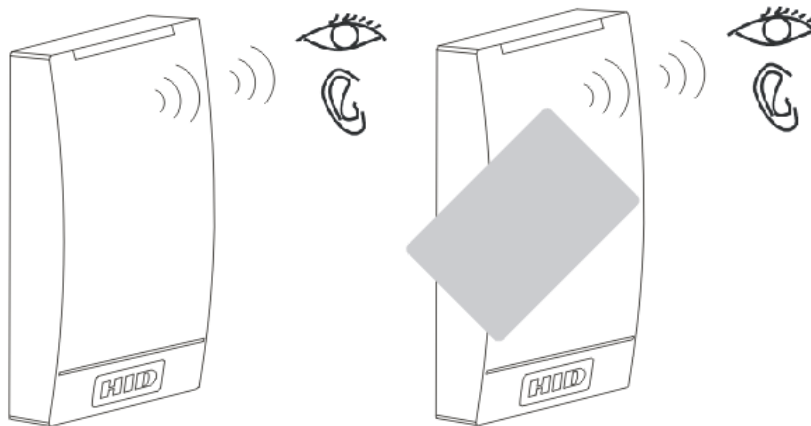

Figure 2

### Power and test

Connect the communication cable from the junction box to the controller, the reader will blink and tweet when the power is on. After startup is complete, LED lights will be kept on, and buzzer will have stopped. At this point, can put the IC card onto the front of the reader and test the swiped, as shown in Figure 3.



## **FCC Caution.**

### **§ 15.19 Labelling requirements.**

This device complies with part 15 of the FCC Rules. Operation is subject to the following two conditions: (1) This device may not cause harmful interference, and (2) this device must accept any interference received, including interference that may cause undesired operation.

### **§ 15.21 Information to user.**

Any Changes or modifications not expressly approved by the party responsible for compliance could void the user's authority to operate the equipment.