

XR-2 User Instruction

使用说明书

01 Product Overview (产品概述)

Introduction (简介)

The CHIGEE XR-2 Motorcycle Smart Riding System is equipped with front and rear 1080P dual cameras. The main unit features a high-brightness 1400nit 4.3-inch IPS 800*480 HD touchscreen, providing smooth wireless screen mirroring, online navigation, BSD blind spot monitoring, and other functions relying on powerful main control processing power. The main unit also has 5G Wi-Fi and 5Hz high-precision satellite positioning capabilities. The XR-2 main unit supports IP68 dust and water resistance, easily coping with harsh environments. Additionally, it can be equipped with a variety of optional accessories to expand personalized usage needs.

CHIGEE XR-2 摩托车智能骑行系统。配备前后 1080P 双摄像头，主机搭载 1400nit 亮 4.3 寸 IPS 800*480 高清触摸屏，依靠强劲主算力提供流畅的手机无线投屏、在线导航、BSD 盲区监测等功能。主机具备 5G Wi-Fi、5Hz 高精度卫星定位功能。XR-2 主机支持 IP68 级防尘防水，轻松应对严苛环境。此外可搭配丰富选装件，拓展个性化使用需求。

Body and Accessories (主体与配件)

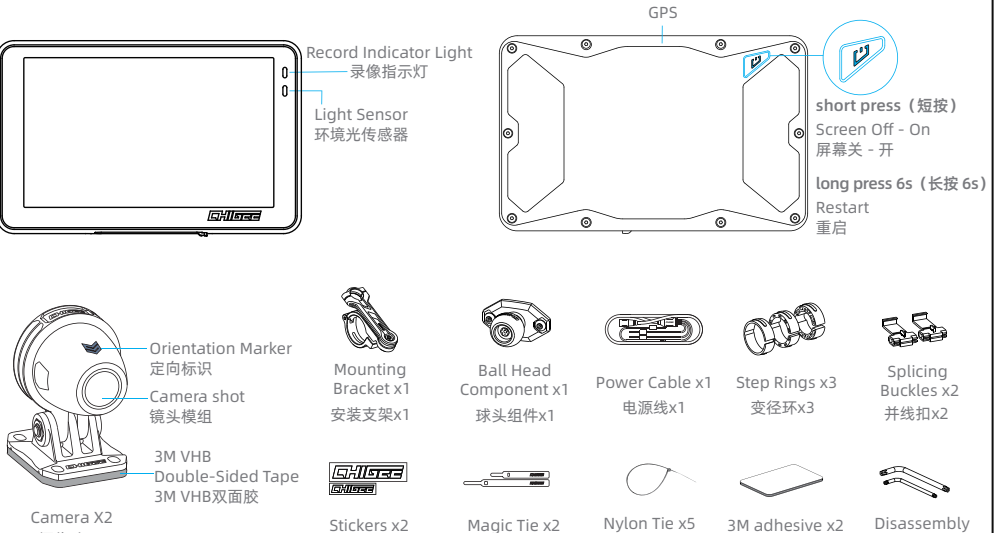

02 Installation Guide (安装指南)

SD Card Installation (SD卡安装)

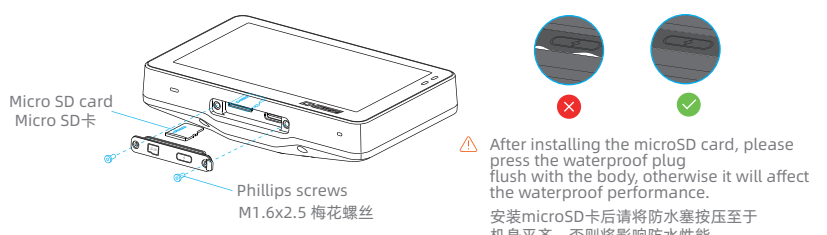

Please use a microSD card with a U3 rating for transmission speed to ensure stable videorecording, otherwise there may be risks of video stuttering and loss. (SD card needs to be purchased separately)
请使用传输速度达到U3级别的microSD卡以保证录像稳定性,否则可能存在录像卡顿、丢失风险。(SD卡需自行购买)

Image Storage (影像存储逻辑)

The XR-2 comes with an internal 32GB storage space (approximately 29GB available) that can store photos and videos directly. When a microSD card is inserted, photos and videos will be stored on the microSD card. XR-2 机身内置 32GB 存储空间 (实际可用约 29GB), 可直接存储拍摄影像。插入 microSD 卡后, 拍摄影像将存储至 microSD 卡。

Collision Lock Files will not be overwritten in a loop. Please follow the host's prompts to delete the lock files, or format the storage space.
碰撞锁定文件将无法被循环覆盖, 请按照主机提示删除锁定文件, 或格式化存储空间。

Regularly format the SD card to keep it in good condition.
定期格式化 SD 卡, 让其保持良好状况。
This will erase all media files:
这将删除所有媒体文件:
① Enter Settings (进入设置)
② Click "Storage" - "Format" (点击 "存储" - "格式化")

Camera Installation (摄像头安装)

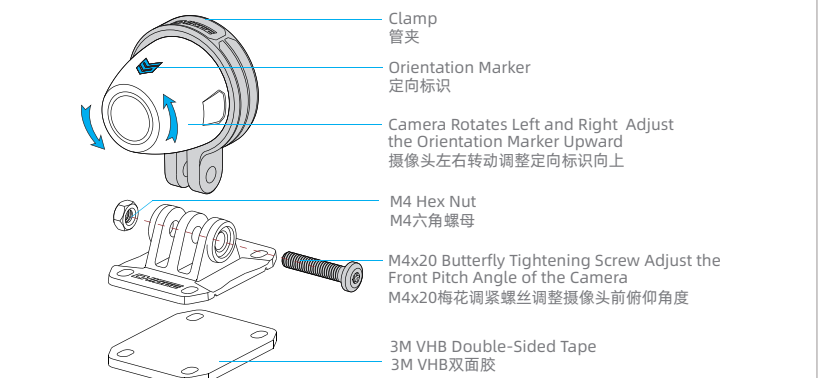

Wiring Diagram (接线图)

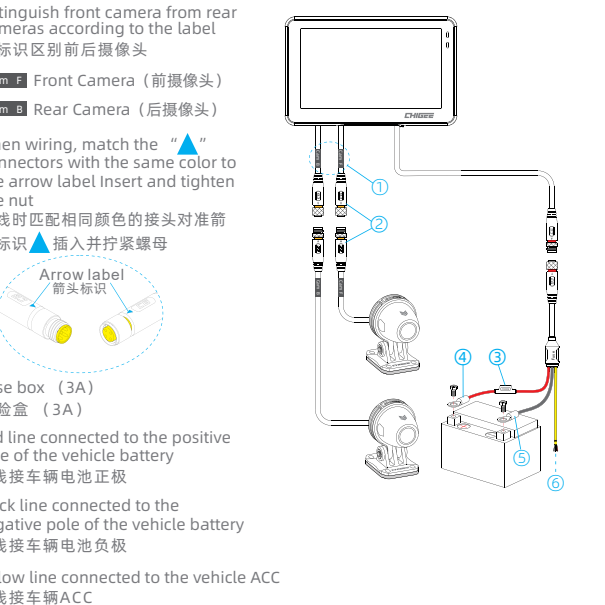

ACC Power Definition (ACC电源定义)

When the motorcycle ignition is in the OFF position, the voltage is 0V, and when in the ON position, the voltage of 11-14.4V can be recognized as the ACC state power supply.
当摩托车电源处于 OFF 档时电压为 0V, 处于 ON 档时电压为 11-14.4V 的即可认定为 ACC 状态电源。

03 Product Activation (产品激活)

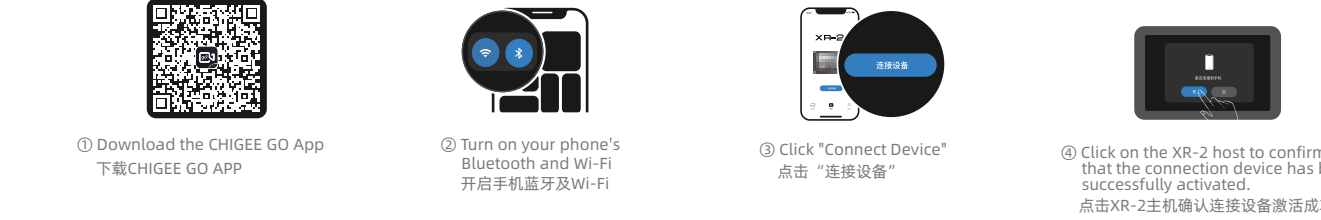

04 Interface (界面介绍)

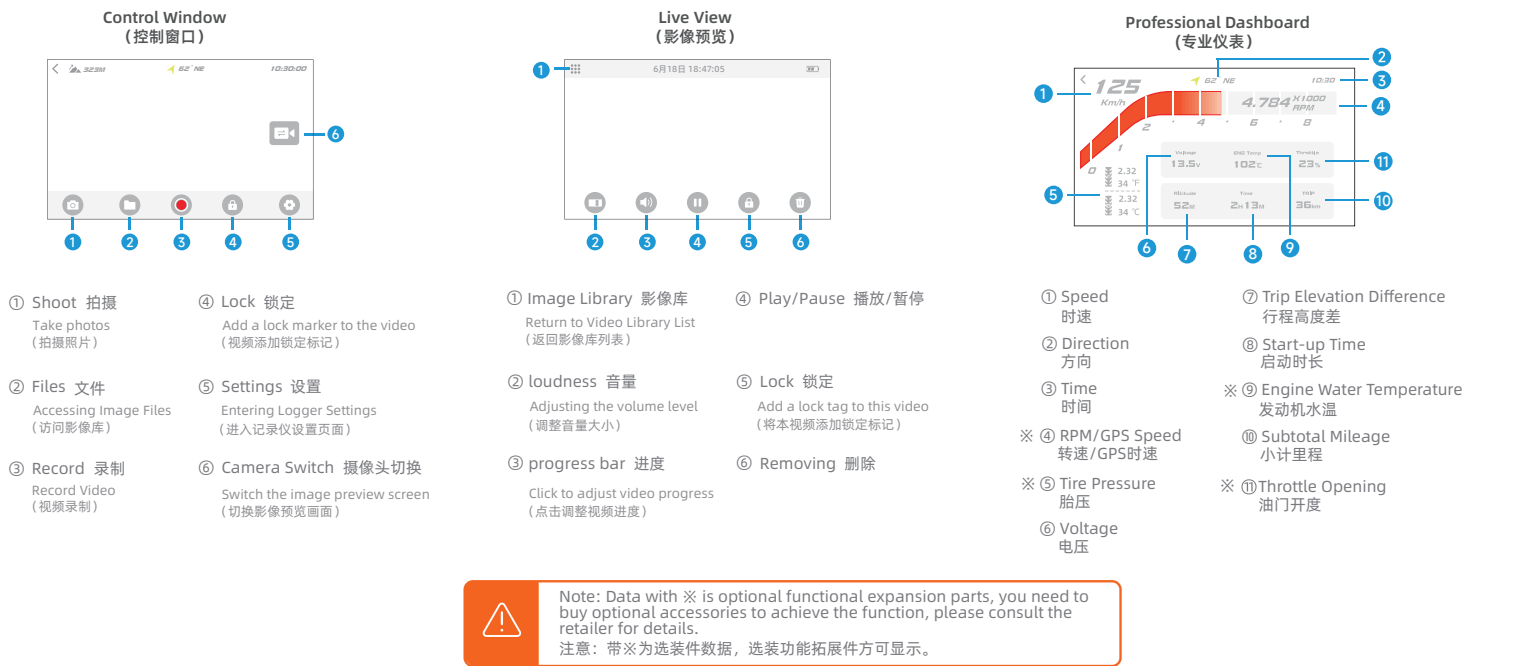

Setting up the Dash Cam (记录仪设置)

Resolution Setting 分辨率设置
1080P/30FPS | 720P/30FPS

Fusion Output 融合输出
Turn on this feature and the front and rear cameras will be saved as a single video file, with the images presented in a large-small format. 开启该功能后, 前后摄像头将保存为一个视频文件, 画面将以一大一小的形式展现。

Recording Time 录制时长
Set the recording duration of each video clip for the Motorcycle Dash Cam, available options: 1 minute, 2 minutes, 3 minutes.
设置记录仪每段视频录制时长, 可选: 1 分钟、2 分钟、3 分钟。

Data overlay 数据叠加
Choose the data you need to overlay to the video files, options include: time, speed, and latitude/longitude. For more data, overlay in the CHIGEE GO APP.
选择所需的数据叠加至视频文件, 可选: 时间、速度、经纬度。更多数据请在 CHIGEE GO APP 中进行叠加。

System Settings (系统设置)

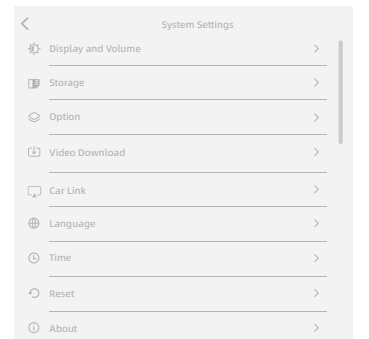

Display and Volume 显示与音量

Adjust the screen brightness and speaker volume, and enable the auto brightness mode.
调节屏幕亮度及扬声器音量, 可开启自动亮度模式。

Storage 存储

Check the remaining capacity of the built-in storage and TF card, and format the operation. Please back up important video files before formatting.
查看内置存储及 TF 卡剩余容量、格式化操作。格式化前请备份重要视频文件。

Option 功能

Customize the settings or view the features, available options: Tire Pressure Sensor, Bluetooth Headset, Remote Control, GPS, OBD, Blind Spot Monitoring, Update.
选装功能的设置或查看, 可设置项: 胎压传感器、蓝牙耳机、遥控器、GPS、OBD、盲区监测、系统更新。

Video Download 影像下载

Enter this page to enable the host's WiFi hotspot, and you can download videos by connecting the phone to WiFi.
进入该页面开启主机 WiFi 热点, 可通过手机连接 WiFi 后进行视频下载。

Mirror Preview 镜像预览

Set the mirror correction to preview the inverted image, or set the rear camera mirror as a rearview mirror.
设置镜像修正画面预览反向问题, 或设置后置摄像头镜像作为后视镜使用。

Collision Lock 碰撞锁定

Once activated, if the vehicle has an impact, the video of that time period will be marked as locked and will not be overwritten by the looping recording. Sensitivity options: High, Medium, Low.
开启后如车辆发生碰撞, 该时间段视频将添加锁定标识, 不会被循环录制所覆盖。灵敏度选项: 高、中、低。

Parking Monitoring 停车监控
When the vehicle is in a parking state and is subjected to vibration, the device will silently record a 30-seconds video file, and the sensitivity can be set. Sensitivity options: High, Medium, Low.
停车状态下车辆如受到震动, 设备将静默录制 30 秒视频文件, 可进行灵敏度设置。灵敏度选项: 高、中、低。

Voice Recording 声音录制

Microphone Volume Settings.
麦克风音量设置。

05 Optional Accessories (选装配件)

Tire Pressure Monitoring (胎压检测)

Tire Pressure Monitoring Sensor to read the real-time tire pressure and alert you with a pop-up warning and an alarm sound when it reaches the preset value. The pressure data can be overlaid with the video file in real time.
通过选装胎压检测传感器可读取轮胎实时气压, 并在达到报警阈值时弹窗提示同时发出预警音。气压数据可通过数据叠加实时同步至录像文件中。

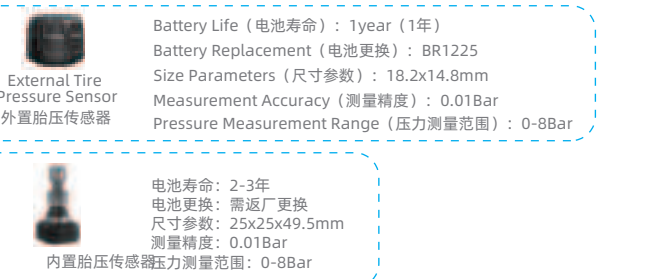

Remote Controls Pro (遥控器Pro)

After installing, you can switch interfaces, select apps, and answer calls directly with your thumb.
通过选装 CG 遥控器 Pro 可进行: 界面切换、应用选择、电话接听等操作。



06 CHIGEE GO APP

First connection (首次连接)

Download the CHIGEE GO APP from the Apple App Store or Android App Store. 扫描二维码下载 CHIGEE GO APP。
Follow the instructions in the app to operate and connect the XR-2. 按照 APP 提示说明进行操作, 连接 XR-2。

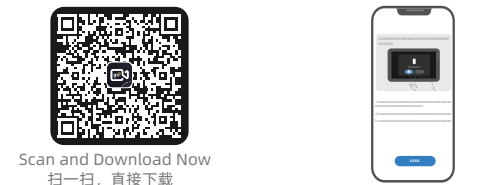

CHIGEE GO Main Page (CHIGEE GO 主页)



Connect Devices (连接设备)

Connect the XR-2 to download video files and adjust recording parameters. 通过连接 XR-2 可下载录像文件并调整录制参数。

Album (相册)

Visit the Motorcycle Dash Cam Album or the local album. Select the clips you need to download, and once the clips are downloaded, users can superimpose data and edit the video themselves.
访问记录仪相册或本地相册。可挑选需要的片段进行下载, 片段下载成功后, 用户可自行叠加数据编辑视频。

My (我的)

Access the latest version of the User Manual, Troubleshooting Guide, and view the device code.
访问最新版用户使用说明、故障排查指南、查看设备编码。

Firmware Upgrade (固件升级)

XR-2 will perform system updates from time to time to add new product features, please follow the instructions below to perform the firmware level. (Please insert the SD card and format it in the device before upgrading)
XR-2 将不时进行系统更新以新增产品功能, 请按以下提示进行固件升级。(升级前请先插入 SD 卡, 并在设备内进行格式化)



Go to XR-2 [Settings] - [Functions] - [System Update] and click Check for updates. 进入 XR-2 [设置] - [功能] - [系统更新] 点击检查更新。
Check to the new firmware version, click "Update Now", XR-2 starts to download the firmware. Once the download is complete, the upgrade will automatically reboot, please make sure the device is not powered off. 检查到新的固件版本, 点击 "立即更新", XR-2 开始下载固件。下载完成后, 将自动重启升级, 请确保设备不要断电。

Reminder提示

Firmware upgrade failure:
固件升级失败
If there is an accidental power failure etc. that causes the device upgrade to fail and the device cannot be turned on again, please Contact customer service to get the SD card upgrade file.
如出现意外断电等导致设备升级失败设备无法再次开机, 请联系客服获取 SD 卡升级文件。

Cleaning and Care Instructions (清洁及注意事项)

- Ensure the lens glass is clean, foreign objects may scratch the lens, it is recommended to use a soft dry cloth to clean the lens.
确保镜头玻璃清洁, 异物可能划伤镜头, 建议使用柔软的干布清洁镜头。
- During the use of AIO-5 lite, sand and dust may block the lens, please use water to flush.
使用 XR-2 的过程中可能造成泥沙堵塞, 请使用水冲洗。
- All components should avoid using oil detergents and other organic solvents for cleaning, which may cause corrosion, loss of waterproof performance, and failure of protective coating.
所有部件应避免使用泊油清洗剂等有机溶剂进行清洗, 该操作可能造成腐蚀、防水性能失效、保护涂层失效。



07 Parameters (技术参数)

Host/主机	
Size/尺寸:	116.7x73.8x28.3
Weight/重量:	262g
Display/显示屏:	4.3inch 800x480 1400Nit
Rated Input Voltage/工作电压:	12-18V DC
Working current/工作电流:	0.6A
CPU/处理器:	A53*2
Operating temperature/工作温度:	-20~60°C
Bluetooth/蓝牙:	Bluetooth 5.0
WiFi:	2.4/5.8G
GPS:	外置式 5Hz GPS 模块, GPS+BeiDou
Operating System/系统:	CGOS (Linux)
TF Card Expansion/TF卡拓展:	256GB MAX
Internal Storage/内置存储:	32GB
Video Format/视频格式:	MP4
Resolution/分辨率:	1920*1080
Support peripherals/支持外设:	
Attitude sensor Tire pressure sensor OBD engine data detection module Bluetooth remote control (Optional accessory) 姿态传感器 胎压传感器 OBD 发动机数据检测模块 蓝牙遥控器	

08 After-sales service (售后服务)

CHIGEE after-sales service strictly implements the "Consumer Rights and Interests Protection Law of the People's Republic of China" and the "Product Quality Law of the People's Republic of China" to provide the following after-sales three-package services:
CHIGEE 售后服务严格按照《中华人民共和国消费者权益保护法》、《中华人民共和国产品质量法》实行售后三包服务内容如下:

Within the three-package period, you can enjoy free returns, exchanges and repairs according to this regulation, and repairs, exchanges and returns should be handled with invoices or purchase records.
在三包有效期内, 您可以依照本规定免费享受退货、换货、维修的服务, 维修、换货、退货应当凭发票或购买记录办理。
1.7 days no reason to return, the user shall bear the freight.
7 日无理由退货, 由用户承担物流费用。
2.If the product has the performance failure listed in the "Product Performance Failure Table", after being tested and confirmed, you can enjoy the following services for free.
本产品出现【产品性能故障表】所列性能故障的情况, 经检测确定后, 可免费享受如下服务。

Product Performance Failure Table (产品性能故障表)

1. Device won't power on 设备无法开机
2. Camera image display is abnormal 摄像头图像显示异常
3. Screen display is abnormal 屏幕显示异常

Product Safety Information (产品安全信息)

Please read all instructions and warnings before using this product. Improper use may cause damage to the product or personal safety.
在使用本产品前请阅读所有的指示和警告, 不规范使用将会给产品或人身安全带来损害。
01. Improper use of the product may cause damage to the product itself or endanger personal and property safety.
产品使用不当, 容易造成产品本身受损或可能危及人身财产安全。
02. Consumers shall bear all consequences if they violate the product instructions and use the product improperly, and the company shall not assume any legal responsibility.
消费者如因违反产品说明书规定, 不当使用产品, 造成人身及财产损失, 将自行承担一切后果, 本公司将不承担任何法律责任。
03. Non-professionals are strictly prohibited from disassembling this product.
非专业人员严禁拆解本产品。

Warranty Terms (保修条款)

Return: Return within 7 days of activation for product quality reasons exchange or refund
退货 自激活起 7 天内产品质量原因退货换货
Exchange: Exchange within 15 days of activation due to product quality issues.
换货 自激活起 15 天内产品质量原因退货换货
Repair: Free repair within 365 days for product quality reasons
维修 自激活起 365 天内产品质量原因维修

Non-warranty regulations (非保修条例)

1. Repair, misuse, collision, negligence, abuse, liquid ingress, accidents, modification, and incorrect use of accessories without authorization.
未经授权的维修、误用、碰撞、疏忽、滥用、进水、事故、改动、不正确地使用配件。
2. Beyond the three-pack validity period.
已超过三包有效期。
3. Damage caused by force majeure.
因不可抗力因素造成的损坏。
4. Not in accordance with the product performance failure table, the situation of the listed performance failures.
不符合产品性能故障表, 所列性能故障的情况。
5. Due to human factors, this product has caused the performance failures listed in the product performance failure table.
因人为原因导致本产品产生产品性能故障表, 所列性能故障。

Disclaimer (免责声明)
Thank you for purchasing the CHIGEE XR-2 product. Before using this product, please read and follow all safety and compliance operating instructions provided in this document, otherwise it may cause harm to you and the people around you, damage this product or other surrounding items. Once you use this product, it is deemed that you have read this document carefully, understand, accept and agree to all the terms and conditions of this document and all related documents of this product. You agree to use this product only for legitimate purposes. You agree to be solely responsible for the use of this product and any consequences that may arise before, during or after the use of this product. This product and manual are owned by Shenzhen CHIGEE Technology Co., Ltd. and may not be copied or reproduced in any form without permission. The latest interpretation of this document and all related documents of this product belongs to CHIGEE XR-2. If there are updates, no further notice will be given. Please visit www.chigee.com official website to get the latest product information.
感谢您购买 CHIGEE XR-2 产品。在使用本产品之前, 请仔细阅读并遵守本文件提供的所有安全与合规操作指引, 否则可能会给您和周围的人带来伤害, 损坏本产品或造成其他财产损失。一旦使用本产品, 即视为您已仔细阅读并理解本文件、手册、认可和接受本产品所有相关文件的全部条款和条件。您承诺仅出于正当目的使用本产品。您承诺对使用本产品以及可能带来的后果负全部责任。CHIGEE XR-2 对于直接或间接使用本产品所造成的损坏亦不承担任何法律责任。不承诺。本产品及手册为深圳市骑技科技有限公司所有未授权, 不得以何形式复制或传播。本文件及本产品所有相关的文件最终解释权归骑技 CHIGEE XR-2 所有。如有更新, 恕不另行通知。请访问 www.chigee.com 官方网站以获取最新的产品信息。

Makers/メーカー/제작자/Hersteller/creator/и/производители
CHIGEE Technology Co., Ltd.
Address/住所/주소/Adresse/appec: 2/F, Building 2
Sanlian Industrial Zone, Shiyan Street, Bao'an District
Shenzhen, China
CHIGEE is a trademark of CHIGEE
Copyright ©2021 CHIGEE All Rights Reserved

本产品由深圳市骑技科技有限公司授权生产
地址: 深圳市宝安区石岩街道三联工业区二栋二层
执行标准: GB4943.1-2022



FCC Warning:

This equipment has been tested and found to comply with the limits for a Class B digital device, pursuant to part 15 of the FCC Rules. These limits are designed to provide reasonable protection against harmful interference in a residential installation. This equipment generates, uses and can radiate radio frequency energy and, if not installed and used in accordance with the instructions, may cause harmful interference to radio communications. However, there is no guarantee that interference will not occur in a particular installation. If this equipment does cause harmful interference to radio or television reception, which can be determined by turning the equipment off and on, the user is encouraged to try to correct the interference by one or more of the following measures:

- Reorient or relocate the receiving antenna.
- Increase the separation between the equipment and receiver.
- Connect the equipment into an outlet on a circuit different from that to which the receiver is connected.
- Consult the dealer or an experienced radio/TV technician for help.

Caution: Any changes or modifications to this device not explicitly approved by manufacturer could void your authority to operate this equipment.

This device complies with part 15 of the FCC Rules. Operation is subject to the following two conditions:

(1) This device may not cause harmful interference, and (2) this device must accept any interference received, including interference that may cause undesired operation.

This equipment complies with FCC radiation exposure limits set forth for an uncontrolled environment. This equipment should be installed and operated with minimum distance 20cm between the radiator and your body.