

# Truly Wire-Free Earbuds

User's Guide for Model IAEBT20 v2401-01



## Features

- True Wireless Stereo
- Sweat proof
- Bluetooth Wireless: range 49 ft.
- Built-in microphone
- Voice prompts announce earbud operations
- Digital volume control
- Built-in rechargeable battery: approximately 5 hrs playtime
- Micro-USB port for battery recharge

## Includes

- 3 pairs of eartips: 1 small, 1 medium, 1 large
- Micro-USB to USB charging cable

FCC ID: 2AH16NIAEBT20

## Battery Charging

- Lightly pull back the cover on the DC Power Input.
- Using a **Micro-USB to USB** cable, connect to the USB port of a powered on computer or USB power adaptor (not included).

Initial charge time is approximately 3 hours. Charge fully before use.

**When the battery is low** the indicator LED will flash red for 2 minutes and a voice will announce "Low Battery," then the unit will automatically power OFF.

**While the unit is charging** it will display a solid red light. When the unit is fully charged it will display a solid blue light.

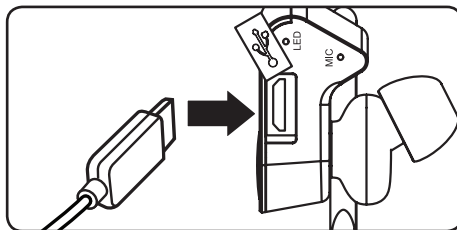

## Orientation & Controls

Right earbud shown. Controls are the same on both earbuds.

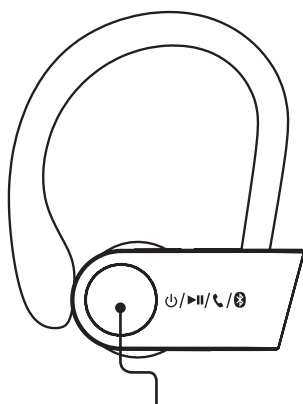

### Function Button

Press and hold to power ON or OFF.  
Press to play or pause audio.  
Press to answer incoming phone call.  
Press quickly 2 times to manually pair.

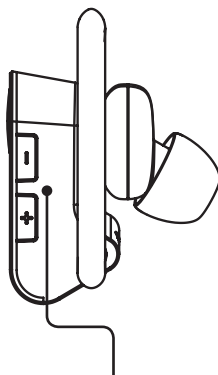

### Volume / Skip

Press to adjust volume.  
Press and hold to skip ahead or back.

### Indicator LED

### Microphone

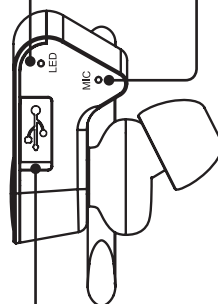

### DC Power Input

## Initial Linking of Earbuds & Pairing to a Bluetooth Device

1. To link the earbuds manually, press and hold the **Function** button on **both earbuds**. They will automatically pair with each other, when successfully linked, a voice prompt will also announce the connection.
2. With the earbuds linked, you can now connect to your Bluetooth device. On your Bluetooth device, access Bluetooth Settings and search for nearby devices. Select **IAEBT20** when it is discovered. When successfully connected to your Bluetooth device, a voice prompt will announce the connection.
3. Audio played through the connected Bluetooth device will now be heard through both earbuds. Use the controls on the connected device to play audio and adjust volume.

**PLEASE NOTE:** Due to the nature of truly wireless earbuds, you may experience slight interruptions with your audio in areas with multiple 2.4Ghz bands or in high wireless traffic areas.

## Speakerphone

1. To accept a call, press the **Function** button, or use the controls on the connected phone.
2. To end a call, press the **Function** button, or use the controls on the connected phone.

## Previously Connected Devices

- To manually pair to another device, press the **Function** button quickly two times. The earbuds will enter pairing mode and can connect to a new device.
- The earbuds can remember multiple Bluetooth devices and will always try to re-connect to the last device used.
- To re-connect to a different device, turn off Bluetooth on unwanted devices, then access the Bluetooth settings menu on the device you wish to use and select **IAEBT20**.

## Troubleshooting

If the earbuds should become unpaired or will not connect normally, follow these steps in your device's Bluetooth Settings Menu.

1. Delete the earbuds ("Forget This Device").
2. Turn Bluetooth OFF then ON again, and repeat the **Initial Bluetooth Connection** steps.

## Customer Support

**Customer Service:** 1-888-999-4215 | **Email Support:** [prodinfo@dpiinc.com](mailto:prodinfo@dpiinc.com) | **Email Parts:** [partsinfo@dpiinc.com](mailto:partsinfo@dpiinc.com)

For Warranty Information and the most up-to-date version of this User's Guide, go to [www.LiveElectronics.com](http://www.LiveElectronics.com)

To download this User's Guide in English, Spanish, or French, or to get answers to frequently asked questions, visit the support section at: [www.LiveElectronics.com](http://www.LiveElectronics.com)

Para descargar este Manual del Usuario en inglés, español y francés, o para obtener respuestas a preguntas frecuentes, visite la sección de apoyo en: [www.LiveElectronics.com](http://www.LiveElectronics.com)

Pour télécharger ce guide de l'utilisateur en anglais, espagnol ou français, ou pour obtenir des réponses à des questions fréquemment posées, consultez la rubrique d'assistance sur: [www.LiveElectronics.com](http://www.LiveElectronics.com)



Copyright © 2019 Digital Products International (DPI, Inc.) All other trademarks appearing herein are the property of their respective owners. Specifications are subject to change without notice.

## FCC Warnings

**WARNING:** Changes or modifications to this unit not expressly approved by the party responsible for compliance could void the user's authority to operate the equipment.

**NOTE:** This equipment has been tested and found to comply with the limits for a Class B digital device, pursuant to Part 15 of the FCC Rules. These limits are designed to provide reasonable protection against harmful interference in a residential installation. This equipment generates, uses, and can radiate radio frequency energy and, if not installed and used in accordance with the instructions, may cause harmful interference to radio communications. However, there is no guarantee that interference will not occur in a particular installation. If this equipment does cause harmful interference to radio or television reception, which can be determined by turning the equipment off and on, the user is encouraged to try to correct the interference by one or more of the following measures:

- Reorient or relocate the receiving antenna.
- Increase the separation between the equipment and receiver.
- Connect the equipment into an outlet on a circuit different from that to which the receiver is connected.
- Consult the dealer or an experienced radio/TV technician for help.

## Additional Warnings

- **WARNING:** To prevent fire or shock hazards, do not expose this unit to rain or moisture.
- **WARNING :** Where the mains plug or appliance coupler is used as the disconnect device, such disconnect device shall remain readily operable.
- Lithium batteries, like all rechargeable batteries, are recyclable and should be recycled or disposed of according to state and local guidelines. They should never be disposed of in normal household waste, and they should never be incinerated, as they might explode. Contact your local government for disposal or recycling practices in your area.
- **To avoid hearing damage,** make sure that the volume on your music player is turned down before connecting your headphones. After placing headphones in/on your ears, gradually turn up the volume until you reach a comfortable listening level.



**WARNING:** This product can expose you to chemicals including lead, which is known to the State of California to cause cancer and birth defects or other reproductive harm. For more information go to [www.P65Warnings.ca.gov](http://www.P65Warnings.ca.gov). **This product meets and complies with all Federal regulations.**

"This device complies with Part 15 of the FCC Rules. Operation is subject to the following two conditions:

- (1) this device may not cause harmful interference, and
- (2) this device must accept any interference received, including interference that may cause undesired operation."