



LIZN HEARING AID BLUETOOTH BAND ANTENNA

Part Number: 2108900-1,1-2108900-1,2-2108900-1
2108897-1,1-2108897-1,2-2108897-1

FEATURES & BENEFITS

- LDS(Laser Direct Structuring) Antenna
- Ability to selectively and repeatably plate 3 dimensionally
 - Ability to produce thin traces
 - Flexibility of pattern design without changing tool

SPECIFICATIONS

| | | |
|-----------------------|--|---|
| Frequency Range (MHz) | 2400 – 2500 (LEFT with Ear phantom) | 2400 – 2500 (RIGHT with Ear phantom) |
| VSWR | < 2.5.0:1 | < 2.5.0:1 |
| Average Efficiency | 4.4 % | 4.4 % |
| Peak Gain | -7.94 dBi | -7.92 dBi |
| Average Gain | -13.54 dBi | -13.55 dBi |
| Power Handling | 5 Watt cw | |
| Feed Point Impedance | 50 ohms | |
| Polarization | Linear | |
| Size | 18.68 mm x 17.6 mm x 9.77 mm | |
| Weight | < 0.5 g | |
| Operating Temperature | -40 to +85°C | |
| Storage Temperature | -40 to +85°C | |
| Hazardous Materials | A certificate of conformance is available from the product page on TE website. | |

RF DATA

3D Chamber : Efficiency Measurement

LEFT

| | 1 | 2 | 3 | 4 | 5 | 6 | 7 | 8 | 9 |
|-----------------|--------|--------|--------|--------|--------|--------|--------|--------|--------|
| Frequency [MHz] | 2400 | 2413 | 2425 | 2438 | 2450 | 2463 | 2475 | 2488 | 2500 |
| Efficiency [dB] | -14.00 | -13.77 | -13.55 | -13.49 | -13.48 | -13.25 | -13.40 | -13.40 | -13.51 |
| Efficiency [%] | 4.0 | 4.2 | 4.4 | 4.5 | 4.5 | 4.7 | 4.6 | 4.6 | 4.5 |
| Peak Gain [dB] | -8.80 | -8.63 | -8.38 | -8.24 | -8.23 | -7.95 | -7.96 | -7.88 | -7.94 |

RIGHT

| | 1 | 2 | 3 | 4 | 5 | 6 | 7 | 8 | 9 |
|-----------------|--------|--------|--------|--------|--------|--------|--------|--------|--------|
| Frequency [MHz] | 2400 | 2413 | 2425 | 2438 | 2450 | 2463 | 2475 | 2488 | 2500 |
| Efficiency [dB] | -14.01 | -13.80 | -13.57 | -13.49 | -13.50 | -13.27 | -13.41 | -13.42 | -13.53 |
| Efficiency [%] | 4.0 | 4.2 | 4.4 | 4.5 | 4.5 | 4.7 | 4.6 | 4.6 | 4.4 |
| Peak Gain [dB] | -8.76 | -8.61 | -8.38 | -8.25 | -8.27 | -7.96 | -7.99 | -7.92 | -7.96 |

RF DATA - LEFT

VSWR

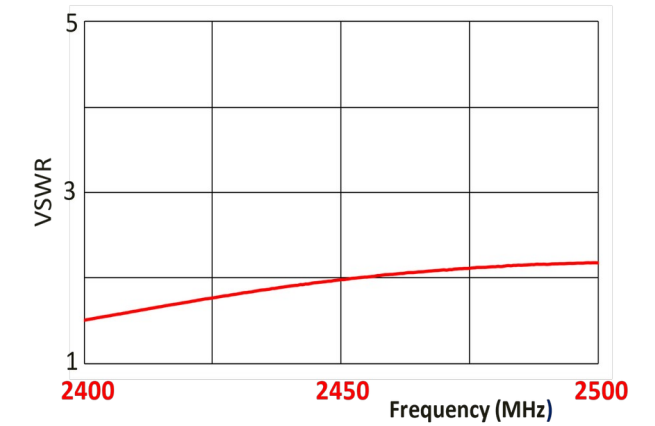

Return Loss

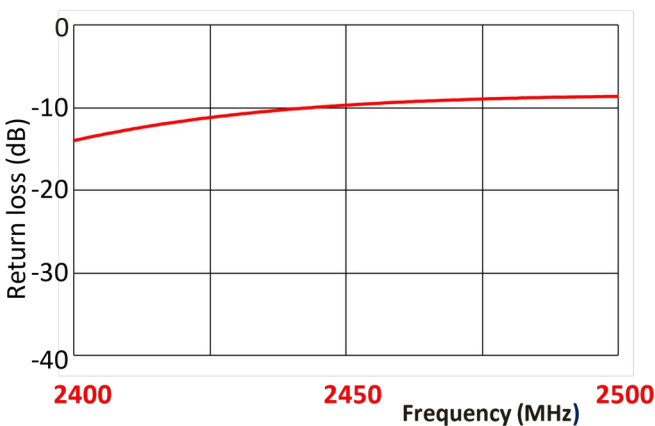

Peak Gain

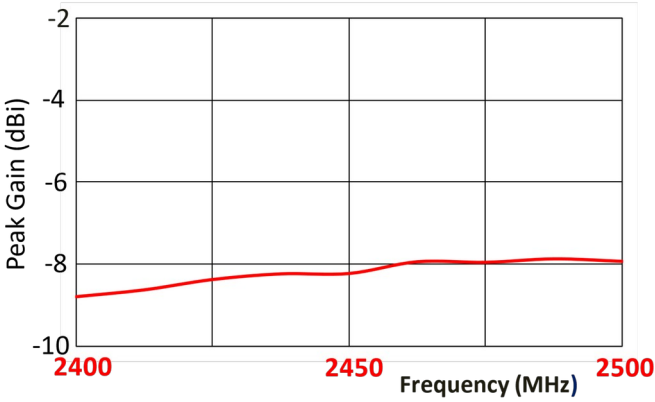

Efficiency

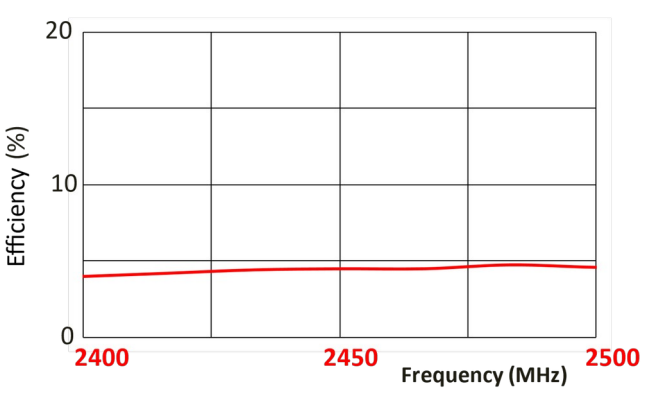

RADIATION PATTERN - LEFT

Test setup

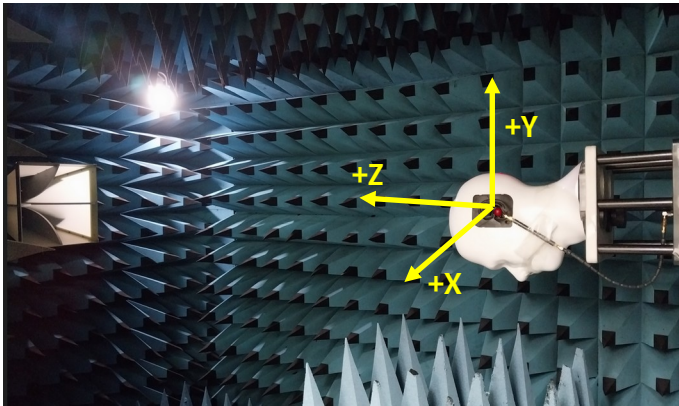

Azimuth [XY]

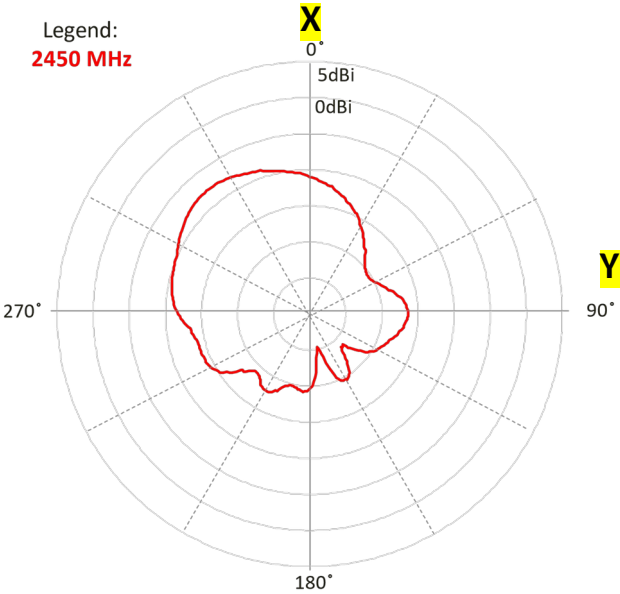

Elevation 1 [XZ]

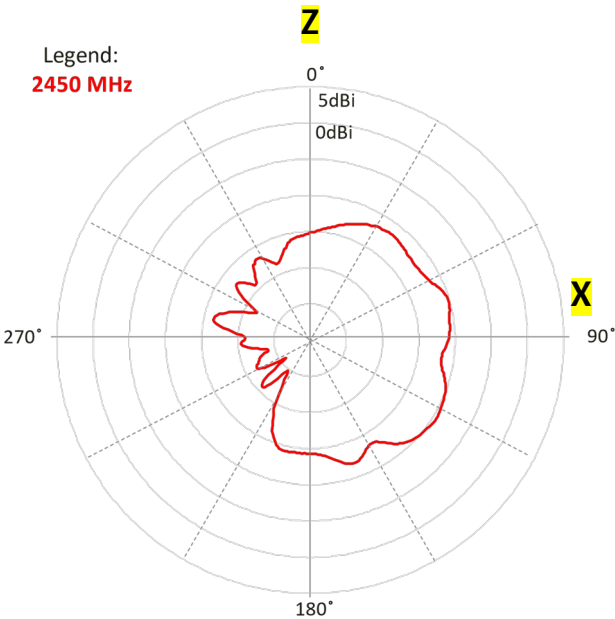

Elevation 2 [YZ]

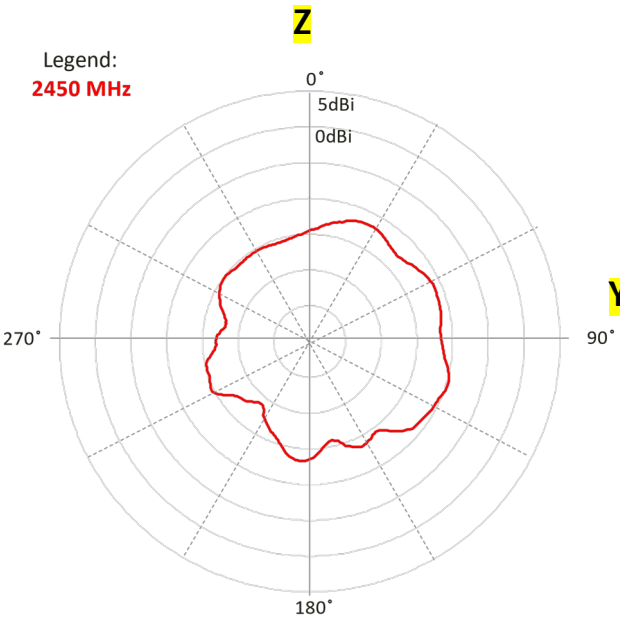



RF DATA - RIGHT

VSWR

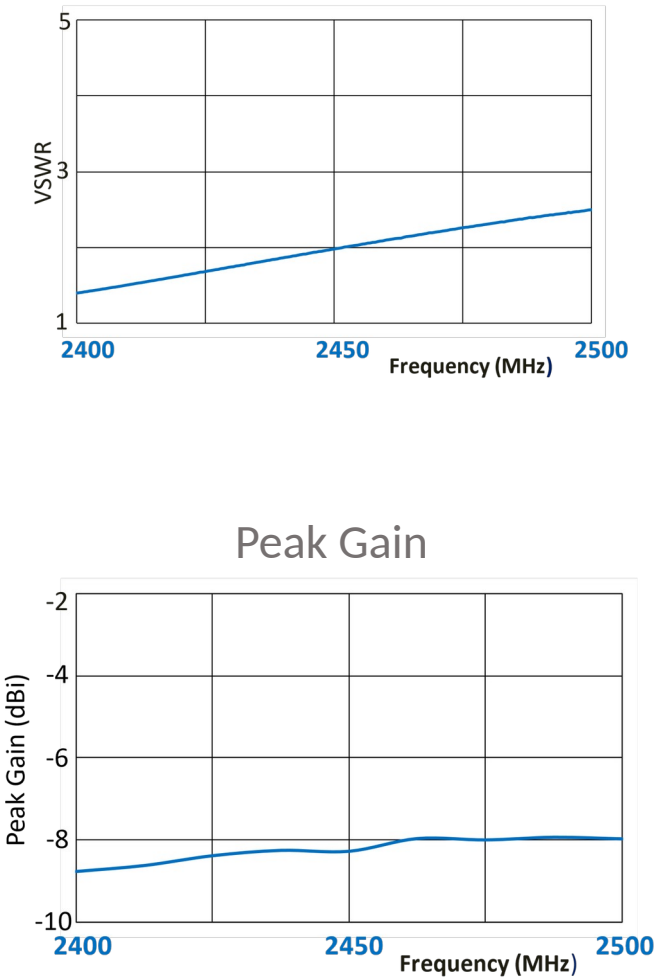

Return Loss

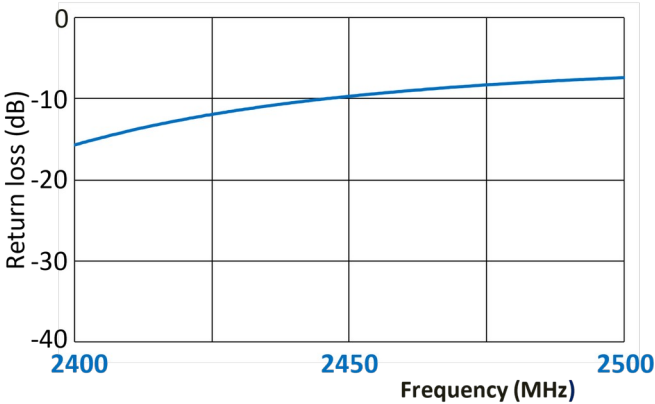

Peak Gain

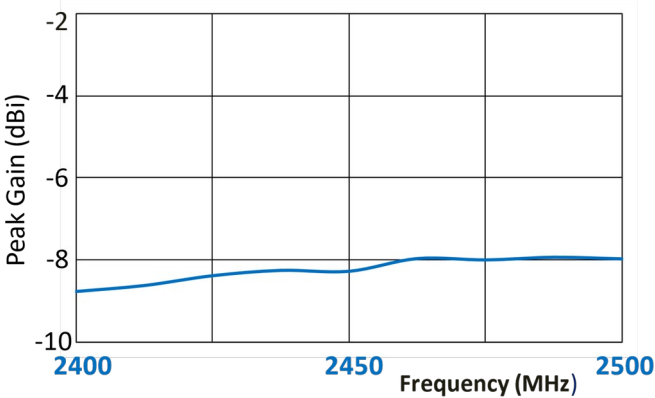

Efficiency

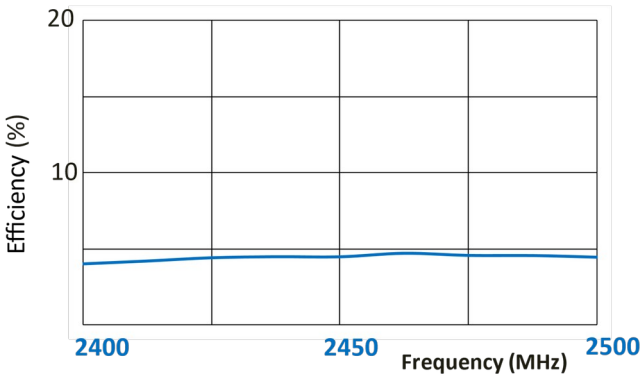

RADIATION PATTERN - RIGHT

Test setup

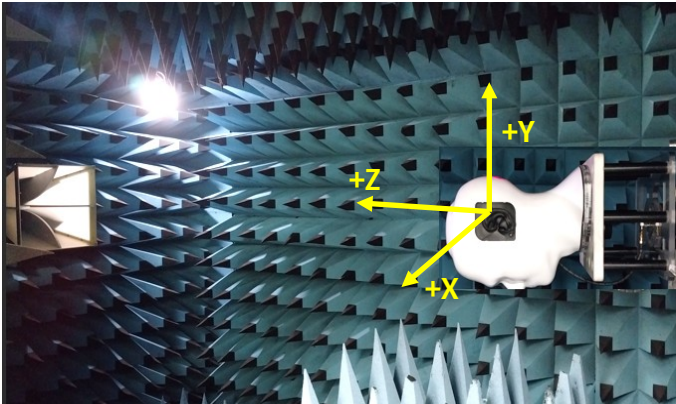

Azimuth [XY]

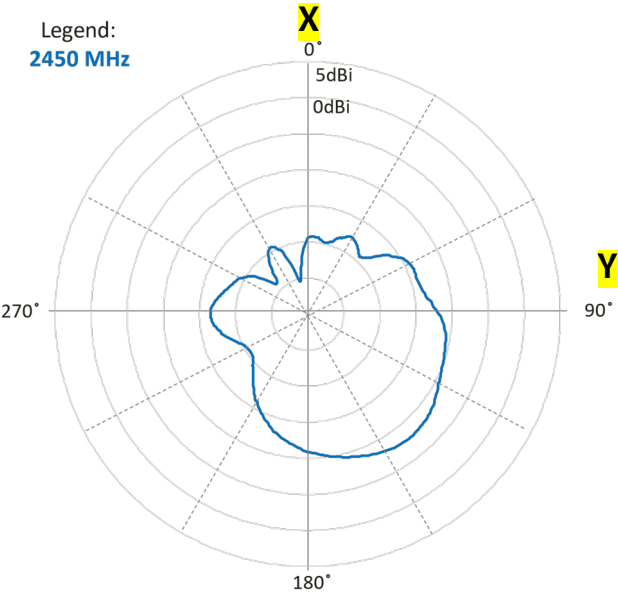

Elevation 1 [XZ]

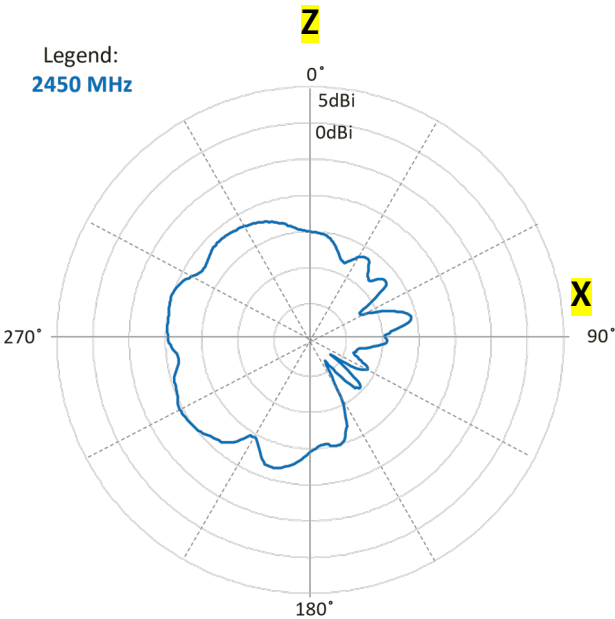

Elevation 2 [YZ]

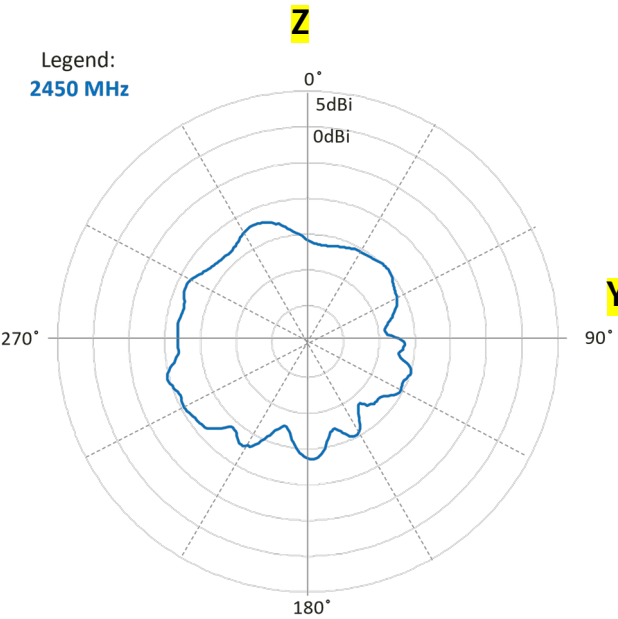

TEST SET

LEFT

RIGHT



LEFT-Ear Phantom

RIGHT-Ear Phantom



MATCHING CIRCUIT VALUE

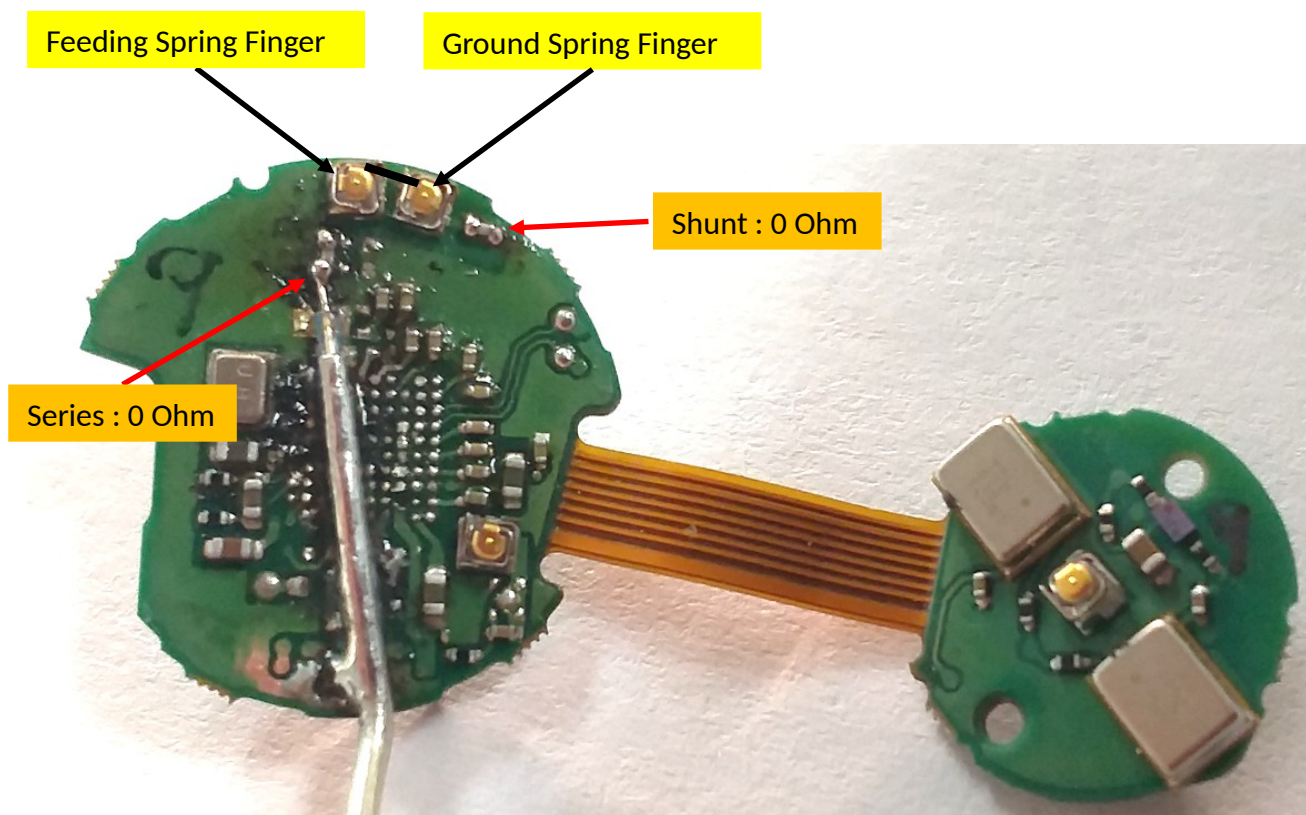

DIMENSIONS

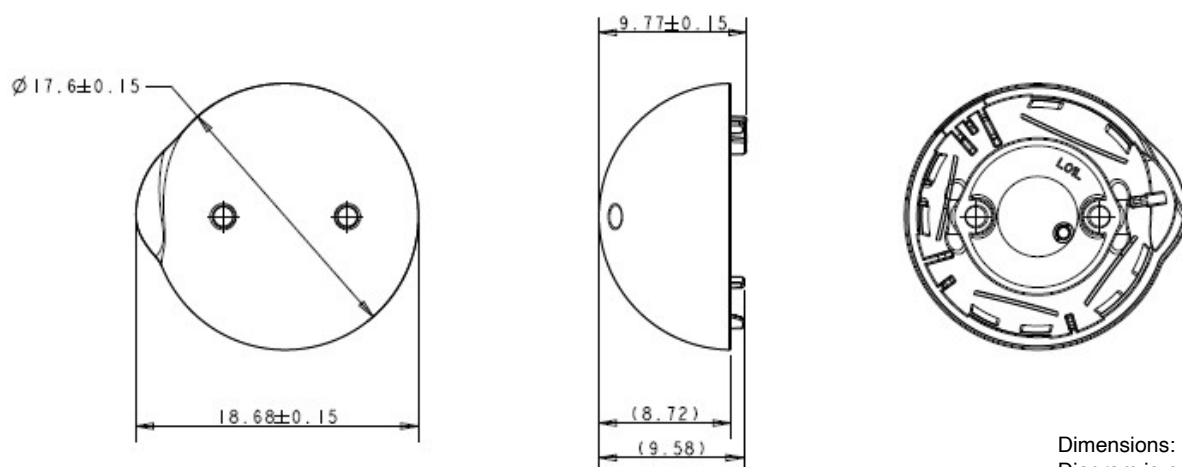

Dimensions: mm
Diagram is not to scale

PACKAGING

① PRIMARY PACKING 80PCS/BUNDLE

② SECONDARY PACKING 1200PCS/BAG 托盘 TY TRAY TRAYS W/PRODUCTS

③ SHIPPER PACKING 2 BAG/BOX

BOX, SHIPPER
2 BAG/BOX

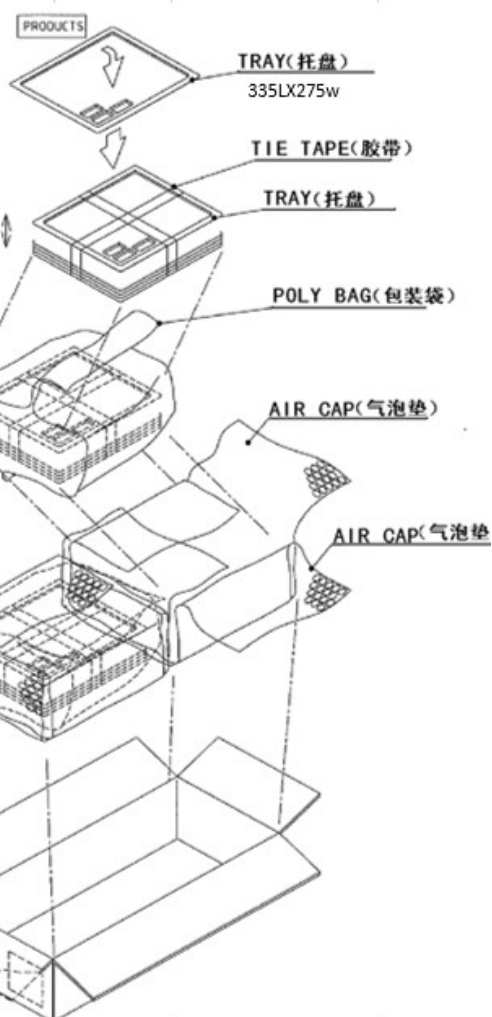

TE TECHNICAL SUPPORT CENTER

| | |
|-------------------|-----------------------|
| USA: | +1 (800) 522-6752 |
| Canada: | +1 (905) 475-6222 |
| Mexico: | +52 (0) 55-1106-0800 |
| Latin/S. America: | +54 (0) 11-4733-2200 |
| Germany: | +49 (0) 6251-133-1999 |
| UK: | +44 (0) 800-267666 |
| France: | +33 (0) 1-3420-8686 |
| Netherlands: | +31 (0) 73-6246-999 |
| China: | +86 (0) 400-820-6015 |

For phone numbers in other countries, go to te.com/support-center

te.com

TE Connectivity, TE Connectivity (logo) are trademarks. All other logos, products and/or company names referred to herein might be trademarks of their respective owners.

The information given herein, including drawings, illustrations and schematics which are intended for illustration purposes only, is believed to be reliable. However, TE Connectivity makes no warranties as to its accuracy or completeness and disclaims any liability in connection with its use. TE Connectivity's obligations shall only be as set forth in TE Connectivity's Standard Terms and Conditions of Sale for this product and in no case will TE Connectivity be liable for any incidental, indirect or consequential damages arising out of the sale, resale, use or misuse of the product. Users of TE Connectivity products should make their own evaluation to determine the suitability of each such product for the specific application.

© 2020 TE Connectivity Ltd. family of companies All Rights Reserved.

10/2023