

OWNER'S MANUAL



SMARTTEMP

INDOOR / OUTDOOR TEMPERATURE SENSOR



TEAMBMPRO.COM

IC ID: 24777-SMARTTEMP
FCC ID: 2ASJH-SMARTTEMP

Designed by BMPRO, one of Australia's leading power solution experts, the BMPRO range of products are proudly Australian-Made in Melbourne, Victoria and represent a high-quality product that will provide years of service.



DISCLAIMER: BMPRO accepts no liability for any loss or damage which may occur from the improper or unsafe use of its products. Warranty is only valid if the unit has not been modified or misused by the customer.

This device complies with part 15 of the FCC Rules. Operation is subject to the following two conditions:

1. This device may not cause harmful interference, and
2. this device must accept any interference received, including interference that may cause undesired operation.

Note: This equipment has been tested and found to comply with the limits for a Class B digital device, pursuant to part 15 of the FCC Rules. These limits are designed to provide reasonable protection against harmful interference in a residential installation. This equipment generates, uses and can radiate radio frequency energy and, if not installed and used in accordance with the instructions, may cause harmful interference to radio communications. However, there is no guarantee that interference will not occur in a particular installation. If this equipment does cause harmful interference to radio or television reception, which can be determined by turning the equipment off and on, the user is encouraged to try to correct the interference by one or more of the following measures:

- Reorient or relocate the receiving antenna.
- Increase the separation between the equipment and receiver.
- Connect the equipment into an outlet on a circuit different from that to which the receiver is connected.
- Consult the dealer or an experienced radio/TV technician for help.



WARNING

Any changes or modifications not expressly approved by BMPRO could void the user's authority to operate this equipment.

This device contains licence-exempt transmitter(s)/receiver(s) that comply with Innovation, Science and Economic Development Canada's licence-exempt RSS(s). Operation is subject to the following two conditions:

This device may not cause interference.

This device must accept any interference, including interference that may cause undesired operation of the device.



WARNING

Any changes or modifications not expressly approved by BMPRO could void the user's authority to operate this equipment.

L'émetteur/récepteur exempt de licence contenu dans le présent appareil est conforme aux CNR d'Innovation, Sciences et Développement économique Canada applicables aux appareils radio exempts de licence. L'exploitation est autorisée aux deux conditions suivantes :

L'appareil ne doit pas produire de brouillage;

L'appareil doit accepter tout brouillage radioélectrique subi, même si le brouillage est susceptible d'en compromettre le fonctionnement.



AVERTISSEMENT

Toute modification ou modification non expressément approuvée par BMPRO pourrait annuler l'autorisation de l'utilisateur d'utiliser cet équipement.



SMARTTEMP

SmartTemp is a temperature sensor which can be located anywhere in your RV, to monitor indoor / outdoor temperatures or in appliances such as your refrigerator.

The SmartTemp integrates with BMPRO RV monitor and control systems, including JAYCOMMAND, JHub, Odyssey and RVMaster. Multiple SmartTemp sensors can be used simultaneously with one monitor.

SPECIFICATION

Voltage	3VDC
Type of battery	CR 2477
Duration of battery	2 years
Weight	19g
Size	39 x 39 x 14 mm
Min. temp.	-20 °C
Max. temp.	+60 °C



Before you start ensure your smartphone is within range of SmartTemp.





Specific instructions required:

Open the app and select ?? on the home screen.

Scan the unique QR Code (C) and follow the instructions in the app.

POWERING THE SMARTTEMP

To maximise battery life, turn the SmartTemp off when not in use.

Press and hold the power button for 3 seconds to switch the SmartTemp on and off.

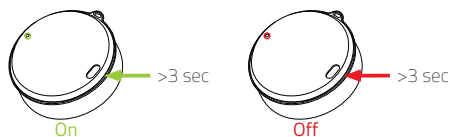

CUSTOMISE YOUR SETTINGS

Navigate to Settings in the app.

Here you can customise your device and setup additional SmartTemp units.

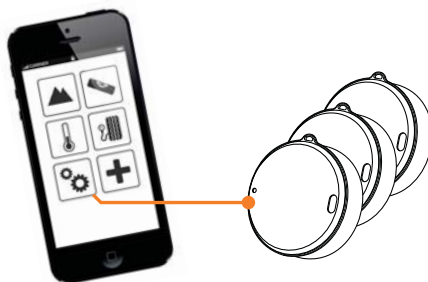

REPLACE THE BATTERY

Open the SmartTemp case using a screwdriver to replace the battery.

Battery required: CR 2477H.

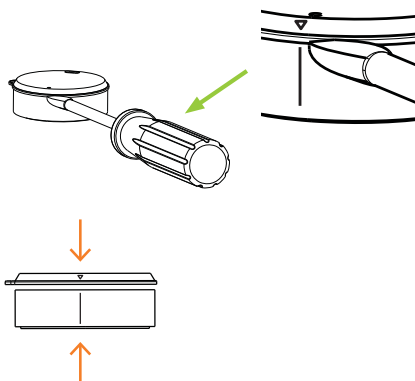

After replacing the battery, close the SmartTemp, ensuring the top and bottom are aligned correctly.

POWERING YOUR ADVENTURES.



BMPRO

TEAM
BMPRO
.COM

BMPRO

+61 3 9763 0962 | sales@teambmp.com
19 Henderson Rd, Knoxfield VIC 3180 Australia

teambmp.com