

# User Mamual

Smart Pet Door

Model:M1

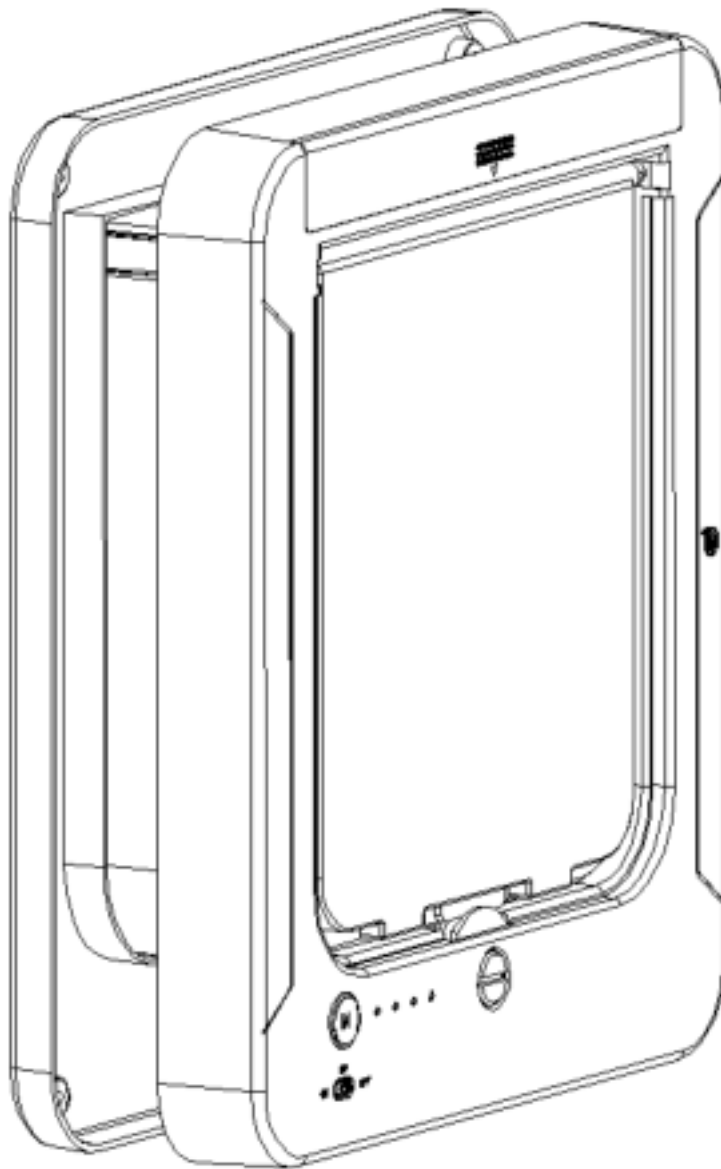

## Functional diagram

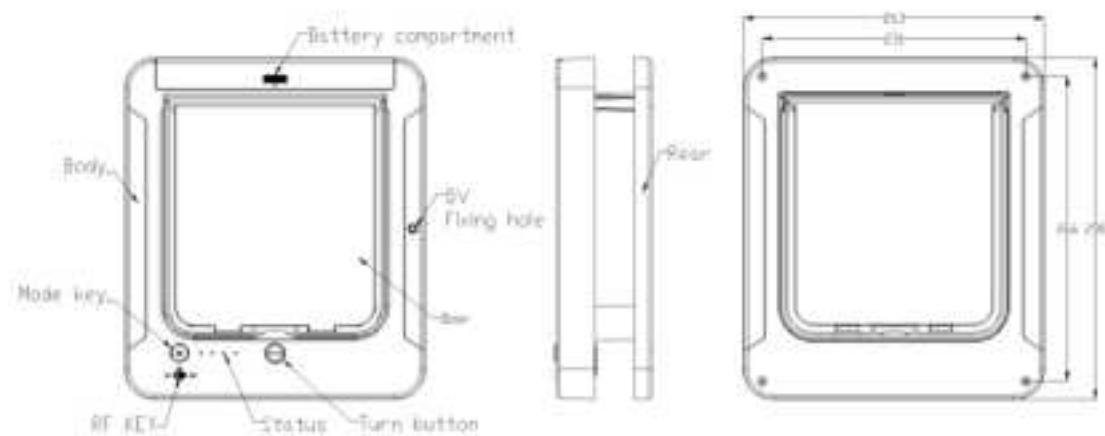

1. The cat door has four access control modes, namely, no entry and no exit, only entry and no exit, only exit and no entry, and entry and exit.



2. Select one of the access control modes through the function key M (Mode Key) on the panel. Press the M key once, the access control mode is switched once, the sound will ring once, the indicator light corresponding to the access control mode will be on, and the light will go out automatically after 2 seconds. The mode selection is completed; the access control will be automatically locked within 15 seconds after no operation. When the cat with the induction key approaches the cat door, the access control will switch to the setting mode, and the indicator light corresponding to the access control mode will be on for 2 seconds and then go out. When the cat pushes the door in and out, the access control will automatically lock after 3 seconds. Or if the cat does not enter the door and leaves for 15 seconds, the rear door is forbidden to lock automatically (no in, no out mode).

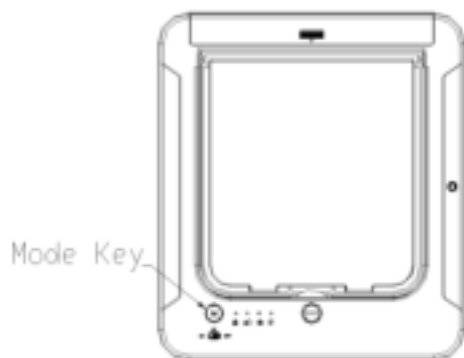

Select one of the access control modes by pressing the button on the remote controller. There are four access control modes available on the remote controller panel. Press the remote controller once. Once the access control mode is switched, the sound will ring once, the corresponding indicator light will be on, the light will automatically go out after 2 seconds, and the mode selection is completed; Without any operation, the rear door will be locked automatically in 15 seconds, and the remote control distance of the remote control is 10M at unobstructed.

3. RF key: a) Turn the RF key to ON to enable the induction key function; B) Turn the RF key to OFF to disable the induction key function; The RF key, whether on or off, has 4 access control modes to choose from.

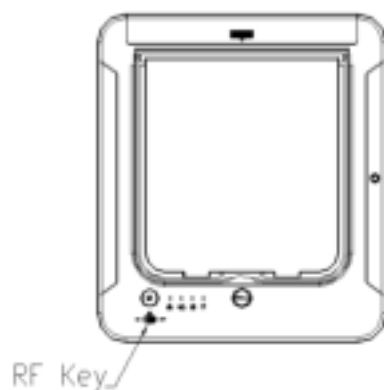

4. Factory status of the product: the key is not coded, and the remote controller is not coded. Subsequent replacement of the battery will save the last record status.
  - 1) When there is no key code, all the initial induction keys are identified to be able to open the door, and there is no limit on the number of keys; If only the key with matching code can open the door after matching code, it can support the identification of 4 keys with matching code at most.
  - 2) When the remote controller has no code, the remote controller cannot be used; it can be used after the code is checked, and only one remote controller is supported.
5. How to use the matching code.
  - 1) Short press the function M button to switch the access control mode, and the indicator light will be on at the corresponding position for 2 seconds and then go out.
  - 2) Induction key code matching: long press the M button for 3 seconds, the sound will ring for 3 times, and the indicator light will display circularly to enter the code matching mode. If the induction key is within 10MM of the induction area and the sound is heard once and the indicator light is off, the code matching is successful. If there is no operation in the code matching mode for 30 seconds, it will automatically exit the code matching mode, or press the M button for a long time again to hear the sound and exit the code matching mode. If there are more than one sensing key, repeat the above actions.



- 3) Code matching of remote controller: long press the M button for 3 seconds, the sound will ring for 3 times, and the indicator light will display circularly, then the code matching mode will be entered. Aim the remote controller at the cat door, and press two keys at the same time within 50mm from the cat door for code matching. If the sound is heard once and the indicator light is off, the code matching is successful. If there is no operation after 30 seconds of successful code matching, the code matching mode will be automatically exited, or if the M button is pressed for a long time again and a sound is heard, the code matching mode will be exited. 



- 4) Clear the matching code: After pressing the M button for a long time, the battery is installed and powered on. After the sound rings three times and the indicator light goes out, the saved matching code is successfully cleared. Press the M key again to activate when done.
6. The effective sensing distance of the RFID key is within 20CM of the front of the cat door.

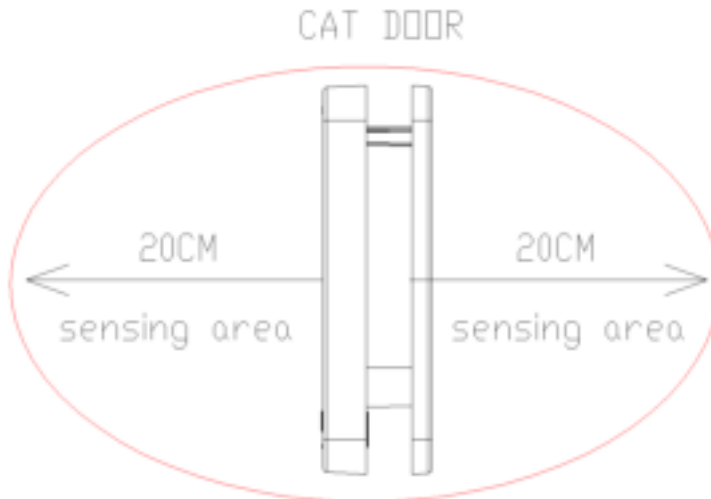

7. When the battery is in a low state, the cat door will continuously emit a "beep beep" sound, and all indicator lights will be on at the same time. The cat door will enter a locked state, prompting to replace the battery

8. When the battery is low or not working, you can manually rotate the center button with a coin to adjust the **exit/entry modes**



9. Install step

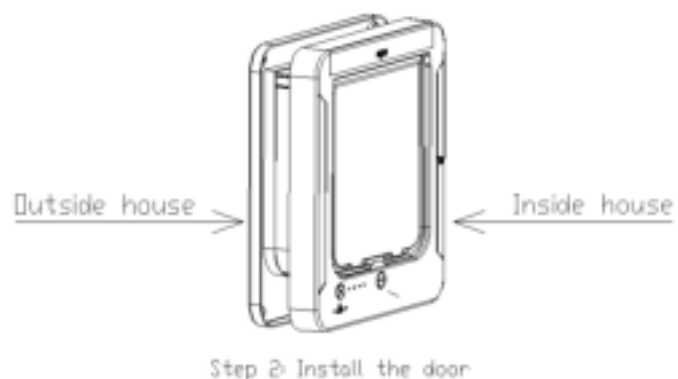
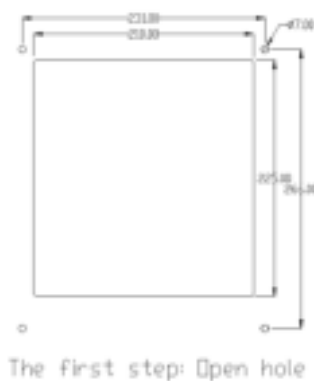

10. Precautions

- 1) After the battery is installed, the machine works normally if a "drop" sound is heard and the indicator light is on.
- 2) Check that the FP key has been turned to the ON position.

3) After powering on, the induction key of the smart cat door and the remote controller are operated by code matching.

4) When the RFID key cannot be recognized, please reset the matching code.

5) When the battery voltage is too low, The cat door will enter a locked state, and the cat door will continuously emit a "beep beep" sound, Do not restart until the battery is replaced with a new one. (Or manual rotation mode)

6) When the door cannot be opened due to the rotation deviation of the cat door lock, it indicates that the battery power is low and the battery can be replaced.

7) When the cat approaches, the four lights flash. At this time, the Hall switch on the control panel cannot detect the magnet on the door. Please check whether the door is closed. Whether the magnet polarity on the door panel is installed in the wrong direction, etc.

8) When the cat approaches, the corresponding access control indicator lights up, but the door cannot be opened. Please check whether the shaft plate and the door plate have been pasted, resulting in too much resistance and the motor can not rotate. After adjustment, you can use the button (remote control) to recalibrate the origin of the motor.

9) Choose a high quality battery to ensure a longer working time.

10) When the indicator light is in the ticker state, it indicates that the equipment is in the wireless code matching state, which can be solved by powering off.

11) When powering on for the first time, press the M key to reset the motor.

12) When switching the mode, press the M key to wake up the device, and then press the M key to adjust the mode.

13) This equipment is not waterproof.

#### Introduction to this pet door

- Smart pet door: Use RFID to read the sensor key worn by your pet. pets that read the key can open the door, while animals that cannot read the key will block the door, helping to prevent intruders from entering your home.
- The key uses a passive induction chip, and the key does not need to be charged.
- Door opening: The pet door flip opening is 190MM (width) by 205MM (height), the installation wall thickness is 5MM-50MM, the optimal installation thickness is 35MM-45MM, and can be installed on doors, windows or walls.
- Battery Powered: Runs on 4 AA non-rechargeable alkaline batteries (not included); estimated battery life of up to 12months, depending on usage.
- Perfect Gift: The smart pet door makes a great gift for pet lovers and cat lovers - creating a safe space and home for their pets, comes with a one-year warranty.

Access control status	4 exit/entry modes
RFID frequency	125KHz
Material	ABS
Recognition distance	20CM
Remote control frequency	433HZ
Product size	263*298*84MM
Door opening size	190*205MM
Installation hole size	210*230MM
Weight	1KG
Battery	4*AA
Work time	12month
Color	White/Black
Accessory	2 tag keys, 1 necklace, 8 screws, User Manul, 1 install paper, 1 remote control (optional)

#### **FCC Warning Statement**

Changes or modifications not expressly approved by the party responsible for compliance could void the user's authority to operate the equipment. This equipment has been tested and found to comply with the limits for a Class B digital device, pursuant to Part 15 of the FCC Rules. These limits are designed to provide reasonable protection against harmful interference in a residential installation. This equipment generates uses and can radiate radio frequency energy and, if not installed and used in accordance with the instructions, may cause harmful interference to radio communications. However, there is no guarantee that interference will not occur in a particular installation. If this equipment does cause harmful interference to radio or television reception, which can be determined by turning the equipment off and on, the user is encouraged to try to correct the interference by one or more of the following measures:

- Reorient or relocate the receiving antenna.
- Increase the separation between the equipment and receiver.
- Connect the equipment into an outlet on a circuit different from that to which the receiver is connected.
- Consult the dealer or an experienced radio/TV technician for help.

#### **FCC Radiation Exposure Statement**

The antennas used for this transmitter must be installed to provide a separation distance of at least 20 cm from all persons and must not be co-located for operating in conjunction with any other antenna or transmitter. (For Pet Door)

The device has been evaluated to meet general RF exposure requirement. The device can be used in portable exposure condition without restriction. (For Remote control)

This device complies with Part 15 of the FCC Rules. Operation is subject to the following two conditions:

- (1) This device may not cause harmful interference.
- (2) This device must accept any interference received, including interference that may cause undesired operation.