

# USER MANUAL

happy plugs

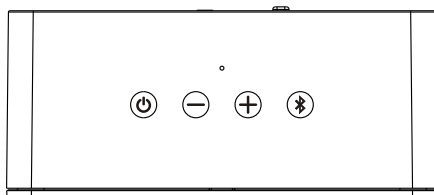

## Happy Plugs BLUETOOTH SPEAKER Sound Piece mini

### FEATURES

Thanks for your purchase of our product. Please read through this manual before making connections and operating this product. Retain this manual for future reference.

- Bluetooth playback
  - AUX input
  - Power supply: DC-5V
- Note: ● Use DC adapter or USB terminal to charge battery no matter the speaker power on or off.
- In low battery status, the bluetooth speaker will emit once **Battery Low, Please Charging** voice prompt per five minutes and it will switch off automatically if no charged in low battery status.
  - Power consumption: 5W
  - Speaker max output: 2W X 2
- Note: The bluetooth speaker will turn to standby mode after 15 minutes in the absence of no source status, standby power is less than 0.5W.

### ACCESSORY

- User manual
- USB cable

-1-

### PRECAUTION

- Do not drop any objects into the unit through the openings.
  - Do not spill or spray liquid of any kind on or in the unit. It may result in a fire or electric shock.
  - Do not place anything heavy on the unit.
  - To ensure proper ventilation and proper operation, never cover or block the slots and opening with a cloth or other materials.
  - Keep the unit away from an open flame such as fire, candle, etc.
  - Install the batteries correctly.
  - Please dispose the batteries according to the local rule and law.
  - The maximum working temperature is 35 degrees Celsius.
  - Only use attachments/accessories specified by the manufacturer.
  - Where the Mains plug is used as the disconnect device, the disconnect device shall remain readily operable.
  - Rating label are on the bottom of the unit.
- WARNING: The batteries shall not be exposed to excessive heat such as sunshine, fire or the like.
- CAUTION: Danger of explosion if battery is incorrectly replaced. Replace only with the same or equivalent type.

-2-

### PANEL

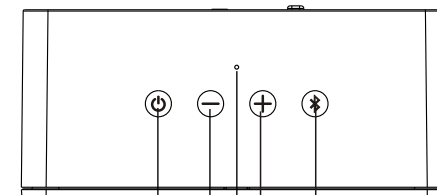

1. STANDBY
2. VOLUME-
3. MICROPHONE
4. VOLUME+
5. BLUETOOTH

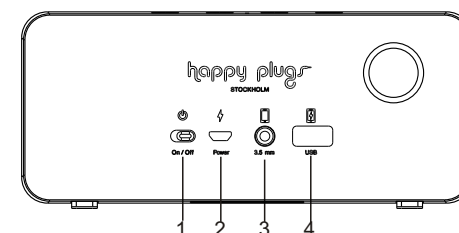

1. POWER ON/OFF
2. DC IN 5V
3. AUX INPUT (3.5MM)
4. USB CHARGING FOR EXTERNAL DEVICE

-3-

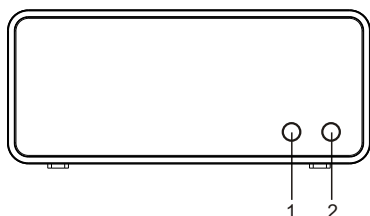

1. BLUETOOTH INDICATOR
2. CHARGING-INDICATOR

### VOLUME+

- When the speaker is in working mode, press to turn up the volume.
- You will hear the beep sound when you turn up to the maximum volume.

### VOLUME-

- When the speaker is in working mode, press to turn down the volume.
- You will hear the beep sound when you turn down to the minimum volume.

-4-

### BLUETOOTH

When the speaker is in bluetooth connection working mode.

- Use the bluetooth speaker answer the phone call in hands free when there is a phone call in.
- Hold down this button for 3 seconds to disconnected the bluetooth connections, the speaker will turn to pairing other matching bluetooth device when you hear the voice prompt of **Device Disconnected, Pairing Device**. Press this button each time you will hear the voice prompt of **Pairing Device** when the speaker without bluetooth connection status.

### CHARGING FOR EXTERNAL DEVICES (5V)

- Use the USB cable to connect the USB slot of the player to other device input terminals to charge battery, like mobile phone, etc. Please note the charge port could charge battery no matter in standby status or power on status.

### INDICATOR

- Power on the speaker by sliding the ON/OFF switch to the ON position and press the standby button, the red and the blue indicator flashing alternately, you will hear

-5-

the voice prompt of **Sound Piece Ready To Go, Pairing Device**, the speaker is in searching bluetooth signal status.

- The blue indicator flashing once per 2 seconds means bluetooth was connected, you will hear the voice prompt of **Device Connected**, and the model of the speaker will show on your device.
- The bluetooth speaker will go into power off and it emit **Sound Piece Going To Sleep** voice prompt if hold down the standby button in power on status.
- It is better to switch off the unit before charging. The charging-indicator changing from red to light off indicates that the battery has been fully charged.

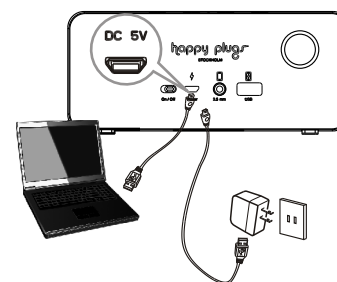

-6-

### AUX IN

- This speaker has an extra group of audio input terminals. You can input the analogue stereo audio signals from extra devices such as mobile phone, computer, MP3 player, etc.
- Use the audio cable to connect the audio output terminals of mobile phone, computer, MP3 player to the audio input terminal (AUX IN) of this speaker.
- If BT is connected, plug in AUX in cable, you have to pause the music in the connected device to start play music through AUX in.
- If BT is connected, plug in AUX in cable, you can disconnect the speaker to give priority to aux in, too.

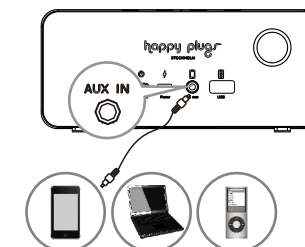

-7-

## BLUETOOTH CONNECTION

- The bluetooth pairing model of the speaker is Sound Piece mini , power on the speaker then use your smart phone to search the bluetooth signal of the unit, the unit will synchronize to play songs on your smart phone while they connected successfully.
- The speaker need to input the password 0000 when the matching bluetooth device under version 2.1.
- The bluetooth speaker will turn to standby status after 15 minutes without bluetooth connections, at this time , the bluetooth speaker will emit the voice of **Power Off**. press [STANDBY] button to wakes up the speaker.
- When the operation too frequently or other reason to disturb the bluetooth reconnected, please use manually connect on the bluetooth device.
- The bluetooth is connected to your smart phone successfully for the first time, disconnect the bluetooth on your smart phone then reconnected it, the speaker will memories your smartphone and repaired automatically.

-8-

Note:

- Bluetooth connection range in 10 meters;
- The model Sound Piece mini in your device was not deleted;
- After 15 minutes in AUX in mode without music playback status, the speaker go to sleep status and you need to hold down [STANDBY] button for 3 seconds to going to standby status, then press [STANDBY] button to wakes up the speaker.
- clear the paired memory history by pressing 'standby' button for 2 times and the speaker would not repaired automatically .

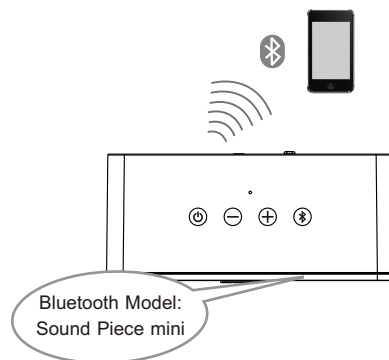

-9-

## TROUBLESHOOTING

No power	Try and power the bluetooth speaker using a different outlet or check the connection of the DC adapter.
Music is not playing over bluetooth	Make sure your bluetooth device has A2DP. Check if both devices are paired and connected over bluetooth. Restart the bluetooth speaker to reconnect your bluetooth device.
Bluetooth device will not reconnect with the speaker	Navigate to your bluetooth settings menu on your bluetooth device, tap "Sound Piece mini", and select "Forget". now follow the steps to pair your device again.

-10-

FCC STATEMENT:

- 1.This device complies with part 15 of the FCC Rules. Operation is subject to the following two conditions:  
(1) This device may not cause harmful interference.  
(2) This device must accept any interference received, including interference that may cause undesired operation.
- 2.Changes or modifications not expressly approved by the party responsible for compliance could void the user's authority to operate the equipment.

NOTE: This equipment has been tested and found to comply with the limits for a Class B digital device, pursuant to Part 15 of the FCC Rules. These limits are designed to provide reasonable protection against harmful interference in a residential installation. This equipment generates uses and can radiate radio frequency energy and, if not installed and used in accordance with the instructions, may cause harmful interference to radio communications. However, there is no guarantee that interference will not occur in a particular installation . If this equipment does cause

-11-

harmful interference to radio or television reception, which can be determined by turning the equipment off and on, the user is encouraged to try to correct the interference by one or more of the following measures:  
Reorient or relocate the receiving antenna.  
Increase the separation between the equipment and receiver.  
Connect the equipment into an outlet on a circuit different from that to which the receiver is connected.  
Consult the dealer or an experienced radio/TV technician for help.

RF warning statement:

The device has been evaluated to meet general RF exposure requirement. The device can be used in portable exposure condition without restriction.

**CE** means that your electrical and electronic equipment should be disposed at the end of its life separately from your household waste.  
There are separate collection systems for recycling in the EU. For more information, please contact the local authority or your retailer where you purchased the product.

-12-

## Industry Canada Notice

This device complies with Industry Canada license-exempt RSS standard(s).

Operation is subject to the following two conditions:

- (1) this device may not cause interference, and
- (2) this device must accept any interference, including interference that may cause undesired operation of the device.

This Class B digital apparatus complies with Canada ICE-003.

IC:10485A-BL5601

CAN ICES-3(B)/NMB-3(B)

- French:

Le présent appareil est conforme aux CNR d'Industrie Canada applicables aux appareils radio exempts de licence. L'exploitation est autorisée aux deux conditions suivantes :

- (1) l'appareil ne doit pas produire de brouillage, et
- (2) l'utilisateur de l'appareil doit accepter tout brouillage radioélectrique subi, même si le brouillage est susceptible d'en compromettre le fonctionnement."

-13-