

## **Model: EL1121-x Handset Antenna**

### **Antenna description:**

This PCB Printed F antenna is optimized and used in the Handset unit. This antenna is directly connected to the ANT RF output in the main PCB.

Model Number	Description
EL1121-x Handset ANT	1.9GHz PCB Printed F antenna

### **Specification:**

<b>Operation Frequency Range</b>	1921.536 to 1928.448 MHz
<b>Maximum Gain</b>	0 dBi
<b>Type</b>	Printed F
<b>Operation bandwidth</b>	10MHz
<b>Nominal Impedance</b>	~50 ohms
<b>Manufacturer</b>	Vtech Telecommunications Ltd
<b>Manufacturer address</b>	23/F, Tai Ping Industrial Centre, Blk1, 57 Ting Kok Road, Tai Po, Hong Kong
<b>Model number</b>	ANT-EL1121-x-P-DE-0

**\*NOTE: Frequency and Orientation with maximum Antenna Gain.**

Frequency: 1924.992 MHz

	Vertical	Horizontal
Antenna Gain (dBi)	0.00	-3.78

EL1121-x Handset Radiation Pattern\_XY Plane

—◆— Vertical  
—■— Horizontal

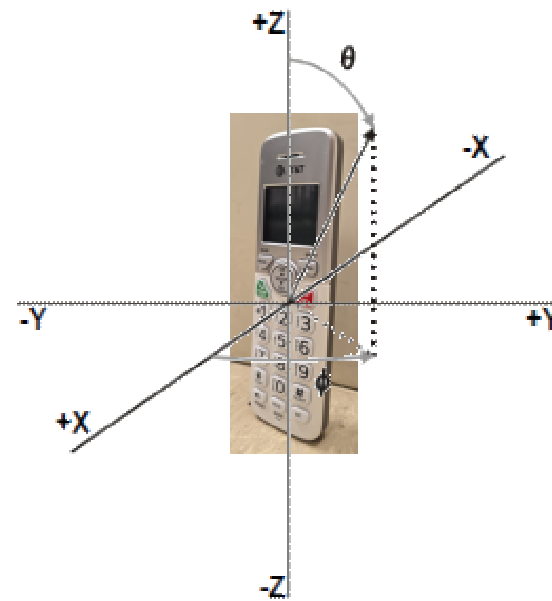
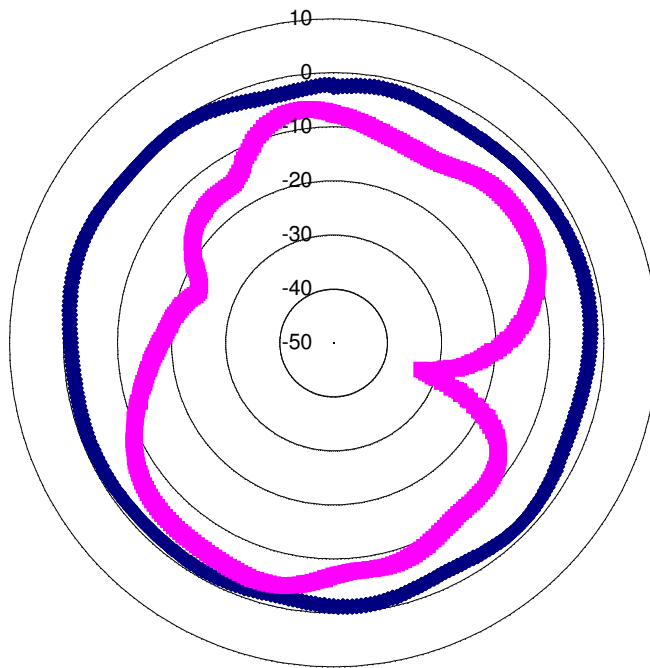

EL1121-x Handset Antenna Dimensions in mm

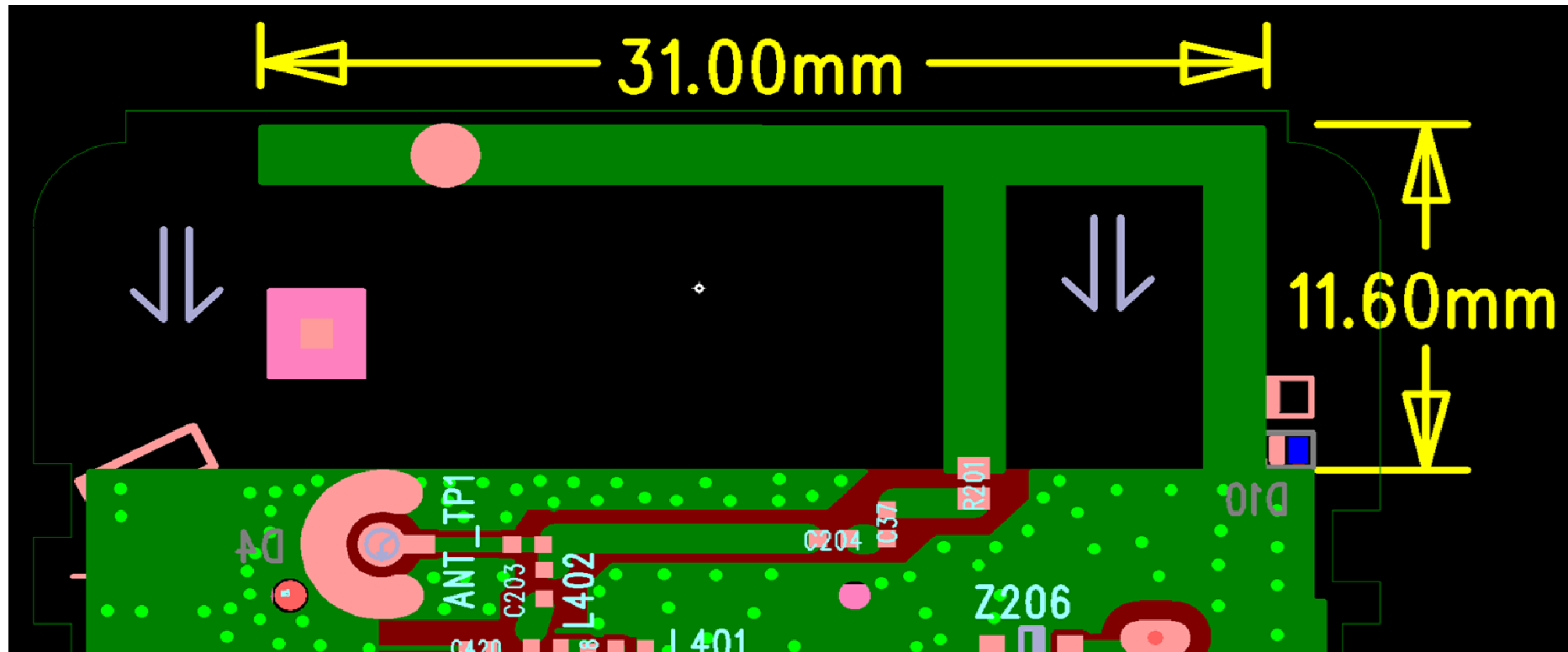

## Model: EL1121-x Base Antenna

### Antenna description:

This wire Monopole antenna is optimized and used in the Base unit. This antenna is directly soldered to the ANT\_0 RF output in the main PCB.

Model Number	Description
EL1121-x BS ANT_0	1.9GHz Monopole

### Specification:

Operation Frequency Range	1921.536 to 1928.448 MHz
Maximum Gain	0 dBi
Type	Monopole
Operation bandwidth	10MHz
Nominal Impedance	~50 ohms
Manufacturer	Vtech Telecommunications Ltd
Manufacturer address	23/F, Tai Ping Industrial Centre, Blk1, 57 Ting Kok Road, Tai Po, Hong Kong
Model number	ANT-EL1121-x-F-DE-1

**\*NOTE:** Frequency and Orientation with maximum Antenna Gain.

Frequency: 1924.992 MHz

	Vertical	Horizontal
Antenna Gain (dBi)	0.00	-3.52

EL1121-x BS ANT1 Radiation Pattern\_XY Plane

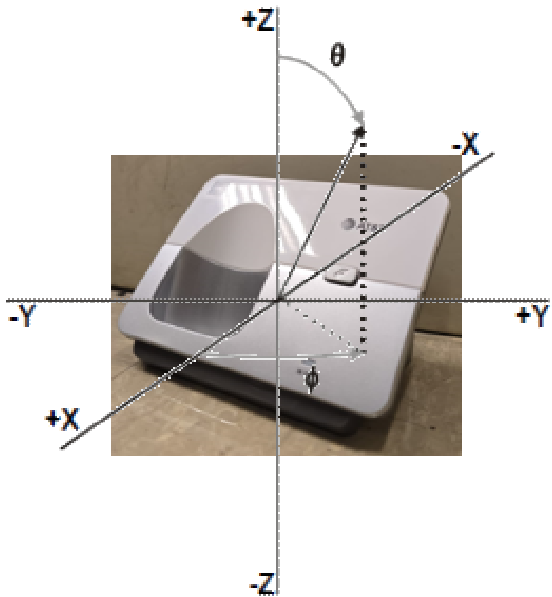
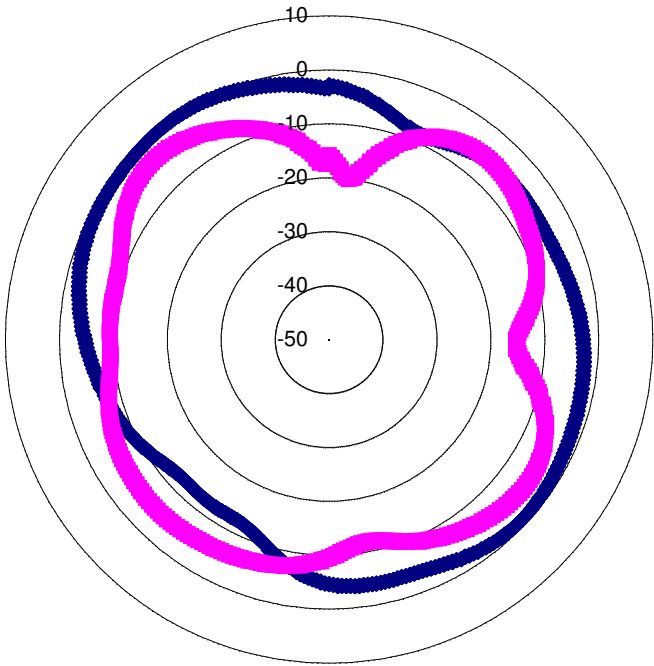
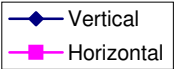

EL1121-x BS ANT0 Antenna Dimensions in mm

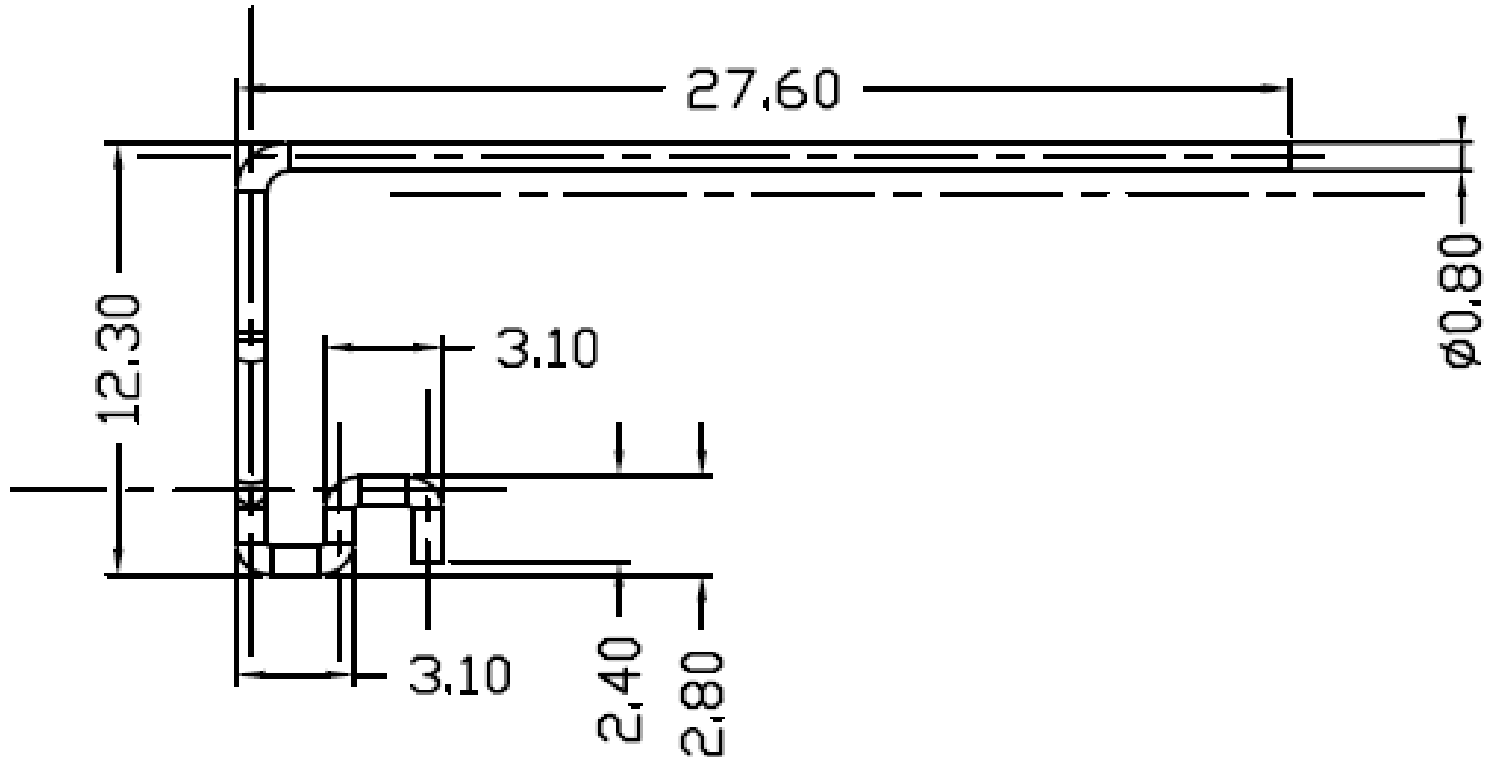

## Model: EL1121-x Base Antenna

### Antenna description:

This wire Monopole antenna is optimized and used in the Base unit. This antenna is directly soldered to the ANT\_1 RF output in the main PCB.

Model Number	Description
EL1121-x BS ANT_1	1.9GHz Monopole

### Specification:

Operation Frequency Range	1921.536 to 1928.448 MHz
Maximum Gain	0 dBi
Type	Monopole
Operation bandwidth	10MHz
Nominal Impedance	~50 ohms
Manufacturer	Vtech Telecommunications Ltd
Manufacturer address	23/F, Tai Ping Industrial Centre, Blk1, 57 Ting Kok Road, Tai Po, Hong Kong
Model number	ANT-EL1121-x-F-DE-1

**\*NOTE:** Frequency and Orientation with maximum Antenna Gain.

Frequency: 1924.992 MHz

	Vertical	Horizontal
Antenna Gain (dBi)	0.00	-3.52

EL1121-x BS ANT1 Radiation Pattern\_XY Plane

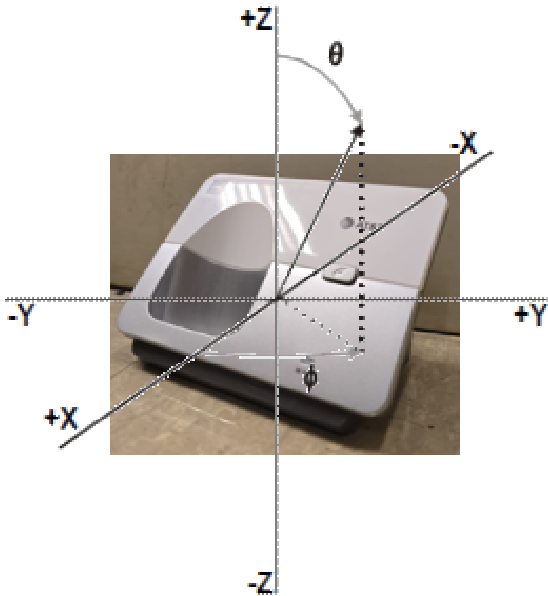
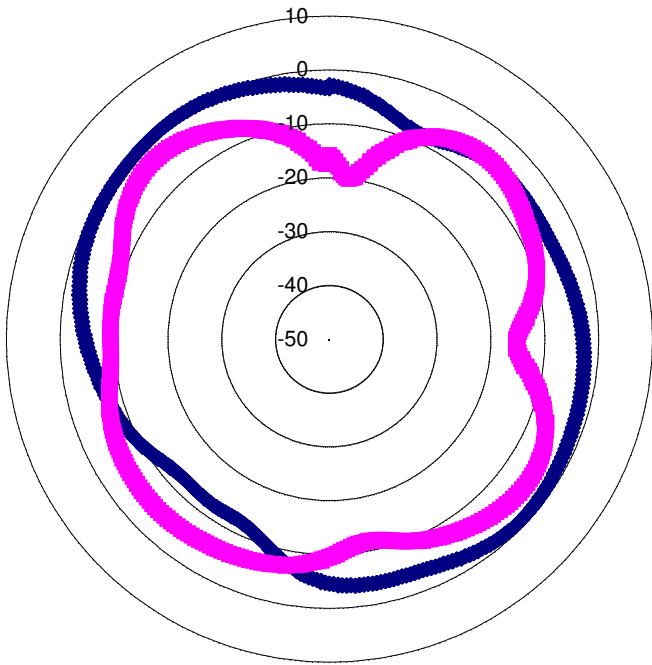
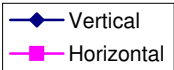

EL1121-x BS ANT1 Antenna Dimensions in mm

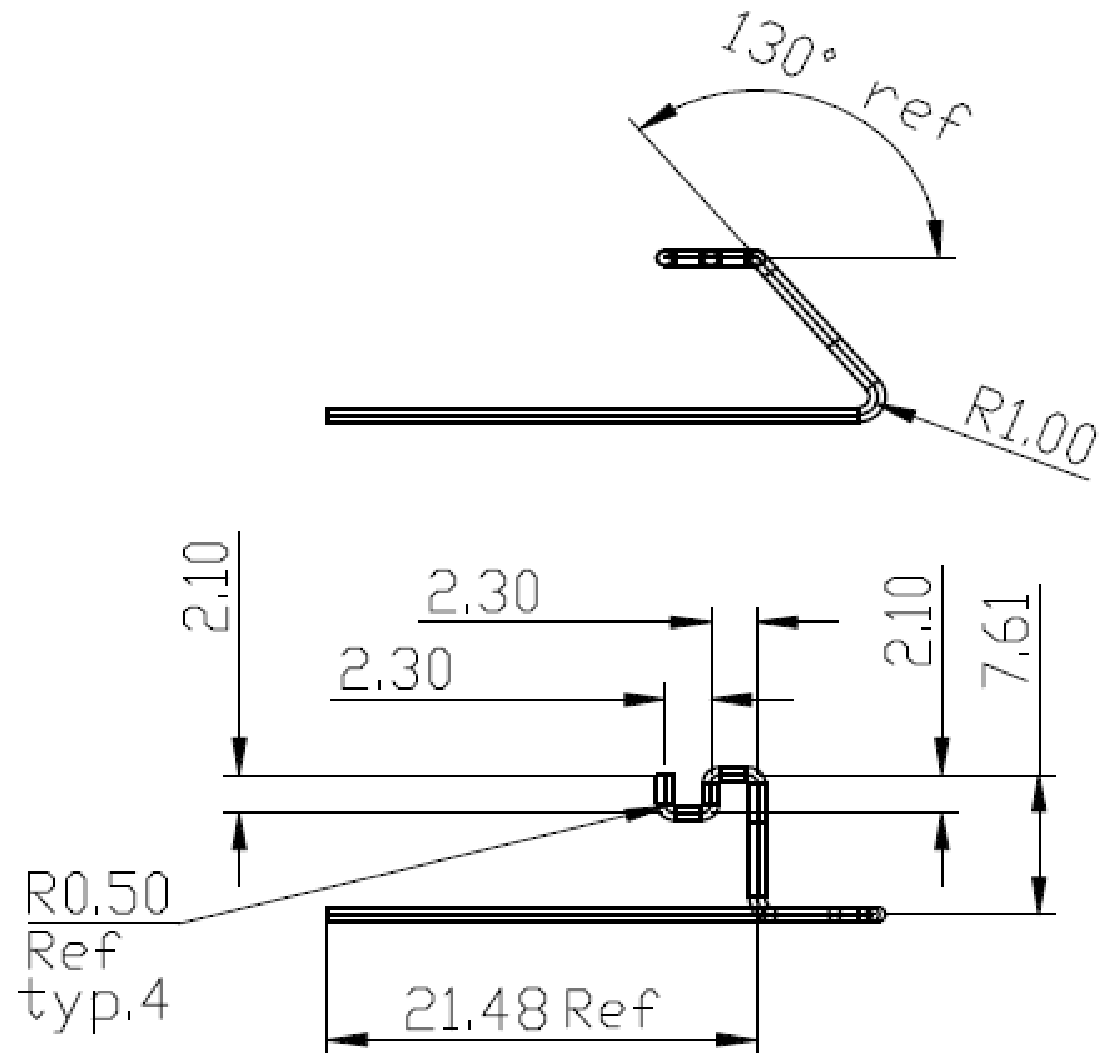

## Model: EL1121-x Base Bluetooth Antenna

### Antenna description:

This Wire Monopole antenna is optimized and used in the Base unit. This antenna is directly soldered to the Bluetooth RF output in the main PCB.

Model Number	Description
EL1121-x BS BT ANT	2.4GHz Wire Monopole Antenna

### Specification:

Operation Frequency Range	2402 to 2480 MHz
Maximum Gain	0 dBi
Type	Monopole
Operation bandwidth	90MHz
Nominal Impedance	~50 ohms
Manufacturer	Vtech Telecommunications Ltd
Manufacturer address	23/F, Tai Ping Industrial Centre, Blk1, 57 Ting Kok Road, Tai Po, Hong Kong
Model number	ANT-EL1121-x-F-BT-0

**\*NOTE:** Frequency and Orientation with maximum Antenna Gain.

Frequency: 2440MHz

	Vertical	Horizontal
Antenna Gain (dBi)	0.00	-0.14

EL1121-x BS BT Radiation Pattern\_XY Plane

◆ Vertical  
■ Horizontal

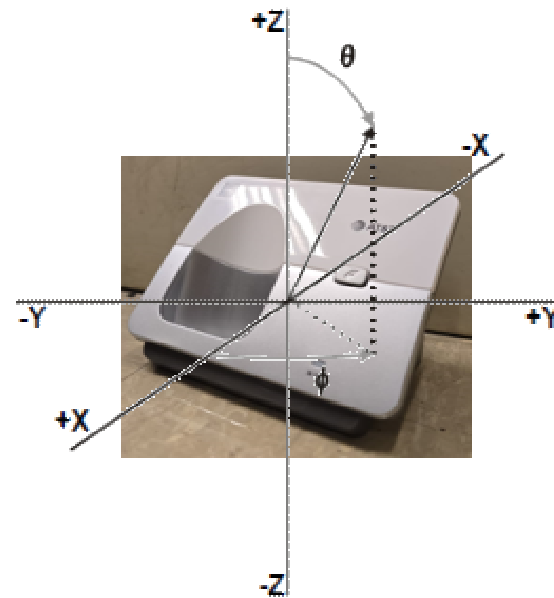
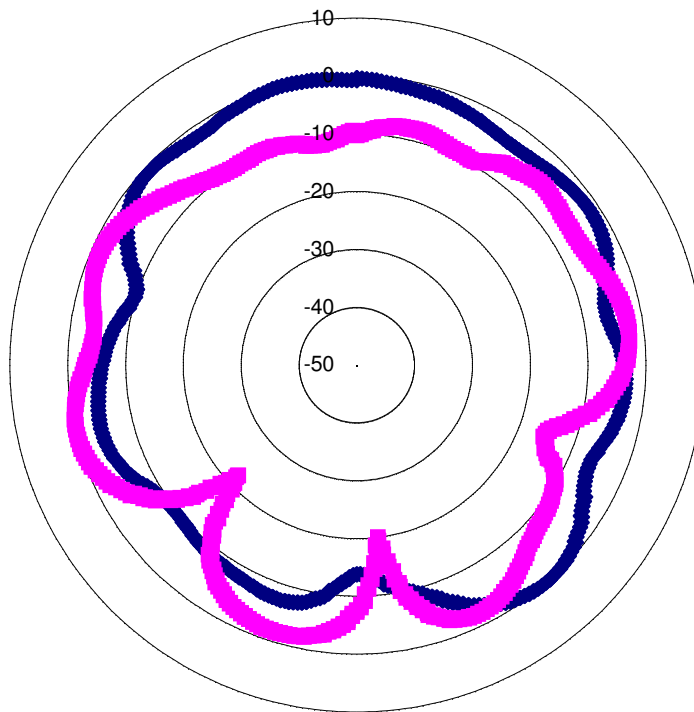

EL1121-x BS BT Antenna Dimensions in mm

