

# WA275ZB

## FCC ID: 2AIXNWA275ZB

### TWS Bluetooth Headset

#### User Manual

Bluetooth headset should be used with the compatible devices which support Bluetooth wireless technology. This allow you to make two calls and enjoy the music streaming at any time freely. Please read this user manual carefully before using the headset, and also read your device's user manual regarding the Bluetooth function, and pay attention to those important safety and maintenance information. Please keep the headset away from children.

## Specifications

Bluetooth Version :	V5.0
Bluetooth Profiles Supported :	HFP, A2DP, AVRCP
Audio Decoding Protocol :	SBC
Transmission Power :	Class 2
Operation Range :	Up to 10 meters
Frequency Range :	2.4GHz-2.48GHz
Battery of Headset :	50mAh Li-polymer Battery
Charging Voltage of Headset :	DC 5±0.25V
Charging Time of Headset :	About 1.5 hours
Battery of Base :	450mAh Li-polymer Battery
Charging Voltage of Base :	DC 5±0.25V
Charging Time of Base :	About 1.5 hours
Charging Headset Times from	
Charging Base :	2~3 times
Music Playing Time :	Up to 3 hours ≥ 80% volume
Talk Time :	Up to 3.5 hours
Standby Time :	About 80 hours
Driver :	φ 8mm
Driver sensitivity :	101±3dB(1kHz)
Driver impedance :	32Ω
Driver frequency ring range :	20Hz-20kHz
Dimensions of Charging	
Base(mm) :	L92.5×W35.6×H30
Dimensions of Headset(mm) :	L27.3×W17×H21.5
Weight(one headset) :	About 4g
Total Weight :	About 50g

\*The time mentioned above may vary due to user's operation mode and device settings.

## Structure Sketch

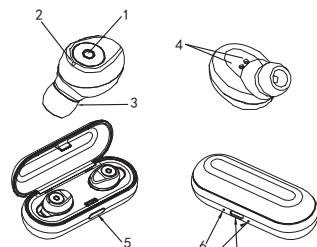

- 1) MFB
- 2) Earbuds Charging Indicator(Mic)
- 3) Drivers
- 4) Charging Pogo Pin
- 5) Charging Base Opening Snap
- 6) Left Charging Base Indicator
- 7) Right Charging Base Indicator
- 8) Micro USB Charging Port

### Headset Mode

Status No.	Status	Charging Base Performance
1	The Single Pairing headset(R)	The indicator light of headset(R) flashes red and blue alternately.
2	TWS Pairing	After TWS pairing succeeded, the indicator light of the right flashes red and blue alternately.
3	Music Mode	No indicators.
4	Calling Mode	No indicators.
5	Headset Charging Mode	The indicator light of the headset is red when being charged, and will turn off automatically after being fully charged.
6	Turn-on Mode	The indicator light flashes blue for 3 times.
7	Power-Off State	The red indicator light will be on for 1 second and will be off after turning off.

### Charging Base Mode

Status No.	Status	Headset Performance
1	Earbuds Charging mode	The right indicator will be green, and will be off after being fully charged.
2	Base Charging mode	The left indicator will be red, and will be off after being fully charged.

## Identify according to L&R and wear the headset (R) and headset (L) respectively



## Wearing Steps:

### Step①



Erect headset and them into the cochlea

### Step②

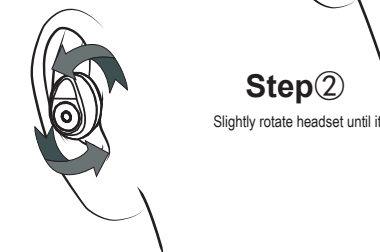

Slightly rotate headset until it firm

### Step③

Make the headset to cochlear edge tightly.

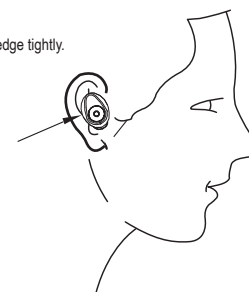

## Charging Ways of Headset

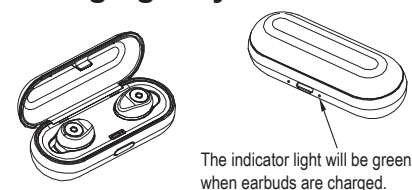

The indicator light will be green when earbuds are charged.

Put the headset (L) (R) to the corresponding position in the bottom of the charging base.

## Charging Ways of Charging Base

Use the USB charging cable to charge

The indicator light will be red when earbuds are charged.

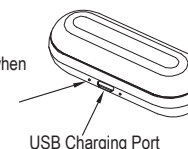

USB Charging Port

## Use the USB cable to connect with computer

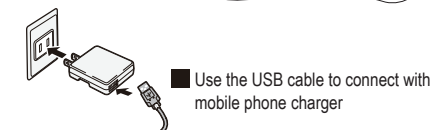
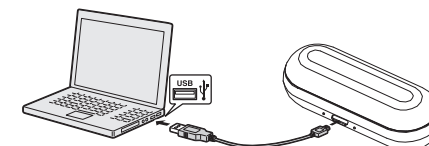

Use the USB cable to connect with mobile phone charger

- Note 1: Check the charging device suitable to the headset or not.
- Note 2: Use only the supplied charger to charge the headset, if use other device may violate the validation or the maintenance article of this product and may cause danger.
- Note 3: Do not attempt to open the built-in battery to avoid damaging the headset.
- Note 4: A fully charged headset will lose its power automatically if being left unused due to transient current. Please charge the headset one per three month even not using.
- Note 5: Do not leave the headset in a too hot or too cold condition (best between -10 °C and 50 °C) which may affect the headset's operations although it is fully charged.
- Note 6: Do not dispose of the headset into fire or water.

## Turning ON/OFF

### 1 Method

In OFF MODE, press and hold headset(R) or headset(L) MFB for 2 seconds to turn on.  
In ON MODE, press and hold headset(R) or headset(L) MFB for 3 seconds to turn off.

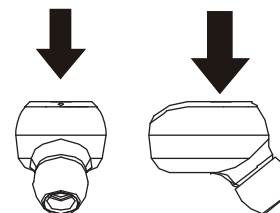

### 2 Method

Pick up the headsets from the charging base to turn on automatically. Put them back and close the case cover to power off.

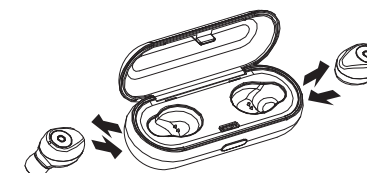

## TWS Pairing

1

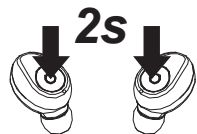

On off state, press the MFB of headset "R" and headset "L" for 2 seconds to power on. Two headsets will enter auto-pairing mode. The two headsets will connect with each other after few seconds and the main(right) headset flashes red and blue alternately, then open the phone's Bluetooth function to search "WA275ZB".

2



Pick up the two headsets from the charging base to power on. Two headsets will auto enter pairing mode. The two headsets will connect with each other after few seconds and the main(right) headset flashes red and blue alternately, and then open the phone's Bluetooth function to search "WA275ZB".

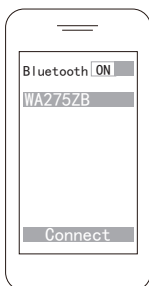

Cell phone begins to search for Bluetooth devices (see the user guide of your phone instructions), and select "WA275ZB" from bluetooth device list.

After connecting with the cell phone, the headsets will prompt "Connected".

## TWS Reconnected

**Method1:** Press and hold MFB of headset(R) or headset(L) for 2 seconds to power on→wait for few seconds, the two headsets connect automatically→the headset pair with the mobile phone that has ever paired→reconnected successfully.

**Method2:** Pick up the headsets from charging base to power on→wait for few seconds, the two headsets connect automatically→the headsets pair with the mobile phone that has ever paired after few seconds→reconnected successfully.

**Note:** The headset(R)(L) will prompt "power on", left headset prompts "left channel", the right headset prompts "right channel". After connected with mobile phone successfully, the right headset prompts "connected".

## Answer/End A Call

When call incoming, short press MFB of headset(R) or headset(L) to answer the call. In call mode, long press MFB of headset(R) or headset(L) to end the call.

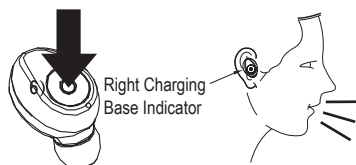

## Reject A Call



Press and hold MFB of headset(R) or headset(L) for 1 second to reject the call.

## Voice Dialing



On standby mode or music playing mode, long press MFB for 1 second to awake the voice dialing function, the headset prompts "Di".

**Note:** This feature only supports phone with voice dialing function.

## Music Pause/Playing



In standby mode, short press MFB of headset(R) or headset(L) to play music.

On music playing state, short press MFB of headset(R) to PAUSE music. This means that the headset(L) can not use independently.

## Volume +/-

In call mode or music playing mode, triple click on MFB of headset(R) to volume up, triple click on MFB of headset(L) to volume down.

## Pre/Next Song

In music playing mode, double click MFB of headset(R) to next song, double click MFB of headset(L) to previous song.

## Delete Pairing Records on the Headset

In OFF mode and earbuds are not in charging case, long press MFB of R and L for about 10 seconds until the blue indicator is on for 1 second.

## Maintenance

- Do not use abrasive cleaning solvents to clean the headset.
- Do not allow the headset to touch with any sharp objects as this will cause scratching and damages.
- Please keep headset away from high-temperature, humidity and dust.  
**Notice:**
  1. The headset (R) can not volume down and previous song when use singly.
  2. The headset (L) can not use independently.

## Trouble Shooting

Trouble	Reasons	Solutions
Can not turn on	low battery protection	Charging headsets for 1-2 hours
Cannot turn on by picking up the headset/No indicator light when headset being charged	Charging base low battery protection	Charging both the headsets and charging base for 1-2 hours
No sounds after pairing	Wrong pairing	Pairing again
The two headsets TWS pairing failure/TWS paired successful but can not find the headset(R)	Too many pairing records	Delete pairing records
Charging base without indicator light when charging	DC power supply doesn't output power	Check whether the micro USB charging line is plugged well or not
Headsets without indicator light when charging	The headsets couldn't being charged in charging base	1)Checking headset charging interface whether has touched to POGO PIN of charging base and the location is correct or not. 2)Charging for charging base
Turning off automatically	Low battery	Charging headset for 1-2 hours
Headset echo	Volume is too loud or environment is noisy	Adjust the volume at phone or change a place
Noise in call	Environmental interference caused or distance between headset and mobile is too far	Change a place or move the headset close to the mobile phone
Low voice of the calling party	Wearing headset is wrong	Adjusting wearing position of headset

**NOTE:** This equipment has been tested and found to comply with the limits for a Class B digital device, pursuant to part 15 of the FCC Rules. These limits are designed to provide reasonable protection against harmful interference in a residential installation. This equipment generates uses and can radiate radio frequency energy and, if not installed and used in accordance with the instructions, may cause harmful interference to radio communications. However, there is no guarantee that interference will not occur in a particular installation. If this equipment does cause harmful interference to radio or television reception, which can be determined by turning the equipment off and on, the user is encouraged to try to correct the interference by one or more of the following measures:

- Reorient or relocate the receiving antenna.
- Increase the separation between the equipment and receiver.
- Connect the equipment into an outlet on a circuit different from that to which the receiver is connected.
- Consult the dealer or an experienced radio/TV technician for help.

Changes or modifications not expressly approved by the party responsible for compliance could void the user's authority to operate the equipment.

This device complies with Part 15 of the FCC Rules. Operation is subject to the following two conditions:

- (1) this device may not cause harmful interference.
- (2) this device must accept any interference received, including interference that may cause undesired operation.

\* RF warning for Portable device:

The device has been evaluated to meet general RF exposure requirement. The device can be used in portable exposure condition without restriction.