

Inrico®

SINCE 2004

**GLOBAL WALKIE-TALKIE
IN TOUCH TIMELY EVERYWHERE**



T192

Instructions

Please read this instruction book carefully before use and keep this with care

Warning

- Flammable environment (gas, dust and fog, etc.)
- Please turn off the radio before getting close to the blasting zone or detonato handset.

General information before use

Please observe the following instructions to prevent fire, injury or damage to the handset.

- The recommended use pattern is 1 min of emission and 4 mins of receives. Constant emission over long time will cause over heat on the back side. Do not let the back touch any plastic surface when put it down.
- Prohibit to modify this product in any case.
- Please do not expose the handset to long-time direct sunlight, neither to close any heat source.
- Please do not expose the handset to dust, damp and spill. and over object that is unstable.
- If abnormal odor or smoke noted from the handset, please shut down immediately, remove the battery unit, and contact our local authorized service provider.

Contents

Unpacking and checking equipment	1
Accessories	1
Preparation work	1
Using the Lithium Battery	2
Feature of the Lithium battery	2
Charging for the Lithium battery	2
Operating instructions of battery charging	2
Installing accessories	3
Installing/Removing battery	3
Installing antenna	4
Installing belt clip	4
Installing sling	5
Installing headset	5
Knowing the device well	6
Unit structure	7
Volume selector/ON and OFF switch	7
Push To Talk button PTT	7
Session selector	7
Indicator lights status	7
Introduction	8
Installing SIM card	8
Basic use	8
Session selection	8
FAQ	9
Indicator light interpretation	10
Brief technical data	10

Unpacking and checking equipment

Note: following instructions is only suitable for authorized retailers and service providers. Carefully unpack the radio. We recommend you check the items listed in the following table before discarding the package. If any item is missing, please contact local dealer immediately.

Accessories:

Items	Number
Handset	1
Lithium battery	1
AC adapter	1
Antenna	1
Sling	1
Belt clip	1
Desktop charger	1
User manual	1

Preparation work

Warning

※ Do not overcharge with the battery

Please stop to charging if it is uncompleted in normal time. The battery may flame, smoke or crack due to abnormal charging process.

※ Do not put battery into the microwave or high pressure container

The battery may flame, smoke or crack.

※ Do not expose broken battery to any flame.

If the battery is seen broken (or with abnormal odor), please remove it from flammable condition immediately. The fluid in battery is really flammable, which may cause flame or smoke.

※ Do not use abnormal battery

If the battery is abnormal in odor, color, shape or any other form, please remove it from charger or radio and do not use it anymore.

※ Please use exclusive adapter

The adapter in accessories is designed exclusively for the bought radio. It ensures the safety and reliability of battery charging.

Using the Lithium Battery

Charge before use

To reduce electrical emission in battery, please remove the battery from device if not in use within a long time. Please keep the battery in cool and dry places. When keeping battery for a long time:

- 1、Remove battery from device;
- 2、If possible, please fully charge the battery before store;
- 3、Store the battery in places that are cool and dry (with the temperature lower than 25 Celsius);

Feature of the Lithium Battery:

- ※ After repeated charging process, the capacity will decrease.
- ※ The battery degenerates gradually even without being used.
- ※ More time will be required when Lithium battery is being charged in cool condition.
- ※ Charging and storage of Lithium battery in relatively warm condition will jeopardize its service life. Please do not keep them inside the vehicle or near heating equipment.
- ※ If the duration of battery shortens significantly, please replace the battery immediately to prevent fluid leak.

Charging Lithium battery

After the AC adapter is connected and the battery is well placed, the indicator will show red which means the charging is in progress. Green will indicate that the battery is fully charged. The indicator will go off if the temperature is not proper, or the battery is damaged or the connection is poor.

Operating instructions of battery charging

1. Plug the charger end of the power supply cord into the power receptacle located at the back of the charger.

Plug the wall receptacle end of the power supply cord into the appropriate AC outlet.

2. Insert a battery, or handset with battery (with the handset turned off), into the charger's pocket.

3. Charger indicator status:

- ※ Steady Red: Battery is being charged.
- ※ Steady Green: Battery has been charged completely.

4. After battery charged fully, remove the end of power supply cord from the outlet, and then remove the battery or handset from circuitthe charger.

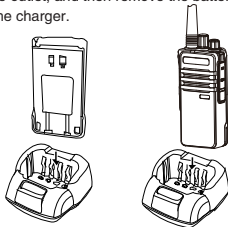

Installing accessories

Installing/Removing battery

- ※ Do not short circuit the battery terminal, or put the battery in fire.
- ※ Do not attempt to remove the shell of battery.
- ※ Do not install battery in any dangerous condition, since the possible flame may cause explosion.

To install the battery. Turn off the radio. Please make sure the bolt on the top of battery aim at the location hole on the top of aluminium plate. Fastening the battery latch as direction ① after pushing down battery to fit the radio. At last push to lock the battery as direction ② .

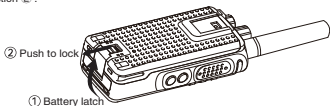

To remove battery. Turn off the radio and push to unlock battery as direction ①. Break apart out of aluminum plate naturally, and then take off the battery.



Installing antenna

Hold the antenna pedestal, revolve the antenna in clockwise until it is tightened.

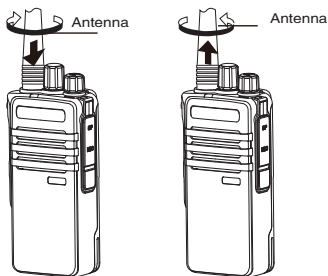

Installing belt clip

To install belt clip. Press the movable buckle on the top of the belt clip. Parallel push and make sure the belt clip slot aim at battery slot until hear the voice "click", Buckle locked. the belt clip installation finish.

To remove belt clip. Press the movable buckle, the other hand push up hard with propping the bottom belt clip ,belt clip remove.

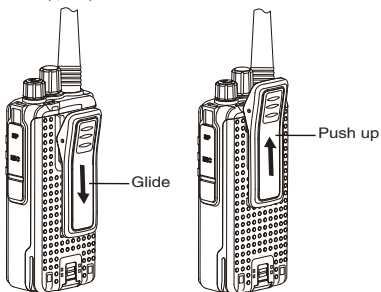

Installing sling

Take the tail of sling across the oval hole on the back of handset to install.

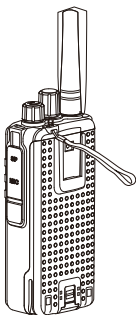

Installing headset

Open the cover from the top of device to show the headset sockets. Headset will work immediately after being plugged in.

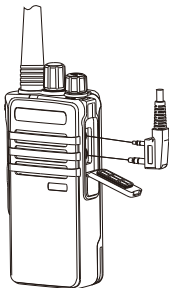

Knowing the device well

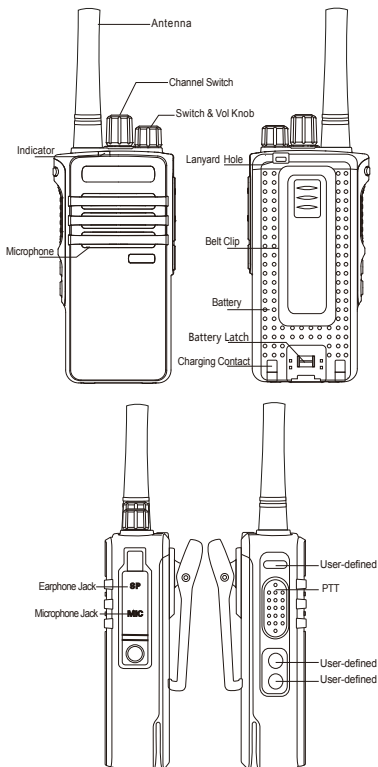

1.Volume selector/ ON/OFF switch

A: Clockwise for switch ON, counterclockwise for switch OFF.

B: Clockwise for volume UP, counterclockwise for volume DOWN.

2.Push To Talk button PTT

A: Press PTT button to initiate a call (red light goes on) when handset is standing by.

B: If not in reception, hold PPT to apply for turn to talk (red light goes on).

Release the PPT button to quit talk and go back to stand by.

3.Session selector

Revolve the selector for last/next session. And confirm to enter the current session with voice prompt.

4. Recorder playback/Individual call

Press to voice–play the last call. Hold for 3 seconds to enter a single call, then press to selecting member.

5.Indicator light status

The green light goes on after the device is switched on. The green light flashes fast to indicate network searching. In standing by, the green light flashes for every 5 seconds. The green light remains on for reception, and the red light remains on for emission.

1.Installing battery and SIM card

Please insert effective USIM card before use, make sure the USIM card can be effective in any selected WCDMA cellphone.

- (1)Revolve the volume button to switch ON/OFF device.
- (2)Remove the battery cover by pushing backwards.
- (3)Lift USIM socket cover, place the USIM card in the socket well in right direction.
- (4)Replace the battery and cover.

2.Basic use:

Switch ON: Revolve the volume button clockwise to switch ON device, there will be voice prompt for switch ON. After the device is successfully switched ON, the green light goes on first then flash to indicate network searching. After the network is connected, there will be voice prompt.

Switch OFF: Revolve the volume button counterclockwise to switch OFF device, the light will goes off.

Note: Do not frequently switch between ON and OFF, it may affect the switch function.

Volume adjustment: Revolve clockwise to volume UP, counterclockwise to volume DOWN.

Headset: Plug in headset, press the PPT button on headset if there is one to initiate a call, release the button to cancel the call.

Low battery notification: When the battery is lower than 10%, there will be voice prompt to indicate charging need.

3.Session selection:

Before switching ON, user needs to revolve the selector to Channel 1 (The default session is Channel 1, revolve to select other sessions. If the session is not available, there will be voice prompt: No Channel).

If your handset shows following problem in use, please check the instruction below, and if the issue still persists, please contact local authorized service.

1.Poor reception: Possible reasons: signal over your current location is weak (such as basement or next to a blocking building), or the network is busy (such as during rush hours).

Solutions: 1. Please move to somewhere with improved signal.

2: Please avoid using at that moment or wait for while before another attempt.

2.Echo or noise: Possible reason: the quality of network service provider is flawed. Solution: Restart the radio will let it automatically search for available network with better quality.

3.Less duration: Possible reasons: the duration depends a lot on the settings by network service provider. Using and charging the handset under condition with high temperature will also jeopardize the battery duration. Searching for network constantly in weak-network area will also lower the duration. Solution: if you are at place with weak signal, please temporarily switch OFF the handset.

4.Unable to connect to network: Possible reasons: USIM card not effective, poor signal, out of network service area.

Solutions: replace another USIM card, move to somewhere open and flat, if you are in the building , move near to the window.

Indicator light interpretation

Device Status	Indicator Status	Frequency
ON/Setting	Green on	
Searching for network	Green flashes fast	Flash every 1 sec
Standing by	Green flashes slow	Flash every 5 secs
Initiating call	Red on	
Receiving call	Green on	

Brief technical data

Voltage	3.7V
Frequency band	GSM900, DCS 1800, WCDMA Band I: 1920~1980MHz, WCDMA Band VIII: 880~915MHz
Size	56*35*112mm (width*length*height)
Weight	~300g
Working temperature	-10----+55celcius
Storage temperature	-40----+85celcius
Transmit power	23dBm ~ 30dBm@-104dBm
Receive sensitivity	WCDMA2100 : $\leq -106.7\text{dBm}$ WCDMA1900/900/850 : $\leq -107.5\text{dBm}$ GSM850/900/1800/1900 : $\leq -108\text{dBm}$
Sound output power	2W@10%distortion

FCC RF Exposure Information and Statement

This device meets the government's requirements for exposure to radio waves. The guidelines are based on standards that were developed by independent scientific organizations through periodic and thorough evaluation of scientific studies. The standards include a substantial safety margin designed to assure the safety of all persons regardless of age or health. The SAR limit of USA (FCC) is 1.6 W/kg averaged. This Device has also been tested against this SAR limit. SAR information on this and other pad can be viewed on - line at <http://www.fcc.gov/oet/ea/fccid/>. Please use the device FCC ID number for search. This device was test Body SAR with belt-clip 0mm and Front-of-face SAR with 25mm. To maintain compliance with FCC RF exposure requirements. The use of belt clips, holsters and similar accessories should not contain metallic components in its assembly. The use of accessories that do not satisfy these requirements may not comply with FCC RF exposure requirements, and should be avoided.

FCC Warning

This device complies with part 15 of the FCC Rules. Operation is subject to the condition that this device does not cause harmful interference.

NOTE 1: This equipment has been tested and found to comply with the limits for a Class B digital device, pursuant to part 15 of the FCC Rules. These limits are designed to provide reasonable protection against harmful interference in a residential installation. This equipment generates, uses and can radiate radio frequency energy and, if not installed and used in accordance with the instructions, may cause harmful interference to radio communications. However, there is no guarantee that interference will not occur in a particular installation. If this equipment does cause harmful interference to radio or television reception, which can be determined by turning the equipment off and on, the user is encouraged to try to correct the interference by one or more of the following measures:

- Reorient or relocate the receiving antenna.
- Increase the separation between the equipment and receiver.
- Connect the equipment into an outlet on a circuit different from that to which the receiver is connected.
- Consult the dealer or an experienced radio/TV technician for help.

NOTE 2: Any changes or modifications to this unit not expressly approved by the party responsible for compliance could void the user's authority to operate the equipment.

Professional In High Quality Two Way Radios

SHENZHEN INRICO ELECTRONICS CO.,LTD

www.inrico.cn

