

# BATTERY REPLACEMENT

---

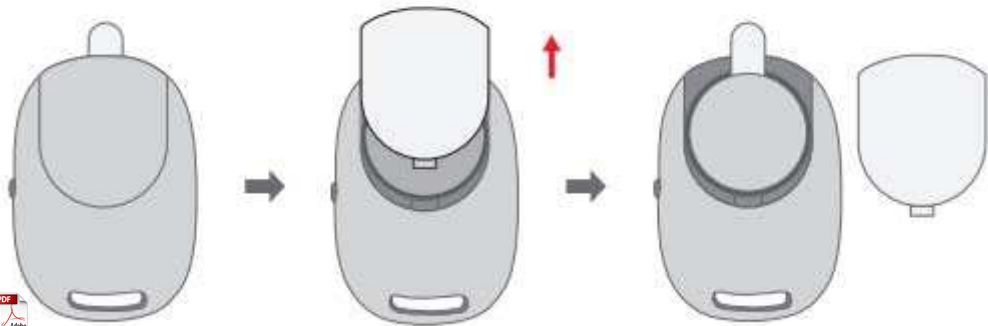

# BLUETOOTH CONNECTION

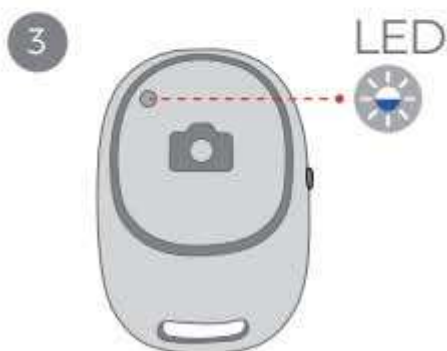
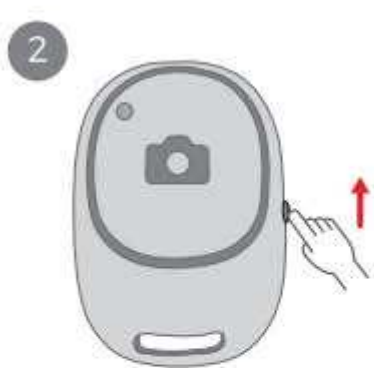
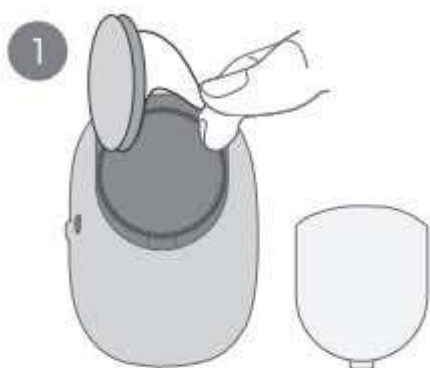

1. Turn the switch on the remote control to "On", and the blue light flashes to show that it enters the pairing mode.
2. Turn on Bluetooth on your phone and pair with "Mpow isnap X2". Once paired, the light turns off.

**Tips:** The battery can be replaced. No need to charge.



## NOTE

---

EN

1. Bluetooth pairing may fail when the battery of the remote control is running low.
2. The remote control works with smartphones ONLY.
3. Please set the Volume Button as the shutter on your phone first.
4. When the remote control is connected to the second mobile phone, please make sure that the last connected mobile phone is not within 10m/33ft or disconnected. (Bluetooth will automatically connect to the last connected phone)
5. If there is any problem with Bluetooth connection, please contact us at the first time and we will solve it for you.

## **FCC Warning**

This device complies with Part 15 of the FCC Rules. Operation is subject to the following two conditions:

(1) This device may not cause harmful interference, and (2) this device must accept any interference received, including interference that may cause undesired operation.

NOTE 1: This equipment has been tested and found to comply with the limits for a Class B digital device, pursuant to part 15 of the FCC Rules. These limits are designed to provide reasonable protection against harmful interference in a residential installation. This equipment generates uses and can radiate radio frequency energy and, if not installed and used in accordance with the instructions, may cause harmful interference to radio communications. However, there is no guarantee that interference will not occur in a particular installation. If this equipment does cause harmful interference to radio or television reception, which can be determined by turning the equipment off and on, the user is encouraged to try to correct the interference by one or more of the following measures:

- Reorient or relocate the receiving antenna.
- Increase the separation between the equipment and receiver.
- Connect the equipment into an outlet on a circuit different from that to which the receiver is connected.
- Consult the dealer or an experienced radio/TV technician for help.

NOTE 2: Any changes or modifications to this unit not expressly approved by the party responsible for compliance could void the user's authority to operate the equipment.