

XL Quick Start Guide

Start Here

Phone overview

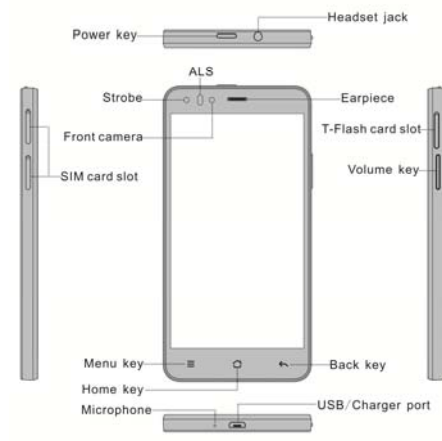

Getting started

To insert the SIM card and a microSD card please perform the steps shown in the following figures.

1. Open the SIM card slot

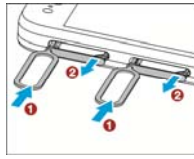

2. Install SIM card

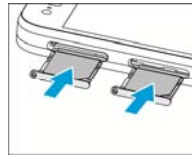

3. Open the memory card slot

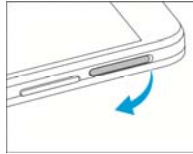

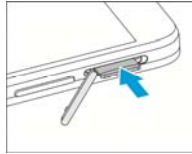

4. Install memory card



Buttons

Power key: To power off XL, press and hold power key for a few seconds, then tap the options to confirm. When XL is on, press the power key once to activate or deactivate the screen.

Home key (

Menu key (

Back key (

Screen

XL features a 5.0" high definition screen. Which make your phone looks fascinating.

Screen lock

You can increase the security of your phone by selecting screen lock .Screen lock settings can be found under "Settings">"Security"> "Screen lock".

Customize home screen

In standby mode, touch and hold an empty area to add set wallpapers. You can also remove items from the home screen, move items, add items to home screen to customize the home screen.

Camera

XL is equipped with 13.0MP camera and a camcorder, which are designed for you to share wonderful moments with friends and family.

Adjust focus, exposure, zoom in or zoom out, switch between cameras and switch between the functions by flipping the icon on the screen.

Internet

You can enjoy network by selecting 3G, WLAN, GSM. Enjoy music, videos, apps and news anywhere and anytime as you like.

Make a call

You can make a call under the interface of Call log, contacts, favorites, message (which contains a phone number). In standby mode, press call key to make a call.

Messaging

Touch and hold the text box to select an input method. You can insert picture, audio or video files and send to multiple recipients.

Email

The email app enables you to read, compose and send emails, and is configured to work with all the major email providers. XL supports multiple account mode, and you won't miss any email.

Videos

Enjoy a visual feast in a variety of video formats, please choose .

Photos

You will find it very easy to view all the photos. Flick right or left to move among images. Double-tap or pinch the photo to zoom. You can edit, share, print, and more.

Intelligent keyboard

XL automatically corrects and suggests words as you type, and it also supports voice input.

Cut, copy, and paste

Touch and hold text content to bring up the magnifying glass, and then slide your finger to move the insertion points. Then tap to cut, copy, or paste. It is very easy to copy text from web pages, email, or text messages.

Map

You can view satellite images or street map with detailed route instructions just as you are walking in the street. The Map app can be used to locate yourself, view real-time traffic conditions, pedestrian, bus routes or car driving route instructions.

FCC Caution.

§ 15.19 Labelling requirements.

This device complies with part 15 of the FCC Rules.

Operation is subject to the following two conditions: (1)

This device may not cause harmful interference, and (2)

this device must accept any interference received,

including interference that may cause undesired

operation.

§ 15.21 Information to user.

Any Changes or modifications not expressly approved

by the party responsible for compliance could void the

user's authority to operate the equipment.

§ 15.105 Information to the user.

Note: This equipment has been tested and found to

comply with the limits for a Class B digital device,

pursuant to part 15 of the FCC Rules. These limits are

designed to provide reasonable protection against

harmful interference in a residential installation. This equipment generates uses and can radiate radio frequency energy and, if not installed and used in accordance with the instructions, may cause harmful interference to radio communications. However, there is no guarantee that interference will not occur in a particular installation.

If this equipment does cause harmful interference to radio or television reception, which can be determined by turning the equipment off and on, the user is encouraged to try to correct the interference by one or more of the following measures:

- Reorient or relocate the receiving antenna.
- Increase the separation between the equipment and receiver.
- Connect the equipment into an outlet on a circuit different from that to which the receiver is connected.

-Consult the dealer or an experienced radio/TV technician for help.

Specific Absorption Rate (SAR) information:

This mobile phone meets the government's requirements for exposure to radio waves. The guidelines are based on standards that were developed by independent scientific organizations through periodic and thorough evaluation of scientific studies. The standards include a substantial safety margin designed to assure the safety of all persons regardless of age or health.

FCC RF Exposure Information and Statement

The SAR limit of USA (FCC) is 1.6 W/kg averaged over one gram of tissue. Device types: Instamatic (FCC ID: ZL5IM5) has also been tested against this SAR limit.

The highest SAR value reported under this standard during product certification for use at the ear is 0.429W/kg and when properly worn on the body is 1.18W/kg. This device was tested for typical body-worn operations with the back of the handset kept 10mm from the body. To maintain compliance with FCC RF exposure requirements, use accessories that maintain a 10mm separation distance between the user's body and the back of the handset. The use of belt clips, holsters and similar accessories should not contain metallic components in its assembly. The use of accessories that do not satisfy these requirements may not comply with FCC RF exposure requirements, and should be avoided.

Body - worn Operation

This device was tested for typical body-worn

operations. To comply with RF exposure requirements, a minimum separation distance of 10mm cm must be maintained between the user's body and the handset, including the antenna. Third-party belt-clips, holsters, and similar accessories used by this device should not contain any metallic components. Body-worn accessories that do not meet these requirements may not comply with RF exposure requirements and should be avoided. Use only the supplied or an approved antenna.

Contact Information

Company Name: Bullitt Group

Address: 4 The Aquarium, 1-7 King Street, Reading,
RG1 2AN, UK

Contact Person: Janelle Stoner

E-Mail: jlee@bullitt-group.com

