

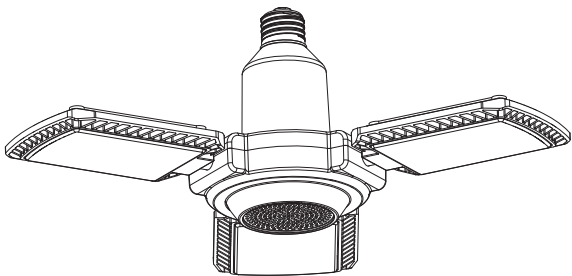

GV Garage Light with Speaker

VVenfor Stock Number: YGA99C14-40W-BL

Questions, Problems, Missing parts ?
Before returning to the store,
call Walmart’s Customer Service at:
1-833-908-2024



IMPORTANT: Please read this manual carefully and save it for reference.

01 WARNING AND SAFETY INFORMATION

READ ALL INSTRUCTIONS

- Suitable for damp location.
- Do not use with dimmers.
- Not for use in totally enclosed luminaire.
- Added weight of the device may cause instability of a free-standing portable luminaire.
- This device is not intended for use with emergency exits.
- Do not make or alter open holes in an enclosure of wiring or electrical components during kit installation.
- The retrofit kit is accepted as a component of a luminaire where the suitability of the combination shall be determined by authorities having jurisdiction.

Product must be installed by a qualified electrician in accordance with the applicable and appropriate electrical codes. The installation guide does not supersede local or national regulations for electrical installations.

WARNING: Risk of fire or electric shock. LED retrofit kit installation requires knowledge of luminaire electrical systems. If not qualified, do not attempt installation. Contact a qualified electrician.

WARNING: Risk of fire or electric shock. Install this kit only in luminaire that have the construction features and dimensions shown in the photographs and/or drawings and where the input rating of the retrofit kit does exceed the input rating of the luminaire.

WARNING: To prevent wiring damage or abrasion, do not expose wiring to edges of sheet metal or other sharp objects.

CAUTION:

Light is extremely bright. Avoid looking directly at LED's.

02 FCC STATEMENT

WARNING: Changes or modifications not expressly approved by the party responsible for compliance could void the user’s authority to operate the equipment. This device complies with part 15 of the FCC Rules. Operation is subject to the following two conditions:

- (1) this device may not cause harmful interference, and
- (2) this device must accept any interference received, including interference that may cause undesired operation.

02 FCC STATEMENT

Note: This equipment has been tested and found to comply with the limits for a Class B digital device, pursuant to part 15 of the FCC Rules. These limits are designed to provide reasonable protection against harmful interference in a residential installation. This equipment generates, uses, and can radiate radio frequency energy and, if not installed and used in accordance with the instructions, may cause harmful interference to radio communications. However, there is no guarantee that interference will not occur in a particular installation. If this equipment does cause harmful interference to radio or television reception, which can be determined by turning the equipment off and on, the user is encouraged to try to correct the interference by one or more of the following measures:

- Reorient or relocate the receiving antenna.
- Increase the separation between the equipment and receiver.
- Connect the equipment to an outlet on a circuit different from that to which the receiver is connected.
- Consult the dealer or an experienced radio/TV technician for help.

This equipment should be installed and operated with minimum distance 20cm between the radiator& your body. This transmitter must not be co-located or operating in conjunction with any other antenna or transmitter.

03 ELECTRICAL INFORMATION

FEATURES

- Rugged Plastic Lens
- Suitable for Damp Locations
- ETL Certified
- Equipment has been tested and found to comply with the limits pursuant to Part 15,Subpart B of the FCC Rules.

These limits are designed to provide reasonable protection against harmful electrical interference in a residential installation.

SPECIFICATIONS			
Model	YGA99C14-40W-BL	Rated Voltage	120V(60HZ)
Product Length	14.17"	Rated Power	40W
Product Width	14.17"	Lumen Output	3000Lumens
Product Height	5.281"	Color temperature	5000K

04 INSTALLATION INSTRUCTIONS

CAUTION: BEFORE BEGINNING INSTALLATION, TURN OFF THE CIRCUIT BREAKER AND LIGHT SWITCH.

1. INSTALLATION

- Carefully remove the utility light from the packaging. Check for any defects or damage.
- Installation: Screw utility light clockwise into E26 socket to tighten. Adjust fins as desired to direct light where needed. Fins can fold it up 90° rotate left and right 350°

NOTE: Be careful not to over-tighten.

- Restore power to the fuse box and turn the light switch on to activate the fixture.

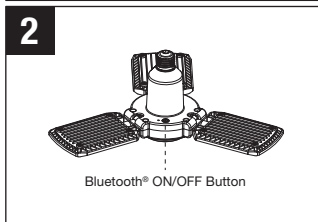
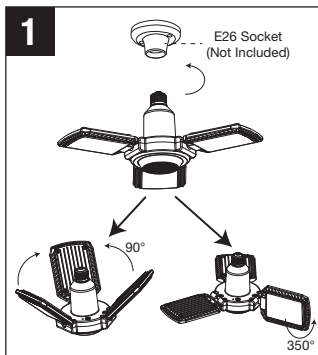

2. OPERATION

- Turn on the light switch, you will hear "Power on" and after 5 seconds you will hear "Pairing".
- Locate Bluetooth® settings on your Bluetooth® enabled device and find the device named "YGA99C14-40W-BL". Press to pair. You will then hear "You are now paired".
- Once paired, select audio from your Bluetooth® enabled device. Audio should play from YGA99C14-40W-BL speaker.
- Press Bluetooth® ON/OFF button quickly to pause or play music.
- Press Bluetooth® ON/OFF button for 2 seconds to turn off Bluetooth®.
- Maximum connection distance from Bluetooth® enabled device to YGA99C14-40W-BL within 49.2 feet (15m) in an open environment.

NOTE: Adjust the volume with your device.

04 INSTALLATION INSTRUCTIONS

Connect up to two YGA99C14-40W-BL linkable speakers to play the same music in will activate after turned on and within range of 1st speaker.

NOTE: Light will remain in last mode selected: Bluetooth® on or Bluetooth® off.

05 TROUBLE SHOOTING

PROBLEM	POSSIBLE CAUSE	CORRECTIVE ACTION
Light will not come on.	A. Light switch is turned off. B. The light is not properly installed. C. Fuse is blown or circuit breaker is turned off.	A. Check if the Power switch is set to ON. B. Make sure light is completely screwed into E26 base. C. Check if the GFCI has tripped. Check if the 120 Vac circuit breaker has tripped. Reset the GFCI or circuit breaker.
Sound will not play.	A. Bluetooth® not active or not close enough to device. B. Bluetooth® may be paired to wrong device. C. Device volume may be low or muted.	A. Ensure your device's Bluetooth® is turned on, in range and discoverable. B. Make sure you are selecting the correct device to pair to. C. Make sure your audio level is set appropriately.

06 WARRANTY

This security light is backed with a two-year limited warranty to the original purchaser. This warranty covers against defects in material and workmanship under normal use. This warranty does not cover against abuse, improper use, failure to follow directions, neglect, ordinary wear and tear.

"The Bluetooth® word mark and logos are registered trademarks owned by Bluetooth SIG, Inc. And any use of such marks by IDC is under license. Other trademarks and trade names are those of their respective owners."

NOTE:

The Bluetooth® brand elements may not be used in a fashion or manner that could impair or otherwise damage the goodwill associated with the Bluetooth® brand or the Fellow Adopters (IDC). The Bluetooth® brand elements shall therefore not be used in connection with products and services that do not enable any Bluetooth® wireless functionality or in connection with unlawful, obscene, pornographic, excessively violent, hazardous, or otherwise poor-taste activities.



120 volts | 40 watts | 5000k