



T100X series
Teclast power bank manual

1. Technical parameters

Thank you for purchasing Teclast product! The brief description of the product assures you to operate freely, fully embodies the value of this product, please read carefully before use.

1.1. Product appearance



1.2. Specifications (please refer to actual item)

- ◆ Product Model: T100X
- ◆ Battery type: original A + grade high density polymer batteries
- ◆ Capacity: 10000mAh
- ◆ Output: 5V/2.1A(MAX)
- ◆ Wireless output: 5V/1.0A(MAX)
- ◆ Input port: Micro
- ◆ Input parameters: Micro 5V/2.0A (MAX)
- ◆ Product color: White
- ◆ Size: 150*74*14.6mm
- ◆ Product weight: 240g

1.3. List of accessories

- ◆ Power bank 1
- ◆ USB Cable 1
- ◆ Manual 1



Please scan the QR code for detailed use instructions.

2. Power display

Indicator light:

- 1. Indicator light: There are 4 lights on the device to show the capacity.
- ○ " LED flashing " ○ " LED switch off " ● " LED lighting
- ○ ○ ○ Power bank will check and show the percentage of capacity when power on.
- 4 light stand for: 25% 50% 75% 100%

Charge the power bank	
Quantity of flashing	Indicator light
1	① ● ○ ○ ○
2	② ● ● ○ ○
3	③ ● ● ● ○
4	④ ● ● ● ●

The power bank is full charged when all the light is lighting.

Charge the devices			
Display	Indicator light	Capacity percentage	Note
None	○ ○ ○ ○	1%~5%	During discharging, LED lights decrease along with power reduction, and it will be turned off or the red light flashes when the remaining power is close to 5%.
1	● ○ ○ ○	5%~25%	
2	● ● ○ ○	25%~50%	
3	● ● ● ○	50%~75%	
4	● ● ● ●	75%~100%	

3. Charging instructions

3.1. Charge the power bank

- ◆ Connect the cable USB port to the charging device and the other end to the Micro input connector of power bank.
- ◆ After connecting, the power bank is automatically charged and the current power level on the battery status indicator flashes. When the battery is fully charged, the status indicator light will be on.

3.2. Charge digital equipment

- ◆ Check whether the charging voltage of the digital device matches the discharging voltage of the power bank.
- ◆ Select one matching charging cable, connect one end to the power bank output interface, the other end to the digital device, power bank will automatically recognize to charge digital device.

3.3. Wireless charge for digital equipment

- ◆ Pressing the start button to open wireless charging mode, the blue indicator light means it is working state, double-click the button to turn off the wireless charging function;
- ◆ Please place your mobile phones in the most central of the wireless charging circle to ensure the highest charging efficiency.
- ◆ Do not place metallic objects in the wireless charging range.

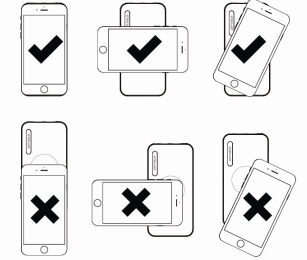

Charging digital products diagram

4. Cautions

- ◆ Please note the new power bank can only achieve its best performance after two to three times fully charge and discharge.
- ◆ Please extend the charging time for 1-2 hours in first three times in order to maximize the performance of lithium battery.
- ◆ Please do not try to disassemble and modify the product by yourself.
- ◆ Please avoid making physical damages on this product.
- ◆ Please avoid using this product in the following environments: high temperature, low pressure, low temperature, humidity, dust, magnetic field strong and long term exposure to sunlight. We recommend that you at an altitude of 3000 meters, 0° to 35° C and humidity of 5-95% of the environment using the product.
- ◆ This product must not be exposed to dripping and splashing water, also it should not be placed in the sauna next to items such as cups filled with liquid a class.
- ◆ Please only use the charger to charge the product which is comply with below specification, it might have safety issue if user uses the unsuitable charger to charge the product.
- ◆ Please follow the relevant local environmental regulations to dispose the product and accessories.
- ◆ Please contact with the local dealer or local customer service center if you have any questions.
- ◆ Product is subject to change without notification, please prevail in kind.

5. Tips

- ◆ If you do not use the power bank for a long time, we recommend you to fully charge the battery then placed it in the dry environment with temperature range from 5 - 35 °C , please avoid to directly expose the product in sunlight.
- ◆ Please fully discharge then perform full recharging if you have not use the power bank for more than three weeks or the battery life of the product becomes shorter.

6. Environmental Claims

Name and Content of Hazardous Substances						
Name	Pb	Hg	Cd	Cr(VI)	PBB	PBDE
Power bank	X	○	○	○	○	○
Accessories	○	○	○	○	○	○

○: Means the PH substances in the material is under the GB/T 26572 standard.
X: Means the PH substances is out of the GB/T 26572 standard.
Guangzhou Shengde Information Technology Limited Company
Address: 12 Floor 8&F To-win Building, No.30 Huaxia Road, Tianhe District Guangzhou
Web: http://www.teclast.com
TEL: 400-696-0606
E-Mail: fae@941999.com
Made in China



FCC Warning

This device complies with Part 15 of the FCC Rules. Operation is subject to the following two conditions:
(1) This device may not cause harmful interference, and
(2) This device must accept any interference received, including interference that may cause undesired operation.

NOTE 1:

This equipment has been tested and found to comply with the limits for a Class B digital device, pursuant to part 15 of the FCC Rules. These limits are designed to provide reasonable protection against harmful interference in a residential installation. This equipment generates, uses and can radiate radio frequency energy and, if not installed and used in accordance with the instructions, may cause harmful interference to radio communications. However, there is no guarantee that interference will not occur in a particular installation. If this equipment does cause harmful interference to radio or television reception, which can be determined by turning the equipment off and on, the user is encouraged to try to correct the interference by one or more of the following measures:
- Reorient or relocate the receiving antenna.
- Increase the separation between the equipment and receiver.
- Connect the equipment into an outlet on a circuit different from that to which the receiver is connected.
- Consult the dealer or an experienced radio/TV technician for help.

NOTE 2:

Any changes or modifications to this unit not expressly approved by the party responsible for compliance could void the user's authority to operate the equipment.

Safety Information for RF Exposure

The device should not be used next to the body.
This device is designed for desktop usage.
This device has been tested for compliance with RF exposure limits at 10 cm from User.

WARRANTY STATEMENT

Dear customer:
Thanks for your concern and purchase Teclast products, please call your local technical support center for help if you have any query when using Teclast power bank, or call Shanghai (400-696-0606) directly for after sales service.
Shengde provide one year warranty service according to the guarantees of repair, replacement and refund of substantial products policy. This limited warranty is subjected to the following terms and conditions.

— Change for New Service

Within one year after purchased, if you have encounter quality problem listed in the Fault List of Micro Computer Performance when using the product in normal conditions, and is within the quality warranty scope. The seller should provide corresponding service according to the guarantees of repair, replacement and refund of substantial products policy.

— Warranty Descriptions

Teclast will follow the warranty service to power bank and its accessories as below:
1. One year warranty for Teclast power bank. According to the warranty card with the device.
2. 15 days warranty for its data cable and plug adapter. According to the warranty card with the device, no warranty service for over 15 days.
3. Self 1 year warranty for its charger. Charge as an optional accessories is not included in each model, warranty according to the label on the charger, no warranty service for over half a year.
4. Limited Warranty does not apply to the accessories except the one listed as above, e.g., manual.

— Product damage or defects caused by the following conditions are not covered by this Limited Warranty

- ◆ Trade show products.
 - ◆ Over warranty period.
 - ◆ The physical damage is resulting from the use of the product in a manner other than their normal and customary manner: e.g. burst of power bank, USB port or cover, PCB burned etc.
 - ◆ The Product barcode number has been removed, erased, defaced, altered or is illegible.
 - ◆ Improper handling, neglect or failure to operate the unit in compliance with the instructions given in the manual. Or damage caused by any Act of God or Nature (such accident, fire, flood, etc.)
 - ◆ The damage caused by poor packing or improper handling in transportation during the defect product return to Shengde customer service center.
 - ◆ The damage caused by modification or repair by anyone other than third party.
- Remark: Shengde reserved the rights to identify the defect reason and the final explanation to above terms. Warranty service conditions are subject to change without notice.

Customer name: _____ TEL: _____ Address: _____
Product name: _____ Purchase date: _____ Numbrer: _____