

LISEN

Car Magnetic Wireless  
Charging Stand

>

2E749

EN

Thanks for choosing Lisen! To bring you a fantastic experience, please read the manual before using

## ACCESSORY LIST

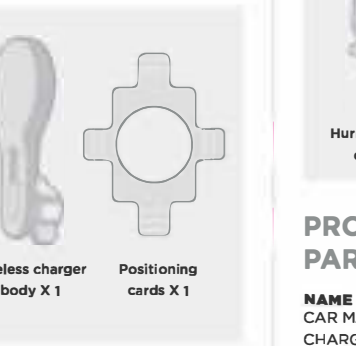

Wireless charger  
body X 1

Positioning  
cards X 1



Magnetic  
lead sheets X1

Protective  
film X 1

Hurricane outlet  
chuck X 1

Cleaning kit X 1

## PRODUCT PARAMETER

**NAME**  
CAR MAGNETIC WIRELESS  
CHARGING STAND

**MODEL**  
2E749

**MATERIAL**  
ABS/PC

**INPUT**  
5V=2A 9V=2A 12V=1.5A

**OUTPUT**  
5W/7.5W/10W/15W

**SIZE**  
60MM\*117MM\*35MM

**WEIGHT**  
165G

**APPLICABLE POSITION**  
AIR OUTLET

**SUPPORT BAR ADJUSTMENT STROKE**  
10MM

**HOOK TELESCOPIC STROKE**  
30MM

**OUTLET BLADE WIDTH**  
11-28MM

**THICKNESS OF AIR OUTLET BLADE**  
<4.5MM

## PRODUCT DESCRIPTION

1.The product is equipped with LED light ring, LED light source rotates around a circle when the power is turned on, the LED light is always on when the power is normally turned on.

2.Put into the mobile phone since the LED light effect off, take away the phone after the LED re-lighting,



## COMPATIBLE DEVICES

1.Headphones: Airpods pro (with magsafe battery compartment)/Airpods pro 2nd generation.

2.iphone 12/13/14 series bare phone /phone case with magsafe function /third party case without magsafe need to increase the magnetizer .

3. With wireless charging does not support magsafe mobile phones, need to use the magnetizer

4.Without wireless charging mobile phone, need to use the magnetizer (only the car mount function, no wireless charging function)

INSTALLATION STEPS FOR THE USE OF AIR OUTLET HOOK CLIPS.

Loosen the fixing nut in a counter-clockwise direction

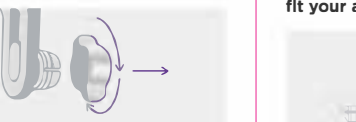

Insert the swivel ball into the bolt



Tighten the fixing nut

Turn the hook clip adjustment knob counter-clockwise to adjust the hook length to the maximum.



(1) If the support ring is obstructed, you can rotate the support ring to fit your air outlet.

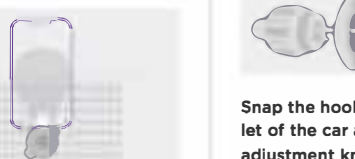

(2) If your air vent is small in size and it is inconvenient to install the support ring, you do not need to use the support ring. (When there is

no support ring in the attached picture)



Snap the hook clip into the air outlet of the car and turn the hook clip adjustment knob to lock the blade.

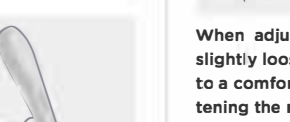

To remove, loosen the hook and clip adjustment knob and detach the holder from the blade. (The blades should be kept horizontal so that they are perpendicular to each other and to the surface of the air outlet)



When adjusting the angle of use, slightly loosen the nut and adjust it to a comfortable angle before tightening the nut.



Hint: The uneven surface of mobile phone cases, liquid silicone cases, oil-painted cases and fabric leather cases are not suitable for this magnetizer.



If your case does not have the magsafe function, please follow the steps below to attract the magnetic sheet to achieve the magnetic suction function first.

Place the magnetic plate locator on the back of the phone/case, aligning the edges of the phone to ensure

the top and bottom scale/left and right scales are the same; remove the protective film from the magnetic plate and stick it to the centre of the magnetic plate locator.

## INSTALLATION STEPS

Tutorial on the use of the lead magnet:

1.Open the tissue pack and wipe the back of the phone/case with a damp tissue first, then dry it with a dry tissue.

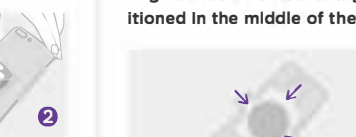

2.If the mobile phone (case) is made of glass or if you do not want to

stick the magnet attractor directly to the mobile phone (case), you can use the PE film first, peel off the PE film and stick it on the back of the mobile phone/case in the centre.

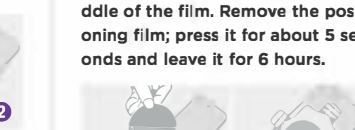

3.Place the film on the back of the phone. Observe that the positioning film has the same symmetrical edge to ensure that the ring is positioned in the middle of the phone.

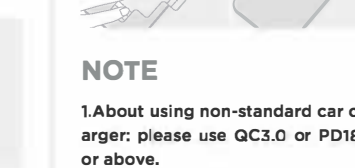

4.Remove the protective film from the back of the ring. Place the film in the middle of the case and press gently with your hand. Make sure that the ring is positioned in the middle of the film. Remove the positioning film; press it for about 5 seconds and leave it for 6 hours.

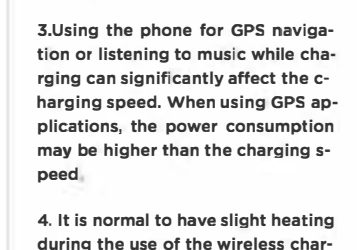

## NOTE

1.About using non-standard car charger: please use QC3.0 or PD18W or above.

## PRODUCT WARNINGS

This equipment generates, uses and can radiate radio frequency energy and, if not installed and used in accordance with the instructions, may cause harmful interference to radio communications. However, there is no guarantee that interference will not occur in a particular installation.

3.Using the phone for GPS navigation or listening to music while charging can significantly affect the charging speed. When using GPS applications, the power consumption may be higher than the charging speed.

4. It is normal to have slight heating during the use of the wireless charger, if you encounter serious heating, please suspend the use and contact our after-sales mailbox.

- Reorient or relocate the receiving antenna.  
- Increase the separation between the equipment and receiver.

- Connect the equipment into an outlet on a circuit different from that to which the receiver is connected.  
- Consult the dealer or an experienced radio/TV technician for help  
This equipment must be installed and operated with a minimum distance of 15 cm between the radiator and user body.