

85 mm

85 mm

Distributed by / Distribuido por:

Dongguan Tunno Electronics Technology Co., Ltd

Model No. / Modelo Núm.: 1212H

Version / Versión: 08/2022

FCC ID: 2AZUU-1212H

Made in / Hecho en: China

TRUE WIRELESS EARPHONES

STSK 2G8

(USEN)

TRUE WIRELESS EARPHONES

Operation and safety notes

IAN 392269_2201



IAN 392269_2201

(US)

Description of signal words	Page 5
Customer service	Page 5
Warning remarks and symbols used ...	Page 6
Introduction	Page 7
Intended use	Page 8
Trademark notices	Page 9
Scope of delivery	Page 10
You will need	Page 10
Description of parts	Page 11
Technical data	Page 13
IMPORTANT SAFETY INSTRUCTIONS ...	Page 15
Safety instructions for built-in rechargeable batteries	Page 25
Prior to first use	Page 30
Charging the charging/storage box battery .	Page 30
Charging the headphones	Page 32
Operation	Page 33
Charging/storage box	Page 33

EARPHONES	Page 34
Turning on the headphones	Page 34
Turning off the headphones	Page 34
Manually turning off the headphones	Page 34
LED status	Page 35
Pairing the headphones to each other	Page 35
Pairing the headphones with a Bluetooth device	Page 36
Reset	Page 38
Using the multi-function button (MF button) ..	Page 39
Voice control function with Siri / Google Assistant	Page 42
Optical sensor	Page 43
Changing ear cushions	Page 44
Cleaning and maintenance	Page 45
Storage	Page 45
Troubleshooting	Page 46
Disposal	Page 50
Three year limited warranty	Page 51

DESCRIPTION OF SIGNAL WORDS

⚠ WARNING

WARNING indicates a hazardous situation that, if not avoided, could result in death or serious injury.

⚠ CAUTION

CAUTION indicates a hazardous situation that, if not avoided, could result in minor or moderate injury.

NOTICE

NOTICE indicates information considered important, but not hazard related (e.g. messages related to property damage).

Warning remarks and symbols used

The following warnings are used in this manual:



⚠ WARNING EXPLOSION HAZARD!

A warning with this symbol and word "WARNING! EXPLOSION HAZARD" indicates the potential threat of explosion.

Failure to observe this warning may result in serious or fatal injuries and potential property damage.



- Follow the instructions in this warning to prevent serious injuries, danger to life or property damage!



This symbol reminds the user to wear suitable protective hand wear! Follow this warning to prevent hand injury by objects or contact with hot or chemical materials!



A warning with this symbol notifies the user of possible hearing damage. Avoid listening at excessive volumes for prolonged periods.

	Direct current/voltage
	<p>"Qi" and the Qi logo mark are trademarks of the Wireless Power Consortium (WPC).</p> <p>The charging box is built with Qi wireless charging technology. You can charge the charging box via Qi wireless technology.</p>
	This symbol means that the operating instructions must read be prior to using the product.

TRUE WIRELESS EARPHONES

● Introduction

Congratulations on your purchase. You have selected a quality product. The instructions for use are a part of the product. They contain important information about the safety, use and disposal of the product. Before using the product, please learn about all the safety information and usage instructions. Only use the product as described and for the specified applications. If you lend the product to someone else, please also give all the instructions.

● **Intended use**

These headphones are a consumer electronics device. The headphones are intended for playback of audio material via a Bluetooth® connection. If the headphones are connected to a smartphone, the headphones can also be used as a headset.

The charging and storage box is intended solely for charging and storing the headphones.

The product is intended for private use only.

Any other use beyond what is specified is not intended. Do not use the product for industrial or commercial purposes.

Any claims for damages resulting from unintended use, improper repairs, unauthorized modifications, or the use of unapproved replacement parts are excluded. The user carries the sole risk.

● **Trademark notices**

- USB® is a registered trademark of USB Implementers Forum, Inc.
- The Bluetooth® word mark and logos are registered trademarks owned by Bluetooth SIG, Inc. and any use of such marks by Dongguan Tunno Electronics Technology Co., Ltd is under license.
- “Qi” and the Qi logo mark are trademarks of the Wireless Power Consortium (WPC).
- The SilverCrest trademark and trade name is the property of their respective owners.

Any other names and products may be trademarks or registered trademarks of their respective owners

● **Scope of delivery**

After unpacking the product, check if the delivery is complete and if all parts are in good condition. Remove all packaging materials before use. If you notice any damage or missing parts, please contact the dealer where you purchased this product.

- 2x Headphones (1x left and 1x right)
- 1x Charging/storage box
- 1x USB cable (type A to C)
- 2x Ear cushions – large
- 2x Ear cushions – medium (preinstalled)
- 2x Ear cushions – small
- 1x Quick start guide
- 1x Instruction manual

● **You will need**

- USB voltage source (output voltage 5 V, min 400 mA output current) or a Qi-enabled charger with an output power of at least 2.5 W
- Bluetooth®-capable playback device

● Description of parts

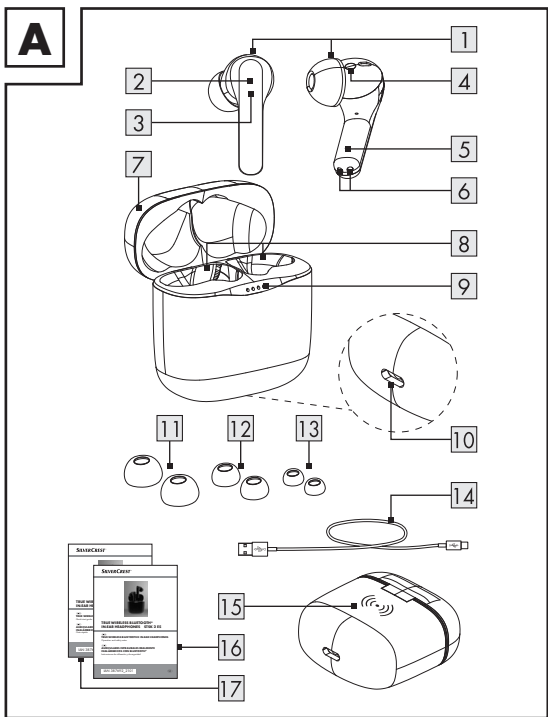

Before reading, unfold the page containing the illustration and familiarize yourself with all functions of the product.

- 1 Headphones (1x left and 1x right)
- 2 LED
- 3 Multi-function button (MF button)
- 4 Optical sensor
- 5 Microphone
- 6 Charging contact pins
- 7 Charging/storage box
- 8 Charging ports
- 9 Charging status indicator
- 10 USB-C charging port
- 11 Ear cushions - large
- 12 Ear cushions - medium
- 13 Ear cushions - small
- 14 USB cable (type A to C)
- 15 Qi reception area
- 16 Instruction manual
- 17 Quick start guide

● **Technical data**

Charging/storage box

USB-C input voltage	USB 5 V ===
USB-C input current	400 mA
Qi wireless input voltage	5 V
Wireless charging power	2.5 W
Wireless charging distance to the Qi charger	≤ 0.2 in (5 mm)
Frequency band	128 – 181 kHz
Transmitted maximum radio frequency power (H-field)	-13.42 dBμA/m at 10 m distance
Rechargeable battery	Li-ion, 3.7 V, 400 mAh, 1.48 Wh
Charging capacity	up to 4 complete charge cycles for fully discharged headphones
Charging time of the charging/storage box's built-in battery	3 hours (complete charging cycle)
Protection class	IPX0

Headphones

Wireless standard	Bluetooth® 5.0
Supported profile	A2DP, AVRCP, HSP, HFP
Frequency band	2402 to 2480 MHz
Max. transmitted power	3.85 mW
Range	32 ft (10 m)
Rechargeable battery	Li-ion, 3.7 V, 40 mAh, 0.15 Wh
Charging time	1.5 hours (complete charging cycle)
Operating time (music & phone)	4.5 hours (at medium volume)
Protection class	IPX4
Operating temperature	+50 to +95 °F (+10 to +35 °C)
Humidity (no condensation)	10 to 70 % relative humidity
Storage temperature	+32 to +104 °F (0 to +40 °C)
Dimensions (headphones)	0.83 x 0.88 x 1.52 in (21 x 22.3 x 38.6 mm)
(charging box)	2.14 x 2.05 x 1.06 in (54.3 x 52 x 27 mm)
Weight (both headphones)	0.32 oz (9 g)
(charging box)	1.23 oz (35 g)

NOTICE Qi technology:

This product with wireless Qi charging technology is designed to comply with the Qi (Wireless Power Consortium) standard, but no guarantees are given for its compatibility with all products that comply with the standard.

The specification and design may be changed without notification.



IMPORTANT SAFETY INSTRUCTIONS

**READ ALL INSTRUCTIONS. KEEP FOR
FUTURE REFERENCE. INCLUDE ALL
DOCUMENTATION WHEN PASSING
THIS PRODUCT ON TO OTHERS.**

⚠ WARNING

Failure to observe the following warnings can result in death or serious injury.



DANGER TO LIFE AND RISK OF ACCIDENT FOR INFANTS AND CHILDREN!

Suffocation hazard! Never leave children unsupervised with the packaging materials. The packaging materials pose a suffocation hazard. Children frequently underestimate the dangers. The packaging materials are not a toy.

This product is not intended for use by persons (including children) with reduced physical, sensory, or mental capabilities or lack of experience and knowledge, unless they have been given supervision or instruction concerning use of the product by a person responsible for their safety. Children should be supervised to ensure that they do not play with the product.

Changes or modifications to this product not expressly approved by the party responsible for compliance could void the user's authority to operate the product.

NOTICE

This product has been tested and complies with the limits for a Class B digital device, pursuant to Part 15 of the FCC Rules.

These limits are designed to provide reasonable protection against harmful interference in a residential installation.

This product generates, uses, and can radiate radio frequency energy and, if not installed and used in accordance with the instructions, may cause harmful interference to radio communications.

However, there is no guarantee that interference will not occur in a particular installation.

If this product causes harmful interference to radio or television reception, which can be determined by turning the product off and on, the user is encouraged to try and correct the interference by one or more of the following measures:

- Reorient or relocate the receiving antenna.
- Increase the separation between the product and receiver.
- Connect the equipment to an outlet on a different circuit than the one the receiver is connected to.
- Consult the dealer or an experienced radio/TV technician for help.

- This product complies with Part 15 of the FCC Rules. Operation is subject to the following two conditions:
 - (1) This product may not cause harmful interference, and
 - (2) This product must accept any interference received, including interference that may cause undesired operation.

- **Wireless interference**

Turn the device off on airplanes, in hospitals, service rooms or near medical electronic systems. The wireless signals transmitted could impact the functionality of sensitive electronics.

Keep the device at least 7.874 in (20 cm) from pacemakers or implantable cardioverter defibrillators as the electromagnetic radiation may impair the functionality of pacemakers. The radio waves transmitted could cause interference in hearing aids. Do not place the device near flammable gases or potentially explosives areas (e.g. paint shops) with the wireless components on as the radio waves emitted can cause explosions and fire. The range of the radio waves varies by environmental conditions.

In the event of wireless data transmission, unauthorized third parties receiving the data cannot be excluded. Tunno is not responsible for interference with radios or televisions due to unauthorized modification of the device. Tunno further assumes no liability for using or replacing cables and devices not distributed by Tunno. The user of the device is fully responsible for correcting interference caused by such unauthorized modification of the device as well as replacement of such devices. The RF exposure compliance distance is 5 mm.

NOTICE

This product does not contain any parts which can be serviced by the user. The rechargeable battery cannot be replaced.

⚠ WARNING

Failure to observe the following warnings may result in death or serious injuries.

- Do not place burning candles or other open fire on or next to the product.
- If you notice smoke or unusual noise or odor, switch the product off immediately and remove the USB cable.
- Do not throw the product into fire or expose it to high temperatures.

- Do not cover the product during use or charging.
- Only charge the battery in dry environments, since the product is not splash-proof.

NOTICE

- Check the product before every use! Discontinue use if any damage to the product or the charging cable is detected!
- Sudden temperature changes may cause condensation inside the product. In this case, allow the product to acclimate for some time before using it again to prevent short circuits!

- Do not operate the product near heat sources, e.g. radiators or other devices emitting heat!
- Do not try to open the product! It has no internal parts requiring maintenance.



Safety instructions for built-in rechargeable batteries

⚠ WARNING

Failure to observe the following warnings may result in fatal or serious injuries.

- **DANGER TO LIFE!** Keep batteries / rechargeable batteries out of reach of children. If accidentally swallowed, seek immediate medical attention.

- **DANGER OF EXPLOSION!**



- Never recharge disposable batteries. Do not short-circuit batteries / rechargeable batteries and/or open them. They may overheat, ignite, or explode.
- Never throw batteries / rechargeable batteries into fire or water.
- Do not exert mechanical loads on batteries / rechargeable batteries.

- Batteries should not be disassembled, crushed, punctured, opened, or otherwise mutilated.

Risk of battery leakage

⚠ CAUTION

Failure to observe the following warnings may result in injuries or property damage.

- Avoid extreme environmental conditions and temperatures which could affect batteries / rechargeable batteries, e.g. radiators / direct sunlight.

- Avoid contact with the skin, eyes and mucous membranes. In the event of contact with battery acid, thoroughly flush the affected area with plenty of clean water and seek immediate medical attention.

-  **WEAR PROTECTIVE GLOVES!** Leaked or damaged batteries / rechargeable batteries can cause burns on contact with the skin. Wear suitable protective gloves at all times if such an event occurs.

- This product contains an integrated battery which cannot be replaced by the user. The battery may only be removed or replaced by the manufacturer or its customer service or by a similarly qualified person in order to avoid hazards.

SAVE THESE INSTRUCTIONS

● **Prior to first use**

Remove the protective foil between the headphones [1] and the charging/storage box [7].

● **Charging the charging/storage box battery**

Before first use, the charging/storage box battery must be charged.



Charging via USB



- Connect the charging/storage box [7] via the USB-C charging port [10] and the included USB cable [14] with a USB voltage source with an output current of at least 400 mA (e.g. a USB charger or a computer).

Qi wireless charging

- Place the Qi reception area [15] of the charging/storage box [7] on your Qi charger.
- Charging starts automatically when the Qi wireless charger is switched on.
- When charging is completed, the 4 charging status indicators [9] light up.

NOTICE

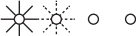
- The charge status is shown via the charging status indicator  on the charging/storage box .

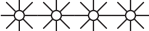
LEDs	Battery charge status
	< 25%
	< 50%
	< 75%
	< 100%
	100%

● Charging the headphones

Before first use, the headphones must also be charged.

NOTICE

- The headphones [1] and the charging/storage box [7] can be charged simultaneously.
- The headphones only fit into one of the charging ports [8] respectively.
- Insert the headphones in the charging ports [8] of the charging/storage box [7].
- Close the cover of the charging/storage box [7].
- Charging begins automatically.
- After approx. 1.5 hours both headphones [1] are fully charged.

● **Operation**





● **Charging/storage box**

- The headphones [1] begin charging automatically when at least one headphone is inserted into a charging port [8] and the cover of the charging/storage box [7] is closed.

- Checking current battery capacity status of the charging/storage box [7]:

Open or close the cover of the charging/storage box [7] to activate the charging status indicator [9].

The current battery capacity status is indicated by the charging status indicator [9] on the charging/storage box:

LED	Battery status
 ○ ○ ○	≤ 25%
 ○ ○	≤ 50%
 ○	≤ 75%
	≤ 100%

● **Earphones**

● **Turning on the headphones**

- To turn on the headphones, remove them from the charging ports [8].

● **Turning off the headphones**

- To turn off the headphones, insert the headphones in the charging ports [8] of the charging/storage box [7].

● **Manually turning off the headphones**

- To save energy, the headphones turn to OFF mode automatically when they receive no signal or cannot pair for 5 minutes.
- Turning the headphones to OFF mode manually: In paired mode, press and hold the MF button [3] for 5 seconds. When the headphones are paired to each other, this turns both headphones to OFF mode. The Bluetooth connection is ended automatically.
- Briefly press the MF button [3] for 3 seconds to power on the headphones again. **A signal sounds once the headphones are paired to each other.**

● LED status

LED	Status
Flashes red/white	Waiting for Bluetooth device to pair
Flashes white	Headphones paired with Bluetooth device

NOTICE If the headphones have already been paired to each other, the right headphone is already connected to the left and flashes white only.

● Pairing the headphones to each other

To hear sound through both headphones in stereo, they must be paired to each other.

- When you remove the headphones from the charging ports **8**, they automatically pair.
- If the headphones do not pair to each other, reset them to the default settings (see “Reset”).

- When the headphones are paired to each other and are awaiting connection to a Bluetooth device, the **primary** headphone flashes red/white and the **secondary** headphone white only.

NOTICE The **secondary** headphone connects to the **primary** headphone only. The **primary** headphone connects to the Bluetooth device.

● Pairing the headphones with a Bluetooth device

- Remove the headphones from the charging ports .
- When the headphones are ready to pair, the indicator LED on the primary headphone flashes red/white.

NOTICE

- If the headphones have already been paired to each other, the secondary headphone is already connected to the primary headphone and flashes white only.
- A signal sounds once the headphones are paired to each other.

Alternatively, use the Hall Switch function to pair up the headphones **1**:

- With Hall Switch, the recognition and synchronization between the headphones **1** takes place directly after opening the charging/storage box **7**.
- When the headphones **1** are ready to pair, the indicator LED **2** on the primary headphone flashes red/white after opening the charging/storage box **7**. The secondary headphone automatically connects to the primary headphone and flashes white only when the cover of the charging/storage box is opened.
- On your Bluetooth playback device, search for a product named **STSK 2 G8** and pair with the product. If your Bluetooth device prompts you to enter a password, enter **0000**.

● Reset

To reset the headphones [1], follow below steps:

- Deactivate the Bluetooth connection on your playback device to disconnect the headphones [1] from your playback device. Follow the user manual of your playback device.
- Reset the left and the right headphone [1]:
 - Remove one of the headphones (left or right) from the charging/storage box [7].
Press the MF button [3] 3 times in quick succession until the LED [2] briefly flashes red/white.
Insert the previously removed headphone back into the charging/storage box [7] to complete the reset.
 - Remove the other headphone from the charging/storage box [7].
Press the MF button [3] 3 times in quick succession until the LED [2] briefly flashes red/white.
Insert this headphone back into the charging/storage box [7] to complete the reset.
- Both headphones [1] are now successfully reset.

NOTICE

- A signal sounds once the headphones are disconnected from each other.
- After the headphones have been reset, the Bluetooth connection to the playback device needs to be restored (see "Pairing the headphones with a Bluetooth device").

● Using the multi-function button (MF button)

Use both multi-function buttons **3** on the headphones **1** to operate the various call and playback functions.

The following table describes the operation in combination with a paired smartphone. Due to different software statuses and software versions, not all functions may be available.

MF button 3	Call functions	Signal tone
Press 1x	Accept call	2
	End call	1
Press right MF button 2x	Redial	1
Press and hold for 2 seconds	Reject call	1
Press 1x	End the current call and answer call waiting*	2
Press and hold for 2 seconds	Switch between 2 calls (toggle)*	-

MF button 3**Playback functions**

Press **1** x

Pause/playback

Press and hold
right MF button
for **2** seconds

Start next track

Press and hold
left MF button
for **2** seconds

Play current track from beginning

**Press and hold
left MF button
for 2 seconds, release,
then press and hold for
2 seconds again**

Back to previous track

**Press left MF button
2 x in quick succession
(double click)**

Activate voice assistant

NOTICE

- * These functions must be supported by your mobile service provider.
- **The ring tone (or the voice announcement “Incoming call”, depending on your phone) and the caller’s voice are rendered through the speakers of the headphones 1.**

- The microphone **5** captures your voice.
- Music playback is automatically paused when a call is received. Music continues after the call has been ended.

● Voice control function with Siri / Google Assistant

- Activate Siri or Google Assistant on your mobile device.
- **iOS:** Complete the Siri setup. Then use Siri to activate this product's voice control function.
- **Android:** Open Google Assistant. Follow Google Assistant's instructions to complete setup before using this product's voice control function.

NOTICE Google Assistant is available on devices with Android 5.0 or above.

- Activate the Bluetooth function. Pair this product with your mobile device.
- Press the left MF button **3** twice in quick succession to activate the voice control function. Now you can use the voice control function.

● Optical sensor

B

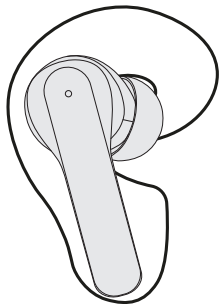

- Both headphones **1** are equipped with an optical sensor **4**.
- When you remove a headphone **1** from your ear, the audio playback will be paused.
- When you insert the headphone **1** back into your ear, the audio playback will continue automatically.

● Changing ear cushions

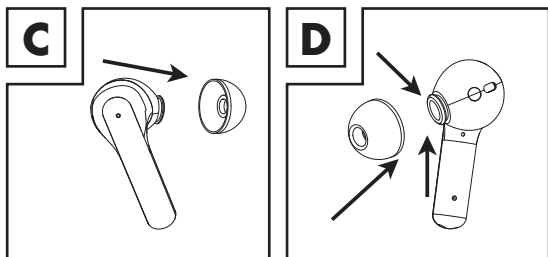

Before changing the ear cushions: Power off the product.

- Remove the medium size ear cushions **12** from the headphones **1** (Fig. C).
- Select the small or large size ear cushions **11** **13** and push them onto the headphones **1** (Fig. D).

● **Cleaning and maintenance**

⚠ CAUTION

Potential damage to the product!

- Switch the product off and remove all plugs before cleaning!
- Be sure moisture does not enter the product during cleaning to prevent damage to the product and related repairs.
- The ear cushions [11], [12] and [13] can be removed from the headphones [1] for cleaning. Clean the ear cushions under running water. Let the ear cushions dry completely, before you fit the ear cushions.
- Only clean the product with a slightly dampened cloth and a mild cleaning agent!
- Do not use any abrasive, aggressive cleaners to clean the product.

● **Storage when not in use**

- Store the product in a dry environment, protected from dust and direct sunlight.
- Store the headphones in the charging/storage box [7].
- Prolonged storage: To prevent battery deterioration, the rechargeable battery has to be charged at least once every 12 months.

● **Troubleshooting**

● = **Error**

⊙ = Possible cause

○ = Action

● = **No functions**

⊙ = Battery drained.

○ = Recharge the battery as described in "Charging the charging/storage box battery".

● = **No Bluetooth connection**

⊙ = Error operating the headphones.

○ = Switch the headphones off and on again.

⊙ = Bluetooth device error.

○ = Separate the connection to the headphones.
Reconnect.

○ = Check if the headphones work in combination with
another Bluetooth device.

⊙ = Bluetooth connection error.

○ = Move closer to the device connected via Bluetooth.

● = **No sound**

⦿ = Error operating the Bluetooth device.

○ = Increase the volume on the playback device.

⦿ = Bluetooth connection error.

○ = Move closer to the device connected via Bluetooth.

○ = Disconnect the Bluetooth devices. Reconnect.

● = **Not all functions are available.**

⦿ = Error with Bluetooth device.

○ = Check whether your Bluetooth device supports all functions.

● = **Qi wireless charging of the charging/
storage box 7 does not start.**

⦿ = The charging/storage box 7 has become warm as a result of charging.

○ = Remove the charging/storage box 7 from the Qi charging surface to let it cool. Check if the product is damaged.

⦿ = This product is in a location where strong radio waves or noise is being generated such as TV towers, electric power plants, or gas stations.

○ = In these environments, use other output ports such as a USB type C port for charging the charging/storage box 7.

● = **Error operating the product.**

⦿ = The optical sensor of the product has separated music playback.

○ = Replace the ear cushions [11], [12] and [13]. Use different ear cushions if necessary.

● = **Wireless charging does not start.**

⦿ = The charging/storage box [7] is not placed at the center of the Qi mark location of the Qi wireless charger.

○ = Make sure the charging/storage box [7] is placed at the correct position at the center of Qi wireless charger.

○ = Make sure that there are no other objects on the wireless Qi reception area [15].

● = **The wireless charging speed is slow.**

⦿ = The wireless Qi reception area [15] is too far away from the center of the Qi wireless charging surface.

○ = Make sure the wireless Qi reception area [15] is placed at the correct position at the center of the Qi wireless charging surface.

- = **Charging does not start even after the product has been placed in the charging area.**
- ◎ = The product has not been positioned correctly.
- = Position the product near the Φ mark in the center of the charging area. Before starting with wireless charging, read the instructions provided with the Qi wireless charger as well.

● **Disposal**

Dispose of the packaging through your local recycling facilities and in compliance with all federal, state and local regulations.



Please note the package markings regarding waste separation, indicated by abbreviations (a) and numbers (b), meaning: 1–7: plastics / 20–22: paper and cardboard / 80–98: composite materials.



Contact your local waste management authority for additional information on how to dispose of the used product.

To help protect the environment, please dispose of the product properly when it has reached the end of its useful life, do not throw in the garbage. Information on collection sites and their opening hours is available from your local authority.



Improper disposal of batteries can damage the environment!

Never throw batteries in the garbage. They may contain toxic heavy metals and must be handled as special waste. The chemical symbols of heavy metals are: Cd = cadmium, Hg = mercury, Pb = lead. Used batteries should therefore be disposed of through a local collection point.

● Three year limited warranty

What does this warranty cover?

The warranty covers:

- Damage, breakage or inoperability due to defect.
- Damage not caused by normal wear and tear or failure to follow the safety and maintenance instructions provided in the user manual.

What is not covered by the warranty?

The warranty does not cover damage caused by:

- Normal wear and tear of the product, including fragile parts (such as switches, glass, etc.);
- Improper use or transport;
- Disregarding safety and maintenance instructions;
- Accidents or acts of nature (e.g. lightning, fire, water, etc.).
- Tampering with the product (such as removing cover, unscrewing screws etc.)

Consequential and incidental damages are also not covered under this warranty. However, some states do not allow the exclusion or limitation of incidental or consequential damages, so this limitation or exclusion may not apply to you.

What is the period of coverage and warranty resolution?

The warranty is for 3 years from the date of purchase. At our discretion, product will either be refunded or replaced.

What will we not do?

We will not:

- Start a new warranty period upon product exchange;
- Repair product.

How to process the warranty?

To initiate, please:

- Call customer service at 1 (844) 543-5872
- Visit the Website Customer Service Platform at www.tunnocom/contact-us
or
- Visit a TUNNO store for further assistance

To ensure the quickest warranty return process, please have the following available:

- The original sales receipt that includes the date purchased;
- The product and manual in the original package;
- A statement of the problem.

What must you do to keep the warranty in effect?

- Retain the original receipt;
- Follow all product instructions;
- Do not repair or modify the product.

How does state law relate to this warranty?

This warranty gives you specific legal rights, and you may also have other rights which vary from state to state. All implied warranties are limited by the duration and terms of this warranty. Some states do not allow limitations on how long an implied warranty lasts, so the above limitation may not apply to you.

● **Simplified EU declaration of conformity**

Hereby, Dongguan Tunno Electronics Technology Co., Ltd, Room 201, 2nd Building, No. 153 Wenzhou Road, Dongcheng Street, Dongguan, Guangdong declares that the product TRUE WIRELESS EARPHONES, 1212H, is in compliance with Directives 2014/53/EU and 2011/65/EU.

The full text of the EU declaration of conformity is available at the following internet address:
www.owim.com