

# Q1

## Cell phone holder with Wireless Speaker and Clock

### USER MANUAL

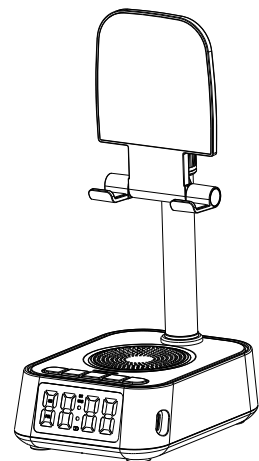

Before using the multi-function device, please read the instructions carefully and operate it in strict accordance with the instructions.

### Product Features

1. With phone stand, free your hands.
2. Wireless speaker phone for conference calls.
3. Led digital clock.
4. Built in lithium battery, easy to carry.

### What's included

- Q1 Main Unit ——— ①      Stretch bracket ——— ①  
USB Charging Cable — ①      User Manual ——— ①

### Details about Buttons

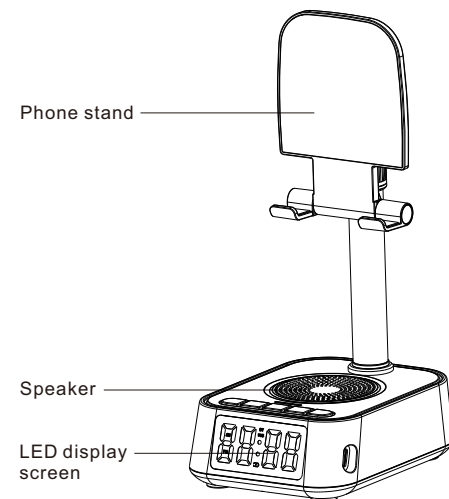

-1-

### Top

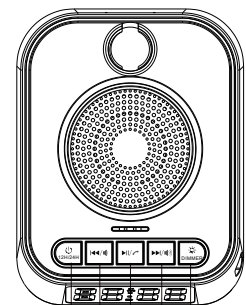

- Power/  
12h-24h      Light/  
Dimmer  
Previous  
track/Vol-      Next track  
Vol+  
Play /Pause  
Answer the phone

### Bottom

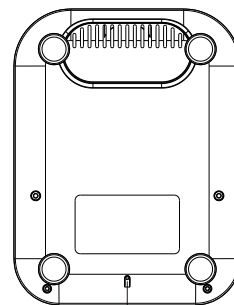

Mic

### Right

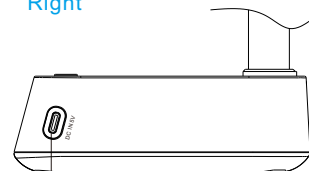

Type-C (DC IN 5V)

-2-

### Getting Started

Please read this product manual carefully before using this product.

1. Open the package, take the product out of the box, and open the mobile phone support frame.
2. Long press the POWER button and the power of speaker will be turned on and the LED screen will light up simultaneously.

3. Wireless connection and playback  
Long press the POWER button to turn on the speaker, then the LED screen lights up and the BT symbol on the LED screen flashes. Using the Wireless function of mobile phone to search the Wireless device of the audio and connect it(the device model is Q1). The wireless speaker will voice prompt when wireless device is connected successfully. It indicates the Wireless link is successful, Turn on the phone's music player, and the speaker can play the phone's music through Wireless signal.

\* After connecting to the Wireless for 20 minutes without any operation, the Wireless will automatically disconnect and require a restart of the machine to reconnect.

### 4. Playing Music

In the process of playing music, Press once ◀▶ / ▶▶ / ▶▶ to control previous song, next song and play/pause respectively. Long Press ◀ / ▶ to decrease or increase volume.

5. Press once ▶▶ to answer the call comes in.

6. Long press ☀ to turn on or off the ambient light (Speaker position).

-3-

### 7. Time setting

When the phone is wirelessly connected to the speaker, time will automatically synchronize to the speaker. The update time will be displayed on the LED screen.

### 8. 12H/24H setting

Long press the 12H/24H button to switch the 12 hour and 24 hour modes.

In the 12 hour mode, the LED screen will display AM or PM symbols.

### 9. Battery charging

In use, when the battery is low, the speaker will display a beeping low voltage prompt, and the ⚡ will flash. At this time, it is necessary to charge the speaker in a timely manner, otherwise the speaker will automatically shut down.

### 10. Using of mobile phone holder

By installing the long arm bracket through threaded rotation, you can place your phone on the bracket for use.

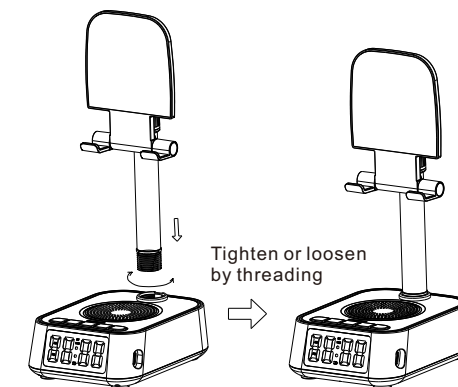

-4-

FCC Warning:

This equipment has been tested and found to comply with the limits for a Class B digital device, pursuant to part 15 of the FCC Rules. These limits are designed to provide reasonable protection against harmful interference in a residential installation. This equipment generates, uses and can radiate radio frequency energy and, if not installed and used in accordance with the instructions, may cause harmful interference to radio communications. However, there is no guarantee that interference will not occur in a particular installation. If this equipment does cause harmful interference to radio or television reception, which can be determined by turning the equipment off and on, the user is encouraged to try to correct the interference by one or more of the following measures:

- Reorient or relocate the receiving antenna.
- Increase the separation between the equipment and receiver.
- Connect the equipment into an outlet on a circuit different from that to which the receiver is connected.
- Consult the dealer or an experienced radio/TV technician for help.

Caution: Any changes or modifications to this device not explicitly approved by manufacturer could void your authority to operate this equipment.

This device complies with part 15 of the FCC Rules. Operation is subject to the following two conditions:

(1) This device may not cause harmful interference, and (2) this device must accept any interference received, including interference that may cause undesired operation.

This equipment complies with FCC radiation exposure limits set forth for an uncontrolled environment. This equipment should be installed and operated with minimum distance 0cm between the radiator and your body.